

**AGENDA ITEM 4**

Consider noting in minutes any off right-of-way work on any County road done by Road & Bridge Unified System.

Greg Bergeron addressed the Court.

Moved: **Judge Doerfler**

Seconded: **Commissioner Hays**

Motion: To note in the minutes the following utility requests on: **Blockhouse Creek Drive (Blockhouse subdivision)** by Trugreen Landcare, LLC, on **Country Road (Country West subdivision)** by Brittain Plumbing, Inc., and on **Silver Maple (Morningside Meadows)** by Austin Engineering Co., Inc.

Vote: **5 – 0**

< Attachment >

**WILLIAMSON COUNTY URS**

Utility Requests – 04/13/04

**Precinct I****Precinct II**

## A. Trugreen Landcare, LLC

1. Blockhouse Creek Drive from Apache Pool to the barricade(Blockhouse Creek) – Road cuts for an irrigation sleeve

**Precinct III**

## A. Brittain Plumbing, Inc.

1. Country Road(Country West sub.) – Road cut for 8" wastewater line

**Precinct IV**

## A. Austin Engineering Co., Inc.

1. Silver Maple(Morningside Meadows) – Road cut for 6" sewer pipe

noted 4-13-04  
John C. Daegler

## NOTICE OF PROPOSED INSTALLATION

## UTILITY LINE ON WILLIAMSON COUNTY RIGHT-OF-WAY

TO: Williamson County Unified Road System

DATE:

4/1/04

3151 S. E. Inner Loop, Suite B  
Georgetown, Texas 78626Formal notice is hereby given that TRUGREEN LANDSCAPECompany proposes to place a SLEEVE FOR AN IRRIGATION SYSTEMLine within the right-of-way of BLACKHOUSE CREEK DRIVE FROM APACHE POOL TO THE BARRICADE.

as follows: (give location, length, general design, etc.)

WE propose to cut 4 patch Smithfield Drive, Black Kettle, Echo Lake, Scottsdale, Creek Run, Fricklaw + Fort Hood. The proposed trench will be no wider than 12". All work is being done @ the request of Black House Creek MUD.

The line will be constructed and maintained on the road right-of-way as directed by the Williamson County Unified Road System in accordance with governing laws.

Our firm further understands that the County considers proper traffic control measures as those complying with applicable portions of the Texas Manual of Traffic Control Devices required for adoption by the "Transportation Code" (V.C.T.A. CH.251)

The location and description of the proposed line and appurtenances is more fully shown by 1 copies of drawings attached to this notice.

Construction of this line is proposed to begin on or after the 7th day of April 2004

APPROVAL

This application is hereby approved subject to the following understandings and restrictions.

It is expressly understood that the said County Commissioners' Court does not imply hereby to grant any right, claim, title or easement in or upon this County Road; and it is further understood that in the future, should Williamson County, for any reason, need to work, improve, relocate, widen, increase, add to, decrease, or in any manner change the structure of this road or right-of-way, this line, if affected, will be moved at the direction of the Williamson County Engineer or County Commissioner. This installation work shall not damage any part of the roadway and adequate provisions shall be made to cause a minimum of inconvenience to traffic and adjacent property owners.

APPROVED BY WILLIAMSON COUNTY COMMISSIONERS' COURT

BY:

Ray Bey  
COUNTY ROAD ADMINISTRATOR

DATE:

4/5/04

Firm: TRUGREEN LANDSCAPE

Jeffrey Rutkowski  
Authorized Signature

Printed Name

Address: TRUGREEN LANDSCAPE8741 BurnetAUSTIN TEXAS 78757Phone: 512 458 8873Fax: 512 467 0119

Pd. 2

**received**

4-2-04

4-5-04

Street Cuts

B.C.

Bond # 103265903924

04/02/04 10:47 FAX 512 467 0119

TRUGREEN

003

CONTRACTOR'S LIABILITY AGREEMENT

JEFFREY RUTKOWSKI, Contractor for TRUGREEN LAND CARE  
 in Williamson County, Texas do hereby agree to the following schedules and conditions for doing work within  
 the right-of-way of Block House Creek which is a public roadway  
 maintained by Williamson County.

1. I will contact the Williamson County Unified Road System at least 48 hours prior to start of construction.
2. All work in the right-of-way will be done between the hours of 8:30 a.m. and 4:30 p.m. on Monday through Friday only.
3. Cuts will be opened for one-half the roadway only, with flagmen on both sides of the work area, allowing one-way traffic through. This type of operation will be held to a minimum and all advance warning signs and barricades shall be as specified in the Texas Manual on Uniform Traffic Control Devices. These cuts will also be filled and entire roadway opened at night and on weekends.
4. Roadside work in ditches alongside the trenched surface may be left opened at night, only if they can be barricaded solidly between open ditch and traveled roadway leaving a minimum 6' of road shoulder between the pavement edge and the barricades. The barricades must be reflective and lighted with warning lights and conform to the requirements of the T.M.U.T.C.D. for nighttime use.
5. Any construction area to be maintained from dusk to dawn shall have Type B High Intensity Steady Burn Warning Lights to delineate the traveled way through and around obstructions in a construction or maintenance area. All warning lights shall be installed to a minimum mounting height of 36" to the bottom of the lens.
6. Construction work and road repair on County right-of-way will be done to Williamson County Standards and to the approval of the Williamson County Unified Road System.
7. I will notify the Williamson County Unified Road System and obtain approval prior to any changes from this agreement if required due to soil conditions or other problems.

DATE

4/1/04  
 Williamson County Unified Road System  
 3151 S. E. Inner Loop, Ste. B  
 Georgetown, Texas 78626

SIGNED

JEFFREY RUTKOWSKI  
 CONTRACTOR (PRINT NAME)

TRUGREEN LAND CARE

8711 BURNET  
 ADDRESS

AUSTIN TX 78757  
 CITY, STATE, ZIP CODE

MAIN 512 458 8873  
 PHONE

DIRECT 512 634 1113

MOBILE 512 748 2047

FAX 512 467 0119

04/02/04 10:47 FAX 512 467 0119

TRUGREEN

004

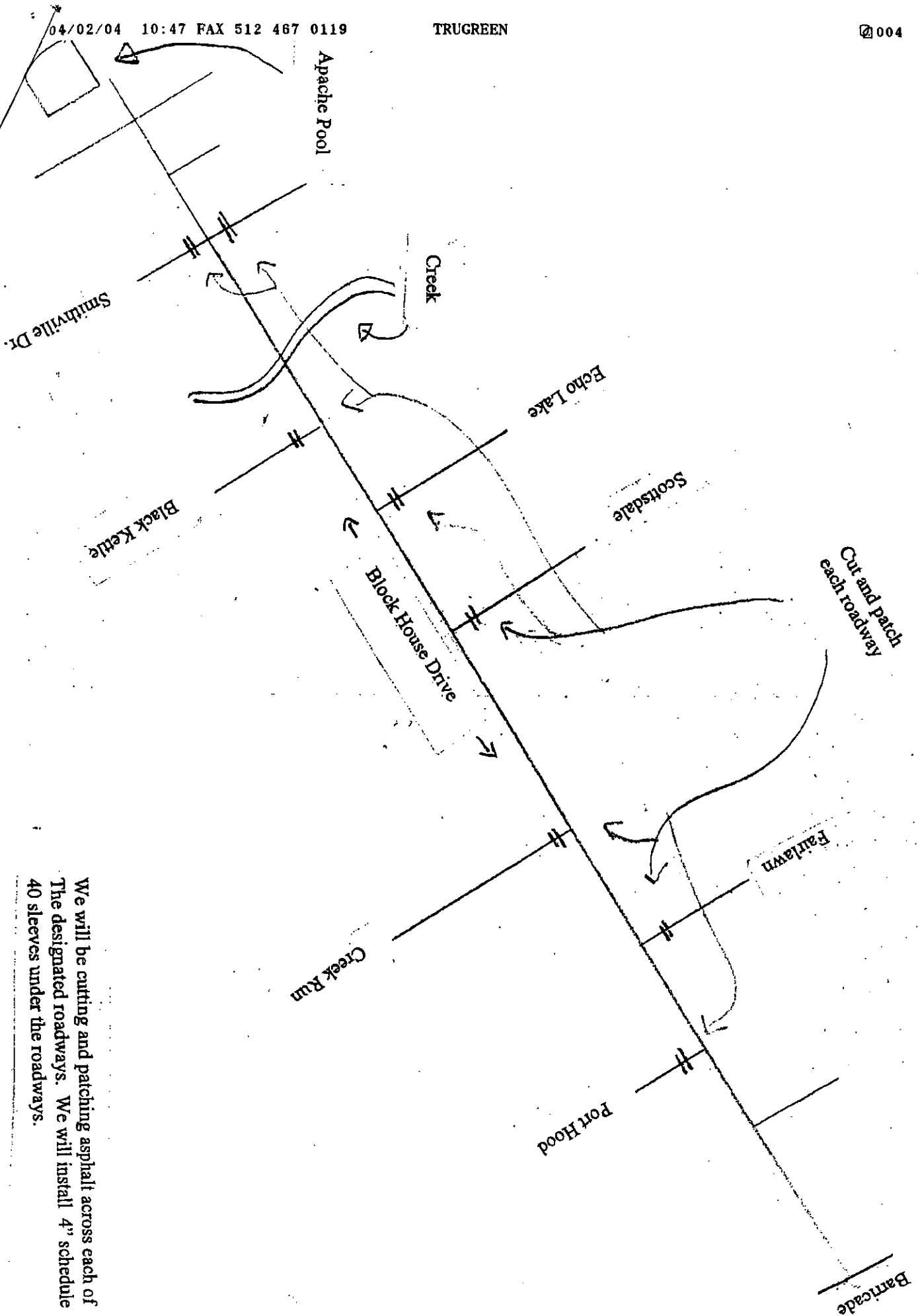

We will be cutting and patching asphalt across each of  
The designated roadways. We will install 4" schedule  
40 sleeves under the roadways.

## NOTICE OF PROPOSED INSTALLATION

## UTILITY LINE ON WILLIAMSON COUNTY RIGHT-OF-WAY

TO: Williamson County Unified Road System  
1900 Georgetown Inner Loop, Suite B  
Georgetown, Texas 78626

DATE: 11/19/03

Formal notice is hereby given that Brittain Plumbing, Inc.

Company proposes to place a 8" Wastewater

line within the right-of-way of Country Road  
as follows: (give location, length, general design, etc.)

Crossing perpendicular to Country Road 16 feet north of the most easterly northeast corner of Lot 4, Country West Subdivision.

The line will be constructed and maintained on the road right-of-way as directed by the Williamson County Unified Road System in accordance with governing laws.

Our firm further understands that the County considers proper traffic control measures as those complying with applicable portions of the Texas Manual of Traffic Control Devices required for adoption by the "Transportation Code" (V.C.T.A. CH.251)

The location and description of the proposed line and appurtenances is more fully shown by 2 copies of drawings attached to this notice.

Construction of this line is proposed to begin on or after the 1st day of December

## APPROVAL

This application is hereby approved subject to the following understandings and restrictions.

It is expressly understood that the said County Commissioners' Court does not imply hereby to grant any right, claim, title or easement in or upon this County Road; and it is further understood that in the future, should Williamson County, for any reason, need to work, improve, relocate, widen, increase, add to, decrease, or in any manner change the structure of this road or right-of-way, this line, if affected, will be moved at the direction of the Williamson County Engineer or County Commissioner. This installation work shall not damage any part of the roadway and adequate provisions shall be made to cause a minimum of inconvenience to traffic and adjacent property owners.

APPROVED BY WILLIAMSON COUNTY COMMISSIONERS' COURT

BY: Ky Berger  
COUNTY ROAD ADMINISTRATOR

DATE: 2/24/04

Firm: Steger & Bizzell Engineering, Inc.

Authorized Signature

Don H. Bizzell, Vice President

Printed Name

Address: Steger & Bizzell Engineering, Inc.

1978 S. Austin Avenue

Georgetown, Texas 78626

Phone: 512-930-9412

Fax: 512-930-9416

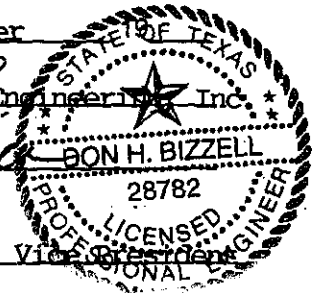

**received**

2-19-04

2-19-04

Road cut

BC

Band No. 361171



**Steger & Bizzell Engineering, Inc.**  
Consulting Engineers

Surveyors

1978 South Austin Avenue  
Georgetown, Texas 78626

Telephone: (512) 930-9412  
Facsimile: (512) 930-9416

November 24, 2003

Williamson County Engineer  
Mr. Joe England, P.E.  
3151 S.E. Georgetown Inner Loop, Ste. B  
Georgetown, Texas  
78626

Attn.: Mr. Mark Kronkosky

Re: Brittain Plumbing  
Proposed Road Cut on Country Road

Dear Mr. Kronkosky:

I am submitting for your review and approval the above referenced road cut request. The owner is requesting to open cut Country Road for a proposed wastewater line. For your information, the City of Georgetown is requiring that one lane be kept open at all times and that flowable fill is used for trench backfill.

If you should have any questions, please feel free to contact Mr. Bizzell, P.E. or me.

Sincerely,

James M. Cummins  
Project Manager

/jmc

Enclosures: 2 sets of Construction plans

Cc: Steve Brittain  
David Munk, P.E.

H:\Word Documents\20269 Brittain\wms joe england open cut request.doc

Member: NSPE TSPE TSPS ASCE

**FILE COPY**

SUBMITTED AGAIN  
2/19/04

1ST SUBMITAL WAS  
LOST.

APR-02-2004 FRI 06:08 PM

FAX NO.

P. 02

Apr 02 2004 12:11

Williamson County

9303335

P. 3

*Morningstar Meadows,  
Section 7*

## NOTICE OF PROPOSED INSTALLATION

## UTILITY LINE ON WILLIAMSON COUNTY RIGHT-OF-WAY

TO: Williamson County Unified Road System

DATE: April 2, 2004

3151 S. E. Inner Loop, Suite B  
Georgetown, Texas 78626Formal notice is hereby given that Austin Engineering Co., Inc.Company proposes to place a Sewer ServiceLine within the right-of-way of Silver Maple

as follows: (give location, length, general design, etc.)

104 Silver Maple

15' x 4' cut

Cut ditch to sewer main and cross Silver Maple with 6-inch  
sewer pipe approximately 7-feet deep

The line will be constructed and maintained on the road right-of-way as directed by the Williamson County Unified Road System in accordance with governing laws.

Our firm further understands that the County considers proper traffic control measures as those complying with applicable portions of the Texas Manual of Traffic Control Devices required for adoption by the "Transportation Code" (V.C.T.A. CH.251)The location and description of the proposed line and appurtenances is more fully shown by      copies of drawings attached to this notice.Construction of this line is proposed to begin on or after the 6th day of April 2004.APPROVAL

This application is hereby approved subject to the following understandings and restrictions.

It is expressly understood that the said County Commissioners' Court does not imply hereby to grant any right, claim, title or easement in or upon this County Road; and it is further understood that in the future, should Williamson County, for any reason, need to work, improve, relocate, widen, increase, add to, decrease, or in any manner change the structure of this road or right-of-way, this line, if affected, will be moved at the direction of the Williamson County Engineer or County Commissioner. This installation work shall not damage any part of the roadway and adequate provisions shall be made to cause a minimum of inconvenience to traffic and adjacent property owners.

APPROVED BY WILLIAMSON COUNTY COMMISSIONERS' COURT

BY: *[Signature]*  
COUNTY ROAD ADMINISTRATORDATE: 4/8/04Firm: Austin Engineering Co., Inc.*[Signature]*  
Authorized Signature

Glendon L. Barrow, Vice President

Printed Name

Address: P. O. Box 342349Austin, Texas 78734-2349Phone: (512) 327-1464Fax: (512) 237-1765**received** *Pct. 4*  
**4-5-04***4-6-04*  
*STAC cat**BL**Bond # 929318779*



APR-02-2004 FRI 06:09 PM

FAX NO.

P. 03

Apr 02 2004 12:11

Williamson County

9303335

P. 4

CONTRACTOR'S LIABILITY AGREEMENT

( Austin Engineering Co., Inc. Contractor for Morningside Meadows  
 in Williamson County, Texas do hereby agree to the following schedules and conditions for doing work within  
 the right-of-way of Silver Maple which is a public roadway  
 maintained by Williamson County.

1. I will contact the Williamson County Unified Road System at least 48 hours prior to start of construction.
2. All work in the right-of-way will be done between the hours of 8:30 a.m. and 4:30 p.m. on Monday through Friday only.
3. Cuts will be opened for one-half the roadway only, with flagmen on both sides of the work area, allowing one-way traffic through. This type of operation will be held to a minimum and all advance warning signs and barricades shall be as specified in the Texas Manual on Uniform Traffic Control Devices. These cuts will also be filled and entire roadway opened at night and on weekends.
4. Roadside work in ditches alongside the trrenched surface may be left opened at night, only if they can be barricaded solidly between open ditch and traveled roadway leaving a minimum 6' of road shoulder between the pavement edge and the barricades. The barricades must be reflective and lighted with warning lights and conform to the requirements of the T.M.U.T.C.D. for nighttime use.
5. Any construction area to be maintained from dusk to dawn shall have Type B High Intensity Steady Burn Warning Lights to delineate the traveled way through and around obstructions in a construction or maintenance area. All warning lights shall be installed to a minimum mounting height of 36" to the bottom of the lens.
6. Construction work and road repair on County right-of-way will be done to Williamson County Standards and to the approval of the Williamson County Unified Road System.
7. I will notify the Williamson County Unified Road System and obtain approval prior to any changes from this agreement if required due to soil conditions or other problems.

AUSTIN ENGINEERING CO., INC.

April 2, 2004

DATE

Williamson County Unified Road System  
 3151 S. E. Inner Loop, Ste. B  
 Georgetown, Texas 78626



SIGNED Glendon L. Barrow, Vice President

Austin Engineering Co., Inc.

CONTRACTOR (PRINT NAME)

P. O. Box 342349

ADDRESS

Austin, Texas 78734-2349

CITY, STATE, ZIP CODE

(512) 327-1464

PHONE

APR-02-2004 FRI 06:10 PM

FAX NO.

P. 04

Apr 02 2004 12:12

Williamson County

9303335

p. 5

## PERPENDICULAR UTILITY CUT DESIGN IN WILLIAMSON COUNTY R.O.W.

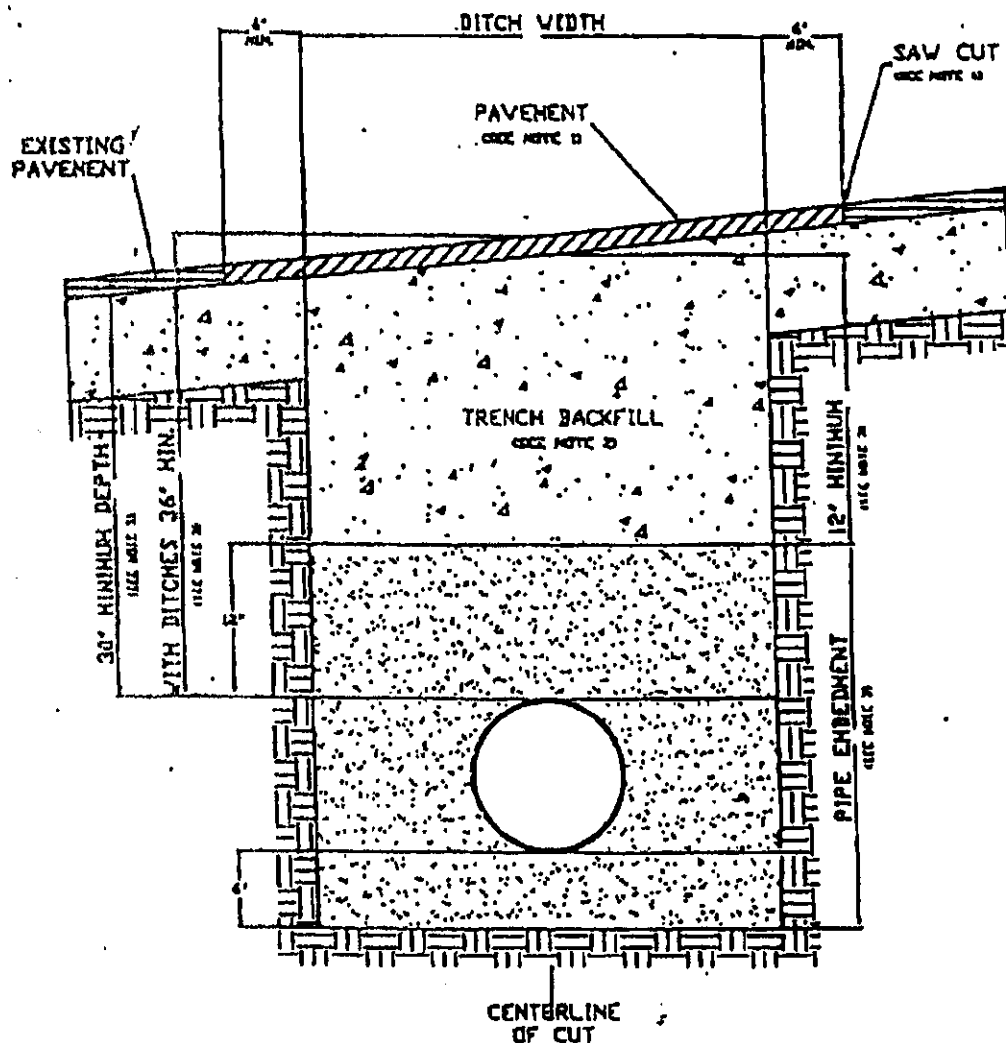

1. Hot mix asphalt 1 1/2" min. thickness. Roll in place to match existing surface, + or - 1/8" tolerance.
2. Trench backfill shall be flexible base, compacted to 95% optimum in 8" layers unless otherwise approved and specified. Flexible base to match existing base thickness or 8 inches, whichever is greater (specifications; TxDOT Item 247, Type A, Grade 2).
3. Pipe embedment (pipe envelope) size and materials shall be as specified elsewhere by utility company and/or its engineers. Pipe depth shall be as specified elsewhere provided that minimum depths are met.
4. Saw cut shall be made prior to ditch cut. If pavement is damaged during cut, a new saw cut shall be made beyond the damaged area and new pavement placed.
5. Where roadside ditches (ber ditches) are crossed by the utility pipe, minimum depth to the top of the pipe from centerline road elevation will be 36".

APR-02-2004 FRI 06:11 PM

FAX NO.

P. 05

Apr 02 2004 12:12

Williamson County

9303335

P. 6

## PARALLEL UTILITY CUT DESIGN IN WILLIAMSON COUNTY R.O.W.

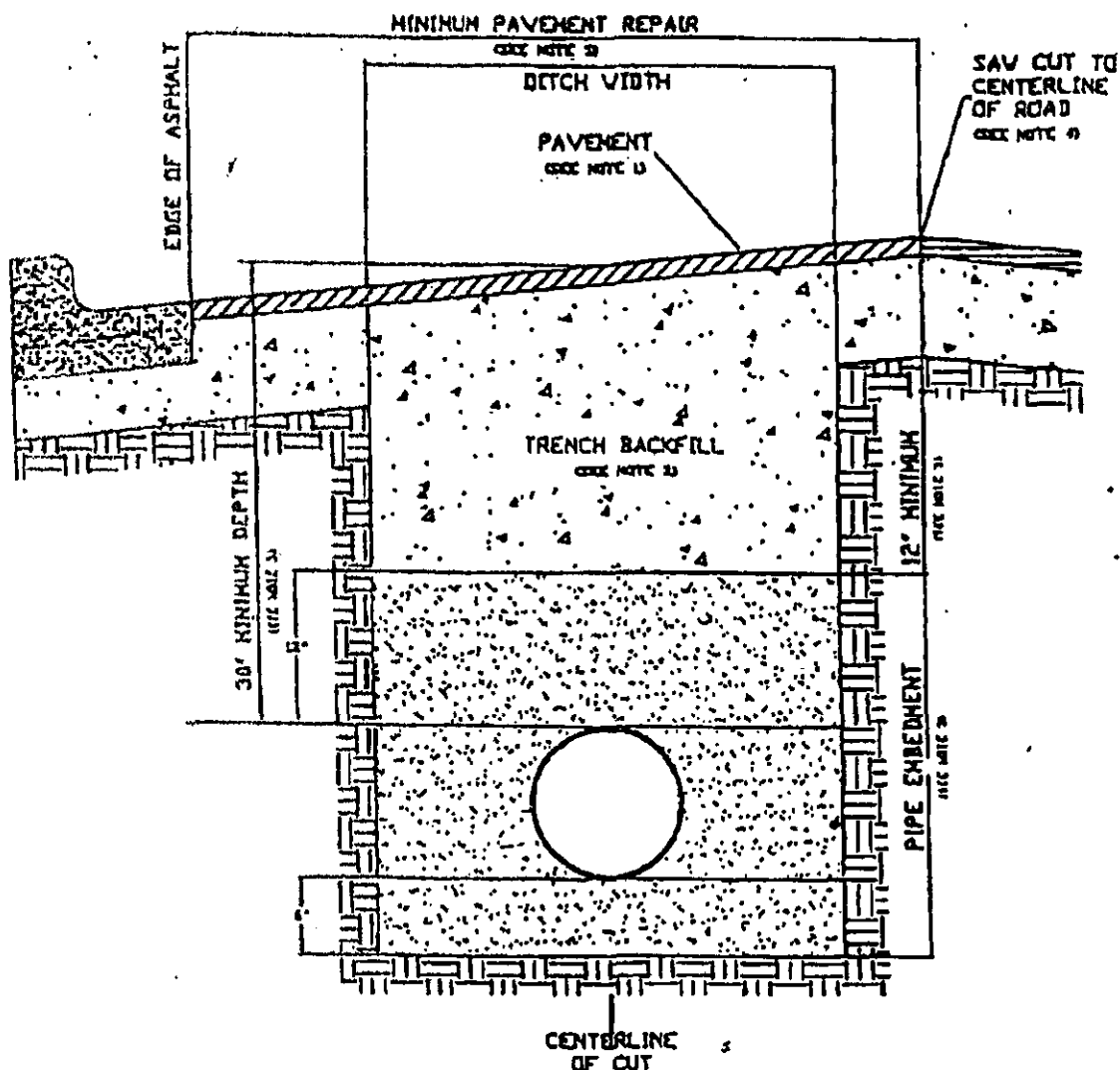

1. Hot mix asphalt to match existing HMA thickness or 2" minimum, whichever is greater. Roll in place to match existing surface, + or - 1/8" tolerance.
2. Trench backfill shall be flexible base, compacted to 95% optimum in 8" layers unless otherwise approved and specified. Flexible base to match existing base thickness or 8", whichever is greater (Specifications: TxDOT Item 247, Type A, Grade 2).
3. Pipe embedment (pipe envelope) size and materials shall be as specified elsewhere by the utility company and/or its engineers. Pipe depth shall be as specified elsewhere provided that minimum depths are met.
4. Saw cut shall be made prior to ditch cut. If pavement is damaged during cut, a new saw cut shall be made beyond the damaged area and new pavement placed.
5. Damage beyond the centerline requires repair over entire roadway width.

APR-02-2004 FRI 06:12 PM

5' BUILDING LINE

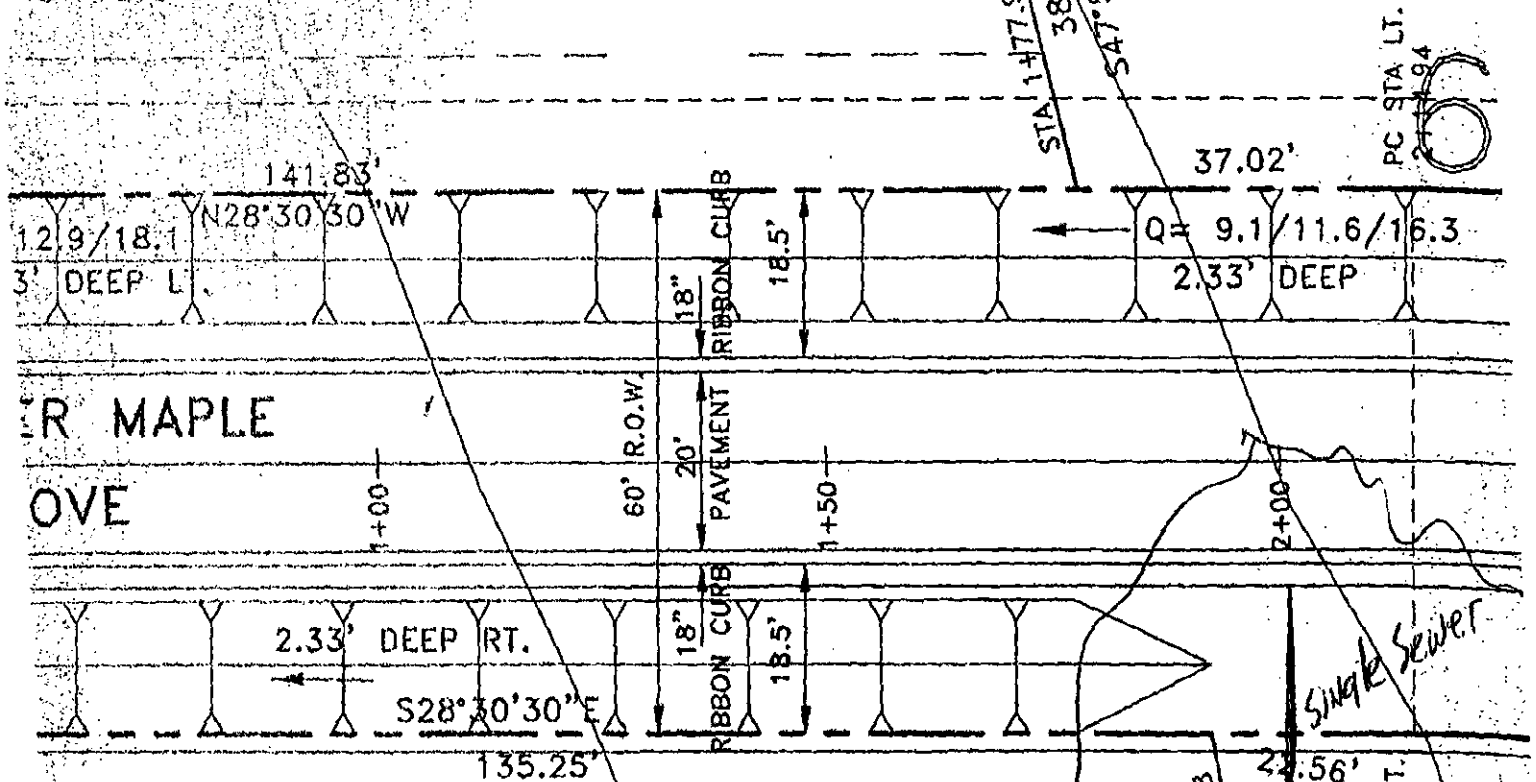

69

15' BUILDING LINE

CURVE	DELTA	RADIUS	TANGENT	ARC	CHORD	CHORD BE
C108	24°50'07"	200.00	44.04	86.69	86.01	N16°05'2"
C109	23°50'38"	200.00	42.23	83.23	82.63	S59°51'5"
C111	21°41'47"	190.00	36.41	71.95	71.52	S60°56'2"
C112	23°50'38"	210.00	44.34	87.39	86.76	S59°51'5"
C120	78°35'59"	25.00	20.46	34.30	31.67	S10°47'3"
C121	49°40'47"	45.00	20.83	39.02	37.81	S28°30'4"
C122	49°40'47"	45.00	20.83	39.02	37.81	N21°10'0"
C123	279°21'34"	40.00	33.95	195.03	51.76	N86°19'3"
C124	24°50'07"	190.00	41.84	82.36	81.71	N16°05'2"
C125	24°50'07"	210.00	46.24	91.03	90.31	N16°05'2"
C153	103°32'52"	25.00	31.74	45.18	39.28	N80°16'5"

STA 4+29.50 149.46'

**Consent Agenda**

The Consent Agenda includes non-controversial and routine items that the Court may act on with one single vote. The Judge or a Commissioner may pull any item from the Consent Agenda in order that the court discuss and act upon it individually as part of the Regular Agenda.

(Items 5 - 20)

**AGENDA ITEM 5****Consider approving a line item transfer for the Jail:**

From:	0100-0570-003316	Medical/Hospital	50,000.00
To:	0100-0570-003307	Pharmaceuticals	50,000.00

Moved: **Commissioner Hays**

Seconded: **Judge Doerfler**

Motion: To approve a line item transfer for the Jail:

From:	0100-0570-003316	Medical/Hospital	50,000.00
To:	0100-0570-003307	Pharmaceuticals	50,000.00

Vote: **5 – 0**

< Attachment >