

AGENDA ITEM 4

Consider noting in minutes any off right-of-way work on any County road done by Road & Bridge Unified System.

Moved: **Judge Doerfler**

Seconded: **Commissioner Limmer**

Motion: To note in the minutes the following utility requests:

Chisholm Trail SUD for bore on CR 233;

Bell-Milam Falls WSC for bore on CR 386; and

Time Warner Cable for ROW on CR 136.

Vote: 4 - 0

< Attachment >

WILLIAMSON COUNTY URS

Utility Requests – 07/09/02

Precinct I**Precinct II****Precinct III**

- A. Chisholm Trail S.U.D.
 - 1. CR 233 - Bore

Precinct IV

- A. Bell-Milam Falls Water Supply Corporation
 - 1. CR 386 – Bore
- B. Time Warner Cable
 - 1. CR 136 - ROW

*noted 7-9-02
John A. Doerfler*

NOTICE OF PROPOSED INSTALLATION
UTILITY LINE ON WILLIAMSON COUNTY RIGHT-OF-WAY

TO: Williamson County Unified Road System
1900 Georgetown Inner Loop, Suite B
Georgetown, Texas 78626

DATE: 6/28/02

Formal notice is hereby given that CHISHOLM TRAIL SPECIAL UTILITY DISTRICT

Company proposes to place a 1" waterline in a 4" casing

line within the right-of-way of County Road 233

as follows: (give location, length, general design, etc.)

Existing District waterline is on the North side of the road, 18' from the pavement, buried 28" deep. Width of pavement is 18'. Depth of bore will be 36".

Location: 1.8 miles from the intersection of Hwy 195. Marked with blue paint
Bill Ellis Contractor--Bulls Eye Excavating, Inc.

The line will be constructed and maintained on the road right-of-way as directed by the Williamson County Unified Road System in accordance with governing laws.

Our firm further understands that the County considers proper traffic control measures as those complying with applicable portions of the Texas Manual of Traffic Control Devices required for adoption by the "Transportation Code" (V.C.T.A. CH.251)

The location and description of the proposed line and appurtenances is more fully shown by 2 copies of drawings attached to this notice.

Construction of this line is proposed to begin on or after the 30 day of June 2002

APPROVAL

This application is hereby approved subject to the following understandings and restrictions.

Firm: Chisholm Trail S.U.D.

Patricia B. Rodgers
Authorized Signature

It is expressly understood that the said County Commissioners' Court does not imply hereby to grant any right, claim, title or easement in or upon this County Road; and it is further understood that in the future, should Williamson County, for any reason, need to work, improve, relocate, widen, increase, add to, decrease, or in any manner change the structure of this road or right-of-way, this line, if affected, will be moved at the direction of the Williamson County Engineer or County Commissioner. This installation work shall not damage any part of the roadway and adequate provisions shall be made to cause a minimum of inconvenience to traffic and adjacent property owners.

APPROVED BY WILLIAMSON COUNTY COMMISSIONERS' COURT

BY: [Signature]
COUNTY ROAD ADMINISTRATOR

DATE: 7/8/02

Printed Name

Address: P O Box 249

Florence, Tx 76527

Phone: 254/793-3103

Fax: 254/793-3100

Pd. 3

[Signature]

[Signature]

UTILITY LINE ON WILLIAMSON COUNTY RIGHT-OF-WAY

TO: Williamson County Unified Road System
1900 Georgetown Inner Loop, Suite B
Georgetown, Texas 78626

DATE: 3/27/02Formal notice is hereby given that Bell-Milam-Falls Water Supply CorporationCompany proposes to place a water lineline within the right-of-way of CR 386

as follows: (give location, length, general design, etc.)

Bore and encase a 1/4" PVC water line in a 2" PVC encasement.

Location: Approximately .7 mile ^{North} from intersection of FM 971 and CR 386.

Customer: Donald Finch

The line will be constructed and maintained on the road right-of-way as directed by the Williamson County Unified Road System in accordance with governing laws:

Our firm further understands that the County considers proper traffic control measures as those complying with applicable portions of the Texas Manual of Traffic Control Devices required for adoption by the "Transportation Code" (V.C.T.A. CH.251)

The location and description of the proposed line and appurtenances is more fully shown by 2 copies of drawings attached to this notice.

Construction of this line is proposed to begin on or after the 8th day of July ~~19~~ 2002APPROVALFirm: BELL-MILAM-FALLS WSC

This application is hereby approved subject to the following understandings and restrictions.

Authorized Signature

Dwayne Jekel, Manager

Printed Name

Address: P. O. Drawer 150Cameron, Texas 76520Dwayne JekelPhone: (254) 697-4016Fax: (254) 697-2294

It is expressly understood that the said County Commissioners' Court does not imply hereby to grant any right, claim, title or easement in or upon this County Road; and it is further understood that in the future, should Williamson County, for any reason, need to work, improve, relocate, widen, increase, add to, decrease, or in any manner change the structure of this road or right-of-way, this line, if affected, will be moved at the direction of the Williamson County Engineer or County Commissioner. This installation work shall not damage any part of the roadway and adequate provisions shall be made to cause a minimum of inconvenience to traffic and adjacent property owners.

APPROVED BY WILLIAMSON COUNTY COMMISSIONERS' COURT

BY: [Signature]
COUNTY ROAD ADMINISTRATORDATE: 7/8/02

Pct. 4

[Signature]
[Signature]

I, D & L Service Co., Inc., Contractor for Bell-Milam-Falls Water Supply Corp.
in Williamson County, Texas do hereby agree to the following schedules and conditions for doing work
within the right-of-way of CR 386 which is a public
roadway maintained by Williamson County.

1. I will contact the Williamson County Unified Road System at least 48 hours prior to start of construction.
2. All work in the right-of-way will be done between the hours of 8:30 a.m. and 4:30 p.m. on Monday through Friday only.
3. Cuts will be opened for one-half the roadway only, with flagmen on both sides of the work area, allowing one-way traffic through. This type of operation will be held to a minimum and all advance warning signs and barricades shall be as specified in the Texas Manual on Uniform Traffic Control Devices. These cuts will also be filled and entire roadway opened at night and on weekends.
4. Roadside work in ditches alongside the trenched surface may be left opened at night, only if they can be barricaded solidly between open ditch and traveled roadway leaving a minimum 6' of road shoulder between the pavement edge and the barricades. The barricades must be reflectorized and lighted with warning lights and conform to the requirements of the T.M.U.T.C.D. for nighttime use.
5. Any construction area to be maintained from dusk to dawn shall have Type B High Intensity Steady Burn Warning Lights to delineate the traveled way through and around obstructions in a construction or maintenance area. All warning lights shall be installed to a minimum mounting height of 36" to the bottom of the lense.
6. Construction work and road repair on County right-of-way will be done to Williamson County Standards and to the approval of the Williamson County Unified Road System.
7. I will notify the Williamson County Unified Road System and obtain approval prior to any changes from this agreement if required due to soil conditions or other problems.

6-27-02

DATE

Williamson County Unified Road System
1900 Georgetown Inner Loop, Ste. B
Georgetown, Texas 78626

SIGNED

DWAYNE JEREL

D & L SERVICE CO., INC.
CONTRACTOR (PRINT NAME)

462 West FM 485
ADDRESS

Cameron, Texas 76520
CITY, STATE, ZIP CODE

(254) 697-4016
PHONE

PERPENDICULAR UTILITY CUT DESIGN IN WILLIAMSON COUNTY R.O.W.

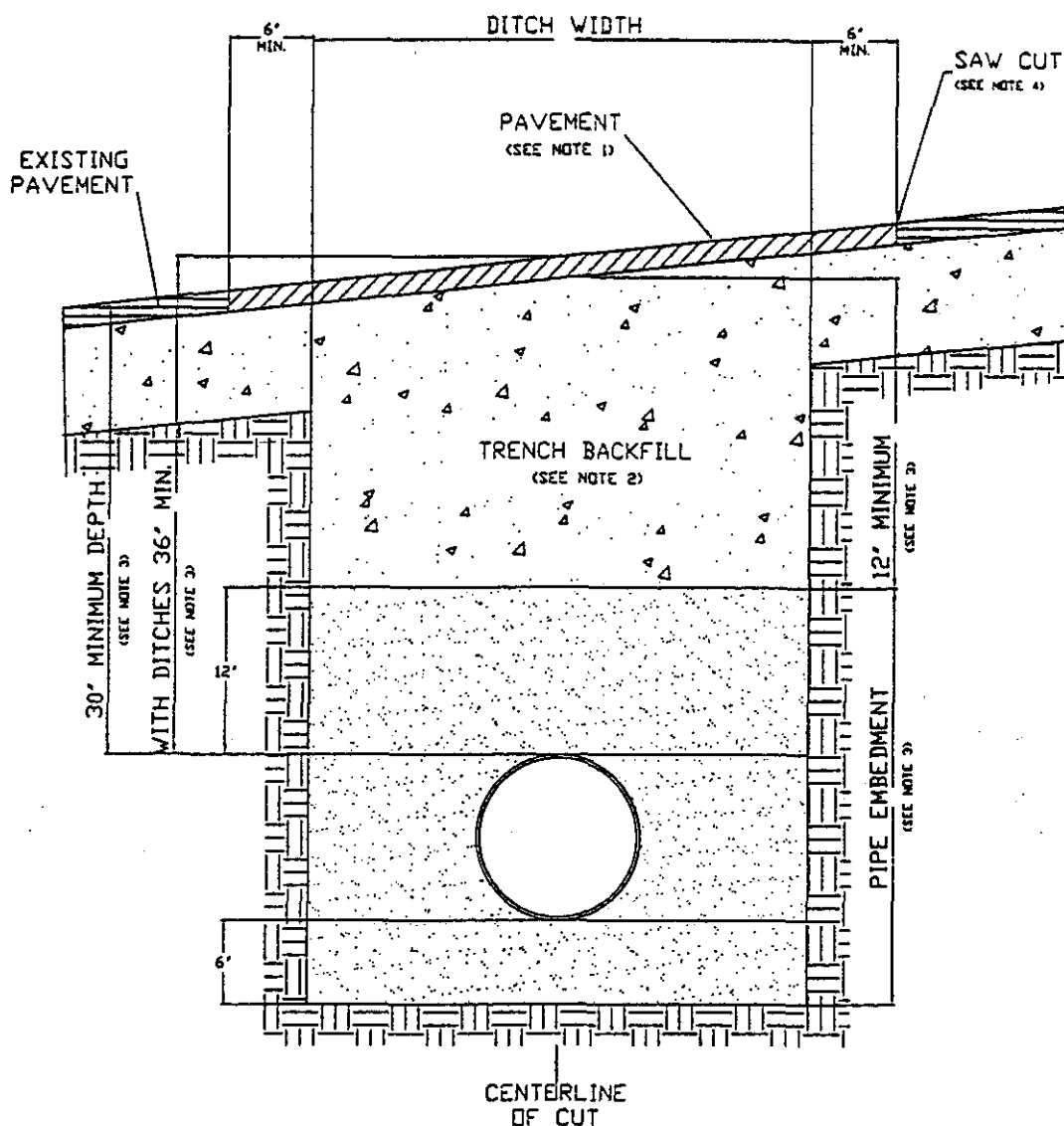

1. Hot mix asphalt 1 1/2" min. thickness. Roll in place to match existing surface, + or - 1/8" tolerance.
2. Trench backfill shall be flexible base, compacted to 95% optimum in 8" layers unless otherwise approved and specified. Flexible base to match existing base thickness or 8 inches, whichever is greater (specifications; TxDOT Item 247, Type A, Grade 2).
3. Pipe embedment (pipe envelope) size and materials shall be as specified elsewhere by utility company and/or its engineers. Pipe depth shall be as specified elsewhere provided that minimum depths are met.
4. Saw cut shall be made prior to ditch cut. If pavement is damaged during cut, a new saw cut shall be made beyond the damaged area and new pavement placed.
5. Where roadside ditches (bar ditches) are crossed by the utility pipe, minimum depth to the top of the pipe from centerline road elevation will be 36".
6. All pavement repair shall conform to Item 351 Repairing Existing Flexible Pavement Structure as found in the 1993 Texas Department of Transportation Standard Specifications for Construction of Highways, Streets and Bridges.

RECORDERS MEMORANDUM

All or parts of the text on this page was not clearly legible for satisfactory recordation.

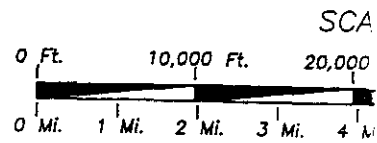

Prepared by:
 STEGER & BIZZELL ENGINEERING, INC.
 Job No. 17578
 Plot Scale 1" = 8250'

NOTICE

This map has been prepared for internal use within the Addressing Office. Accuracy is limited to the validity of the data provided.

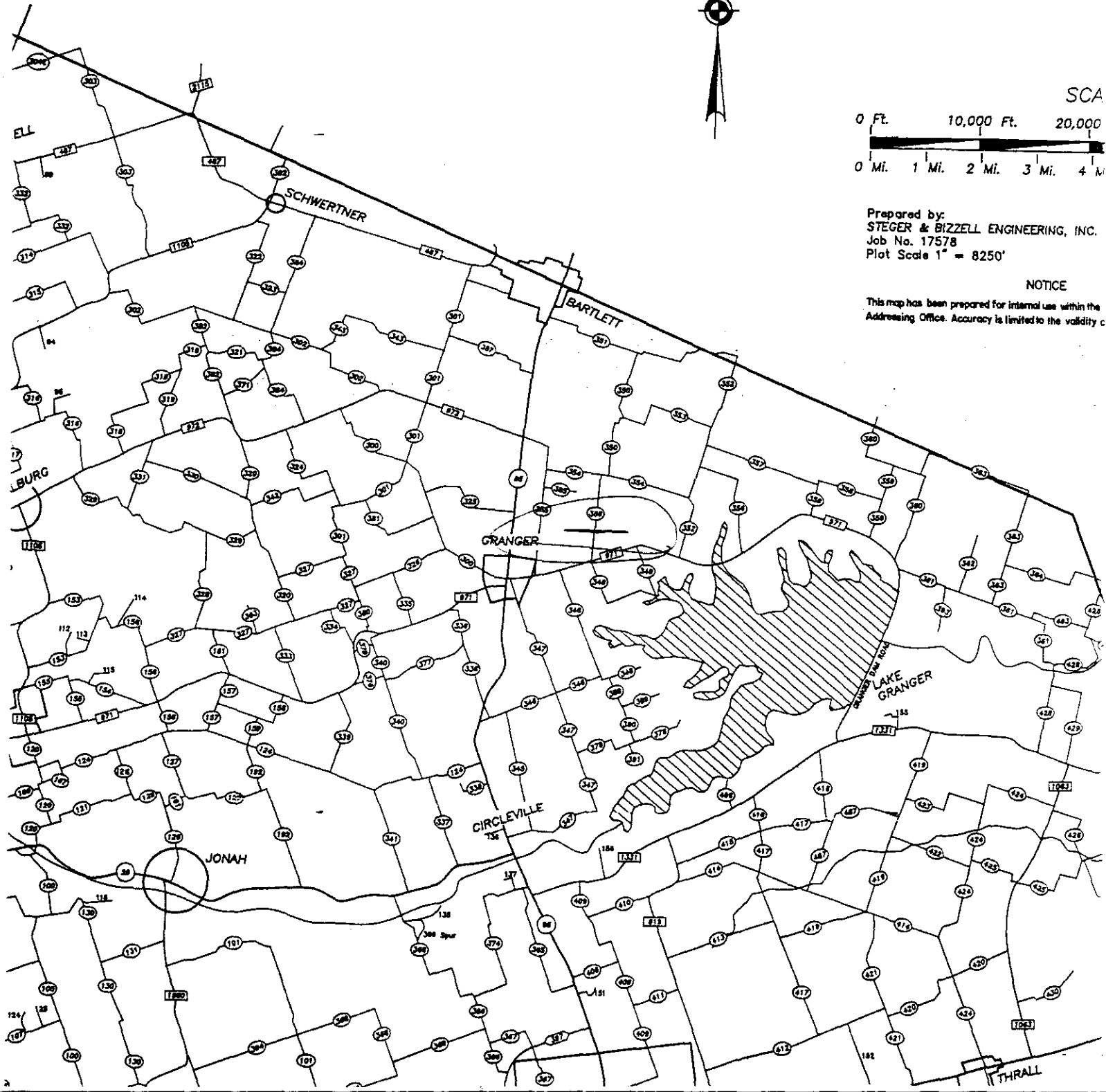

NOTICE OF PROPOSED INSTALLATION

UTILITY LINE ON WILLIAMSON COUNTY RIGHT-OF-WAY

TO: Williamson County Unified Road System
3151 S. E. Inner Loop, Suite B
Georgetown, Texas 78626

DATE: 7-5-02

Formal notice is hereby given that Time Warner Cable

Company proposes to place a Fiber Optic Cable

Line within the right-of-way of C.R. 136
as follows: (give location, length, general design, etc.)

We propose to over lash approx. 2,729' of fiber optic cable on C.R. 136.
Fiber will be over lashed on existing poles. Starting @ E.m. 1640 and
Continuing down C.R. 136 until Carl Dr.

The line will be constructed and maintained on the road right-of-way as directed by the Williamson County Unified Road System in accordance with governing laws.

Our firm further understands that the County considers proper traffic control measures as those complying with applicable portions of the Texas Manual of Traffic Control Devices required for adoption by the "Transportation Code" (V.C.T.A. CH.251)

The location and description of the proposed line and appurtenances is more fully shown by 3 copies of drawings attached to this notice.

Construction of this line is proposed to begin on or after the 5th day of July 2002

APPROVAL

This application is hereby approved subject to the following understandings and restrictions.

It is expressly understood that the said County Commissioners' Court does not imply hereby to grant any right, claim, title or easement in or upon this County Road; and it is further understood that in the future, should Williamson County, for any reason, need to work, improve, relocate, widen, increase, add to, decrease, or in any manner change the structure of this road or right-of-way, this line, if affected, will be moved at the direction of the Williamson County Engineer or County Commissioner. This installation work shall not damage any part of the roadway and adequate provisions shall be made to cause a minimum of inconvenience to traffic and adjacent property owners.

APPROVED BY WILLIAMSON COUNTY COMMISSIONERS' COURT

BY: [Signature]
COUNTY ROAD ADMINISTRATOR

DATE: 7/8/02

Firm: Time Warner Cable

[Signature]
Authorized Signature

Timothy Valderrama
Printed Name

Address: 12012 N. Mopac Expwy.
Austin, TX. 78758

Phone: (512) 485-6778 Mobile (512) 785-7983

Fax: (512) 485-4092

received
7/8/02

7/8/02

Row

B.C.

Pct. 4

I, Time Warner Cable Const., Contractor for Time Warner Cable
in Williamson County, Texas do hereby agree to the following schedules and conditions for doing work within
the right-of-way of any Williamson County maintained road/ROW which is a public roadway
maintained by Williamson County.

1. I will contact the Williamson County Unified Road System at least 48 hours prior to start of construction.
2. All work in the right-of-way will be done between the hours of 8:30 a.m. and 4:30 p.m. on Monday through Friday only.
3. Cuts will be opened for one-half the roadway only, with flagmen on both sides of the work area, allowing one-way traffic through. This type of operation will be held to a minimum and all advance warning signs and barricades shall be as specified in the Texas Manual on Uniform Traffic Control Devices. These cuts will also be filled and entire roadway opened at night and on weekends.
4. Roadside work in ditches alongside the trenched surface may be left opened at night, only if they can be barricaded solidly between open ditch and traveled roadway leaving a minimum 6' of road shoulder between the pavement edge and the barricades. The barricades must be reflective and lighted with warning lights and conform to the requirements of the T.M.U.T.C.D. for nighttime use.
5. Any construction area to be maintained from dusk to dawn shall have Type B High Intensity Steady Burn Warning Lights to delineate the traveled way through and around obstructions in a construction or maintenance area. All warning lights shall be installed to a minimum mounting height of 36" to the bottom of the lens.
6. Construction work and road repair on County right-of-way will be done to Williamson County Standards and to the approval of the Williamson County Unified Road System.
7. I will notify the Williamson County Unified Road System and obtain approval prior to any changes from this agreement if required due to soil conditions or other problems.

7-5-02
DATE

Williamson County Unified Road System
3151 S. E. Inner Loop, Ste. B
Georgetown, Texas 78626

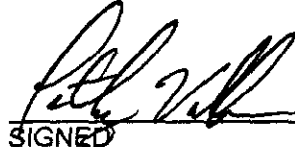
SIGNED

Timothy Valderrama
CONTRACTOR (PRINT NAME)

12012 N. Mapac Expwy.
ADDRESS

Austin, TX. 78758
CITY, STATE, ZIP CODE

(512) 485-6778 Mobile (512) 785-7983
PHONE

Consent Agenda

**The Consent Agenda includes non-controversial and routine items that the Court may act on with one single vote. The Judge or a Commissioner may pull any item from the Consent Agenda in order that the court discuss and act upon it individually as part of the Regular Agenda.
(Items 5- 20)**

AGENDA ITEM 5

Consider approving a line item transfer for Non-Departmental:

From:	0100-0409-004999	Miscellaneous	35,000.00
To:	0100-0440-004236	Extradition Expenses	15,000.00
	0100-0440-004932	Trial Expense	20,000.00

Moved: Commissioner Boatright

Seconded: Commissioner Hays

Motion: To approve a line item transfer for Non-Departmental:

From:	0100-0409-004999	Miscellaneous	35,000.00
To:	0100-0440-004236	Extradition Expenses	15,000.00
	0100-0440-004932	Trial Expense	20,000.00

Vote: 4 - 0

< Attachment >