

AGENDA ITEM 4

Consider noting in minutes any off right-of-way work on any County road done by Road & Bridge Unified System.

Moved: **Judge Doerfler**

Seconded: **Commissioner Limmer**

Motion: To note off right-of-way work on County Road 104 to clean channel in the right-of-way and on the property of **Jim Webb**.

TXU Gas Co. for bore in Chandler Road.

TXU Gas Co. for bore in Great Oaks Drive.

Cat Hollow at Brushy Creek Home Owners Association for road cut for irrigation sleeve at Luckenwald & Manheim.

Southwestern Bell Telephone for right-of-way and bore on Deer Draw.

Central Telephone Company of Texas for right-of-way on County Road 136.

Vote: Motion carried 5 – 0

< Clerk copy here >

WILLIAMSON COUNTY URS
Utility Requests – 08/29/00

Precinct I

- A. TXU Gas Co.
 - 1. Chandler Rd. - Bore (S. side of road is in Pct. 4)

Precinct II

Precinct III

- A. TXU Gas Co.
 - 1. Great Oaks Drive - Bore
- B. Brushy Creek H.O.A.
 - 1. Luckenwald & Manheim - Road cut for irrigation sleeve
- C. SWBT
 - 1. Deer Draw - ROW & Bore

Precinct IV

- A. Central Telephone Co. of Texas
 - 1. CR 136 - ROW

*noted 8-29-00
John C. Doerfler*

Cat Hollow

NOTICE OF PROPOSED INSTALLATION

UTILITY LINE ON WILLIAMSON COUNTY RIGHT-OF-WAY

TO: Williamson County Unified Road System
3151 S. E. Inner Loop, Suite B
Georgetown, Texas 78626

DATE: 8/18/00

Formal notice is hereby given that Cat Hollow at Brushy Creek homeowner's association
Company proposes to place a irrigation sleeve
Line within the right-of-way of Luckenwald; Manheim
as follows: (give location, length, general design, etc.)

The line will be constructed and maintained on the road right-of-way as directed by the Williamson County Unified Road System in accordance with governing laws.

Our firm further understands that the County considers proper traffic control measures as those complying with applicable portions of the Texas Manual of Traffic Control Devices required for adoption by the "Transportation Code" (V.C.T.A. CH.251)

The location and description of the proposed line and appurtenances is more fully shown by ___ copies of drawings attached to this notice.

Construction of this line is proposed to begin on or after the ___ day of ___ 2000.

APPROVAL

This application is hereby approved subject to the following understandings and restrictions.

It is expressly understood that the said County Commissioners' Court does not imply hereby to grant any right, claim, title or easement in or upon this County Road; and it is further understood that in the future, should Williamson County, for any reason, need to work, improve, relocate, widen, increase, add to, decrease, or in any manner change the structure of this road or right-of-way, this line, if affected, will be moved at the direction of the Williamson County Engineer or County Commissioner. This installation work shall not damage any part of the roadway and adequate provisions shall be made to cause a minimum of inconvenience to traffic and adjacent property owners.

APPROVED BY WILLIAMSON COUNTY COMMISSIONERS' COURT

BY: [Signature]
COUNTY ROAD ADMINISTRATOR

DATE: 8/25/00

Firm: CAT HOLLOW HOA

[Signature]
Authorized Signature

LORI M. SHORT
Printed Name

Address: 16801 JUDY SCHOLL WAY
ROUND ROCK, TX 78681

Phone: 388-7461

Fax: 11

Bond # R-24/24400
pd. 3
8-25-00

[Signature]
R.J.

RECORDERS MEMORANDUM

All or parts of the text on this page was not
clearly legible for satisfactory recordation.

Handwritten mark resembling a stylized 'A' or '4' with a diagonal slash.

Existing Line 2

Luckenwald Dr.

O'Connor Dr

RECORDERS MEMORANDUM

All or parts of the text on this page was not
clearly legible for satisfactory recordation.

~~N~~

Existing Line &

Mannheim Dr.

O'Connor Dr.

RECORDERS MEMORANDUM

65

All or parts of the text on this page was not
clearly legible for satisfactory reproduction

CONTRACTOR'S LIABILITY AGREEMENT

I, Sunglow Landscape Serv., Contractor for Cat Hollow at Brushy Creek Homeowners Ass
in Williamson County, Texas do hereby agree to the following schedules and conditions for doing work within
the right-of-way of Luckenwald ? Manheim which is a public roadway
maintained by Williamson County.

1. I will contact the Williamson County Unified Road System at least 48 hours prior to start of construction.
2. All work in the right-of-way will be done between the hours of 8:30 a.m. and 4:30 p.m. on Monday through Friday only.
3. Cuts will be opened for one-half the roadway only, with flagmen on both sides of the work area, allowing one-way traffic through. This type of operation will be held to a minimum and all advance warning signs and barricades shall be as specified in the Texas Manual on Uniform Traffic Control Devices. These cuts will also be filled and entire roadway opened at night and on weekends.
4. Roadside work in ditches alongside the trenched surface may be left opened at night, only if they can be barricaded solidly between open ditch and traveled roadway leaving a minimum 6' of road shoulder between the pavement edge and the barricades. The barricades must be reflectorized and lighted with warning lights and conform to the requirements of the T.M.U.T.C.D. for nighttime use.
5. Any construction area to be maintained from dusk to dawn shall have Type B High Intensity Steady Burn Warning Lights to delineate the traveled way through and around obstructions in a construction or maintenance area. All warning lights shall be installed to a minimum mounting height of 36" to the bottom of the lense.
6. Construction work and road repair on County right-of-way will be done to Williamson County Standards and to the approval of the Williamson County Unified Road System.
7. I will notify the Williamson County Unified Road System and obtain approval prior to any changes from this agreement if required due to soil conditions or other problems.

8-18-00
DATE

Williamson County Unified Road System
3151 S. E. Inner Loop, Ste. B
Georgetown, Texas 78626

Michael D. L.
SIGNED

Michael S. Herman (Sunglow)
CONTRACTOR (PRINT NAME)

1508-A Ferguson Lane
ADDRESS

Austin, TX 78754
CITY, STATE, ZIP CODE

512-834-0123
PHONE

RECORDERS MEMORANDUM

All or parts of the text on this page was
 nearly legible for satisfactory recordation.

PARALLEL UTILITY CUT DESIGN IN WILLIAMSON COUNTY R.O.W.

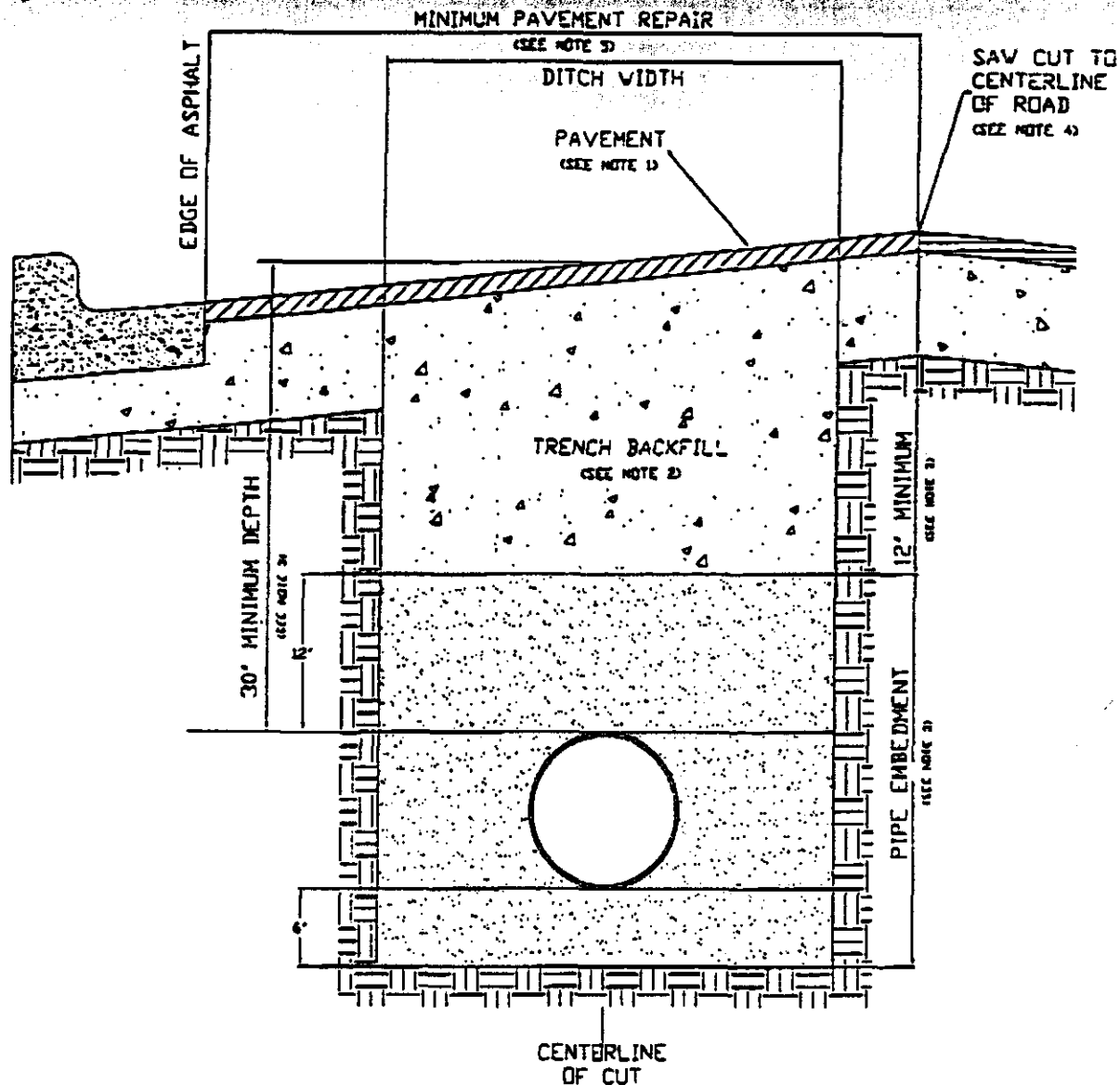

1. Hot mix asphalt to match existing HMAC thickness or 2" minimum, whichever is greater. Roll in place to match existing surface, + or - 1/8" tolerance.
2. Trench backfill shall be flexible base, compacted to 95% optimum in 8" layers unless otherwise approved and specified. Flexible base to match existing base thickness or 8", whichever is greater (Specifications: TxDOT Item 247, Type A, Grade 2).
3. Pipe embedment (pipe envelope) size and materials shall be as specified elsewhere by the utility company and/or its engineers. Pipe depth shall be as specified elsewhere provided that minimum depths are met.
4. Saw cut shall be made prior to ditch cut. If pavement is damaged during cut, a new saw cut shall be made beyond the damaged area and new pavement placed.
5. Damage beyond the centerline requires repair over entire roadway width.
6. All pavement repair shall conform to Item 351 Repairing Existing Flexible Pavement Structure as found in the 1993 Texas Department of Transportation Standard Specifications for Construction of Highways, Streets and Bridges.

PERPENDICULAR UTILITY CUT DESIGN IN WILLIAMSON COUNTY R.O.W.

RECORDERS MEMORANDUM

All or parts of the text on this page was not clearly legible for satisfactory recordation.

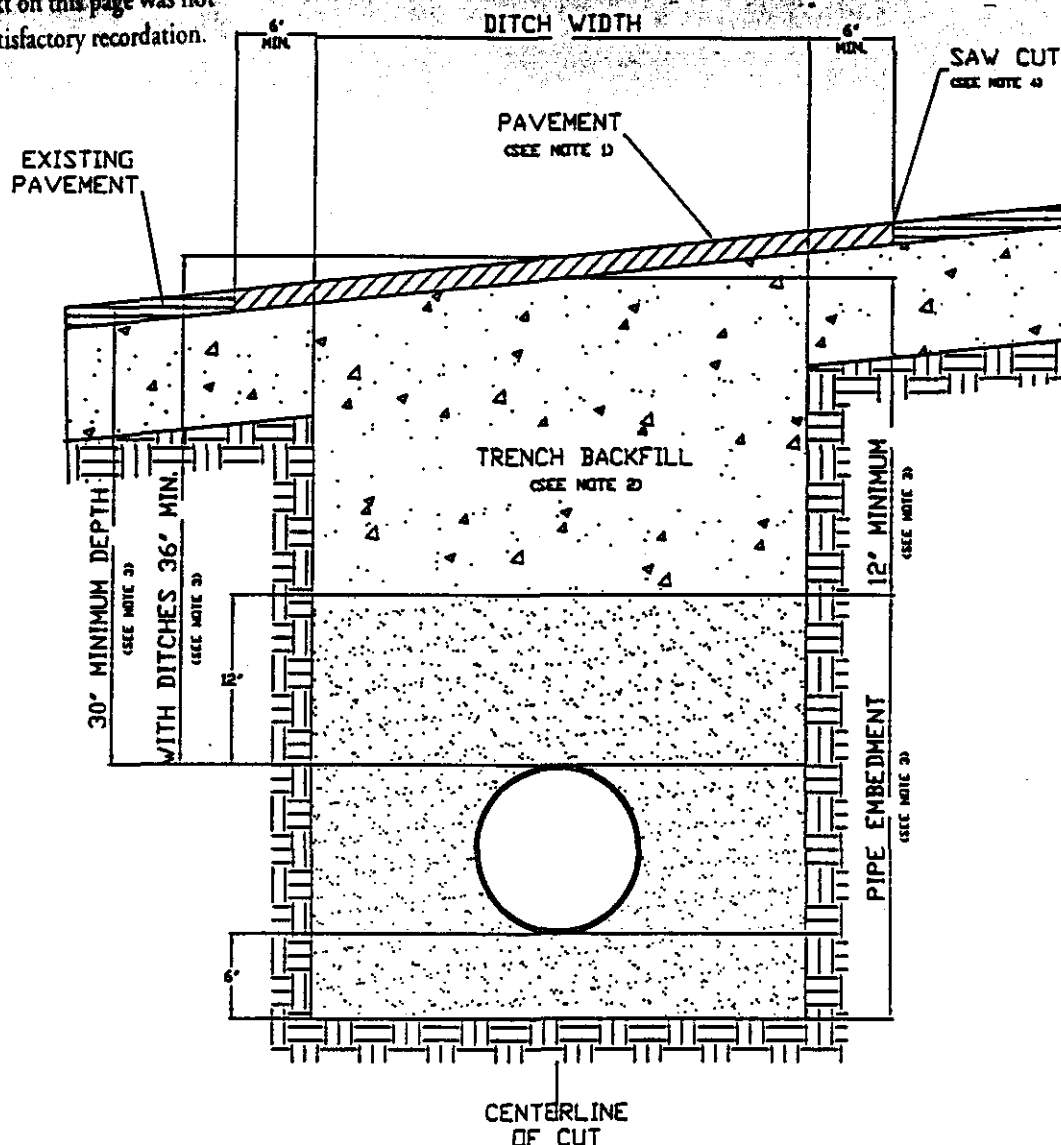

1. Hot mix asphalt 1 1/2" min. thickness. Roll in place to match existing surface, + or - 1/8" tolerance.
2. Trench backfill shall be flexible base, compacted to 95% optimum in 8" layers unless otherwise approved and specified. Flexible base to match existing base thickness or 8 inches, whichever is greater (specifications; TxDOT Item 247, Type A, Grade 2).
3. Pipe embedment (pipe envelope) size and materials shall be as specified elsewhere by utility company and/or its engineers. Pipe depth shall be as specified elsewhere provided that minimum depths are met.
4. Saw cut shall be made prior to ditch cut. If pavement is damaged during cut, a new saw cut shall be made beyond the damaged area and new pavement placed.
5. Where roadside ditches (bar ditches) are crossed by the utility pipe, minimum depth to the top of the pipe from centerline road elevation will be 36".
6. All pavement repair shall conform to Item 351 Repairing Existing Flexible Pavement Structure as found in the 1993 Texas Department of Transportation Standard Specifications for Construction of Highways, Streets and Bridges.

NOTICE OF PROPOSED INSTALLATION

UTILITY LINE ON WILLIAMSON COUNTY RIGHT-OF-WAY

TO: Williamson County Unified Road System
1900 Georgetown Inner Loop, Suite B
Georgetown, Texas 78626

DATE: 8-22-00

Formal notice is hereby given that TXU ELECTRIC AND GAS

Company proposes to place a ELECTRIC DISTRIBUTION AND NATURAL GAS

line within the right-of-way of CHANDLER ROAD
as follows: (give location, length, general design, etc.)

CHANDLER ROAD & ORION ST.

APPROXIMATELY 100 FT IN LENGTH

BORE A 6" P.V.C. ELECTRIC DISTRIBUTION AND A 6" Poly GAS MAIN UNDER CHANDLER ROAD, MINIMUM COVERAGE OF 36" TO TOP OF P.V.C. AND Poly PIPE

The line will be constructed and maintained on the road right-of-way as directed by the Williamson County Unified Road System in accordance with governing laws.

Our firm further understands that the County considers proper traffic control measures as those complying with applicable portions of the Texas Manual of Traffic Control Devices required for adoption by the "Transportation Code" (V.C.T.A. CH.251)

The location and description of the proposed line and appurtenances is more fully shown by 1 copies of drawings attached to this notice.

Construction of this line is proposed to begin on or after the 31 day of September ~~19~~ 2000

APPROVAL

This application is hereby approved subject to the following understandings and restrictions.

It is expressly understood that the said County Commissioners' Court does not imply hereby to grant any right, claim, title or easement in or upon this County Road; and it is further understood that in the future, should Williamson County, for any reason, need to work, improve, relocate, widen, increase, add to, decrease, or in any manner change the structure of this road or right-of-way, this line, if affected, will be moved at the direction of the Williamson County Engineer or County Commissioner. This installation work shall not damage any part of the roadway and adequate provisions shall be made to cause a minimum of inconvenience to traffic and adjacent property owners.

APPROVED BY WILLIAMSON COUNTY COMMISSIONERS' COURT

BY: Aug. Beise
COUNTY CLERK ADMINISTRATOR

DATE: 8/23/00

Firm: TXU ELECTRIC AND GAS

Les Davis
Authorized Signature

Les DAVIS

Printed Name

Address: 3620 FRANKLIN AVE

WACO, TX 76710

Phone: 254-750-5244

Fax: 254-750-5252

8-24-00

Bore

R.J.

Form No. 901



FIELD SKETCH

W.A. No. _____

Preliminary No. or Project No. 1173615 Map No. _____ Sheet No. _____ ER No. _____
Scale N.T.S. Town or County Williamson

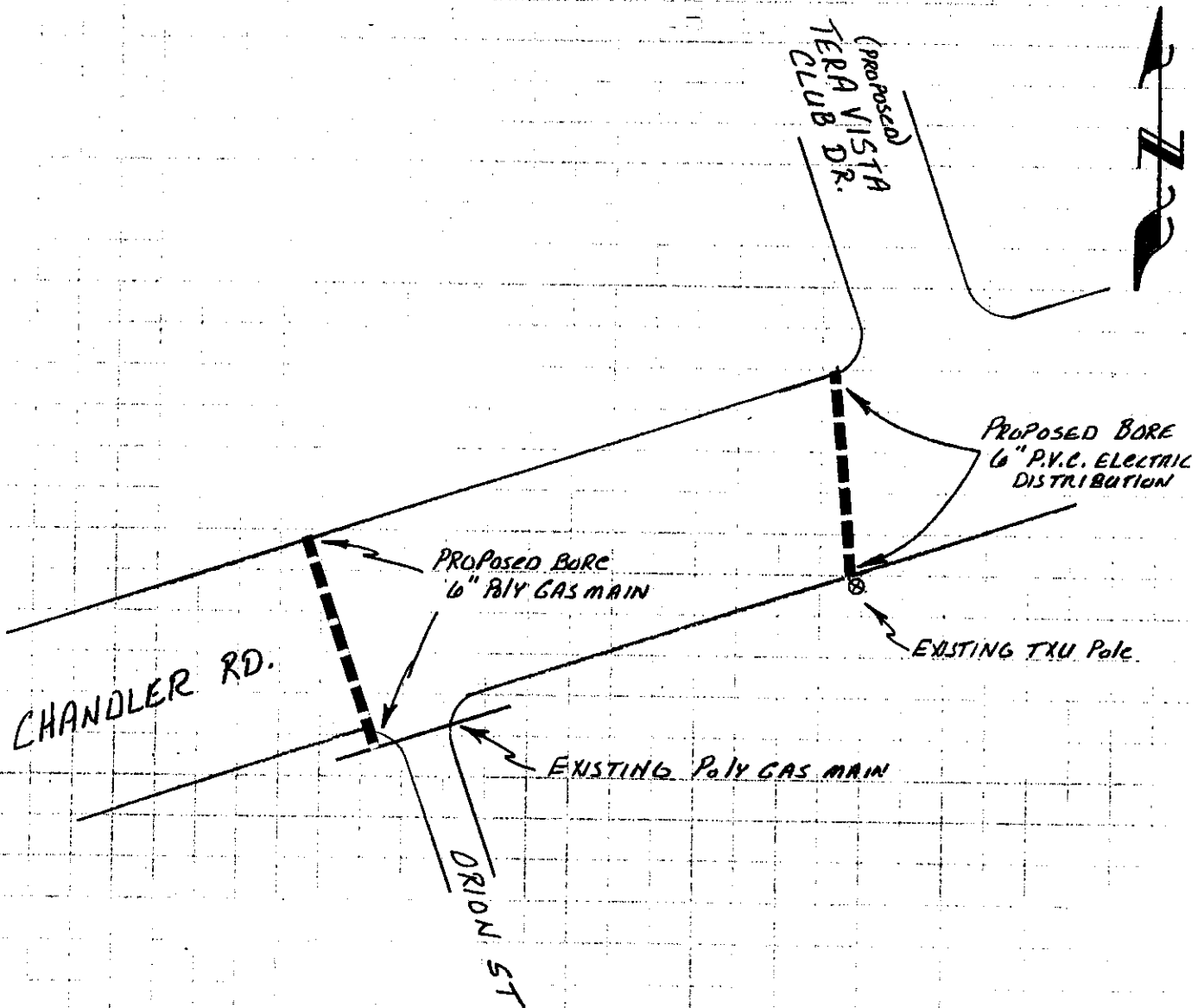

NOTICE OF PROPOSED INSTALLATION

UTILITY LINE ON WILLIAMSON COUNTY RIGHT-OF-WAY

70

TO: Williamson County Unified Road System
1900 Georgetown Inner Loop, Suite B
Georgetown, Texas 78626

DATE: 8-17-2000

RECORDERS MEMORANDUM

All or parts of the text on this page was not
clearly legible for satisfactory recordation.

Formal notice is hereby given that TXU GAS CO.Company proposes to place a 2 IN. GAS MAIN

Line within the right-of-way of GREAT OAKS DR.
as follows: (give location, length, general design, etc.)

BEGINNING AT THE SOUTHWEST CORNER OF THE INTERSECTION
OF GREAT OAKS DRIVE AND DARK LN. AND EXTENDING NORTHERLY
TO THE CENTER MEDIAN OF GREAT OAKS TO TIE INTO AN
EXISTING 8 IN. GAS MAIN.

TO BE ACCOMPLISHED BY AN UNDERGROUND BORE OF APPROX.
50 FT.

The line will be constructed and maintained on the road right-of-way as directed by the Williamson County
Unified Road System in accordance with governing laws.

Our firm further understands that the County considers proper traffic control measures as those complying
with applicable portions of the Texas Manual of Traffic Control Devices required for adoption by the
"Transportation Code" (V.C.T.A. CH.251)

The location and description of the proposed line and appurtenances is more fully shown by 2 copies of
drawings attached to this notice.

Construction of this line is proposed to begin on or after the 17TH day of AUGUST 2000

APPROVAL

This application is hereby approved subject to the
following understandings and restrictions.

It is expressly understood that the said County
Commissioners' Court does not imply hereby to
grant any right, claim, title or easement in or upon
this County Road; and it is further understood that
in the future, should Williamson County, for any
reason, need to work, improve, relocate, widen,
increase, add to, decrease, or in any manner change
the structure of this road or right-of-way, this line,
if affected, will be moved at the direction of the
Williamson County Engineer or County Commissioner.
This installation work shall not damage any part of the
roadway and adequate provisions shall be made to
cause a minimum of inconvenience to traffic and adjacent
property owners.

APPROVED BY WILLIAMSON COUNTY COMMISSIONERS' COURT

BY: [Signature]
COUNTY ROAD ADMINISTRATORDATE: 8/24/00Firm: TXU GASPaul Case

Authorized Signature

PAUL CASE

Printed Name

Address: 3110 N. IH 35ROUND ROCK, TX. 78681Phone: 310-3810Fax: 310-3819RECEIVED AUG 22 2000 Pct. 38-23-00R.J.

Pedro SS Contractor for TXD
in Williamson County, Texas do hereby agree to the following schedules and conditions for doing work within
the right-of-way of Dick Ln & Great Oaks Dr which is a public roadway
maintained by Williamson County.

71

CONTRACT MEMORANDUM

1. I will contact the Williamson County Unified Road System at least 48 hours prior to start of construction.
2. All work in the right-of-way will be done between the hours of 8:30 a.m. and 4:30 p.m. on Monday through Friday only.
3. Cuts will be opened for one-half the roadway only, with flagmen on both sides of the work area, allowing one-way traffic through. This type of operation will be held to a minimum and all advance warning signs and barricades shall be as specified in the Texas Manual on Uniform Traffic Control Devices. These cuts will also be filled and entire roadway opened at night and on weekends.
4. Roadside work in ditches alongside the trenched surface may be left opened at night, only if they can be barricaded solidly between open ditch and traveled roadway leaving a minimum 6' of road shoulder between the pavement edge and the barricades. The barricades must be reflectorized and lighted with warning lights and conform to the requirements of the T.M.U.T.C.D. for nighttime use.
5. Any construction area to be maintained from dusk to dawn shall have Type B High Intensity Steady Burn Warning Lights to delineate the traveled way through and around obstructions in a construction or maintenance area. All warning lights shall be installed to a minimum mounting height of 36" to the bottom of the lense.
6. Construction work and road repair on County right-of-way will be done to Williamson County Standards and to the approval of the Williamson County Unified Road System.
7. I will notify the Williamson County Unified Road System and obtain approval prior to any changes from this agreement if required due to soil conditions or other problems.

8-18-00
DATE

Williamson County Unified Road System
1900 Georgetown Inner Loop, Ste. B
Georgetown, Texas 78626

Paul J. L.
SIGNED

Pedro SS
CONTRACTOR (PRINT NAME)

2415 W. 10th St
ADDRESS

Austin Tx 78703
CITY, STATE, ZIP CODE

476-4518
PHONE

All or parts of the text on this page was not clearly legible for satisfactory recordation.

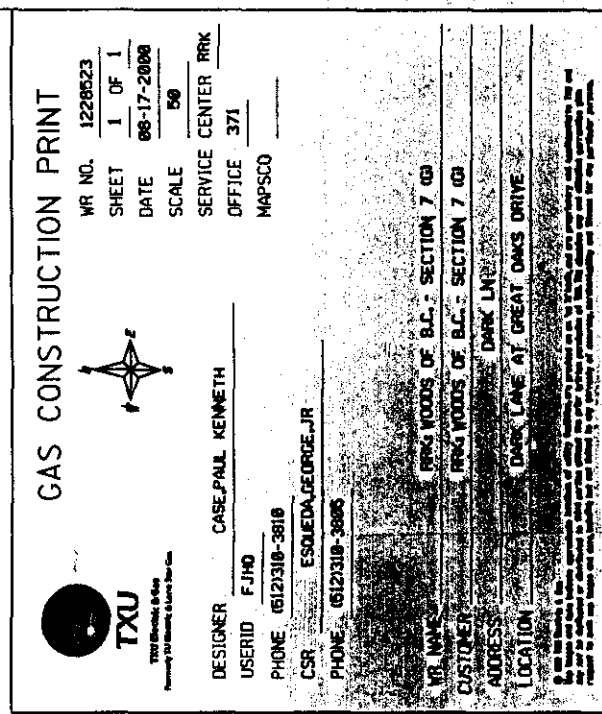

NOTICE OF PROPOSED INSTALLATION

UTILITY LINE ON WILLIAMSON COUNTY RIGHT-OF-WAY

TO: Williamson County Unified Road System
1900 Georgetown Inner Loop, Suite B
Georgetown, Texas 78626

DATE: August 21, 2000

RECORDERS MEMORANDUM

Formal notice is hereby given that Central Telephone Company of Texas

All or parts of the text on this page was not
clearly legible for satisfactory recordation.

Company proposes to place a buried telephone cable

line within the right-of-way of CR 136 (Mager Ln.)
as follows: (give location, length, general design, etc.)

Beginning at the intersection of CR 136 & CR 132, a buried telephone cable in the south R.O.W. of CR 136, continuing approx. 2,000 feet to the east to Telco Ped. # 1010-34, at a depth of 30 inches, 4 feet from the rear of the R.O.W.

The line will be constructed and maintained on the road right-of-way as directed by the Williamson County Unified Road System in accordance with governing laws.

Our firm further understands that the County considers proper traffic control measures as those complying with applicable portions of the Texas Manual of Traffic Control Devices required for adoption by the "Transportation Code" (V.C.T.A. CH.251)

The location and description of the proposed line and appurtenances is more fully shown by 2 copies of drawings attached to this notice.

Construction of this line is proposed to begin on or after the 11th day of September 20 00

APPROVAL

This application is hereby approved subject to the following understandings and restrictions. It is expressly understood that the said County Commissioners' Court does not imply hereby to grant any right, claim, title or easement in or upon this County Road; and it is further understood that in the future, should Williamson County, for any reason, need to work, improve, relocate, widen, increase, add to, decrease, or in any manner change the structure of this road or right-of-way, this line, if affected, will be moved at the direction of the Williamson County Engineer or County Commissioner. This installation work shall not damage any part of the roadway and adequate provisions shall be made to cause a minimum of inconvenience to traffic and adjacent property owners.

APPROVED BY WILLIAMSON COUNTY COMMISSIONERS' COURT

BY: [Signature]
COUNTY ROAD ADMINISTRATOR

DATE: 8/28/00

Firm: Central Telephone Company of Texas

By: [Signature]

Janice Strickland

Title: Network Engineer

Address: 1214 Dogwood Blvd.

P. O. Box 1150

Killeen, Texas 76540

Phone: 254-690-9370

Fax: 254-690-9815

received
8-23-00

8-25-00

RDW

20-1

CONTRACTOR'S LIABILITY AGREEMENT

74

I, Larry Parker, Contractor for Central Telephone Co. of Texas in Williamson County, Texas do hereby agree to the following schedules and conditions for doing work within the right-of-way of CR 136 (Mager Ln.) which is a public roadway maintained by Williamson County.

1. I will contact the Williamson County Unified Road System at least 48 hours prior to start of construction.
2. All work in the right-of-way will be done between the hours of 8:30 a.m. and 4:30 p.m. on Monday through Friday only.
3. Cuts will be opened for one-half the roadway only, with flagmen on both sides of the work area, allowing one-way traffic through. This type of operation will be held to a minimum and all advance warning signs and barricades shall be as specified in the Texas Manual on Uniform Traffic Control Devices. These cuts will also be filled and entire roadway opened at night and on weekends.
4. Roadside work in ditches alongside the trenched surface may be left opened at night, only if they can be barricaded solidly between open ditch and traveled roadway leaving a minimum 6' of road shoulder between the pavement edge and the barricades. The barricades must be reflectorized and lighted with warning lights and conform to the requirements of the T.M.U.T.C.D. for nighttime use.
5. Any construction area to be maintained from dusk to dawn shall have Type B High Intensity Steady Burn Warning Lights to delineate the traveled way through and around obstructions in a construction or maintenance area. All warning lights shall be installed to a minimum mounting height of 36" to the bottom of the lense.
6. Construction work and road repair on County right-of-way will be done to Williamson County Standards and to the approval of the Williamson County Unified Road System.
7. I will notify the Williamson County Unified Road System and obtain approval prior to any changes from this agreement if required due to soil conditions or other problems.

8/21/00

DATE

Williamson County Unified Road System
1900 Georgetown Inner Loop, Ste. B
Georgetown, Texas 78626

SIGNED

LARRY PARKER
CONTRACTOR (PRINT NAME)

PO Box 266
ADDRESS

FLORANCE TX 76527
CITY, STATE, ZIP CODE

254-293-3603
PHONE

RECORDERS MEMORANDUM

All or parts of the text on this page was not
suitable for satisfactory recordation.



3010 LBJ Freeway, Suite 335 • Dallas, TX 75234

LICENSE AND PERMIT BOND

(For County, City, Town or Village Only)

RECORDERS MEMORANDUM Bond No. RSB- 571436

Know All Men By These Presents:

That we Isbell Construction, Inc.
of the city of Florence, State of Texas as Principal,
and the RLI Insurance Company, a corporation duly licensed to do business in the state of Texas, as

Surety, are held and firmly bound unto the Williamson County Unified Road System
(Valid only when a County, City, Town or Village is named as Obligor)
State of Texas, Obligor, in penal sum of two thousand (\$ 2,000.00) DOLLARS.
(Not valid if filed in for more than \$25,000)

lawful money of the United States, to be paid to the said Obligor, for which payment well and truly to be made, we bind ourselves and our legal representatives, jointly and severally by these presents.

THE CONDITION OF THE ABOVE OBLIGATION IS SUCH, that whereas, the said Principal has been licensed as street cutting contractor by the Obligor.

NOW, THEREFORE, if the said Principal shall faithfully perform the duties and in all things comply with the laws and ordinances, including all Amendments thereto, pertaining to the license or permit applied for, then this obligation to be void, otherwise to remain in full force and effect until November 12, 19 98, unless renewed by Continuation Certificate.

This bond may be terminated at any time by the Surety upon sending written notice to the clerk of the Political Subdivision with whom this bond is filed and to the Principal, addressed to them at their first known address, and at the expiration of thirty-five (35) days from the mailing of said notice, or as soon thereafter as permitted by applicable law, whichever is later, this bond shall ipso facto terminate and the Surety shall thereupon be relieved from any liability for any acts or omissions of the Principal subsequent to said date.

Dated this 12th day of November, 19 97.

[Signature]
Principal
(Individual, Partner or Corporate Officer)

[Signature]
Principal
(Additional Partner or Partners)

Countersigned

By [Signature]
Resident Agent

RLI INSURANCE COMPANY

By [Signature]
Jonathan E. Michael, President

Acknowledgement of Surety (Corporate Officer)

STATE OF ILLINOIS)
) SS
County of Peoria)

On this _____ day of _____, 19____, before me, the undersigned officer, personally appeared Jonathan E. Michael, who acknowledged himself to be the aforesaid officer of the RLI Insurance Company, a corporation, and that he as such officer, being authorized so to do, executed the foregoing instrument for the purpose therein contained, by signing the name of the corporation by himself as such officer.

IN WITNESS WHEREOF, I have hereunto set my hand and official seal.

Complaint Notice: Should any dispute arise about your premiums or about a claim that you have filed, contact the agent or write to the issuer of this bond, RLI Insurance Company. If the problem is not resolved, you may also write the State Board of Insurance, Department C, 1110 San Jacinto, Austin, Texas 78786. This notice of complaint procedure is for information only and does not become part or condition of this bond.

OFFICIAL SEAL
Shelly L. Moore
Notary Public, State of Illinois
My Commission Expires 8/31/98

[Signature]
Notary Public

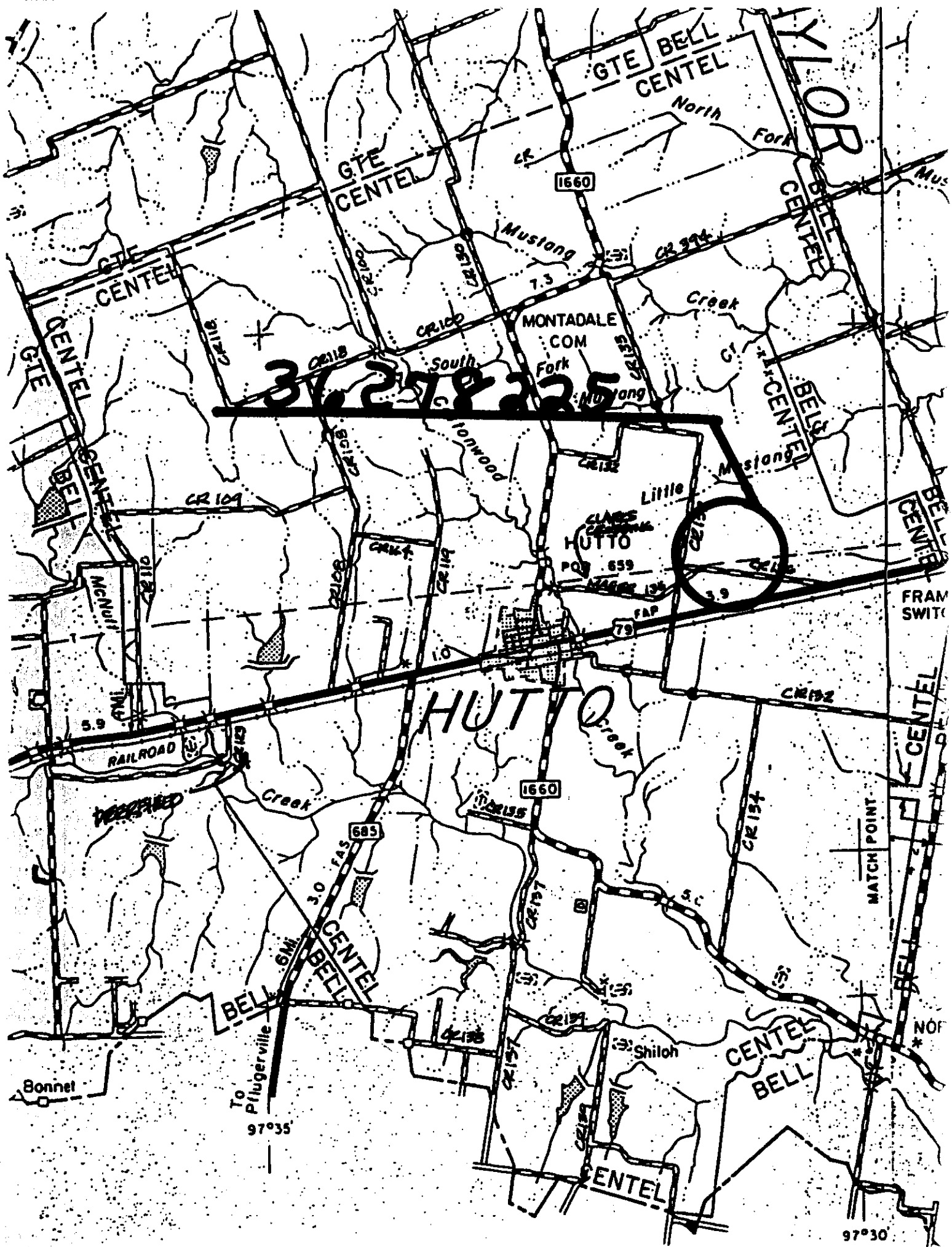



all or parts of the text on this page was not clearly legible for satisfactory recordation.

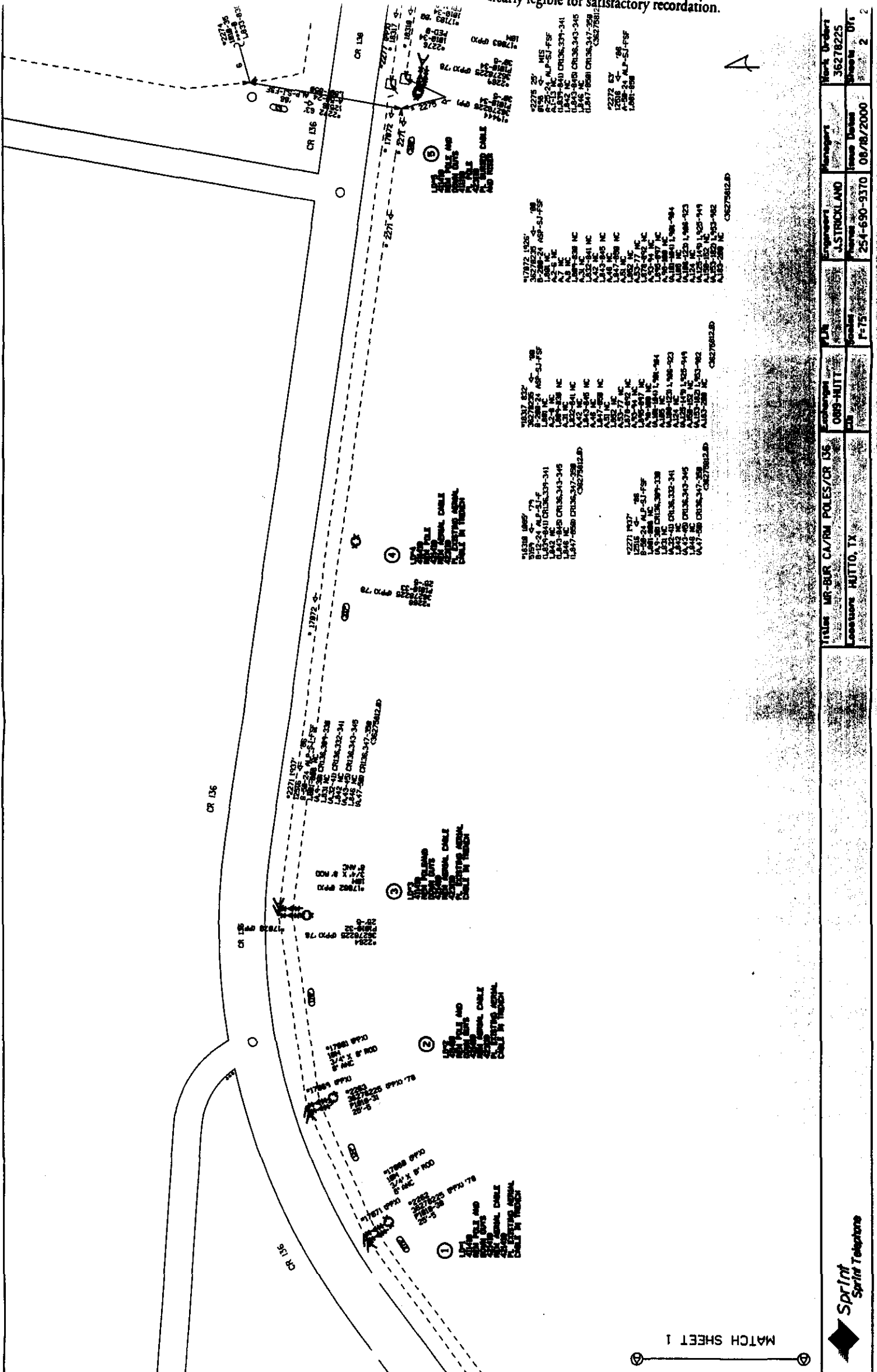

White Tail

79

NOTICE OF PROPOSED INSTALLATION
UTILITY LINE ON WILLIAMSON COUNTY RIGHT-OF-WAY

TO: Williamson County Unified Road System
1900 Georgetown Inner Loop, Suite B
Georgetown, Texas 78626

DATE: 8-22-00

RECORDERS MEMORANDUM

Formal notice is hereby given that SOUTHWESTERN BELL TELEPHONE

All or parts of the text on this page was not
clearly legible for satisfactory recordation.

Company proposes to place a BURIED CABLE

line within the right-of-way of DEER DRAW
as follows: (give location, length, general design, etc.)

STARTING AT PATRICIA RD TRAVELING WEST ON THE NORTH SIDE OF
DEER DRAW FOR APPROXIMATELY 1500'

The line will be constructed and maintained on the road right-of-way as directed by the Williamson County Unified Road System in accordance with governing laws.

Our firm further understands that the County considers proper traffic control measures as those complying with applicable portions of the Texas Manual of Traffic Control Devices required for adoption by the "Transportation Code" (V.C.T.A. CH.251)

The location and description of the proposed line and appurtenances is more fully shown by 3 copies of drawings attached to this notice.

Construction of this line is proposed to begin on or after the 30 day of AUGUST, 2000

APPROVAL

This application is hereby approved subject to the following understandings and restrictions.

It is expressly understood that the said County Commissioners' Court does not imply hereby to grant any right, claim, title or easement in or upon this County Road; and it is further understood that in the future, should Williamson County, for any reason, need to work, improve, relocate, widen, increase, add to, decrease, or in any manner change the structure of this road or right-of-way, this line, if affected, will be moved at the direction of the Williamson County Engineer or County Commissioner. This installation work shall not damage any part of the roadway and adequate provisions shall be made to cause a minimum of inconvenience to traffic and adjacent property owners.

APPROVED BY WILLIAMSON COUNTY COMMISSIONERS' COURT

BY: [Signature]
COUNTY ROAD ADMINISTRATOR

DATE: 8/22/00

Firm: SWBT

[Signature]
Authorized Signature

KEVIN J. AZZARELLO

Printed Name

Address: 1616 GUADALUPE

AUSTIN TX 78701

Phone: (512) 870-6708

Fax: (512) 870-3305

RECEIVED AUG 28 2000 *Pct. 3*

8-28-00

R.J.

Consent Agenda

The Consent Agenda includes non-controversial and routine items that the Court may act on with one single vote. The Judge or a Commissioner may pull any item from the Consent Agenda in order that the court discuss and act upon it individually as part of the Regular Agenda.

(Items 5-18)

AGENDA ITEM 5

Consider approving line item transfer for Sheriff Department:

from: 0100-0560-003530	Law Enforcement Equip	2500.00
to: 0100-0560-005000	Capital Outlay	2500.00

Moved: **Commissioner Heiligenstein**

Seconded: **Commissioner Hays**

Motion: To approve line item transfer for Sheriff Department:

from: 0100-0560-003530	Law Enforcement Equip	2500.00
to: 0100-0560-005000	Capital Outlay	2500.00

Vote: Motion carried 5 – 0

< Clerk copy here >