

#### **AGENDA ITEM 4**

**Consider noting in minutes any off right-of-way work on any County road done by Road & Bridge Unified System.**

**Moved: Judge Doerfler**

**Seconded: Commissioner Hays**

**Motion:** To note off right-of-way work on County Road 384 clearing debris from culvert on adjacent property of **Juan Davila-Antonio** to open drainage and utility requests from:

**Brushy Creek MUD** for road cut on Monument Drive between Arrowhead and Cornerstone;

**Chisholm Trail S.U.D.** for bore on Helm Road in North Lake Subdivision;

**GTE** for bore in right-of-way of County Road 234;

**City of Georgetown** for road cut and right-of-way of Clearview Drive and right-of-way for Booty's Crossing Road;

**Jonah Water S.U.D.** for bore on County Road 100 between County Roads 106 and 130 and road cut on County Road 135;

**Southwestern Bell Telephone Company** for bores and road cuts on Lake Creek Parkway, Pecan Creek Parkway, El Salido Parkway and Anderson Mill Road and

**Verizon** usage of right-of-way on County Road 152.

**Vote:** Motion carried 3 – 0 with Commissioners Heiligenstein and Boatright absent from the dais.

< Clerk copy here >

August 15, 2000

UNIFIED ROAD SYSTEM  
OFF RIGHT-OF-WAY WORK

1. CR 384 - Clearing debris from culvert in the ROW and on the adjacent property of Juan Davila-Antonio to open drainage. (A.S. - Pct. 4)

**WILLIAMSON COUNTY URS**  
Utility Requests - 08/15/00

**Precinct I**

**Precinct II**

- A. SWBT
  1. Lake Creek Pkwy., Pecan Creek Pkwy. & El Salido Pkwy. - Bore & Road cut
  2. Pecan Creek Pkwy. & Anderson Mill Rd. - ROW & Road cut
- B. The City of Georgetown
  1. Clearview Drive - Road cut & ROW

**Precinct III**

- A. Chisholm Trail S.U.D.
  1. Helm Road (North Lake) - Bore
- B. Brushy M.U.D.
  1. Monument Drive between Arrowhead & Cornerstone - Road cut
- C. Verizon
  1. CR 152 - ROW
- D. The City of Georgetown
  1. Booty's Crossing Road - ROW
- E. GTE
  1. CR 234 - Bore & ROW

**Precinct IV**

- A. Jonah Water S.U.D.
  1. CR 100 ( between CR 130 & CR 106 - Bore
- B. Jonah Water S.U.D.
  1. CR 135 - Road cut

*noted 8-15-00*  
*John C. Daugherty*

## NOTICE OF PROPOSED INSTALLATION

## UTILITY LINE ON WILLIAMSON COUNTY RIGHT-OF-WAY

TO: Williamson County Unified Road System  
3151 S. E. Inner Loop, Suite B  
Georgetown, Texas 78626

DATE: 8-3-00

Formal notice is hereby given that Jim Utilities Brushy Creek M.U.D.

Company proposes to ~~place a~~ replace a 6" Gravity wastewater line

Line within the right-of-way of Monument dr. between Arrowhead and Cornerstone  
as follows: (give location, length, general design, etc.)

The line will be constructed and maintained on the road right-of-way as directed by the Williamson County Unified Road System in accordance with governing laws.

Our firm further understands that the County considers proper traffic control measures as those complying with applicable portions of the Texas Manual of Traffic Control Devices required for adoption by the "Transportation Code" (V.C.T.A. CH.251)

The location and description of the proposed line and appurtenances is more fully shown by      copies of drawings attached to this notice.

Construction of this line is proposed to begin on or after the 3 day of August, 2000.

APPROVAL

This application is hereby approved subject to the following understandings and restrictions.

It is expressly understood that the said County Commissioners' Court does not imply hereby to grant any right, claim, title or easement in or upon this County Road; and it is further understood that in the future, should Williamson County, for any reason, need to work, improve, relocate, widen, increase, add to, decrease, or in any manner change the structure of this road or right-of-way, this line, if affected, will be moved at the direction of the Williamson County Engineer or County Commissioner. This installation work shall not damage any part of the roadway and adequate provisions shall be made to cause a minimum of inconvenience to traffic and adjacent property owners.

APPROVED BY WILLIAMSON COUNTY COMMISSIONERS' COURT

BY: [Signature]  
COUNTY ROAD ADMINISTRATOR

DATE: 8/10/00

Firm: Brushy Creek MUD

[Signature]  
Authorized Signature

A-J. Olson  
Printed Name

Address: 901 Great Oaks dr.

Round Rock Tx. 78681

Phone: (512) 255-7871

Fax: (512) 255-0332

**received**  
8-3-00

Pd. 3

8-8-00

Cut & restore

A-J.

**CONTRACTOR'S LIABILITY AGREEMENT**

I, ROY NOMERDING, Contractor for BRUSHY CREEK MUD DISTRICT  
 in Williamson County, Texas do hereby agree to the following schedules and conditions for doing work within  
 the right-of-way of 3500 BLK. OF MONUMENT DR. which is a public roadway  
 maintained by Williamson County.

1. I will contact the Williamson County Unified Road System at least 48 hours prior to start of construction.
2. All work in the right-of-way will be done between the hours of 8:30 a.m. and 4:30 p.m. on Monday through Friday only.
3. Cuts will be opened for one-half the roadway only, with flagmen on both sides of the work area, allowing one-way traffic through. This type of operation will be held to a minimum and all advance warning signs and barricades shall be as specified in the Texas Manual on Uniform Traffic Control Devices. These cuts will also be filled and entire roadway opened at night and on weekends.
4. Roadside work in ditches alongside the trenched surface may be left opened at night, only if they can be barricaded solidly between open ditch and traveled roadway leaving a minimum 6' of road shoulder between the pavement edge and the barricades. The barricades must be reflectorized and lighted with warning lights and conform to the requirements of the T.M.U.T.C.D. for nighttime use.
5. Any construction area to be maintained from dusk to dawn shall have Type B High Intensity Steady Burn Warning Lights to delineate the traveled way through and around obstructions in a construction or maintenance area. All warning lights shall be installed to a minimum mounting height of 36" to the bottom of the lense.
6. Construction work and road repair on County right-of-way will be done to Williamson County Standards and to the approval of the Williamson County Unified Road System.
7. I will notify the Williamson County Unified Road System and obtain approval prior to any changes from this agreement if required due to soil conditions or other problems.

7-31-00  
 DATE

Williamson County Unified Road System  
 3151 S. E. Inner Loop, Ste. B  
 Georgetown, Texas 78626

Roy Nomerding  
 SIGNED

J.M. UTILITIES  
 CONTRACTOR (PRINT NAME)

701 BRUSHY CREEK RD.  
 ADDRESS

CEDAR PARK TX. 78613  
 CITY, STATE, ZIP CODE

(512) 331-1217  
 PHONE

Advanced Warning Signs  
& Spacing Similar For  
Opposing Traffic.

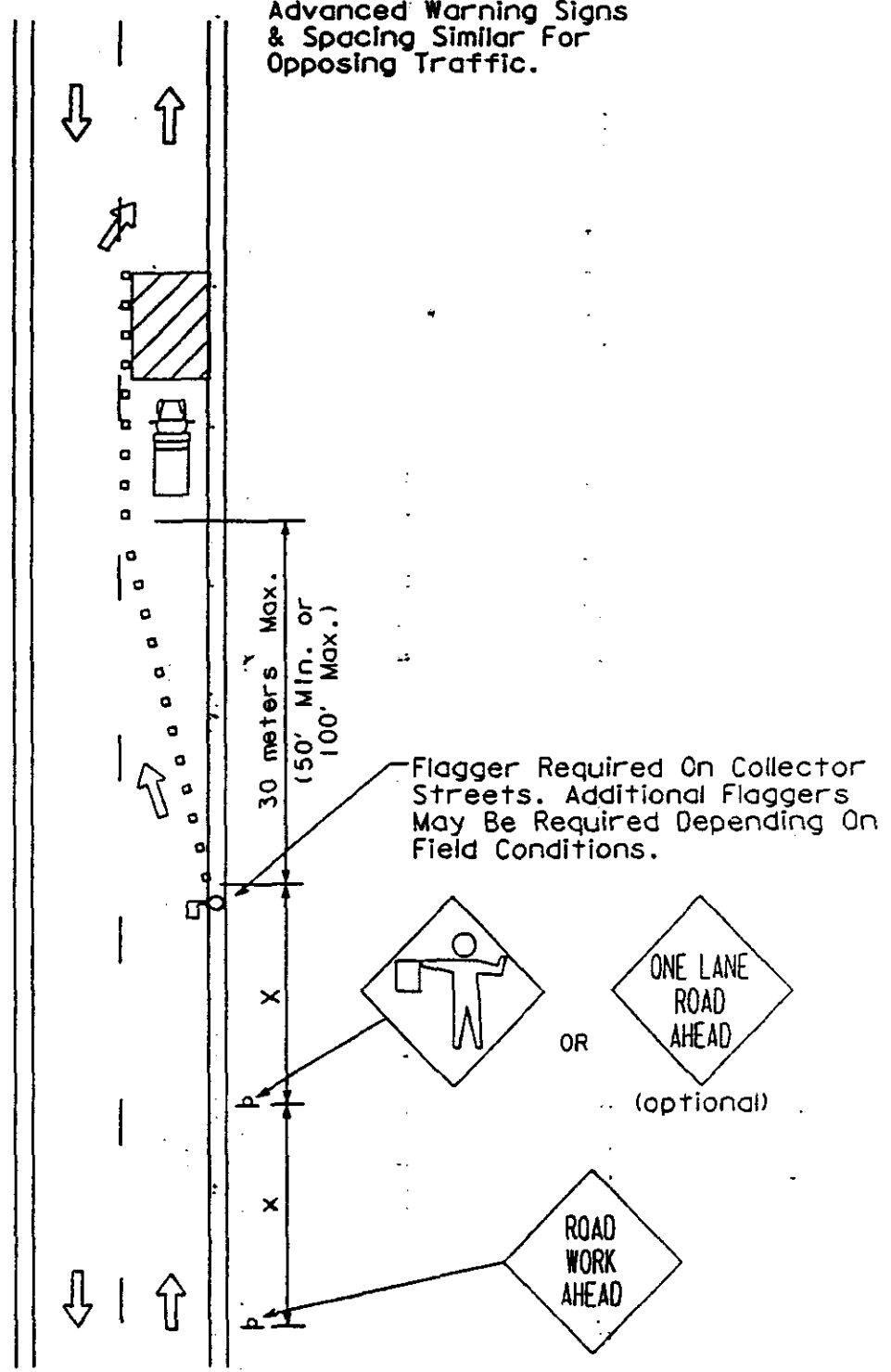

SEE STANDARD DETAIL SHEET  
804-1H FOR GENERAL NOTES  
AND DEVICE SPACING.

DESCRIPTION:

REV. DATE:

CITY OF AUSTIN		COLLECTOR/RESIDENTIAL	
DEPARTMENT OF PUBLIC WORKS & TRANSPORTATION		LANE CLOSURES	
		ADOPTED:	STANDARD NO. 804-1E
		SCALE:	
		INITIAL:	

## PARALLEL UTILITY CUT DESIGN IN WILLIAMSON COUNTY R.O.W.

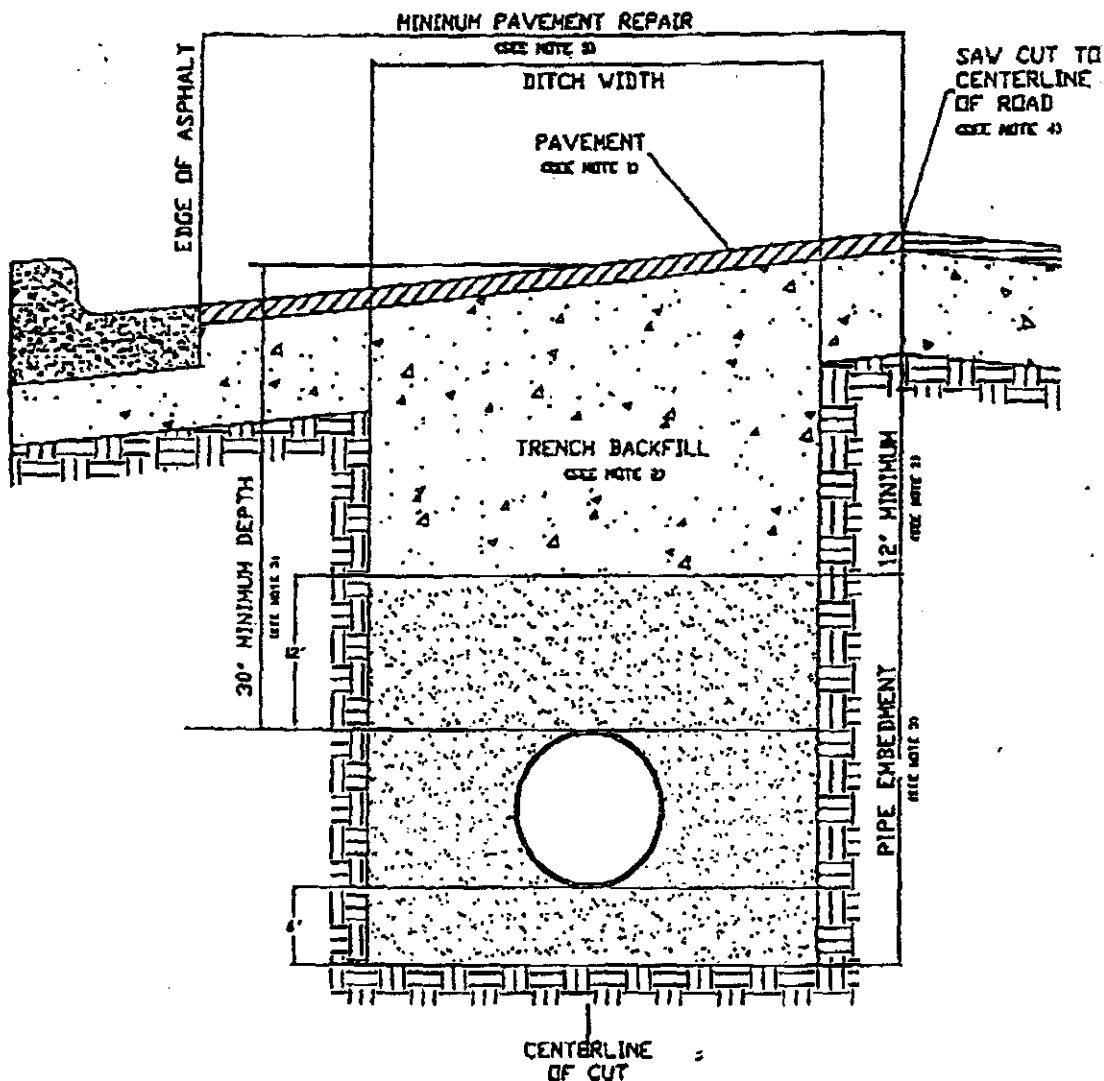

1. Hot mix asphalt to match existing HMA thickness or 2" minimum, whichever is greater. Roll in place to match existing surface, + or - 1/8" tolerance.
2. Trench backfill shall be flexible base, compacted to 95% optimum in 8" layers unless otherwise approved and specified. Flexible base to match existing base thickness or 8", whichever is greater (Specifications: TxDOT Item 247, Type A, Grade 2).
3. Pipe embedment (pipe envelope) size and materials shall be as specified elsewhere by the utility company and/or its engineers. Pipe depth shall be as specified elsewhere provided that minimum depths are met.
4. Saw cut shall be made prior to ditch cut. If pavement is damaged during cut, a new saw cut shall be made beyond the damaged area and new pavement placed.
5. Damage beyond the centerline requires repair over entire roadway width.
6. All pavement repair shall conform to Item 351 Repairing Existing Flexible Pavement Structure as found in the 1993 Texas Department of Transportation Standard Specifications for Construction of Highways, Streets and Bridges.

CONTINUED ON MAP 345

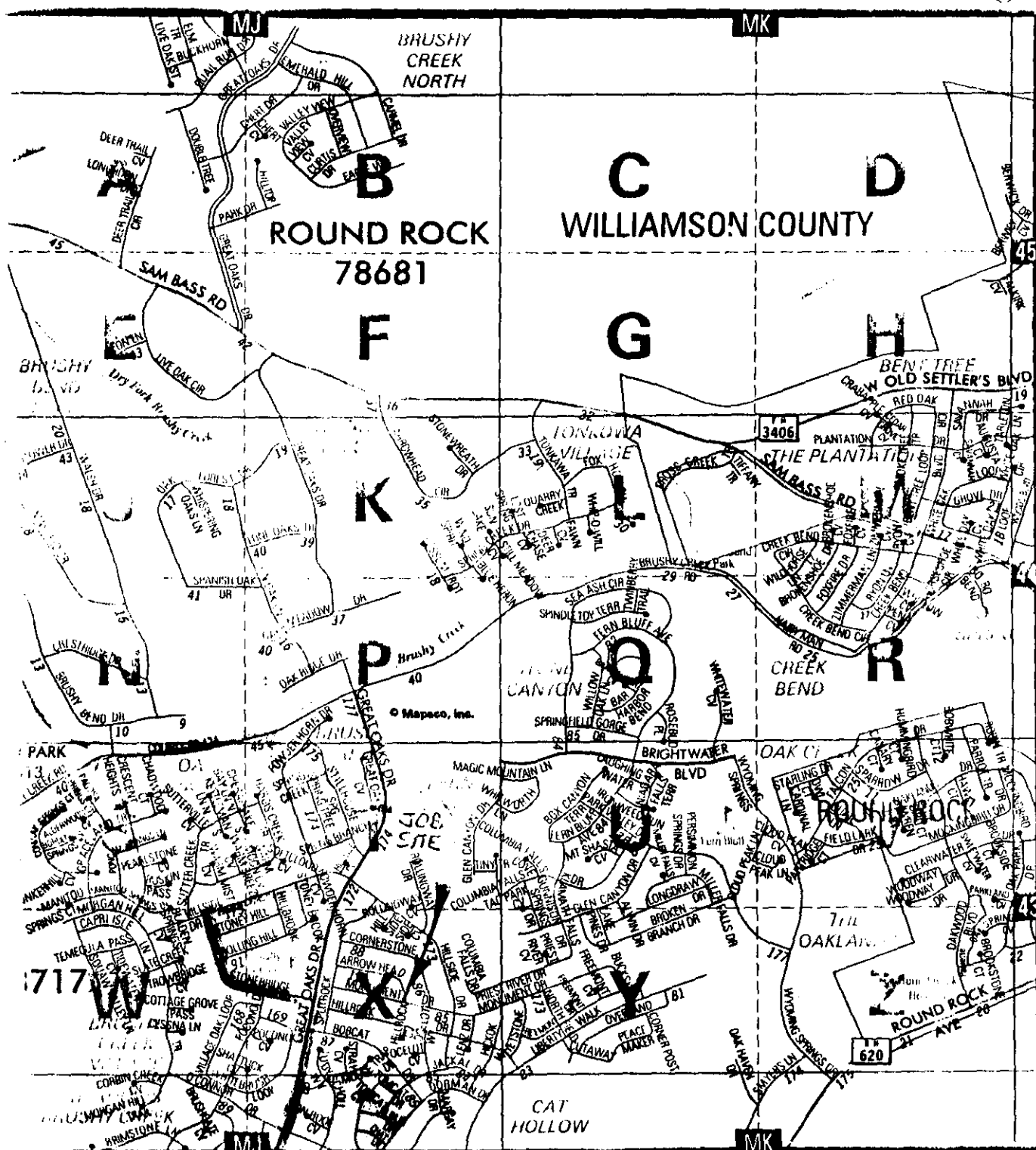

ENCLOSURE ON MAP 374

CONTINUED ON MAP 405

CONTINUED ON MAP 376

IN MILES

SCALE IN FEET

COPYRIGHT 1993, 1999 by MAPSCO, INC. - ALL RIGHTS RESERVED

0                      1000                      2000                      3000

BOOK PAGE 1068

SEWER LINE REPAIR PLAN

ARROWHEAD

TEMP  
SPOKS  
TO BE  
BARRICADED  
WITH LIGHTED  
TYP. 3 BARRICADES

MONUMENT DR.

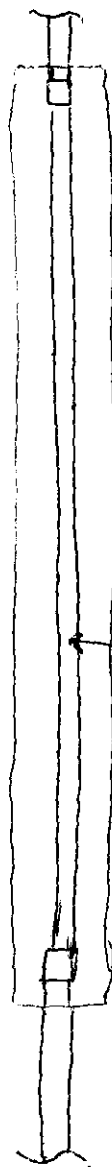

CUT OUT AND REPLACE APPX. 100' EXISTING 6" SEWER  
DUE TO A SAG IN EXISTING PIPE.



Gavornik

NOTICE OF PROPOSED INSTALLATION

UTILITY LINE ON WILLIAMSON COUNTY RIGHT-OF-WAY

ROAD BORE PERMIT

TO: Williamson County Unified Road System  
1900 Georgetown Inner Loop, Suite B  
Georgetown, Texas 78626

DATE: 7/28/00

Formal notice is hereby given that CHISHOLM TRAIL SPECIAL UTILITY DISTRICT

Company proposes to place a 3/4" waterline in a 4" casing

line within the right-of-way of Helm Road -- in the Northlake Subdivision  
as follows: (give location, length, general design, etc.)

The existing waterline is on the West side of Helm Road, approx. 7' from the pavement, buried 28" deep. Width of the pavement is 19' and the depth of the road bore to be made is 36".

Contractor will be Bulls Eye Excavation, Bill Ellis owner.

The line will be constructed and maintained on the road right-of-way as directed by the Williamson County Unified Road System in accordance with governing laws.

Our firm further understands that the County considers proper traffic control measures as those complying with applicable portions of the Texas Manual of Traffic Control Devices required for adoption by the "Transportation Code" (V.C.T.A. CH.251)

The location and description of the proposed line and appurtenances is more fully shown by 2 copies of drawings attached to this notice.

Construction of this line is proposed to begin on or after the 5 day of August ~~XX~~ 2000

APPROVAL

This application is hereby approved subject to the following understandings and restrictions.

It is expressly understood that the said County Commissioners' Court does not imply hereby to grant any right, claim, title or easement in or upon this County Road; and it is further understood that in the future, should Williamson County, for any reason, need to work, improve, relocate, widen, increase, add to, decrease, or in any manner change the structure of this road or right-of-way, this line, if affected, will be moved at the direction of the Williamson County Engineer or County Commissioner. This installation work shall not damage any part of the roadway and adequate provisions shall be made to cause a minimum of inconvenience to traffic and adjacent property owners.

APPROVED BY WILLIAMSON COUNTY COMMISSIONERS' COURT

BY: [Signature]  
COUNTY ROAD ADMINISTRATOR

DATE: 8/8/00

Firm: Chisholm Trail S.U.D.  
Patricia B. Rodgers  
Authorized Signature

Patricia B. Rodgers, General Manager  
Printed Name  
Address: P O Box 249  
Florence, Tx 76527

Phone: 254/793-3103

Fax: 254/793-3100

RECEIVED AUG - 1. 2000 Pct. 3

8-7-00

Bore

R.J.

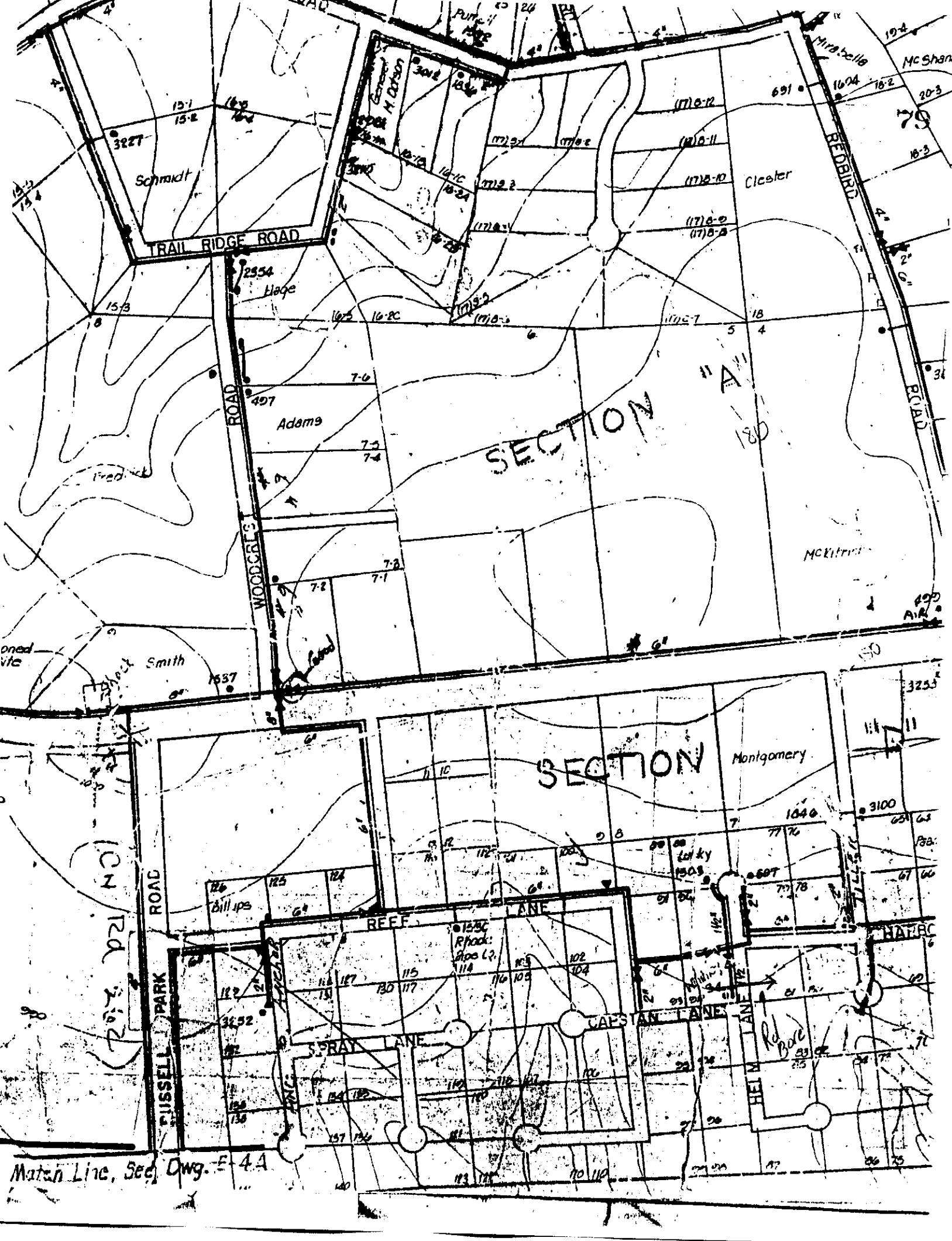

NOTICE OF PROPOSED INSTALLATION  
UTILITY LINE ON WILLIAMSON COUNTY RIGHT-OF-WAY

80

TO: Williamson County Unified Road System  
1900 Georgetown Inner Loop, Suite B  
Georgetown, Texas 78626

DATE: 08-10-00

Formal notice is hereby given that G.T.E.

Company proposes to place a buried copper cable

line within the right-of-way of C.R. 234

as follows: (give location, length, general design, etc.)

beginning 565' North of 2701 CR 234 proceeding in a  
southerly along CR 234 for a distance of 1555'  
then bore CR 234 for 30' East to West then enter  
private property.

The line will be constructed and maintained on the road right-of-way as directed by the Williamson County Unified Road System in accordance with governing laws.

Our firm further understands that the County considers proper traffic control measures as those complying with applicable portions of the Texas Manual of Traffic Control Devices required for adoption by the "Transportation Code" (V.C.T.A. CH.251)

The location and description of the proposed line and appurtenances is more fully shown by 1 copies of drawings attached to this notice.

Construction of this line is proposed to begin on or after the 18 day of Aug. 1900.

APPROVAL

This application is hereby approved subject to the following understandings and restrictions.

It is expressly understood that the said County Commissioners' Court does not imply hereby to grant any right, claim, title or easement in or upon this County Road; and it is further understood that in the future, should Williamson County, for any reason, need to work, improve, relocate, widen, increase, add to, decrease, or in any manner change the structure of this road or right-of-way, this line, if affected, will be moved at the direction of the Williamson County Engineer or County Commissioner. This installation work shall not damage any part of the roadway and adequate provisions shall be made to cause a minimum of inconvenience to traffic and adjacent property owners.

APPROVED BY WILLIAMSON COUNTY COMMISSIONERS' COURT

BY: Greg Bergeron  
COUNTY ROAD ADMINISTRATOR

DATE: 8/15/00

Firm: G.T.E.

Authorized Signature

MIKE CROW

Printed Name

Address: 1700 N. AUSTIN AVE.

GEORGETOWN, TX. 78626

Phone: 512-869-2270

Fax: 512-8692291

Pct. 3

**received**

8-14-00

ROW

&

Bore

R.J.

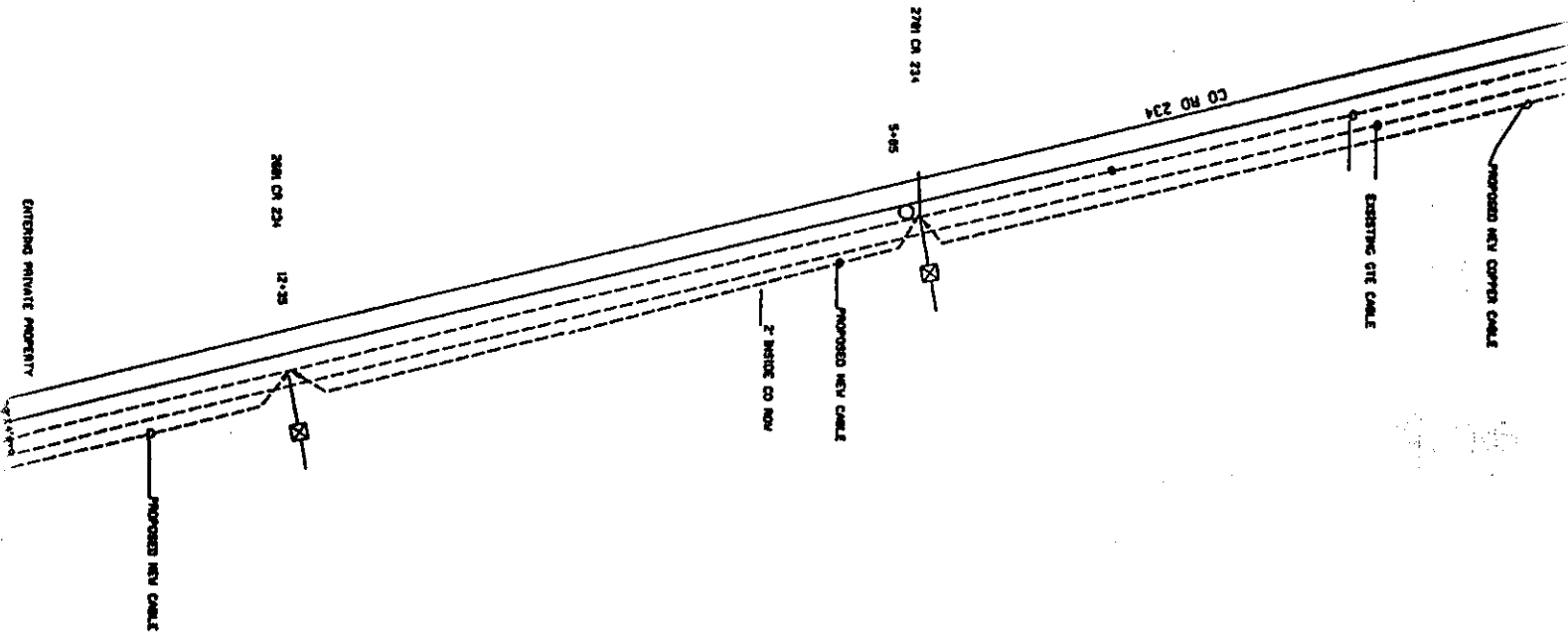

GTE		SII	AREA		STATE: TX
DIVISION: TEXAS AREA		EXCH.: 5437		REM. CD.: 000	
W.C.: 7460	WO NO.: 3P001BX		CONTROL NUMBER:		
TITLE: WmCo PERMIT		TAX DST.:			

NOTICE OF PROPOSED INSTALLATION  
UTILITY LINE ON WILLIAMSON COUNTY RIGHT-OF-WAY

TO: Williamson County Unified Road System  
3151 S. E. Inner Loop, Suite B  
Georgetown, Texas 78626

DATE: \_\_\_\_\_

Formal notice is hereby given that City of Georgetown  
Company proposes to place a 8" water  
Line within the right-of-way of Clear View Drive  
as follows: (give location, length, general design, etc.)

The line will be constructed and maintained on the road right-of-way as directed by the Williamson County Unified Road System in accordance with governing laws.

Our firm further understands that the County considers proper traffic control measures as those complying with applicable portions of the Texas Manual of Traffic Control Devices required for adoption by the "Transportation Code" (V.C.T.A. CH.251)  
The location and description of the proposed line and appurtenances is more fully shown by \_\_\_\_\_ copies of drawings attached to this notice.

Construction of this line is proposed to begin on or after the 10<sup>th</sup> day of August, 2000.

APPROVAL

This application is hereby approved subject to the following understandings and restrictions.

It is expressly understood that the said County Commissioners' Court does not imply hereby to grant any right, claim, title or easement in or upon this County Road; and it is further understood that in the future, should Williamson County, for any reason, need to work, improve, relocate, widen, increase, add to, decrease, or in any manner change the structure of this road or right-of-way, this line, if affected, will be moved at the direction of the Williamson County Engineer or County Commissioner. This installation work shall not damage any part of the roadway and adequate provisions shall be made to cause a minimum of inconvenience to traffic and adjacent property owners.

APPROVED BY WILLIAMSON COUNTY COMMISSIONERS' COURT

BY: [Signature]  
COUNTY ROAD ADMINISTRATOR

DATE: 8/11/00

Firm: City of Georgetown  
David Munk  
Authorized Signature

David Munk  
Printed Name  
Address: 904 S. Main St.  
Georgetown TX 79627-145

Phone: 930-3582

Fax: 930-5892

8-11-00 Pct. 01

ROW  
&  
City and Resident  
P.1 County Platent

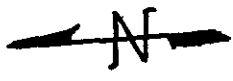

Cloverdale lane

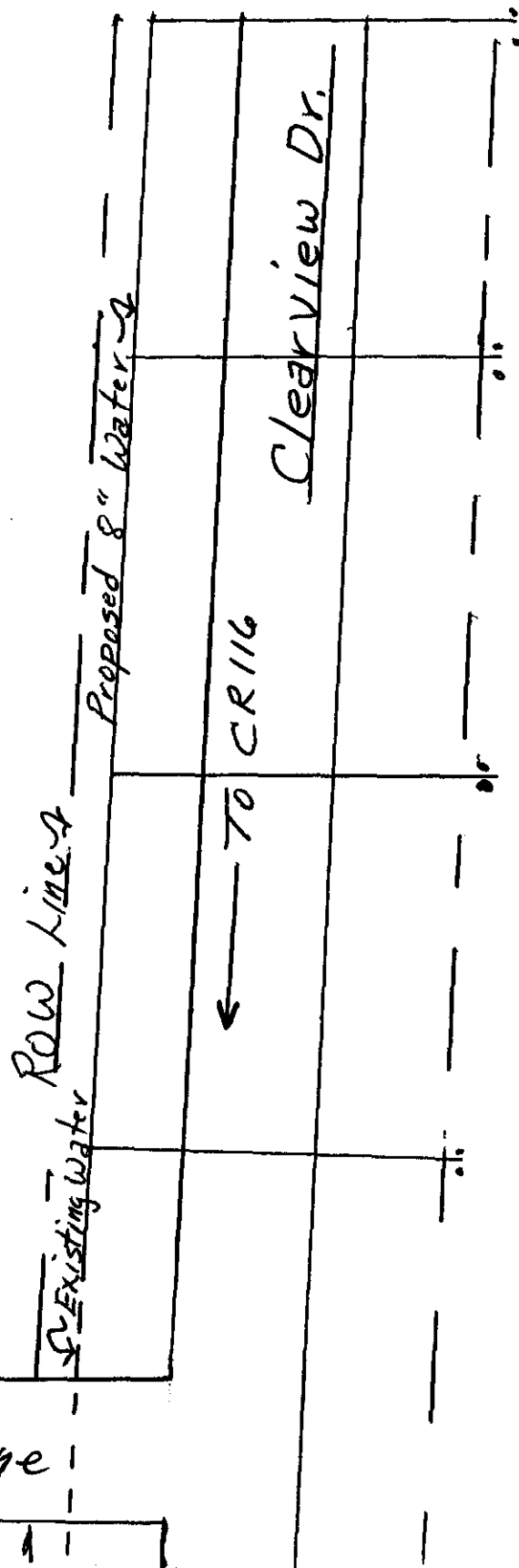

## NOTICE OF PROPOSED INSTALLATION

## UTILITY LINE ON WILLIAMSON COUNTY RIGHT-OF-WAY

TO: Williamson County Unified Road System  
3151 S. E. Inner Loop, Suite B  
Georgetown, Texas 78626

DATE: July 31, 2000

Formal notice is hereby given that The City of Georgetown

Company proposes to place a 8" Water line

Line within the right-of-way of Booty's Crossing Road  
as follows: (give location, length, general design, etc.)

The line will be constructed and maintained on the road right-of-way as directed by the Williamson County Unified Road System in accordance with governing laws.

Our firm further understands that the County considers proper traffic control measures as those complying with applicable portions of the Texas Manual of Traffic Control Devices required for adoption by the "Transportation Code" (V.C.T.A. CH.251)

The location and description of the proposed line and appurtenances is more fully shown by 31st copies of drawings attached to this notice.

Construction of this line is proposed to begin on or after the 31st day of July, 2000.

## APPROVAL

This application is hereby approved subject to the following understandings and restrictions.

It is expressly understood that the said County Commissioners' Court does not imply hereby to grant any right, claim, title or easement in or upon this County Road; and it is further understood that in the future, should Williamson County, for any reason, need to work, improve, relocate, widen, increase, add to, decrease, or in any manner change the structure of this road or right-of-way, this line, if affected, will be moved at the direction of the Williamson County Engineer or County Commissioner. This installation work shall not damage any part of the roadway and adequate provisions shall be made to cause a minimum of inconvenience to traffic and adjacent property owners.

APPROVED BY WILLIAMSON COUNTY COMMISSIONERS' COURT

BY: [Signature]  
COUNTY ROAD ADMINISTRATOR

DATE: 8/10/00

Firm: City of Georgetown

David Munk  
Authorized Signature

David Munk  
Printed Name

Address: 904 S. Main St.

Georgetown TX

78627-1458

Phone: 930-3582

Fax: 930-5892

Pd. 3

8-9-00

R.O.D.

R.J.

Row Line

Boox's Road  
To Georgetown →

Proposed  
Existing





NOTICE OF PROPOSED INSTALLATION

86

UTILITY LINE ON WILLIAMSON COUNTY RIGHT-OF-WAY

TO: Williamson County Unified Road System  
1900 Georgetown Inner Loop, Suite B  
Georgetown, Texas 78626

DATE: 7-28-2000

Formal notice is hereby given that Jonah Water S.U.D.

Company proposes to place a Road Base 12" ENCASUREMENT-6" WATER MAIN

line within the right-of-way of CR 100 - between CR 130 & CR 106  
as follows: (give location, length, general design, etc.)

Road Base on CR 100 - east of 100 & CR 106 intersection  
120ft. Base will be 3' below ditch line on  
North side of CR 100.

The line will be constructed and maintained on the road right-of-way as directed by the Williamson County Unified Road System in accordance with governing laws.

Our firm further understands that the County considers proper traffic control measures as those complying with applicable portions of the Texas Manual of Traffic Control Devices required for adoption by the "Transportation Code" (V.C.T.A. CH.251)

The location and description of the proposed line and appurtenances is more fully shown by 1 copies of drawings attached to this notice.

Construction of this line is proposed to begin on or after the 7<sup>th</sup> day of August 19 2000

APPROVAL

This application is hereby approved subject to the following understandings and restrictions.

It is expressly understood that the said County Commissioners' Court does not imply hereby to grant any right, claim, title or easement in or upon this County Road; and it is further understood that in the future, should Williamson County, for any reason, need to work, improve, relocate, widen, increase, add to, decrease, or in any manner change the structure of this road or right-of-way, this line, if affected, will be moved at the direction of the Williamson County Engineer or County Commissioner. This installation work shall not damage any part of the roadway and adequate provisions shall be made to cause a minimum of inconvenience to traffic and adjacent property owners.

APPROVED BY WILLIAMSON COUNTY COMMISSIONERS' COURT

BY: Ray Fager  
COUNTY ROAD ADMINISTRATOR

DATE: 8/8/00

Firm: Jonah Water S.U.D.

Carl Lidekh  
Authorized Signature

CARL LIDEKH  
Printed Name

Address: 40 CR 126

Georgetown, Tx. 78626

Phone: 863-2235

Fax: 869-5402

Pd. # 8-7-00

Bare  
R.R.

JONAH WATER SPECIAL UTILITY DISTRICT

Rt. 1, Box 112-B  
Georgetown, Texas 78626  
(512) 863-2235

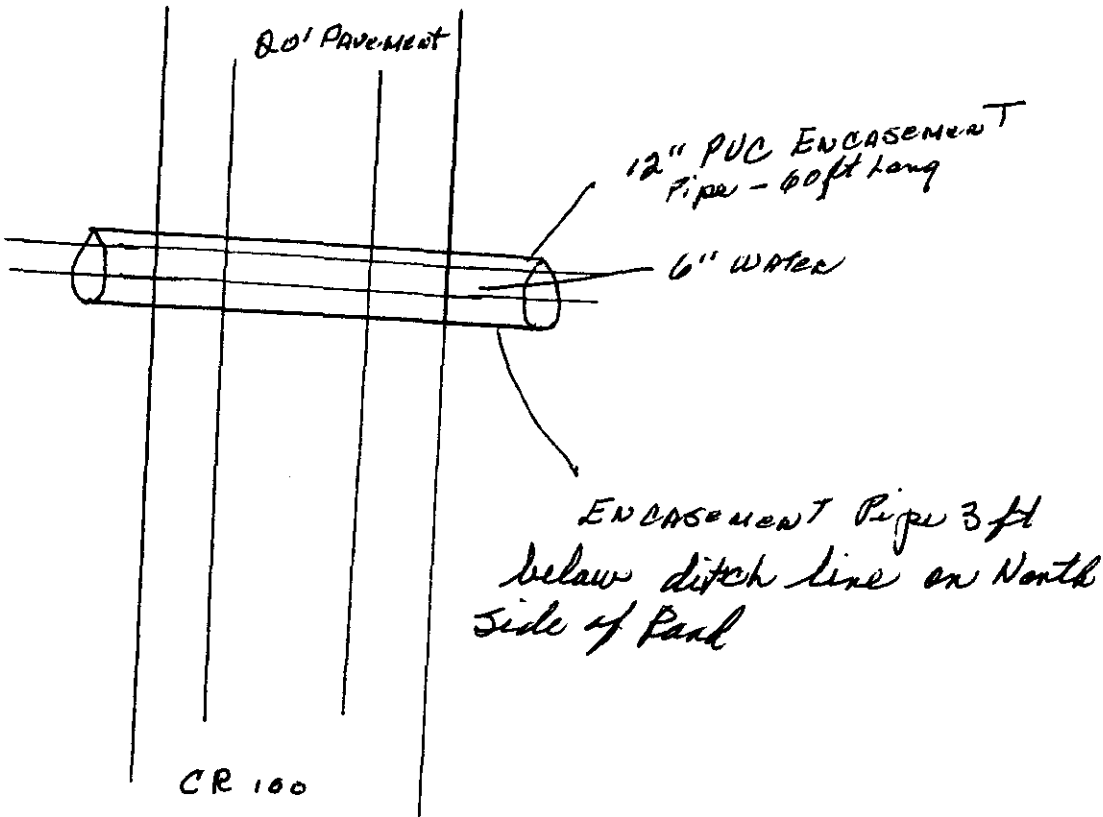

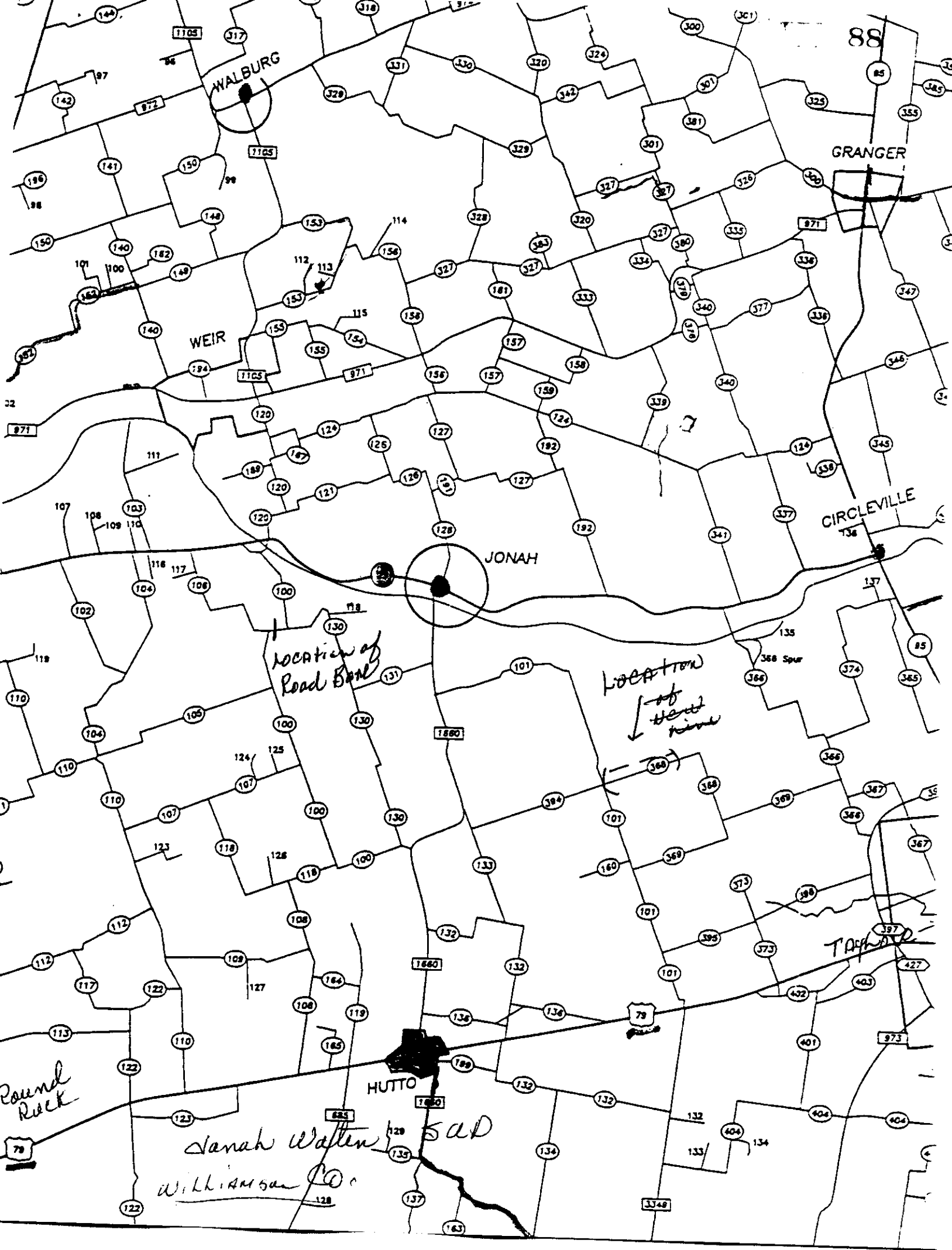

109  
NOTICE OF PROPOSED INSTALLATION

89

UTILITY LINE ON WILLIAMSON COUNTY RIGHT-OF-WAY

TO: Williamson County Unified Road System  
1900 Georgetown Inner Loop, Suite B  
Georgetown, Texas 78626

DATE: 8-4-00

Formal notice is hereby given that JONAH WATER S.U.D.

Company proposes to ~~place~~ REPAIR WATER LEAK

line within the right-of-way of County Road 135  
as follows: (give location, length, general design, etc.)

EMERGENCY REPAIR OF WATER LINE  
LEAK AT EDGE OF PAVEMENT

The line will be constructed and maintained on the road right-of-way as directed by the Williamson County Unified Road System in accordance with governing laws.

Our firm further understands that the County considers proper traffic control measures as those complying with applicable portions of the Texas Manual of Traffic Control Devices required for adoption by the "Transportation Code" (V.C.T.A. CH.251)

The location and description of the proposed line and appurtenances is more fully shown by 1 copies of drawings attached to this notice.

Construction of this line is proposed to begin on or after the 4 day of August 2000

APPROVAL

This application is hereby approved subject to the following understandings and restrictions.

It is expressly understood that the said County Commissioners' Court does not imply hereby to grant any right, claim, title or easement in or upon this County Road; and it is further understood that in the future, should Williamson County, for any reason, need to work, improve, relocate, widen, increase, add to, decrease, or in any manner change the structure of this road or right-of-way, this line, if affected, will be moved at the direction of the Williamson County Engineer or County Commissioner. This installation work shall not damage any part of the roadway and adequate provisions shall be made to cause a minimum of inconvenience to traffic and adjacent property owners.

APPROVED BY WILLIAMSON COUNTY COMMISSIONERS' COURT

BY: Kry Ruge  
COUNTY ROAD ADMINISTRATOR

DATE: 8/11/00

Firm: JONAH WATER SUD

By: KEN HALL

(Print Name) ASST. MANAGER

Title:

Address: 40 C.R. 126

Georgetown TX.

78626

Phone: 512-863-2235

Fax: 512-869-5402

received  
8-4-00

J.W.R. 8-9-00  
Rd. Cmt.

I, KEN HALL <sup>Employee</sup> ~~Contractor~~ for JONAH WATER S.U.D.  
in Williamson County, Texas do hereby agree to the following schedules and conditions for doing work  
within the right-of-way of COUNTY ROAD 135 which is a public  
roadway maintained by Williamson County.

1. I will contact the Williamson County Unified Road System at least 48 hours prior to start of construction.
2. All work in the right-of-way will be done between the hours of 8:30 a.m. and 4:30 p.m. on Monday through Friday only.
3. Cuts will be opened for one-half the roadway only, with flagmen on both sides of the work area, allowing one-way traffic through. This type of operation will be held to a minimum and all advance warning signs and barricades shall be as specified in the Texas Manual on Uniform Traffic Control Devices. These cuts will also be filled and entire roadway opened at night and on weekends.
4. Roadside work in ditches alongside the trenched surface may be left opened at night, only if they can be barricaded solidly between open ditch and traveled roadway leaving a minimum 6' of road shoulder between the pavement edge and the barricades. The barricades must be reflectorized and lighted with warning lights and conform to the requirements of the T.M.U.T.C.D. for nighttime use.
5. Any construction area to be maintained from dusk to dawn shall have Type B High Intensity Steady Burn Warning Lights to delineate the traveled way through and around obstructions in a construction or maintenance area. All warning lights shall be installed to a minimum mounting height of 36" to the bottom of the lense.
6. Construction work and road repair on County right-of-way will be done to Williamson County Standards and to the approval of the Williamson County Unified Road System.
7. I will notify the Williamson County Unified Road System and obtain approval prior to any changes from this agreement if required due to soil conditions or other problems.

8-4-00

DATE

Williamson County Unified Road System  
1900 Georgetown Inner Loop, Ste. B  
Georgetown, Texas 78626

*Ken Hall*  
SIGNED

KEN HALL

~~CONTRACTOR~~ (PRINT NAME)

40 C.R. 126

ADDRESS

GEORGETOWN TX. 78626

CITY, STATE, ZIP CODE

(512) 863-2235

PHONE

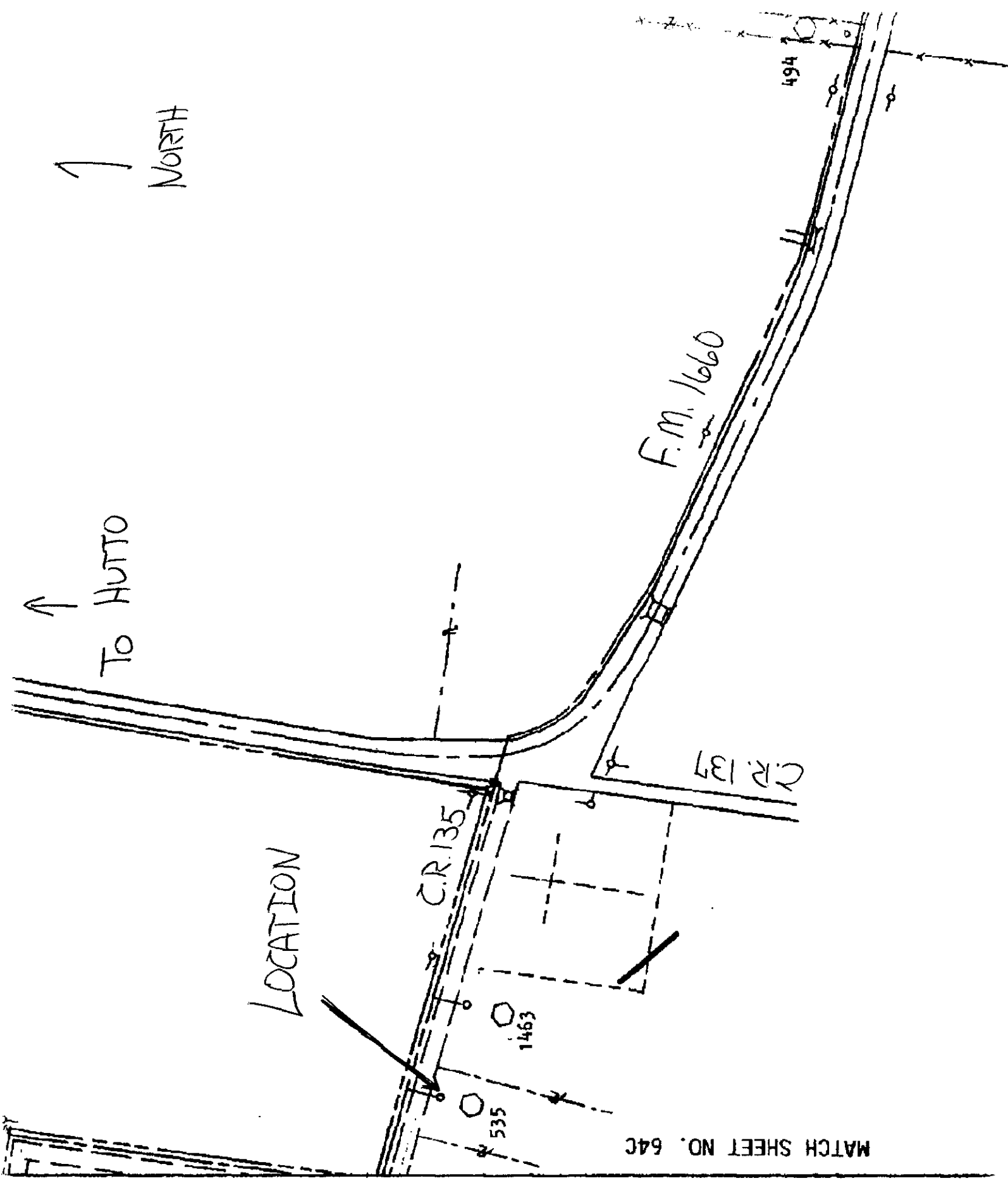

**NOTICE OF PROPOSED INSTALLATION  
UTILITY LINE ON WILLIAMSON COUNTY RIGHT-OF-WAY**

TO: Williamson County Unified Road System  
1900 Georgetown Inner Loop, Suite B  
Georgetown, Texas 78626

DATE: 8/8/00

Formal notice is hereby given that Southwestern Bell Telephone Co  
Company proposes to place a BURIED  
line within the right-of-way of Pecan Creek Hwy & Anderson Mill Rd  
as follows: (give location, length, general design, etc.)  
SEE ATTACHED DRAWINGS.

The line will be constructed and maintained on the road right-of-way as directed by the Williamson County Unified Road System in accordance with governing laws.

Our firm further understands that the County considers proper traffic control measures as those complying with applicable portions of the Texas Manual of Traffic Control Devices required for adoption by the "Transportation Code" (V.C.T.A. CH.251)

The location and description of the proposed line and appurtenances is more fully shown by 3 copies of drawings attached to this notice.

Construction of this line is proposed to begin on or after the 8th day of August 2000.

APPROVAL

This application is hereby approved subject to the following understandings and restrictions.

It is expressly understood that the said County Commissioners' Court does not imply hereby to grant any right, claim, title or easement in or upon this County Road; and it is further understood that in the future, should Williamson County, for any reason, need to work, improve, relocate, widen, increase, add to, decrease, or in any manner change the structure of this road or right-of-way, this line, if affected, will be moved at the direction of the Williamson County Engineer or County Commissioner. This installation work shall not damage any part of the roadway and adequate provisions shall be made to cause a minimum of inconvenience to traffic and adjacent property owners.

APPROVED BY WILLIAMSON COUNTY COMMISSIONERS' COURT

BY: [Signature]  
COUNTY ROAD ADMINISTRATOR

DATE: 8/10/00

Firm: Southwestern Bell Telephone

Authorized Signature [Signature]

Gib Hoffman

Printed Name

Address: 1616 Guadalupe

Rm 406, Austin, Texas  
78701

Phone: (512) 870-3443

Fax: (512) 870-3305

Pct. 2

8-9-00

R.O.W.

[Signature]

R.J.

476238F  
38921-024  
J0004, B23-840  
N. 13-24

476238F  
PVC-C-2"

GUNGROVE CIRCLE

VACANT LOT

11.1 KT  
PROJECT: ABE164  
PECAN CREEK PKWY  
SKID. N8P121  
XULB58  
AUSKTX3V  
LSEB016  
9CBA, 3PBA A  
J0004, B23-832 PDS  
J0004, B23-834 ATN  
DPC27, 1-2023

4748076R  
476238F

CONSTRUCTION NOTE:  
ALIGN DUCTS WITH  
BORE AT P.I. PLAT 3

SBC ESMT

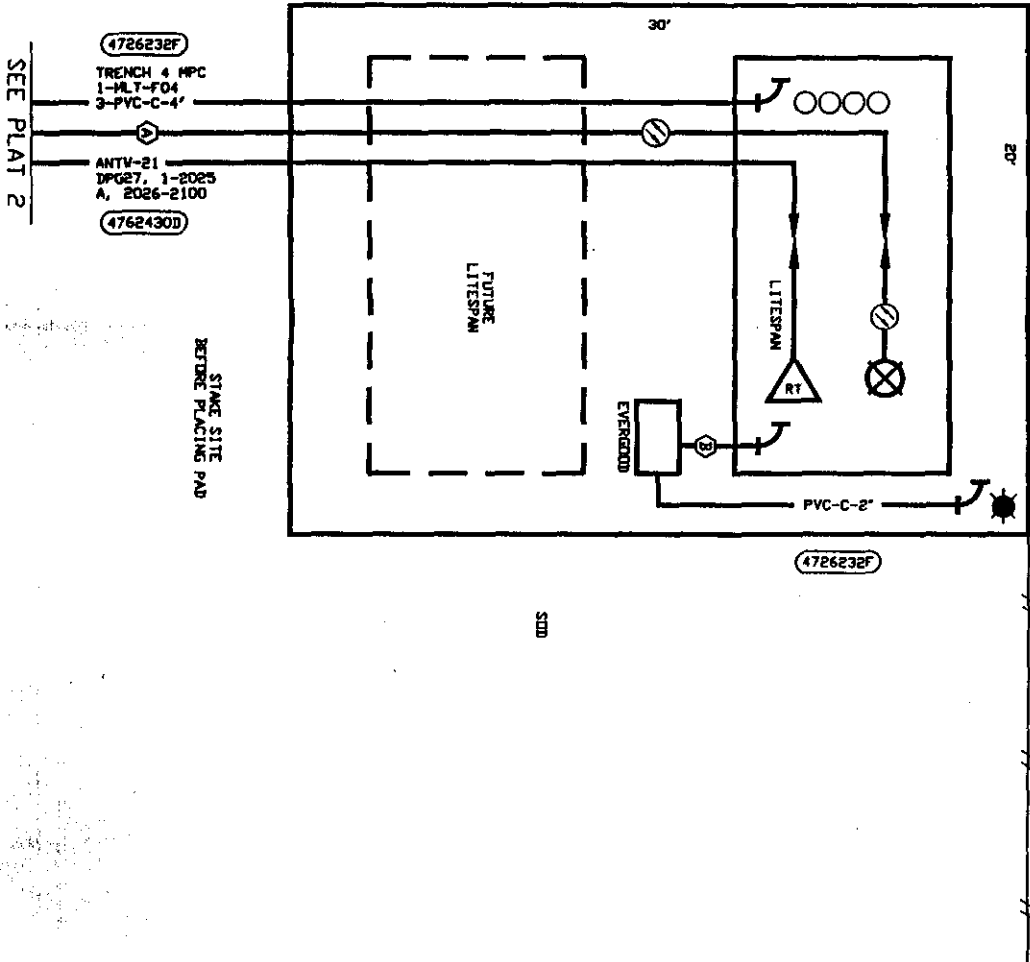

PECAN CREEK PKWY

OPERATING RANGE OF JOB STEPS	
LINE	TO
SPLICE	TO
MFR C 5M	
TRANSMISSION ZONE	
RZ	CZ 9
TAPER CODE 425102	
CAUTION HIGH VOLTAGE	
7.2 KV <input checked="" type="checkbox"/> AERIAL <input checked="" type="checkbox"/> BURIED	
SPECIAL CIRCUITS INVOLVED	
<input type="checkbox"/> YES <input checked="" type="checkbox"/> NO	
6203 FORWARDED	
<input type="checkbox"/> YES <input checked="" type="checkbox"/> NO	
PERMIT REQUIRED	
<input checked="" type="checkbox"/> YES <input type="checkbox"/> NO	
POLE CONTACTS	
<input type="checkbox"/> (+) --- OR (-) ---	
PWR. CO. PEC	
NOTES	
4685388 PLAT 6 (FIBER)	
CONSTRUCTION NOTE:	
1) LOCATE ALL BURIED UTILITIES BEFORE DIGGING IN THE AREA	
ORDER NO. 4762466	
TOT. PLATS 7 PLAT NO. 1	
C.O. AUSTIN NORTH	
EXCH. JOLLYVILLE 258	
TAX DIST. WK017	
GEO. LOC. XY4258	
ENGR. GH-Z DRAWN V	
MAP REF. 433U	
REC. REF. 14-8-C	
DATE INIT. 2000 REV. 05/23	



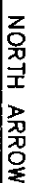
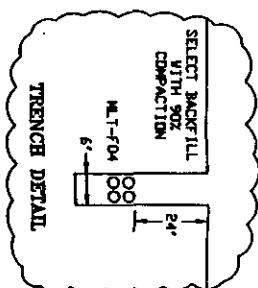
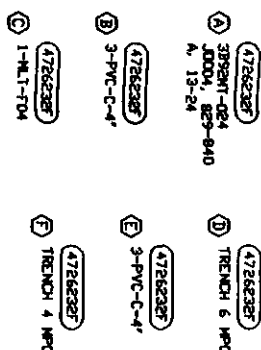

### OPERATING RANGE OF JOB STEPS

LINE TO LINE

SPLICE TO

MFRC 5M

TRANSMISSION ZONE

RZ \_\_\_\_\_ CZ 9

TAPER CODE 425102

CAUTION HIGH VOLTAGE

☒ AERIAL

7.2 KV  
☒ BURIED

## SPECIAL CIRCUITS INVOLVED

☐ YES ☒ NO

6203 FORWARDED

☐ YES ☒ NO

PERMIT REQUIRED

## POLE CONTACTS

(+) -- OR (-) --  
PWR. CO. PEC

## NOTES

**4685388 PLAT 6 (FIBER)**

**CONSTRUCTION NOTE:**

1) LOCATE ALL BURIED UTILITIES  
BEFORE DIGGING IN THE AREA

ORDER NO. 4762466

TOT. PLATS 7 PLAT NO. 2

C.O. AUSTIN NORTH

EXCH. JOLLYVILLE 258

GEO. LOC. XY4258

ENGR. GH-Z DRAWN V

MAP REF. 4331REC. REF. 14-8-CDATE INIT. 2000 REV. 05/23

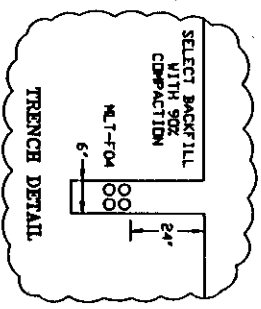

STRIP CENTER

DRIVES NOT SHOWN

- (476232F) 3592NT-024 J0004, 829-840 A, 13-24
- (476232F) 3-PVC-C-4'
- (476232F) 1-M.I.-F04
- (476232F) TRENCH 4 MPC

SEE PLAT 2

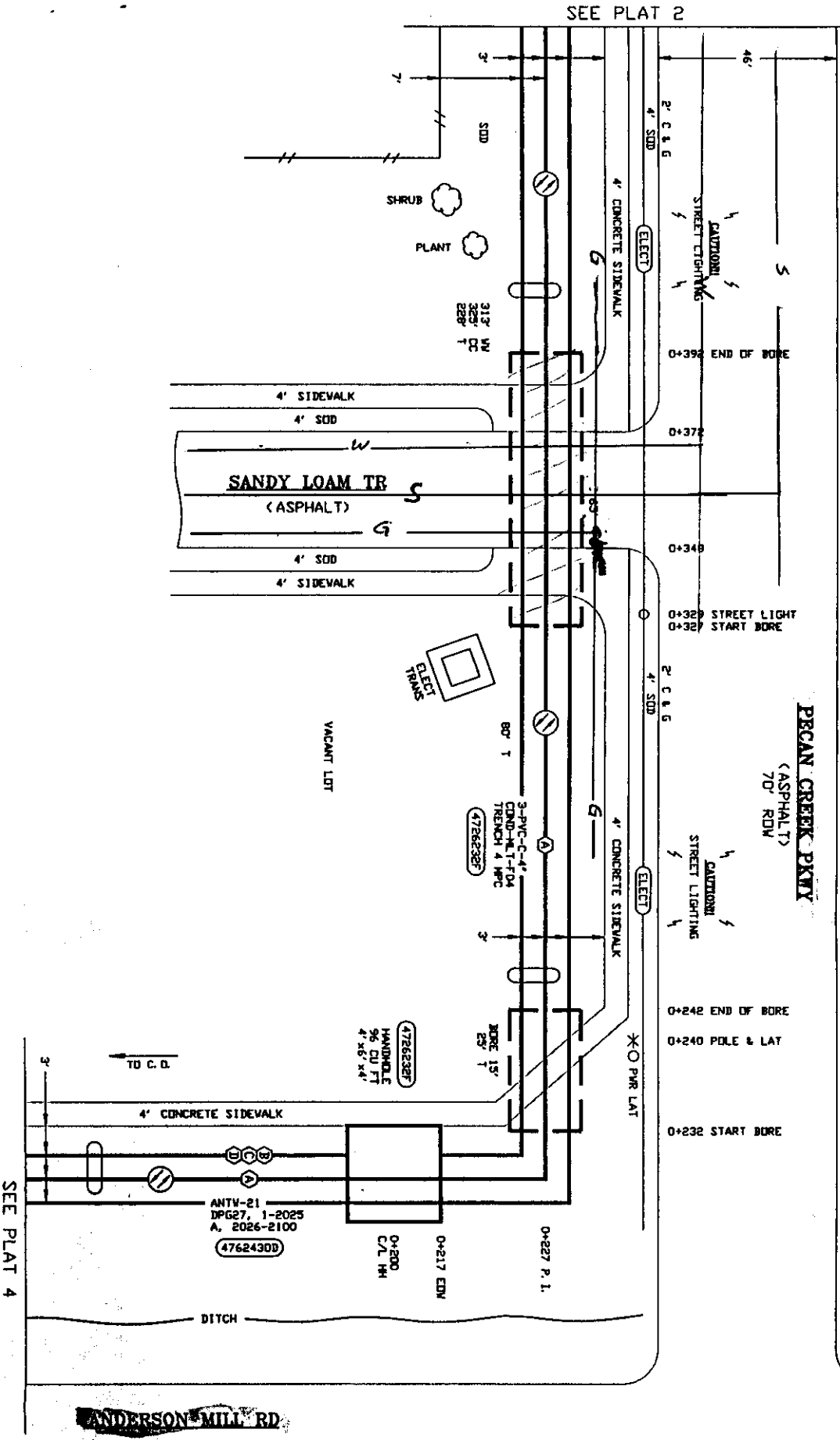

SEE PLAT 4



NORTH ARROW

OPERATING RANGE OF JOB STEPS

LINE TO TO

SPLICE TO TO

MFRC 5M

TRANSMISSION ZONE

RZ CZ 9

TAPER CODE (425102)

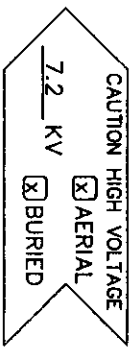

SPECIAL CIRCUITS INVOLVED

6203 FORWARDED

PERMIT REQUIRED

POLE CONTACTS

(+) OR (-) PWR. CO. REC

NOTES

4685388 PLAT 6 (FIBER)

CONSTRUCTION NOTE:

1) LOCATE ALL BURIED UTILITIES BEFORE DIGGING IN THE AREA

ORDER NO. 4762466

TOT. PLATS 7 PLAT NO. 3

C.O. AUSTIN NORTH

EXCH. JOLLYVILLE 258

TAX DIST. WK017

GEO. LOC. XY4258

ENGR. GH-Z DRAWN V

MAP REF. 433U



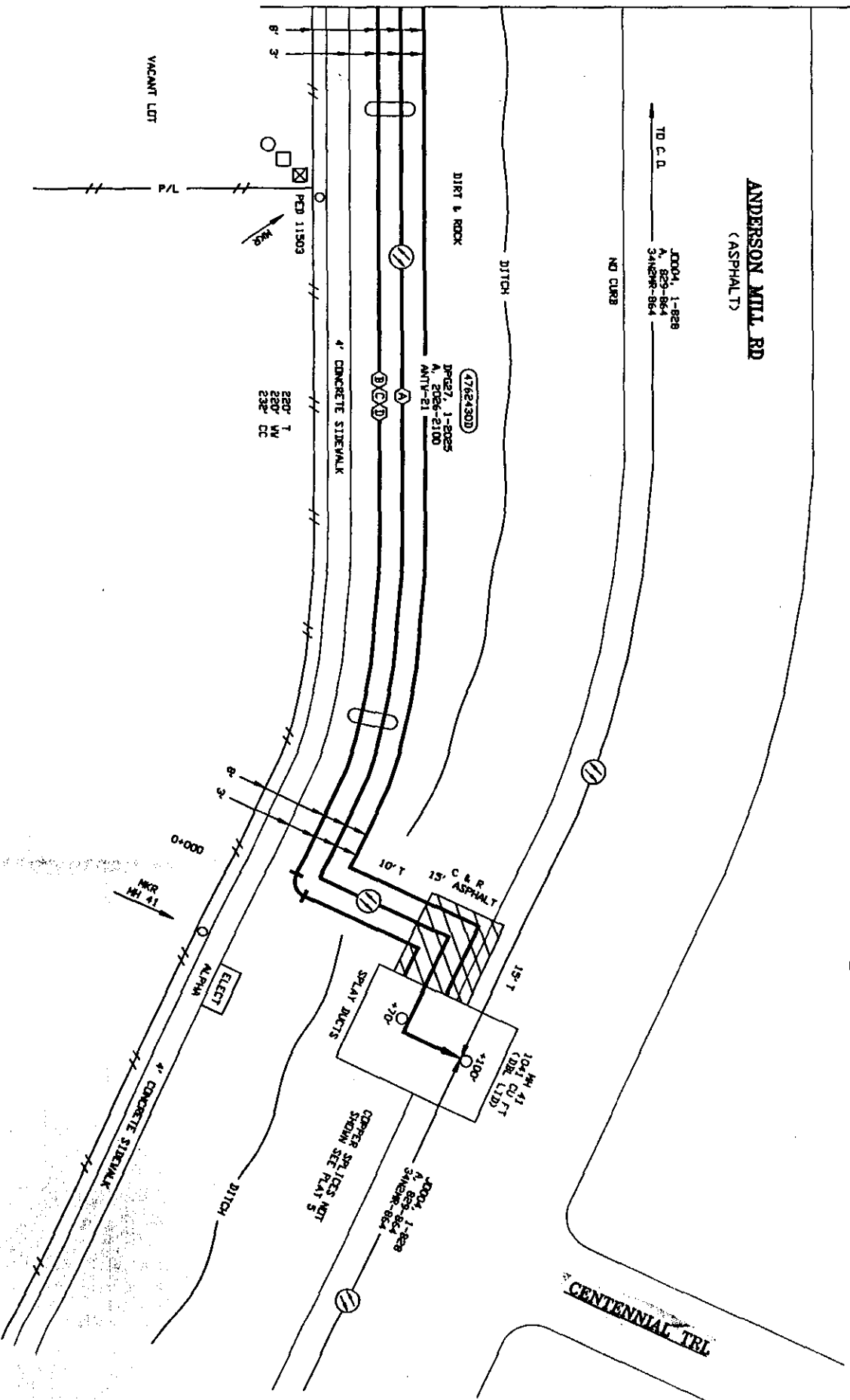

REC. REF. 14-8-C

DATE INIT. 2000 REV. 05/23

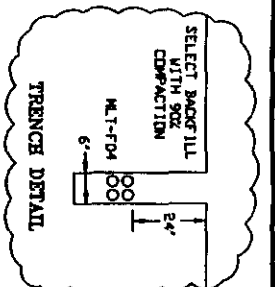

- (47262287)  
 3895MT-024  
 J0004, 825-840  
 A, 13-E4  
 (47262287)  
 3-PVC-C-4\*  
 (47262287)  
 1-MLT-F-04  
 (47262287)  
 TRENCH 4 MPC



 NORTH ARROW	
OPERATING RANGE OF JOB STEPS	
LINE	 TO 
SPURCE	 TO 
MIRC 5M	
TRANSMISSION ZONE	
RZ	CZ 9
TAPER CODE (425102)	
<div style="border: 1px solid black; padding: 5px; text-align: center;">           CAUTION HIGH VOLTAGE  <input checked="" type="checkbox"/> AERIAL            7.2 KV <input checked="" type="checkbox"/> BURIED         </div>	
SPECIAL CIRCUITS INVOLVED	
<input type="checkbox"/> YES <input checked="" type="checkbox"/> NO 6203 FORWARDED <input type="checkbox"/> YES <input checked="" type="checkbox"/> NO PERMIT REQUIRED <input checked="" type="checkbox"/> YES <input type="checkbox"/> NO	
POLE CONTACTS	
(+) <u>--</u> OR (-) <u>--</u> PWR. CO. <u>PEC</u>	
NOTES	
4685388 PLAT 6 (FIBER)	
CONSTRUCTION NOTE:	
1) LOCATE ALL BURIED UTILITIES	
BEFORE DIGGING IN THE AREA	
ORDER NO. 4762466	
TOT. PLATS 7 PLAT NO. 4	
C.O. AUSTIN NORTH	
EXCH. JOLLYVILLE 258	
TAX DIST. WK017	
GEO. LOC. XY4258	
ENGR. GH-7 DRAWN V	
MAP REF. 433U	
REC. REF. UG9 14-8-C	
DATE INIT. 2000 REV. 05/23	

NOTICE OF PROPOSED INSTALLATION  
UTILITY LINE ON WILLIAMSON COUNTY RIGHT-OF-WAY

TO: Williamson County Unified Road System  
1900 Georgetown Inner Loop, Suite B  
Georgetown, Texas 78626

DATE: 8/10/00

Formal notice is hereby given that Southwestern Bell Telephone Co.

Company proposes to place a Buried

line within the right-of-way of Lake Creek Hwy, Pecan Creek Hwy, & El Solido Pk.  
as follows: (give location, length, general design, etc.)

SEE ATTACHED DRAWINGS:

The line will be constructed and maintained on the road right-of-way as directed by the Williamson County Unified Road System in accordance with governing laws.

Our firm further understands that the County considers proper traffic control measures as those complying with applicable portions of the Texas Manual of Traffic Control Devices required for adoption by the "Transportation Code" (V.C.T.A. CH.251)

The location and description of the proposed line and appurtenances is more fully shown by 3 copies of drawings attached to this notice.

Construction of this line is proposed to begin on or after the 8th day of Sept. 2000

APPROVAL

This application is hereby approved subject to the following understandings and restrictions.

It is expressly understood that the said County Commissioners' Court does not imply hereby to grant any right, claim, title or easement in or upon this County Road; and it is further understood that in the future, should Williamson County, for any reason, need to work, improve, relocate, widen, increase, add to, decrease, or in any manner change the structure of this road or right-of-way, this line, if affected, will be moved at the direction of the Williamson County Engineer or County Commissioner. This installation work shall not damage any part of the roadway and adequate provisions shall be made to cause a minimum of inconvenience to traffic and adjacent property owners.

APPROVED BY WILLIAMSON COUNTY COMMISSIONERS' COURT

BY: My Benson  
COUNTY ROAD ADMINISTRATOR

DATE: 8/10/00

Firm: Southwestern Bell Telephone

Authorized Signature

Gib Hoffman  
Printed Name MEN. ENGR. DESIGN

Address: 1616 GUADALUPE

RM 406, AUSTIN, TEXAS

78701

Phone: (512) 870-3443

Fax: (512) 870-3305

Pct. 2

8-9-00

ROW

BORE

Cut & Restore

R.J.

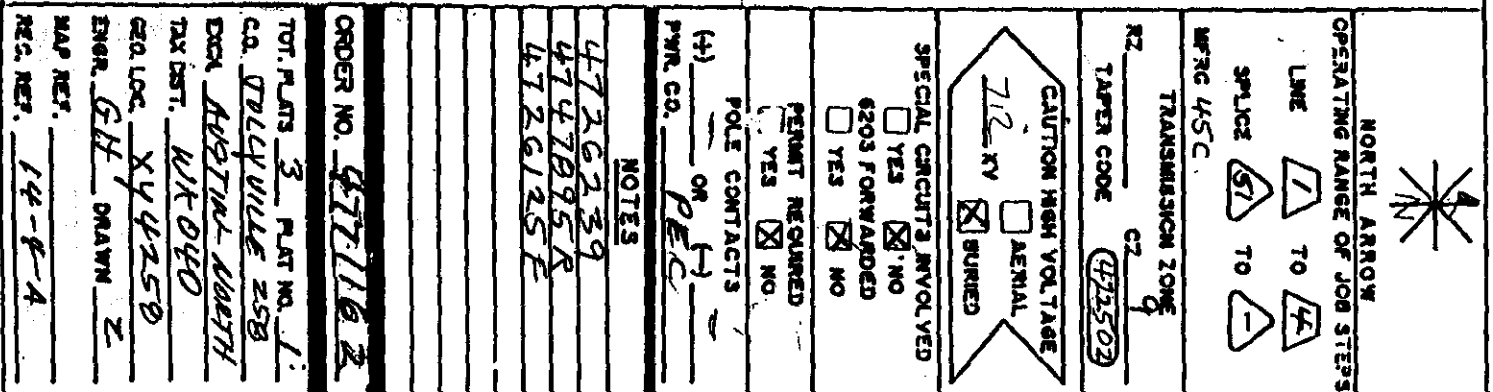



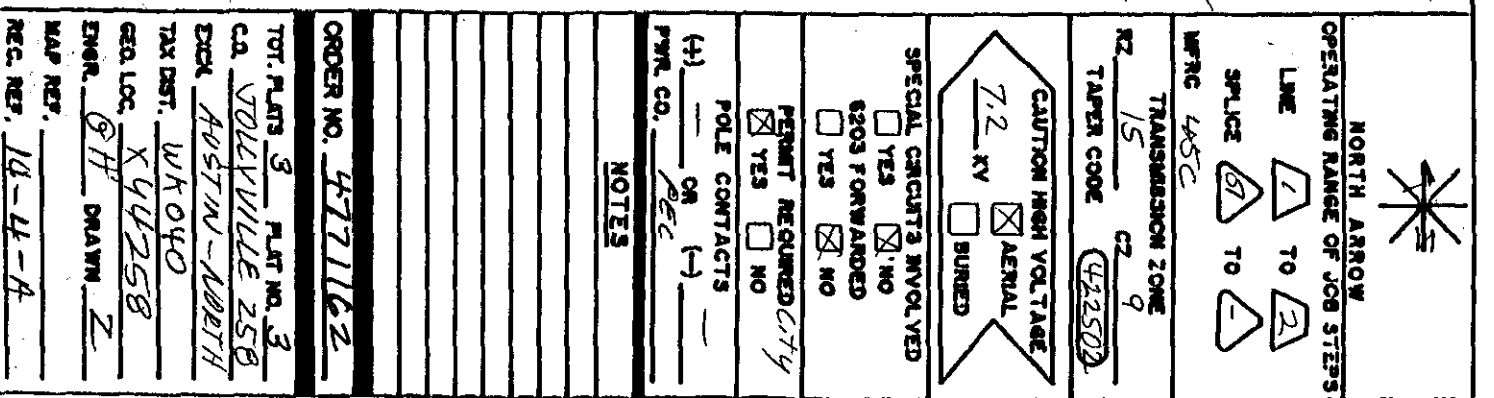

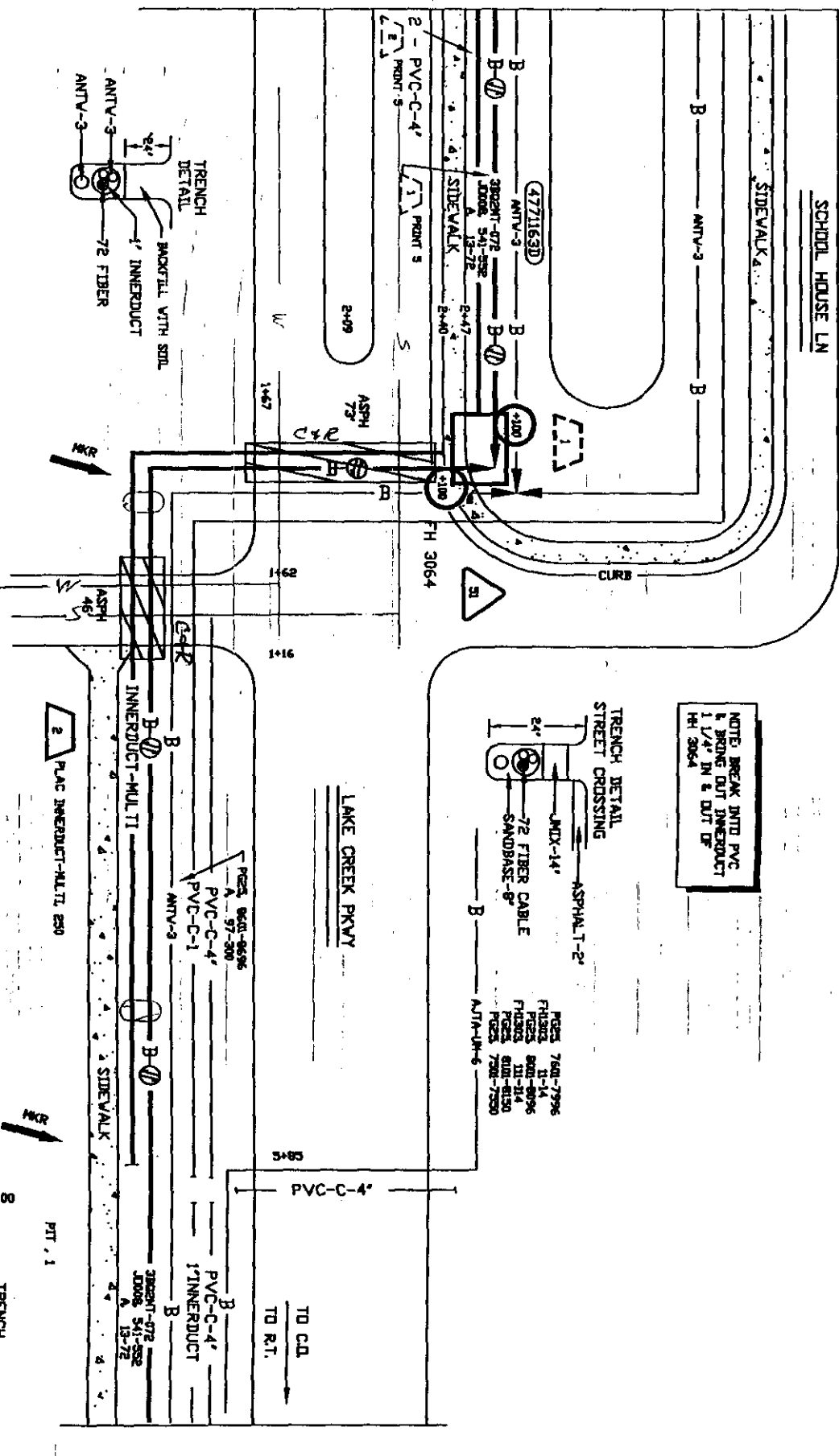
[illegible]

NOTE: BREAK INTO PVC  
& BRING OUT INNERDUCT  
1 1/4" IN & OUT OF  
HH 3064

**TRENCH DETAIL  
STREET CROSSIN**

	PQRS	7600-7999
	FH3023	II-14
	PQRS	8000-8099
	FH3003	III-14
	PQRS	8100-8199
	PQRS	7200-7299
B	ALTA-14-6	

LAKE CREEK PKWY

SEE PLAT 3

SPECIAL CIRCUITS		N	
6203 FORWARDED		N	
PERMIT REQUIRED		Y	NORTH ARROW

OPERATING RANGE OF JOB STEPS	
LINE	<div>1</div> TO <div>2</div>
SPACE	<div>51</div> TO <div>51</div>
MTRC 845C	
TRANSMISSION ZONE	
RZ	CZ 9 TAPER CODE 131102
CAUTION HIGH VOLTAGE	
IV 7.2	AERIAL Y BURIED Y
POLE CONTACTS (+) (-)	
PWR CD P.E.C.	

NOTES	
REC REF: 4517125	
CABLES OMMITTED FOR CLARITY	
ORDER NO.	4726125

TOT. PRINTS	7	PRINT NO.	4
MPA/MNC	512-258	PRI:	
EXCH. JOLLYVILLE			
TAX DIST. WK040			
CED LOC. XY4258			
ENGR. GH	DRAWN C		
TELEPHONE NO. (512) 870-3443			
REC. REF. 14-4-AB			
MAP REF.			
SCALE NONE			
ISSUE DATE 04/25/00			
DATE REV.			
JOB TITLE RT 1309			



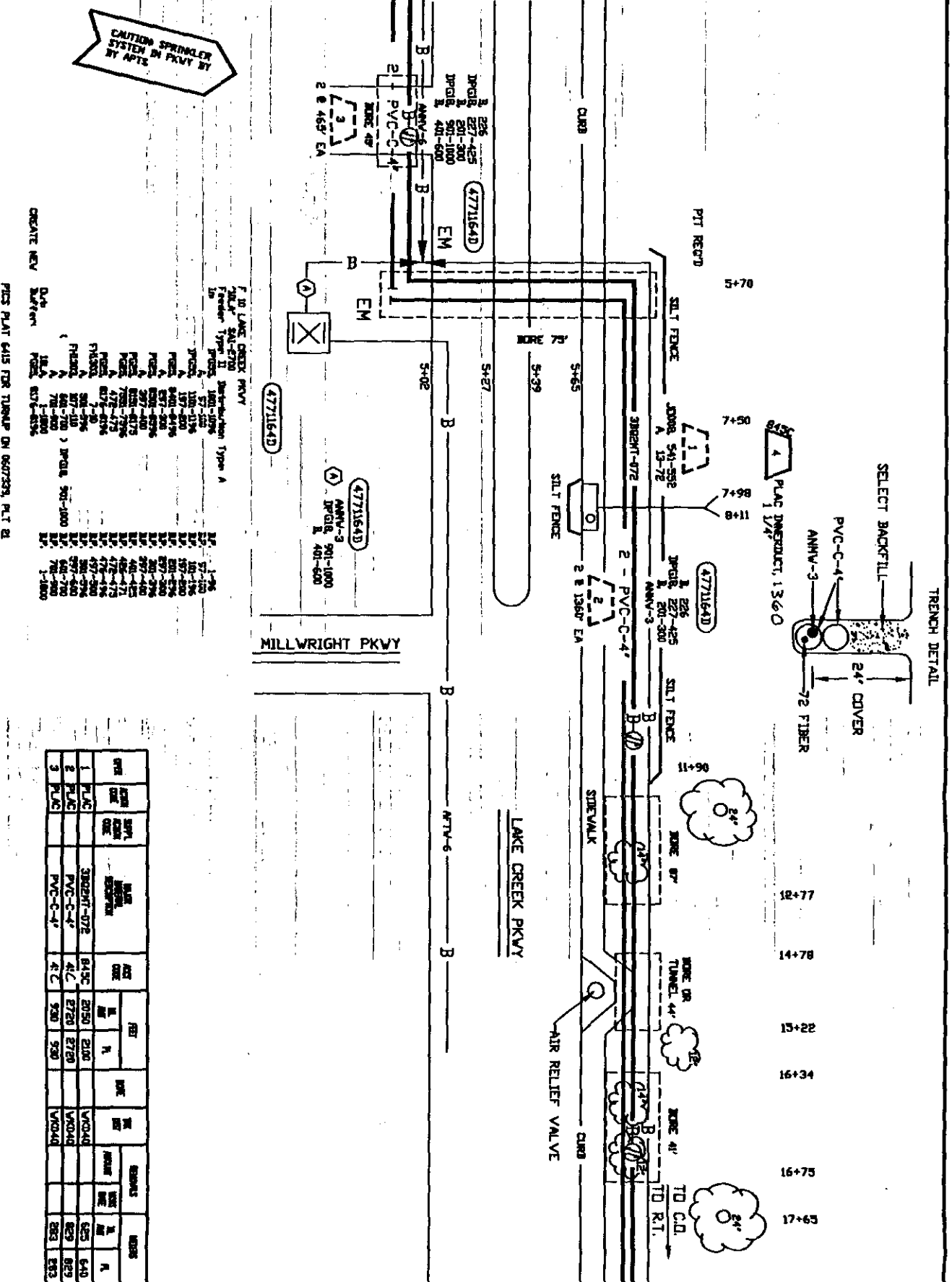

TYPE	SOUTH EAST CONE	NORTH WEST EAST CONE	ACQ CONE	FEI		NOK REV	REMARKS		REDS	
				M	F		NOV	M	F	
										NOV
1 PLAC	3302021-072	64-3C	20-50	21-00		V0044		6-25	6-40	
2 PLAC	PVC-C-4 <sup>a</sup>	41C	27-20	27-30		V0040		8-29	8-29	
3 PLAC	PVC-C-4 <sup>a</sup>	41C	27-30	27-30		V0040		8-23	8-23	

SEE PLAT 4

SPECIAL CIRCUITS      N		
62203 FORWARDED      N		
PERMIT REQUIRED      Y		NORTH ARROW
OPERATING RANGE OF JOB STEPS		
LINE	1 TO 4	
SPICE	TO	
MFRG	4SC	
TRANSMISSION ZONE		
RZ	C2 9	TAPER CODE 130902
CAUTION HIGH VOLTAGE		
KV 7.2	AERIAL Y	BURIED N
POLE CONTACTS (+) (-)		
PWR CO		
NOTES		
ORDER NO. 4726125		
TOT. PRINTS 7		PRINT NO. 5
MAY/ANAL: 512-258		PRT:
EXCH. JOLI/VILLE		
TAX DIST. WKO40		
GEO LOC. XY4258		
ENGR. GH	DRAWN C	
TELEPHONE NO. (512) 870-3443		
REC. REF. 14-4A		
MAP REF.		
SCALE NONE		
ISSUE DATE 04/25/00		
DATE REV.		
JOB TITLE RT 1309		

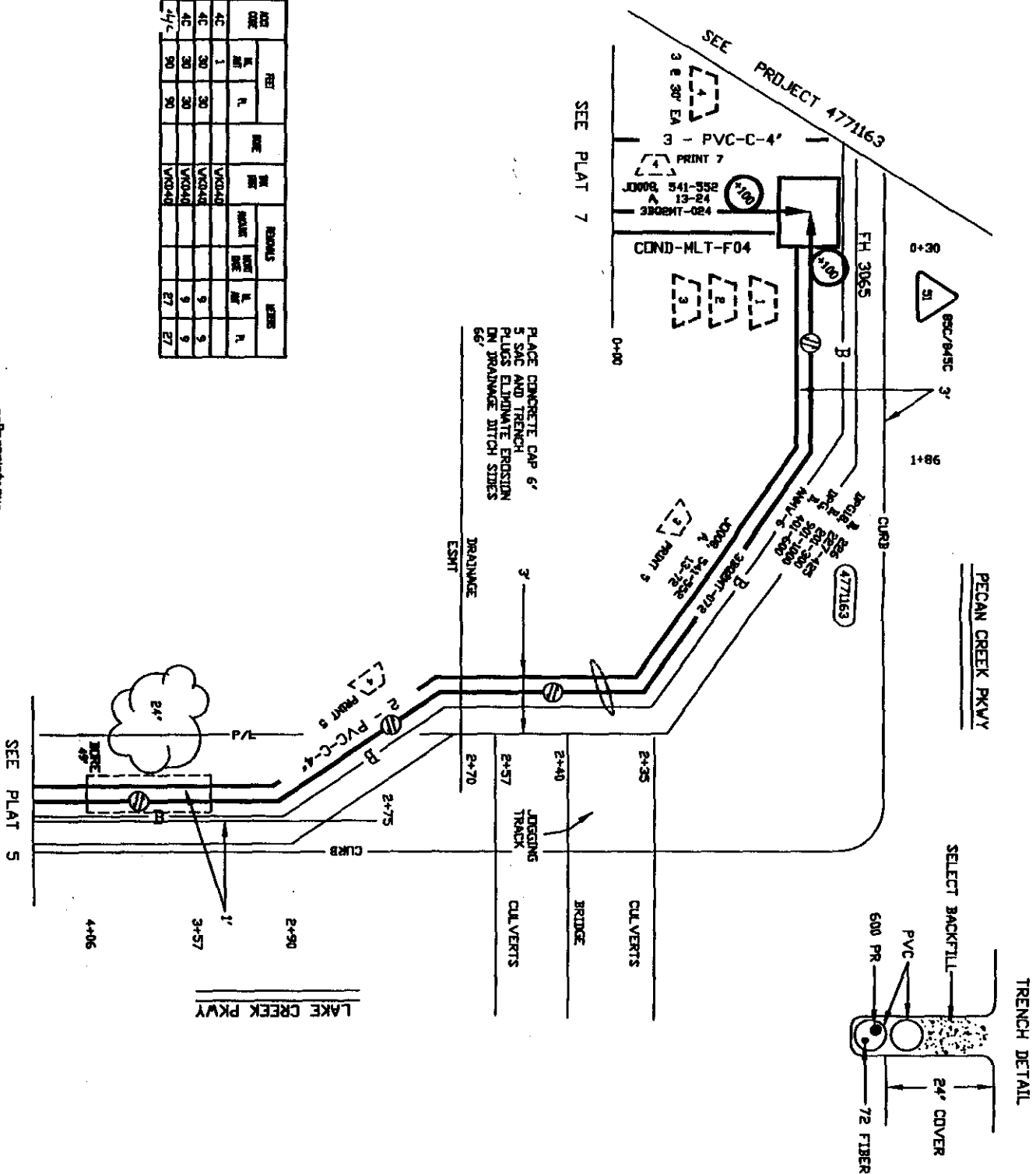

OTHER CODE	ACRON CODE	SUFF. ACRON CODE	MAJOR WORKING DESCRIPTION	ACC CODE	FEET		BORE	IN. DIA.	REINFORC.		WEIGHT	
					L.	H.			WALL	ROOF	L.	H.
1	PLAC		FIBER-ASSISTED	4C	1			WGD4G				
2	PLAC		CONC-HL-T-ED	4C	30	30		WGD4G		9	9	
3	PLAC		TRENCH-T-SPC	4C	30	30		WGD4G		9	9	
4	PLAC		PVC-C-V	4/C	50	50		WGD4G		E7	E7	

--Proprietary--  
Not for disclosure outside Southwestern Bell Telephone Company except under written agreement.

—Proprietary—  
 700 West Tennessee C

SPECIAL CIRCUITS		N	6203 FORWARDED		N	PERMIT REQUIRED		Y	 NORTH ARROW	
OPERATING RANGE OF JOB STEPS										
LINE	1		TO	4						
SPACE	51		TO	51						
WTRC 4C										
TRANSMISSION ZONE										
RZ	CZ 9		TAPER CODE 130902							
CAUTION HIGH VOLTAGE										
KV 7.2	AERIAL		N	BURIED		Y				
POLE CONTACTS (+) (-)										
PWR CO PEC										
NOTES										
CONST NOTE: REROUTE JOGGING										
PATH TO AVOID RT										
ORDER NO. 4726125										
TOTAL PRINTS 7			PRINT NO. 6							
NPA/ANX: 512-258			PRT:							
EXCH. JOLLYVILLE										
TAX DST. WK040										
GEO LOC. XY4258										
ENGR. GH			DRAWN C							
TELEPHONE NO. (512) 870-3443										
REC. REF. 14-4-A										
MAP REF.										
SCALE NONE										
ISSUE DATE 04/25/00										
DATE REV.										
JOB TITLE RT 1309										

PECAN PARK PKVY

SEE PLAT 6

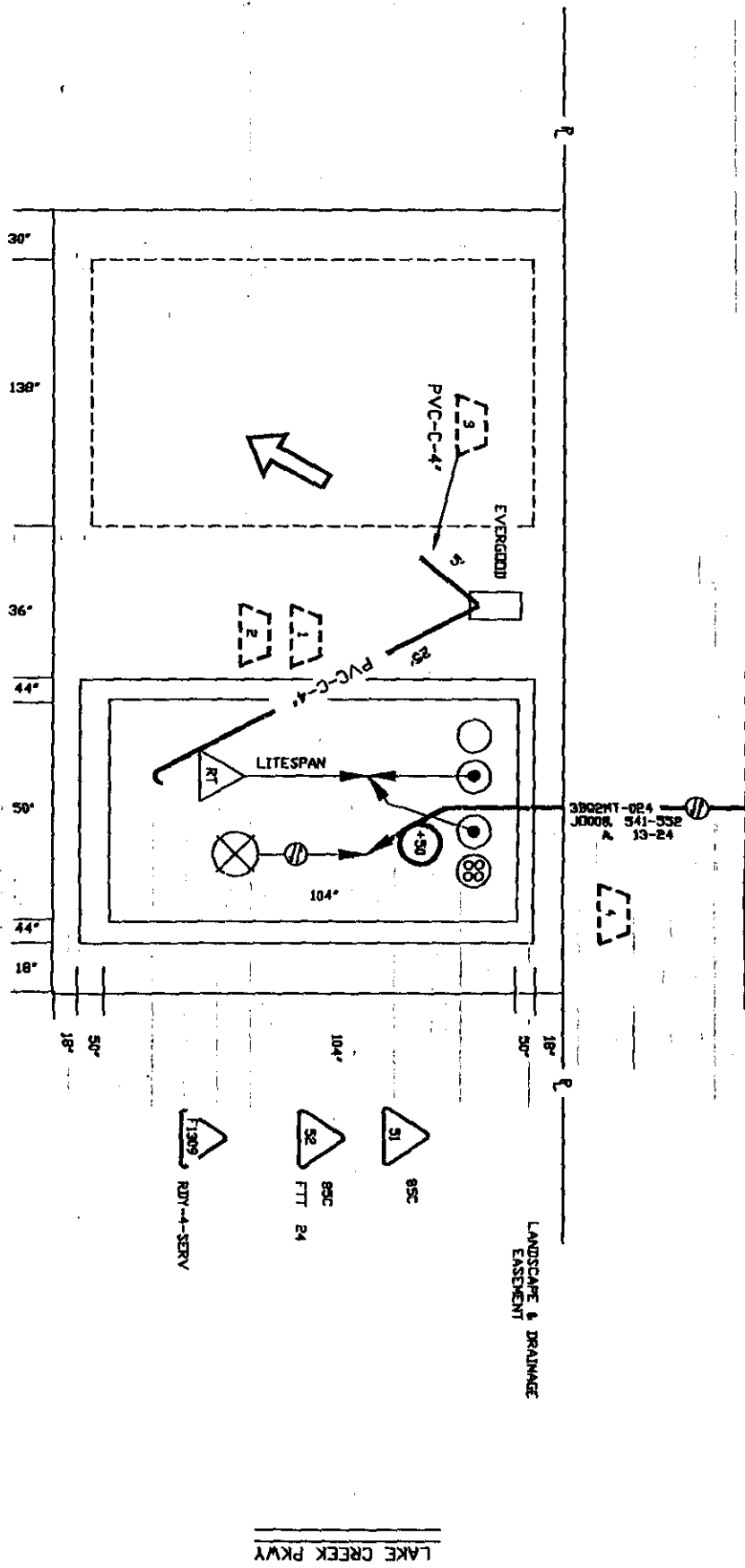

OVER	ITEM	SUFF. OR CORR.	MATERIAL DESCRIPTION	KEY CODE	YTD		INV. WBS	RECORDS		ALBIS	
					W	P		AMOUNT	DATE	W	P
1	PLAC		TRENCH-1-4PC	AC	23	23	W4040			8	
2	PLAC		PVC-C-4"	AC	3	23	W4040			8	
3	PLAC		PVC-C-4"	4SC	3	3	W4040				
4	PLAC		3802841-024	8SC	190	2-40	W4040			38	73

RT 1309 16.8 KT  
12111 PECAN CREEK PKVY  
SKID# NBP098  
(AUSTTXU1360) OLD / NEW CILLI, AUSTTXZM  
LSC 2016  
LS 200010C3  
9CBA3PDA  
JD008, 541-544 DPS  
JD008, 545-546 ATM  
DPSIG, 1-2016

Not for disclosure outside Southern Bell Telephone Company except under written agreement.

LAKE CREEK PKVY

SPECIAL CIRCUITS	N	NORTH ARROW
6203 FORWARDED	N	
PERMIT REQUIRED	Y	
OPERATING RANGE OF JOB STEPS		
LINE	1 TO 4	
SPLICE	51 TO 52	
AFRC	4C	
RZ	CZ 9 TAPER CODE 130902	
KV	7.2 AERIAL Y BURIED Y	
POLE CONTACTS (+) (-)		
PWR CO		
NOTES		
CONSTRUCTION: BUILD BACK OF		
EASEMENT TO MATCH TOP OF		
CURB ELEVATION		
ORDER NO.	4726125	
TOT. PRINTS	7	PRINT NO. 7
NPA/ANX	512-258	PRT:
EXCH.	JOLLYVILLE	
TAX DIST.	WKO40	
GEO LOC.	XV4258	
ENGR.	GH	DRAWN C
TELEPHONE NO.	(512) 870-3443	
REC. REF.	14-4-A	
MAP REF.		
SCALE	NONE	
ISSUE DATE	04/25/00	
DATE REV.		
JOB TITLE	RT 1309	

## NOTICE OF PROPOSED INSTALLATION

105

## UTILITY LINE ON WILLIAMSON COUNTY RIGHT-OF-WAY

TO: Williamson County Unified Road System  
1900 Georgetown Inner Loop, Suite B  
Georgetown, Texas 78626

DATE: 8-8-00

Formal notice is hereby given that VERIZONCompany proposes to place a BURIED CABLE

line within the right-of-way of CO-ROD 152  
as follows: (give location, length, general design, etc.) BEGINNING AT THE JUNCTION  
OF FM 971 AND COUNTY ROAD 152 ON THE EAST SIDE  
OF THE RIGHT OF WAY OF COUNTY ROAD 152 AND  
CONTINUING NORTH FOR A DISTANCE OF 740'

The line will be constructed and maintained on the road right-of-way as directed by the Williamson County Unified Road System in accordance with governing laws.

Our firm further understands that the County considers proper traffic control measures as those complying with applicable portions of the Texas Manual of Traffic Control Devices required for adoption by the "Transportation Code" (V.C.T.A. CH.251)

The location and description of the proposed line and appurtenances is more fully shown by 3 copies of drawings attached to this notice.

Construction of this line is proposed to begin on or after the 7 day of AUGUST 2000.

APPROVAL

This application is hereby approved subject to the following understandings and restrictions.

It is expressly understood that the said County Commissioners' Court does not imply hereby to grant any right, claim, title or easement in or upon this County Road; and it is further understood that in the future, should Williamson County, for any reason, need to work, improve, relocate, widen, increase, add to, decrease, or in any manner change the structure of this road or right-of-way, this line, if affected, will be moved at the direction of the Williamson County Engineer or County Commissioner. This installation work shall not damage any part of the roadway and adequate provisions shall be made to cause a minimum of inconvenience to traffic and adjacent property owners.

APPROVED BY WILLIAMSON COUNTY COMMISSIONERS' COURT

BY: [Signature]  
COUNTY ROAD ADMINISTRATOR

DATE: 8/10/00

Firm: VERIZON

[Signature]  
Authorized Signature

MIKE CROW

Printed Name

Address: 1700 N. AUSTIN AVE.GEORGETOWN, TX. 78626Phone: 512-869-2270Fax: 512-8692291

**received**  
8-9-00

Pt. 3

8-9-00

ROW

R.J.

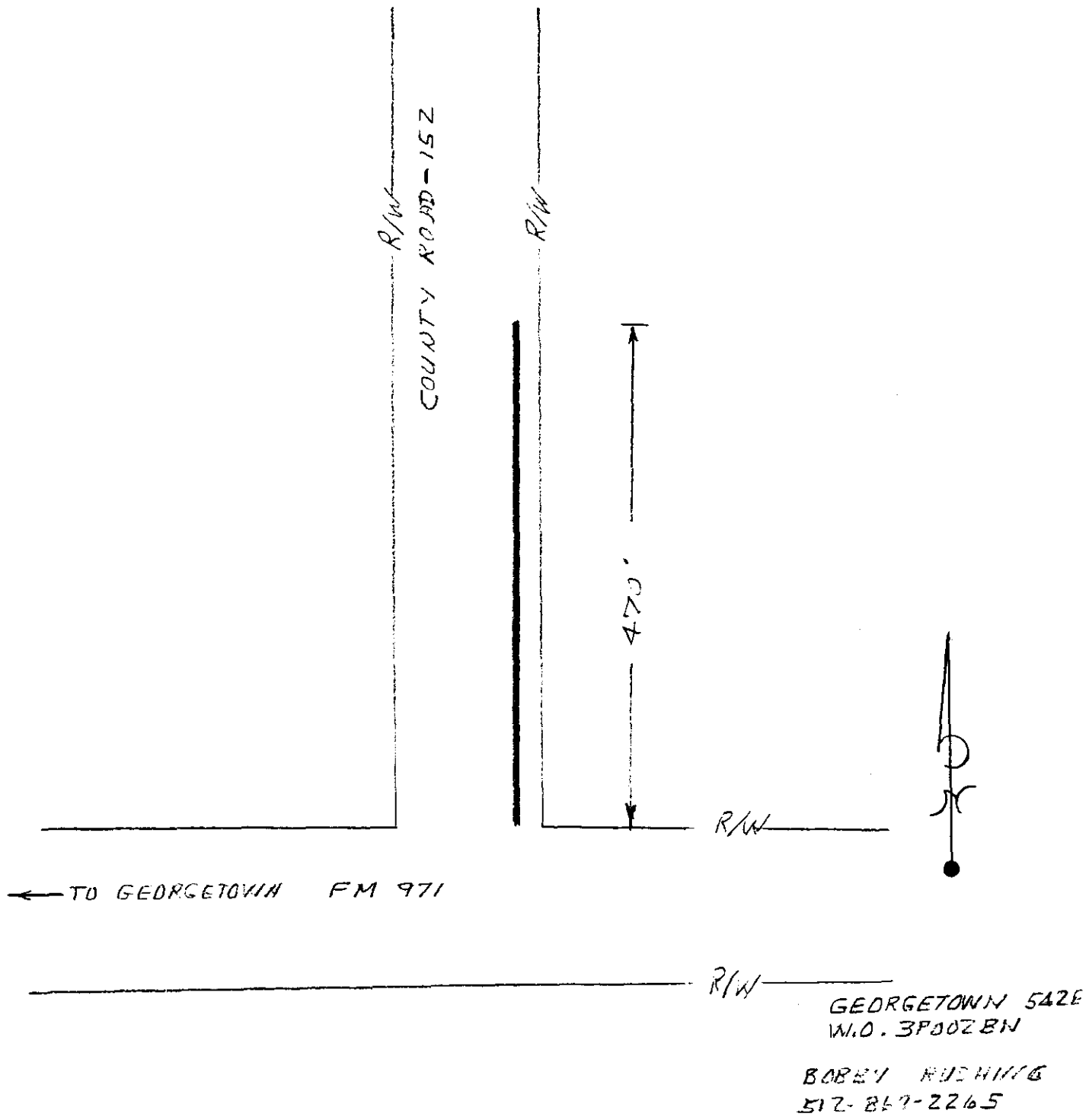

## Consent Agenda

The Consent Agenda includes non-controversial and routine items that the Court may act on with one single vote. The Judge or a Commissioner may pull any item from the Consent Agenda in order that the court discuss and act upon it individually as part of the Regular Agenda.  
(Items 5-23 )

### AGENDA ITEM 5

Consider approving a line item transfer for County Jail:

from:	0100-0570-004231	Travel	2,500.00
to:	0100-0570-003311	Uniforms	300.00
	0100-0570-004350	Printed Forms	700.00
	0100-0570-004232	Training	1,500.00

Moved: **Commissioner Limmer**

Seconded: **Commissioner Hays**

Motion: To approve line item transfer for County Jail:

from:	0100-0570-004231	Travel	2,500.00
to:	0100-0570-003311	Uniforms	300.00
	0100-0570-004350	Printed Forms	700.00
	0100-0570-004232	Training	1,500.00

Vote: Motion carried 3 – 0 with Commissioners Heiligenstein and Boatright absent from the dais.

< Clerk copy here >