

**AGENDA ITEM 4**

Consider noting in minutes any off right-of-way work on any county road done by Road & Bridge Unified System.

Moved: **Judge Doerfler**

Seconded: **Commissioner Hays**

Motion: To note in minutes off right-of-way opening drainage channel downstream of box culvert on the property of **Roland Kudla** on County Road 340 and note utility requests from:

**Chisholm Trail Special Utility District** to place a 20" D.I.P. water line within the right-of-way of County Road 268 and **TXU Electric & TXU Communication** to place a line within the right-of-way of Quick Hill Road also known as County Road 172 and future State Highway 45.

Vote: Motion carried 5 – 0

< Clerk copy here >

July 25, 2000

**UNIFIED ROAD SYSTEM**  
**OFF RIGHT-OF-WAY WORK**

1. CR 340 - Opening of drainage channel downstream of box culvert on the property of Roland Kudla.(EM - Pct. 4)

**WILLIAMSON COUNTY URS**  
Utility Requests – 07/25/00

**Precinct I**

- A. TXU Electric & TXU Communications
  1. Quick Hill Road (CR 172) - Bore

**Precinct II**

- A. Chisholm Trail S.U.D.
  1. CR 268 - Bore

**Precinct III**

- A. Chisholm Trail S.U.D.
  1. CR 268 - Bore (same as above)

**Precinct IV**

*noted 7-25-00*  
*John C. Doerfler*

**NOTICE OF PROPOSED INSTALLATION  
UTILITY LINE ON WILLIAMSON COUNTY RIGHT-OF-WAY**

**ROAD BORE PERMIT**

TO: Williamson County Unified Road System  
1900 Georgetown Inner Loop, Suite B  
Georgetown, Texas 78626

DATE: July 11, 2000

Formal notice is hereby given that CHISHOLM TRAIL SPECIAL UTILITY DISTRICT

Company proposes to place a 20" D.I.P. WATER

Line within the right-of-way of COUNTY ROAD 268  
as follows: (give location, length, general design, etc.)

The proposed utility line (20" D.I.P. Water Line including all appurtenances) location crosses County Road 268 approximately 300 feet south of the S.H. 29 intersection. The proposed alignment is as follows: Perpendicular to and offset approximately 5 feet west of the west R.O.W. of County Road 268 thence northeast approximately 78 feet east to an offset approximately 5 feet east of the east R.O.W. of County Road 268.

The line will be constructed and maintained on the road right-of-way as directed by the Williamson County Unified Road System in accordance with governing laws.

Our firm further understands that the County considers proper traffic control measures as those complying with applicable portions of the Texas Manual of Traffic Control Devices required for adoption by the "Transportation Code" (V.C.T.A. CH.251)

The location and description of the proposed line and appurtenances is more fully shown by 2 copies of drawings attached to this notice.

Construction of this line is proposed to begin on or after the 15 th day of July 20 00.

**APPROVAL**

This application is hereby approved subject to the following understandings and restrictions.

It is expressly understood that the said County Commissioners' Court does not imply hereby to grant any right, claim, title or easement in or upon this County Road; and it is further understood that in the future, should Williamson County for any reason, need to work, improve, relocate, widen, increase, add to, decrease, or in any manner change the structure of this road or right-of-way, this line, if affected will be moved at the direction of the Williamson County Engineer or County Commissioner. This installation work shall not damage any part of the roadway and adequate provisions shall be made to cause a minimum of inconvenience to traffic and adjacent property owners.

APPROVED BY WILLIAMSON COUNTY COMMISSIONERS' COURT

BY: Dreg Bergeson

DATE: 7/20/00

Firm: Chisholm Trail S.U.D.

Patricia B. Rodgers  
Authorized Signature

Patricia B. Rodgers, General Manager  
Printed Name

Address: P.O. Box 249

Florence, Tx 76527

Phone: 254-793-3103

Fax: 254-793-3100

RECEIVED JUL 18 2000

7-19-00

Bore

R.S.

<u>N/A</u>	NAME OF PERSON REQUESTING WATER SERVICE
<u>N/A</u>	SIDE OF ROAD EXISTING WATERLINE IS ON
<u>N/A</u>	DISTANCE WATERLINE IS FROM THE PAVEMENT
<u>48 " Min to top of bore</u>	WATERLINE IS BURIED HOW DEEP (DEPTH)
<u>18 Feet bore</u>	DEPTH OF CUT OR BORE TO BE MADE
<u>48" Min to top of bore</u>	SIZE OF LINE TO BE INSTALLED
<u>20" D.I.P.</u>	SIZE OF CASING
<u>Bid Date 7/27/00</u>	CONTRACTOR
<i>(Contractor will contact the county after the contract has been awarded)</i>	

DIRECTIONS:

On S.H. 29 approximately 6.025 miles West of the Georgetown City Limits.

\_\_\_\_\_

\_\_\_\_\_

PLEASE ATTACH A MAP

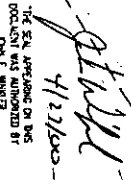

NO.	DATE	REMARKS	BY
REVISIONS			

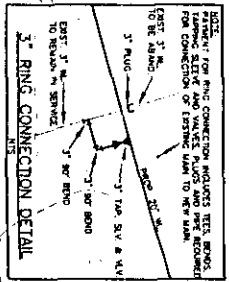
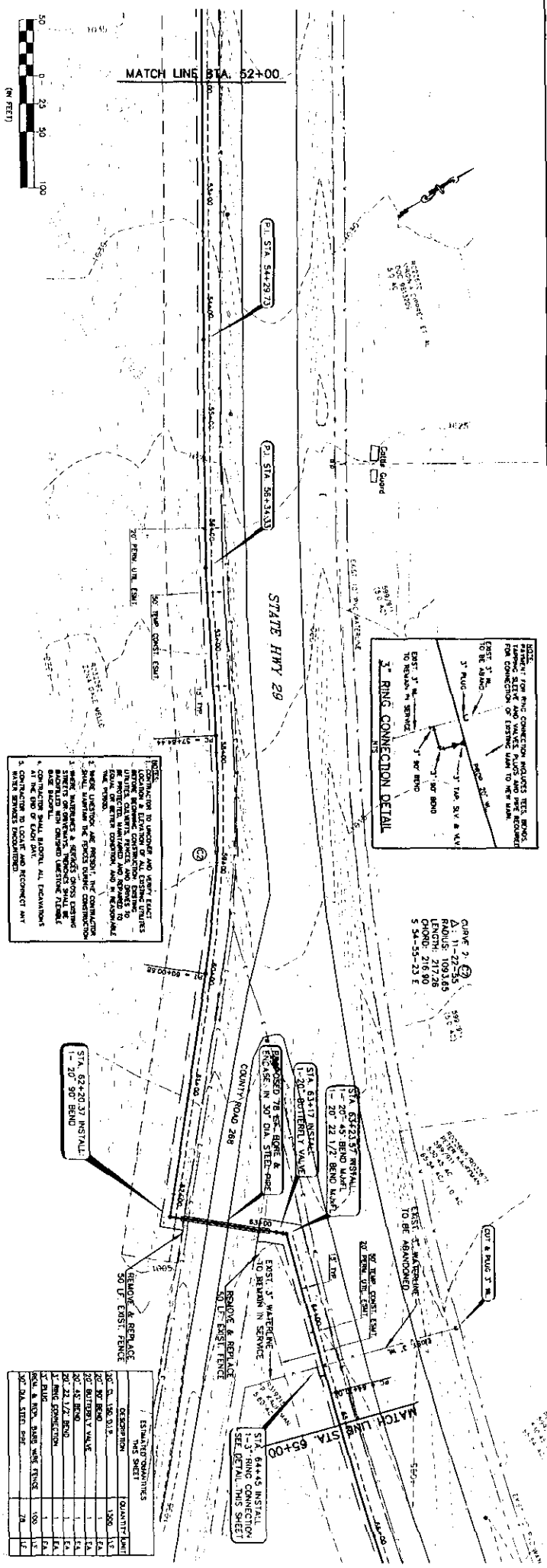
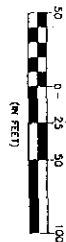

RECOMMENDATION TO UNCOVER AND REPAIR EXISTING SEWER LINE. LOCATIONS OF ALL EXISTING SEWERS, MANHOLES, AND CATCH BASINS SHALL BE LOCATED AND MARKED PRIOR TO CONSTRUCTION. THE CONTRACTOR SHALL BE RESPONSIBLE FOR OBTAINING ALL NECESSARY PERMITS AND FOR PROTECTING ALL UTILITIES. THE CONTRACTOR SHALL MAINTAIN ACCESS TO ALL ADJACENT PROPERTIES AND SHALL BE RESPONSIBLE FOR REPAIRING ANY DAMAGE TO ADJACENT PROPERTIES. THE CONTRACTOR SHALL MAINTAIN ADEQUATE DRAINAGE DURING CONSTRUCTION. THE CONTRACTOR SHALL BE RESPONSIBLE FOR OBTAINING ALL NECESSARY PERMITS AND FOR PROTECTING ALL UTILITIES. THE CONTRACTOR SHALL MAINTAIN ACCESS TO ALL ADJACENT PROPERTIES AND SHALL BE RESPONSIBLE FOR REPAIRING ANY DAMAGE TO ADJACENT PROPERTIES. THE CONTRACTOR SHALL MAINTAIN ADEQUATE DRAINAGE DURING CONSTRUCTION.

ESTIMATED QUANTITIES	
DESCRIPTION	QUANTITY
12" DIA. 30' BEND	1.00
12" DIA. 30' BEND	1.00
12" DIA. 30' BEND	1.00
12" DIA. 30' BEND	1.00
12" DIA. 30' BEND	1.00
12" DIA. 30' BEND	1.00
12" DIA. 30' BEND	1.00
12" DIA. 30' BEND	1.00
12" DIA. 30' BEND	1.00
12" DIA. 30' BEND	1.00

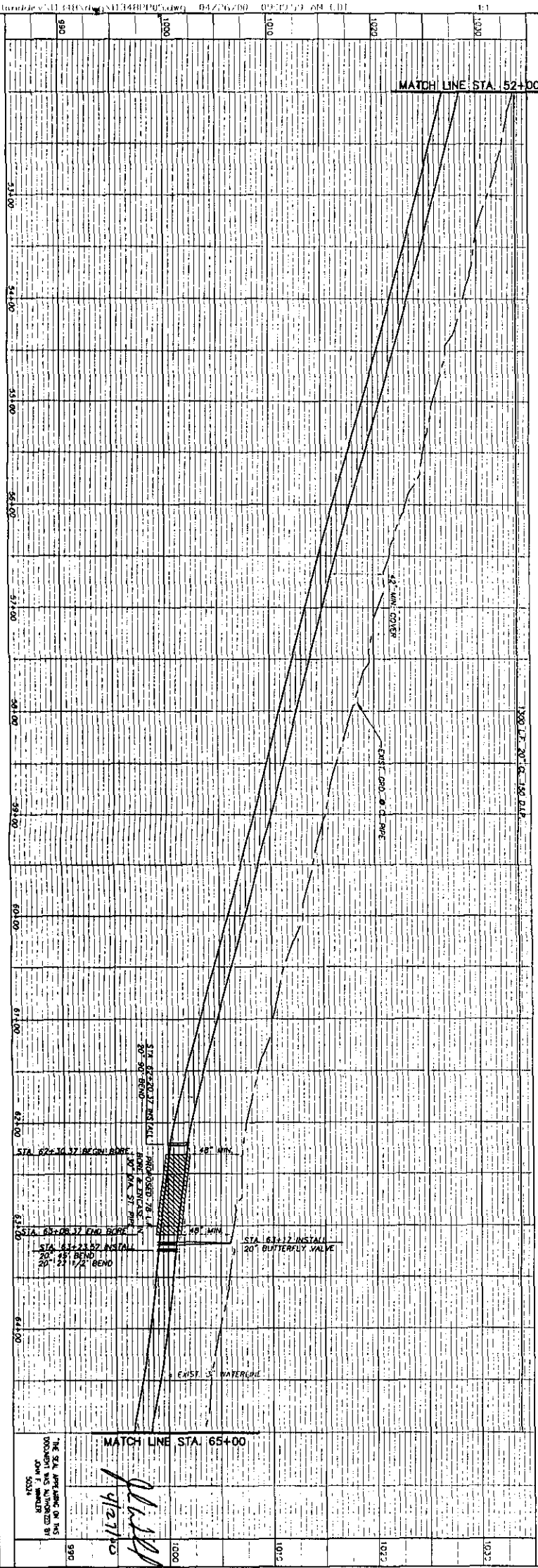

6

CHISHOLM TRAIL S.U.D.  
LEWIS & BOHLS HWY 29 MAIN  
STA 52+00 TO STA 65+00

The Wallace Group, Inc.  
Engineers • Architects • Planners • Surveyors

SURVEYED	DESIGNED	DRAWN	CHECKED	DATE	FILE NAME
PDN	JAB	JAB	JW	4/3/00	11348BPP05

NO.	DATE	REMARKS	BY
REVISIONS			

## NOTICE OF PROPOSED INSTALLATION

## UTILITY LINE ON WILLIAMSON COUNTY RIGHT-OF-WAY

TO: Williamson County Unified Road System  
1900 Georgetown Inner Loop, Suite B  
Georgetown, Texas 78626

DATE: 6-1-00

Formal notice is hereby given that TXU ELECTRIC & TXU COMMUNICATION

Company proposes to place a ELECTRIC AND COMMUNICATION

line within the right-of-way of QUICK HILL ROAD (A.K.A. C.R. 172)  
as follows: (give location, length, general design, etc.)

QUICK HILL ROAD (CR 172) AND FUTURE STATE HIGHWAY 45

APPROXIMATELY 100 FT IN LENGTH

BORE FOR A 18" AND 36" STEEL CASING (1/2" THICKNESS, FILLED WITH GROUT) UNDER QUICK HILL ROAD, MINIMUM COVERAGE OF 36" TO TOP OF PIPE

The line will be constructed and maintained on the road right-of-way as directed by the Williamson County Unified Road System in accordance with governing laws.

Our firm further understands that the County considers proper traffic control measures as those complying with applicable portions of the Texas Manual of Traffic Control Devices required for adoption by the "Transportation Code" (V.C.T.A. CH.251)

The location and description of the proposed line and appurtenances is more fully shown by 1 copies of drawings attached to this notice.

Construction of this line is proposed to begin on or after the 28 day of AUGUST 19 2000

APPROVAL

This application is hereby approved subject to the following understandings and restrictions.

It is expressly understood that the said County Commissioners' Court does not imply hereby to grant any right, claim, title or easement in or upon this County Road; and it is further understood that in the future, should Williamson County, for any reason, need to work, improve, relocate, widen, increase, add to, decrease, or in any manner change the structure of this road or right-of-way, this line, if affected, will be moved at the direction of the Williamson County Engineer or County Commissioner. This installation work shall not damage any part of the roadway and adequate provisions shall be made to cause a minimum of inconvenience to traffic and adjacent property owners.

APPROVED BY WILLIAMSON COUNTY COMMISSIONERS' COURT

BY: Ang Buz  
COUNTY ROAD ADMINISTRATOR

DATE: 7/18/00

Firm: TXU ELECTRIC

Les Davis  
Authorized Signature

LES DAVIS

Printed Name

Address: 3620 FRANKLIN AVE.

WACO, TX 76710

Phone: 254-750-5244

Fax: 254-750-5252

Pct. 1

7-14-00

Bore

R.J.

**REQUIREMENTS FOR WILLIAMSON COUNTY UTILITIES INSTALLATION PERMIT**

1. Complete "Notice of Proposed Installation Utility Line on Williamson County Right-of-Way", including describing the location and showing the sketch and details on the application.
2. Submit two (2) sets of the application with plans locating bore or cut along with detailed specifications including repair/restoration.
3. All work shall be in compliance with Williamson County Specifications.
4. A performance bond in the amount of \$500 minimum, executed by a surety company or surety companies authorized to execute surety bonds under and in accordance with the laws of the State of Texas. Exact amount of the bond to be determined by Williamson County depending on the extent of the project.
5. Traffic handling plans, in compliance with the Texas Manual on Uniform Traffic Control Devices, shall be submitted with application.
6. Contractor shall file a "Contractor's Liability Agreement" prior to issuance of permit (attached).
7. Franchised utilities (City of Austin, Southern Union Gas, Southwestern Bell, etc.) are not required to provide a bond or pay a permit fee if they do the work with their own work forces. Contractors will pay a fee of \$120.00.
8. Contractor shall notify the Williamson County Unified Road System at least 48 hours prior to start of construction at (512) 930-3330.
9. If there are any questions, contact the Williamson County Unified Road System at (512) 930-3330.

**WILLIAMSON COUNTY UNIFIED ROAD SYSTEM**

1900 Georgetown Inner Loop, Suite B

Georgetown, Texas 78626

(512) 930-3330

---

## PERPENDICULAR UTILITY CUT DESIGN IN WILLIAMSON COUNTY R.O.W.

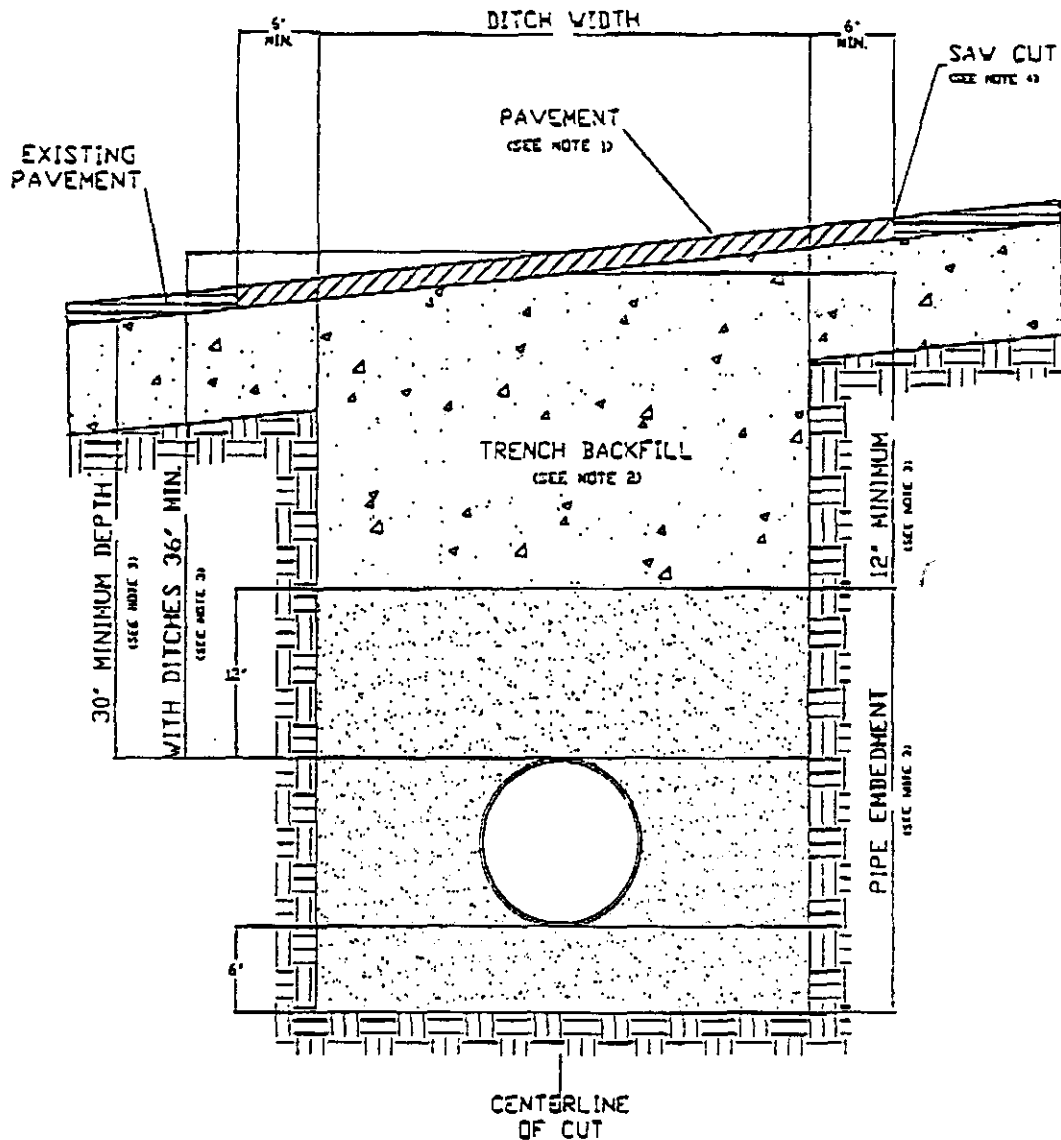

1. Hot mix asphalt 1 1/2" min. thickness. Roll in place to match existing surface, + or - 1/8" tolerance.
2. Trench backfill shall be flexible base, compacted to 95% optimum in 8" layers unless otherwise approved and specified. Flexible base to match existing base thickness or 8 inches, whichever is greater ( specifications: TxDOT Item 247, Type A, Grade 2).
3. Pipe embedment (pipe envelope) size and materials shall be as specified elsewhere by utility company and/or its engineers. Pipe depth shall be as specified elsewhere provided that minimum depths are met.
4. Saw cut shall be made prior to ditch cut. If pavement is damaged during cut, a new saw cut shall be made beyond the damaged area and new pavement placed.
5. Where roadside ditches (bar ditches) are crossed by the utility pipe, minimum depth to the top of the pipe from centerline road elevation will be 36".
6. All pavement repair shall conform to Item 351 Repairing Existing Flexible Pavement Structure as found in the 1993 Texas Department of Transportation Standard Specifications for Construction of Highways.

Form No. 901

**TU ELECTRIC**

FIELD SKETCH

W.A. No. N.A.

Preliminary

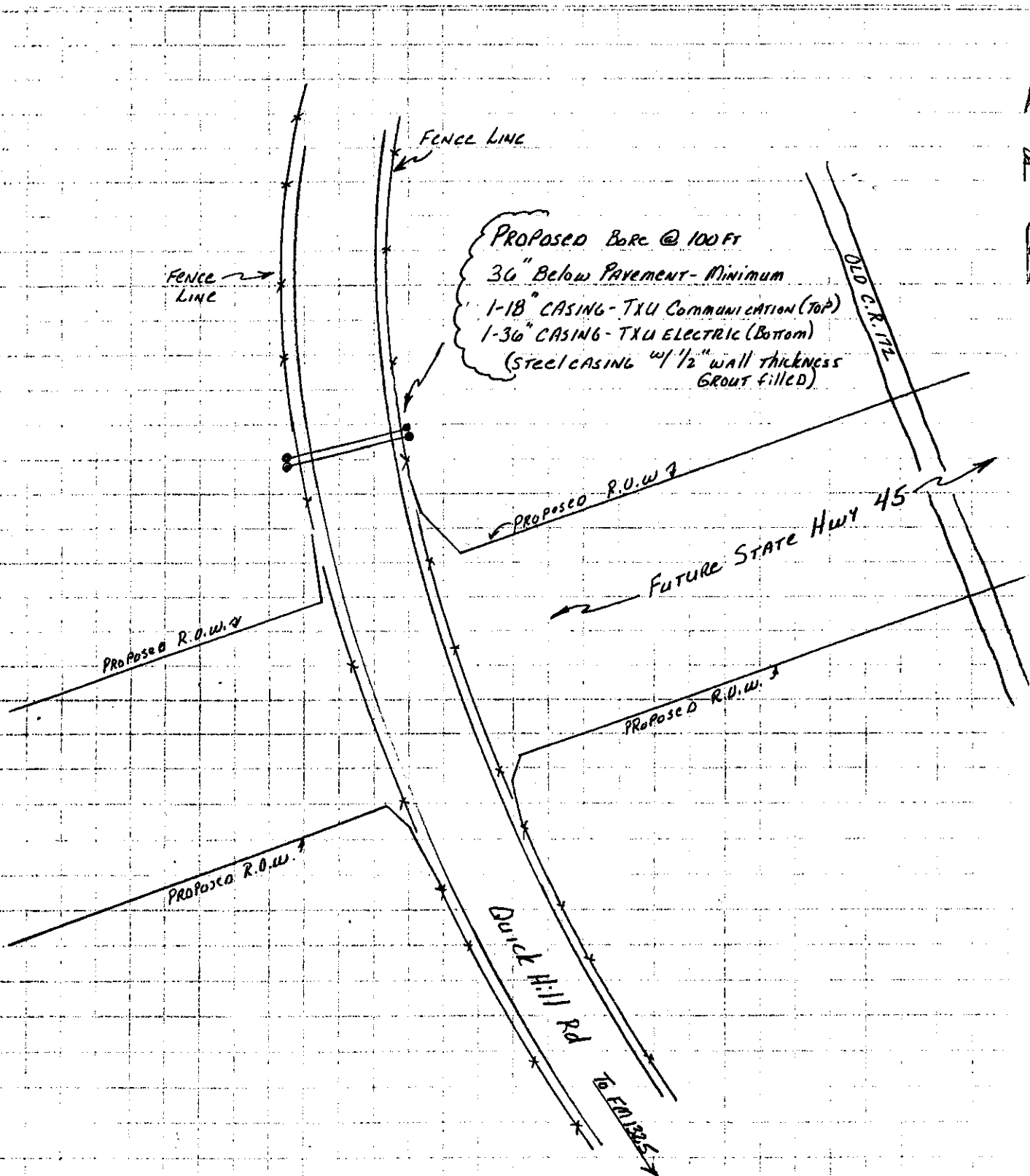
Map No.       Sheet No.       ER No.       No. or  
Project No. 1217305Scale N.T.S.Town or County Williamson Co

## Consent Agenda

The Consent Agenda includes non-controversial and routine items that the Court may act on with one single vote. The Judge or a Commissioner may pull any item from the Consent Agenda in order that the court discuss and act upon it individually as part of the Regular Agenda.

(Items 5- 14)

## AGENDA ITEM 5

Consider approving line item transfer for Tax Assessor Collector:

from: 0100-0499-005750	Furniture/Equip.	1,100.00
to: 0100-0499-005741	Computer Software	1,100.00

Moved: **Commissioner Boatright**

Seconded: **Judge Doerfler**

Motion: To approve line item transfer for Tax Assessor-Collector:

from: 0100-0499-005750	Furniture/Equip.	1,100.00
to: 0100-0499-005741	Computer Software	1,100.00

Vote: Motion carried 5 – 0

< Clerk copy here >