

AGENDA ITEM #4

Consider noting in minutes any off right-of-way work on any County road done by Road & Bridge Unified System.

Moved: **Commissioner Boatright**

Seconded: **Judge Doerfler**

Motion: To note utility easements

**Jonah Water S.U.D.** for bore CR 100.

Vote: 5 - 0

<Clerk copy here>

**WILLIAMSON COUNTY URS**

Utility Requests - 04/04/00

**Precinct I**

**Precinct II**

**Precinct III**

**Precinct IV**

- A.     **Jonah Water S.U.D.**  
1.     **CR 100 - Bore**

*noted 4-4-00  
John C. Doerfler*

NOTICE OF PROPOSED INSTALLATION

087

UTILITY LINE ON WILLIAMSON COUNTY RIGHT-OF-WAY

TO: Williamson County Unified Road System  
1900 Georgetown Inner Loop, Suite B  
Georgetown, Texas 78626

DATE: 3-22-00

Formal notice is hereby given that

JONAH WATER S.U.D.

Company proposes to place a

ROAD BORE - 6" Sleeve

line within the right-of-way of

County Rd. 100

as follows: (give location, length, general design, etc.)

See ATTACHED MAP

The line will be constructed and maintained on the road right-of-way as directed by the Williamson County Unified Road System in accordance with governing laws.

Our firm further understands that the County considers proper traffic control measures as those complying with applicable portions of the Texas Manual of Traffic Control Devices required for adoption by the "Transportation Code" (V.C.T.A. CH.251)

The location and description of the proposed line and appurtenances is more fully shown by 2 copies of drawings attached to this notice.

Construction of this line is proposed to begin on or after the 27th day of MARCH 2000

APPROVAL

This application is hereby approved subject to the following understandings and restrictions.

It is expressly understood that the said County Commissioners' Court does not imply hereby to grant any right, claim, title or easement in or upon this County Road; and it is further understood that in the future, should Williamson County, for any reason, need to work, improve, relocate, widen, increase, add to, decrease, or in any manner change the structure of this road or right-of-way, this line, if affected, will be moved at the direction of the Williamson County Engineer or County Commissioner.

This installation work shall not damage any part of the roadway and adequate provisions shall be made to cause a minimum of inconvenience to traffic and adjacent property owners.

APPROVED BY WILLIAMSON COUNTY COMMISSIONERS' COURT

BY: Sue Bergum  
COUNTY ROAD ADMINISTRATOR

Firm: JONAH WATER S.U.D.

By: KEN HALL

(Print Name)

Title: ASST. Manager

Address: 40 C.R. 126

Georgetown Tx. 78626

Phone: (512) 863-2235

Fax: (512) 869-5402

received  
3-22-00

pd. 4

3-30-00

Bore  
R-1

CONTRACTOR'S LIABILITY AGREEMENT

088

I, KEN HALL, <sup>Employer</sup>~~Contractor~~ for SONAH WATER S.U.D.  
in Williamson County, Texas do hereby agree to the following schedules and conditions for doing work  
within the right-of-way of County Rd. 100 which is a public  
roadway maintained by Williamson County.

1. I will contact the Williamson County Unified Road System at least 48 hours prior to start of construction.
2. All work in the right-of-way will be done between the hours of 8:30 a.m. and 4:30 p.m. on Monday through Friday only.
3. Cuts will be opened for one-half the roadway only, with flagmen on both sides of the work area, allowing one-way traffic through. This type of operation will be held to a minimum and all advance warning signs and barricades shall be as specified in the Texas Manual on Uniform Traffic Control Devices. These cuts will also be filled and entire roadway opened at night and on weekends.
4. Roadside work in ditches alongside the trenched surface may be left opened at night, only if they can be barricaded solidly between open ditch and traveled roadway leaving a minimum 6' of road shoulder between the pavement edge and the barricades. The barricades must be reflectorized and lighted with warning lights and conform to the requirements of the T.M.U.T.C.D. for nighttime use.
5. Any construction area to be maintained from dusk to dawn shall have Type B High Intensity Steady Burn Warning Lights to delineate the traveled way through and around obstructions in a construction or maintenance area. All warning lights shall be installed to a minimum mounting height of 36" to the bottom of the lense.
6. Construction work and road repair on County right-of-way will be done to Williamson County Standards and to the approval of the Williamson County Unified Road System.
7. I will notify the Williamson County Unified Road System and obtain approval prior to any changes from this agreement if required due to soil conditions or other problems.

3-22-00

DATE

Williamson County Unified Road System  
1900 Georgetown Inner Loop, Ste. B  
Georgetown, Texas 78626

Ken Hall

SIGNED

J.W.S.U.D.

CONTRACTOR (PRINT NAME)

40 CR. 126

ADDRESS

Georgetown TX. 78626

CITY, STATE, ZIP CODE

(512) 863-2235

PHONE

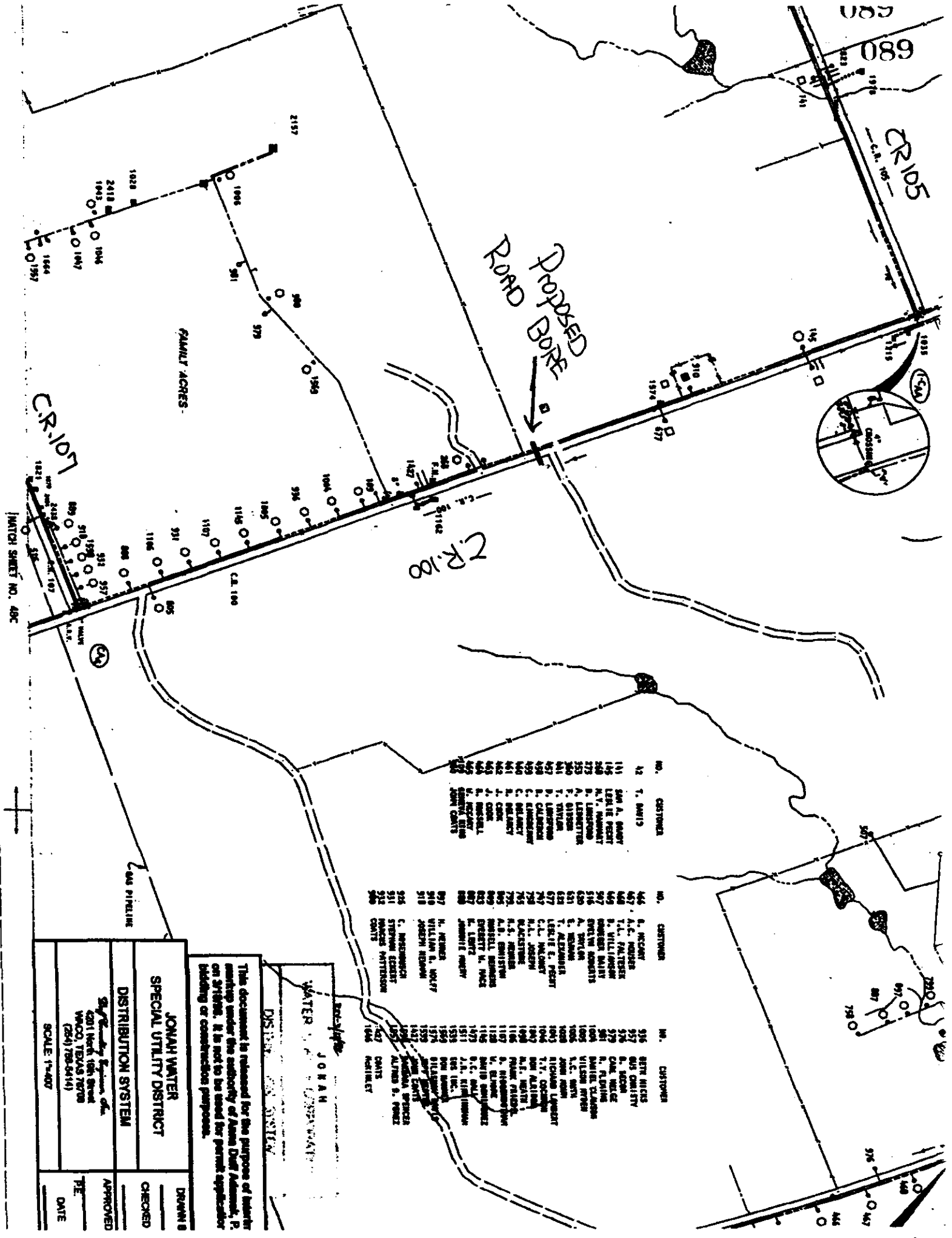

CUSTOMER	
NO.	CUSTOMER
32	T. DAVIS
141	SAH A. GAWAY
146	LESLIE PECK
268	H.V. HANWALT
373	B. LAMBERT
383	F. GIBSON
441	T. VIVIAN
457	B. LAMBERT
459	C. CLARKSON
460	C. LAMBERT
461	C. MCCLARY
462	J. COOK
463	B. MCCLARY
464	B. MCCLARY
465	B. MCCLARY
466	B. MCCLARY
467	B. MCCLARY
468	B. MCCLARY
469	B. MCCLARY
470	B. MCCLARY
471	B. MCCLARY
472	B. MCCLARY
473	B. MCCLARY
474	B. MCCLARY
475	B. MCCLARY
476	B. MCCLARY
477	B. MCCLARY
478	B. MCCLARY
479	B. MCCLARY
480	B. MCCLARY
481	B. MCCLARY
482	B. MCCLARY
483	B. MCCLARY
484	B. MCCLARY
485	B. MCCLARY
486	B. MCCLARY
487	B. MCCLARY
488	B. MCCLARY
489	B. MCCLARY
490	B. MCCLARY
491	B. MCCLARY
492	B. MCCLARY
493	B. MCCLARY
494	B. MCCLARY
495	B. MCCLARY
496	B. MCCLARY
497	B. MCCLARY
498	B. MCCLARY
499	B. MCCLARY
500	B. MCCLARY
501	B. MCCLARY
502	B. MCCLARY
503	B. MCCLARY
504	B. MCCLARY
505	B. MCCLARY
506	B. MCCLARY
507	B. MCCLARY
508	B. MCCLARY
509	B. MCCLARY
510	B. MCCLARY
511	B. MCCLARY
512	B. MCCLARY
513	B. MCCLARY
514	B. MCCLARY
515	B. MCCLARY
516	B. MCCLARY
517	B. MCCLARY
518	B. MCCLARY
519	B. MCCLARY
520	B. MCCLARY
521	B. MCCLARY
522	B. MCCLARY
523	B. MCCLARY
524	B. MCCLARY
525	B. MCCLARY
526	B. MCCLARY
527	B. MCCLARY
528	B. MCCLARY
529	B. MCCLARY
530	B. MCCLARY
531	B. MCCLARY
532	B. MCCLARY
533	B. MCCLARY
534	B. MCCLARY
535	B. MCCLARY
536	B. MCCLARY
537	B. MCCLARY
538	B. MCCLARY
539	B. MCCLARY
540	B. MCCLARY
541	B. MCCLARY
542	B. MCCLARY
543	B. MCCLARY
544	B. MCCLARY
545	B. MCCLARY
546	B. MCCLARY
547	B. MCCLARY
548	B. MCCLARY
549	B. MCCLARY
550	B. MCCLARY
551	B. MCCLARY
552	B. MCCLARY
553	B. MCCLARY
554	B. MCCLARY
555	B. MCCLARY
556	B. MCCLARY
557	B. MCCLARY
558	B. MCCLARY
559	B. MCCLARY
560	B. MCCLARY
561	B. MCCLARY
562	B. MCCLARY
563	B. MCCLARY
564	B. MCCLARY
565	B. MCCLARY
566	B. MCCLARY
567	B. MCCLARY
568	B. MCCLARY
569	B. MCCLARY
570	B. MCCLARY
571	B. MCCLARY
572	B. MCCLARY
573	B. MCCLARY
574	B. MCCLARY
575	B. MCCLARY
576	B. MCCLARY
577	B. MCCLARY
578	B. MCCLARY
579	B. MCCLARY
580	B. MCCLARY
581	B. MCCLARY
582	B. MCCLARY
583	B. MCCLARY
584	B. MCCLARY
585	B. MCCLARY
586	B. MCCLARY
587	B. MCCLARY
588	B. MCCLARY
589	B. MCCLARY
590	B. MCCLARY
591	B. MCCLARY
592	B. MCCLARY
593	B. MCCLARY
594	B. MCCLARY
595	B. MCCLARY
596	B. MCCLARY
597	B. MCCLARY
598	B. MCCLARY
599	B. MCCLARY
600	B. MCCLARY
601	B. MCCLARY
602	B. MCCLARY
603	B. MCCLARY
604	B. MCCLARY
605	B. MCCLARY
606	B. MCCLARY
607	B. MCCLARY
608	B. MCCLARY
609	B. MCCLARY
610	B. MCCLARY
611	B. MCCLARY
612	B. MCCLARY
613	B. MCCLARY
614	B. MCCLARY
615	B. MCCLARY
616	B. MCCLARY
617	B. MCCLARY
618	B. MCCLARY
619	B. MCCLARY
620	B. MCCLARY
621	B. MCCLARY
622	B. MCCLARY
623	B. MCCLARY
624	B. MCCLARY
625	B. MCCLARY
626	B. MCCLARY
627	B. MCCLARY
628	B. MCCLARY
629	B. MCCLARY
630	B. MCCLARY
631	B. MCCLARY
632	B. MCCLARY
633	B. MCCLARY
634	B. MCCLARY
635	B. MCCLARY
636	B. MCCLARY
637	B. MCCLARY
638	B. MCCLARY
639	B. MCCLARY
640	B. MCCLARY
641	B. MCCLARY
642	B. MCCLARY
643	B. MCCLARY
644	B. MCCLARY
645	B. MCCLARY
646	B. MCCLARY
647	B. MCCLARY
648	B. MCCLARY
649	B. MCCLARY
650	B. MCCLARY
651	B. MCCLARY
652	B. MCCLARY
653	B. MCCLARY
654	B. MCCLARY
655	B. MCCLARY
656	B. MCCLARY
657	B. MCCLARY
658	B. MCCLARY
659	B. MCCLARY
660	B. MCCLARY
661	B. MCCLARY
662	B. MCCLARY
663	B. MCCLARY
664	B. MCCLARY
665	B. MCCLARY
666	B. MCCLARY
667	B. MCCLARY
668	B. MCCLARY
669	B. MCCLARY
670	B. MCCLARY
671	B. MCCLARY
672	B. MCCLARY
673	B. MCCLARY
674	B. MCCLARY
675	B. MCCLARY
676	B. MCCLARY
677	B. MCCLARY
678	B. MCCLARY
679	B. MCCLARY
680	B. MCCLARY
681	B. MCCLARY
682	B. MCCLARY
683	B. MCCLARY
684	B. MCCLARY
685	B. MCCLARY
686	B. MCCLARY
687	B. MCCLARY
688	B. MCCLARY
689	B. MCCLARY
690	B. MCCLARY
691	B. MCCLARY
692	B. MCCLARY
693	B. MCCLARY
694	B. MCCLARY
695	B. MCCLARY
696	B. MCCLARY
697	B. MCCLARY
698	B. MCCLARY
699	B. MCCLARY
700	B. MCCLARY

WATER DISTRIBUTION SYSTEM

JONAH WATER SPECIAL UTILITY DISTRICT

DRAWN BY

CHECKED

APPROVED

DATE

SCALE 1"=400'

247 E. Highway 100, Waco, Texas 76708 (254) 768-5414

PE

DATE

This document is released for the purpose of water supply under the authority of James Earl Adams, Jr. on 1/1/1988. It is not to be used for permit application bidding or construction purposes.

Consent Agenda

The Consent Agenda includes non-controversial and routine items that the Court may act on with one single vote. The Judge or a Commissioner may pull any item from the Consent Agenda in order that the court discuss and act upon it individually as part of the Regular Agenda.  
(Items 5-19 )

AGENDA ITEM #5

Consider approving a line item transfer for Tax Assessor/Collector:

from:	0100-0499-005750	Office Furniture	525.00
	0100-0499-005740	Computer Equip	305.00
to:	0100-0499-003005	Office Furniture	525.00
	0100-0499-003010	Computer Equip	305.00

Moved: **Commissioner Heiligenstein**

Seconded: **Judge Doerfler**

Motion: To approve a line item transfer for Tax Assessor/Collector

from:	0100-0499-005750	Office Furniture	525.00
	0100-0499-005740	Computer Equip	305.00
to:	0100-0499-003005	Office Furniture	525.00
	0100-0499-003010	Computer Equip	305.00

Vote: 5 - 0

<Clerk copy here>