

AGENDA ITEM # 4**April 6, 1999****VOL.103, pg.421**

Consider noting in minutes any off right-of-way work on any county road done by Road and Bridge Unified System.

Moved: Judge Doerfler

Seconded: Commissioner Hays

Motion: To note in minutes utility requests from **Bell-Milam-Falls-Water Supply Corporation** for bores on County Roads 352 and 354;

Chisholm Trail Special Utility District for bore at 2350 County Road 233;

City of Georgetown for road cuts at 212 Spanish Oak Drive and 417 Logan Ranch Road;

Southwestern Bell Telephone for bores on County Road 200 and Great Oaks Drive at Conchos Valley Drive;

Southwestern Milam Water Supply Corporation for bore on County Road 427.

Vote: Motion carried 5 - 0

< Clerk copy here >

WILLIAMSON COUNTY URS

Utility Requests - 04/06/99

Precinct I

Precinct II

- A. SWBT
 - 1. CR 200 - Bore

Precinct III

- A. Chisholm Trail S.U.D.
 - 1. CR 233 - Bore
- B. SWBT
 - 1. Great Oaks Dr. - Bore
- C. The City of Georgetown
 - 1. 212 Spanish Oak Drive - Road cut
 - 2. 417 Logan Ranch Road - Road cut

Precinct IV

- A. Bell-Milam-Falls Water Supply Corporation
 - 1. CR 352 & CR 354 - Bore
- B. Southwestern Milam Water Supply Corporation
 - 1. CR 427 - Bore

047

*noted 4-6-99
John C. Doerfler*

NOTICE OF PROPOSED INSTALLATION
UTILITY LINE ON WILLIAMSON COUNTY RIGHT-OF-WAYTO: Williamson County Unified Road System
1900 Georgetown Inner Loop, Suite B
Georgetown, Texas 78626

DATE: 3/22/99

Formal notice is hereby given that Bell-Milam-Falls Water Supply CorporationCompany proposes to place a water lineline within the right-of-way of CR 352 & CR 354
as follows: (give location, length, general design, etc.)**Bore and encase a 3" PVC water line in a 6" PVC encasement.****Location: Approximately 60 ft. West of Intersection of CR 352 & CR 354.**

The line will be constructed and maintained on the road right-of-way as directed by the Williamson County Unified Road System in accordance with governing laws.

Our firm further understands that the County considers proper traffic control measures as those complying with applicable portions of the Texas Manual of Traffic Control Devices required for adoption by the "Transportation Code" (V.C.T.A. CH.251)

The location and description of the proposed line and appurtenances is more fully shown by 2 copies of drawings attached to this notice.

Construction of this line is proposed to begin on or after the 5th day of April 19 99.

APPROVAL

This application is hereby approved subject to the following understandings and restrictions.

It is expressly understood that the said County Commissioners' Court does not imply hereby to grant any right, claim, title or easement in or upon this County Road; and it is further understood that in the future, should Williamson County, for any reason, need to work, improve, relocate, widen, increase, add to, decrease, or in any manner change the structure of this road or right-of-way, this line, if affected, will be moved at the direction of the Williamson County Engineer or County Commissioner. This installation work shall not damage any part of the roadway and adequate provisions shall be made to cause a minimum of inconvenience to traffic and adjacent property owners.

APPROVED BY WILLIAMSON COUNTY COMMISSIONERS' COURT

BY: *Ang Key*
COUNTY ROAD ADMINISTRATORDATE: 4/6/99Firm: BELL-MILAM-FALLS WSCBy: Dwayne Jekel, Manager
(Print Name)

Title: _____

Address: P. O. Drawer 150
Cameron, Texas 76520Phone: (254) 697-4016Fax: (254) 697-2294*Pd. 4 4-1-99**Bore**RJ.*

048

CONTRACTOR'S LIABILITY AGREEMENT

I, D & L Servie Co., Inc., Contractor for Bell-Milam-Falls Water Supply Corp.
in Williamson County, Texas do hereby agree to the following schedules and conditions for doing work
within the right-of-way of CR 352 & CR 354 which is a public
roadway maintained by Williamson County.

1. I will contact the Williamson County Unified Road System at least 48 hours prior to start of construction.
2. All work in the right-of-way will be done between the hours of 8:30 a.m. and 4:30 p.m. on Monday through Friday only.
3. Cuts will be opened for one-half the roadway only, with flagmen on both sides of the work area, allowing one-way traffic through. This type of operation will be held to a minimum and all advance warning signs and barricades shall be as specified in the Texas Manual on Uniform Traffic Control Devices. These cuts will also be filled and entire roadway opened at night and on weekends.
4. Roadside work in ditches alongside the trenched surface may be left opened at night, only if they can be barricaded solidly between open ditch and traveled roadway leaving a minimum 6' of road shoulder between the pavement edge and the barricades. The barricades must be reflectorized and lighted with warning lights and conform to the requirements of the T.M.U.T.C.D. for nighttime use.
5. Any construction area to be maintained from dusk to dawn shall have Type B High Intensity Steady Burn Warning Lights to delineate the traveled way through and around obstructions in a construction or maintenance area. All warning lights shall be installed to a minimum mounting height of 36" to the bottom of the lense.
6. Construction work and road repair on County right-of-way will be done to Williamson County Standards and to the approval of the Williamson County Unified Road System.
7. I will notify the Williamson County Unified Road System and obtain approval prior to any changes from this agreement if required due to soil conditions or other problems.

3-22-99

DATE

Williamson County Unified Road System
1900 Georgetown Inner Loop, Ste. B
Georgetown, Texas 78626

SIGNED

D & L SERVICE CO., INC.
CONTRACTOR (PRINT NAME)

30 West FM 485

ADDRESS

Cameron, Texas 76520
CITY, STATE, ZIP CODE

(254) 697-4016
PHONE

VOL 0103 PAGE 423

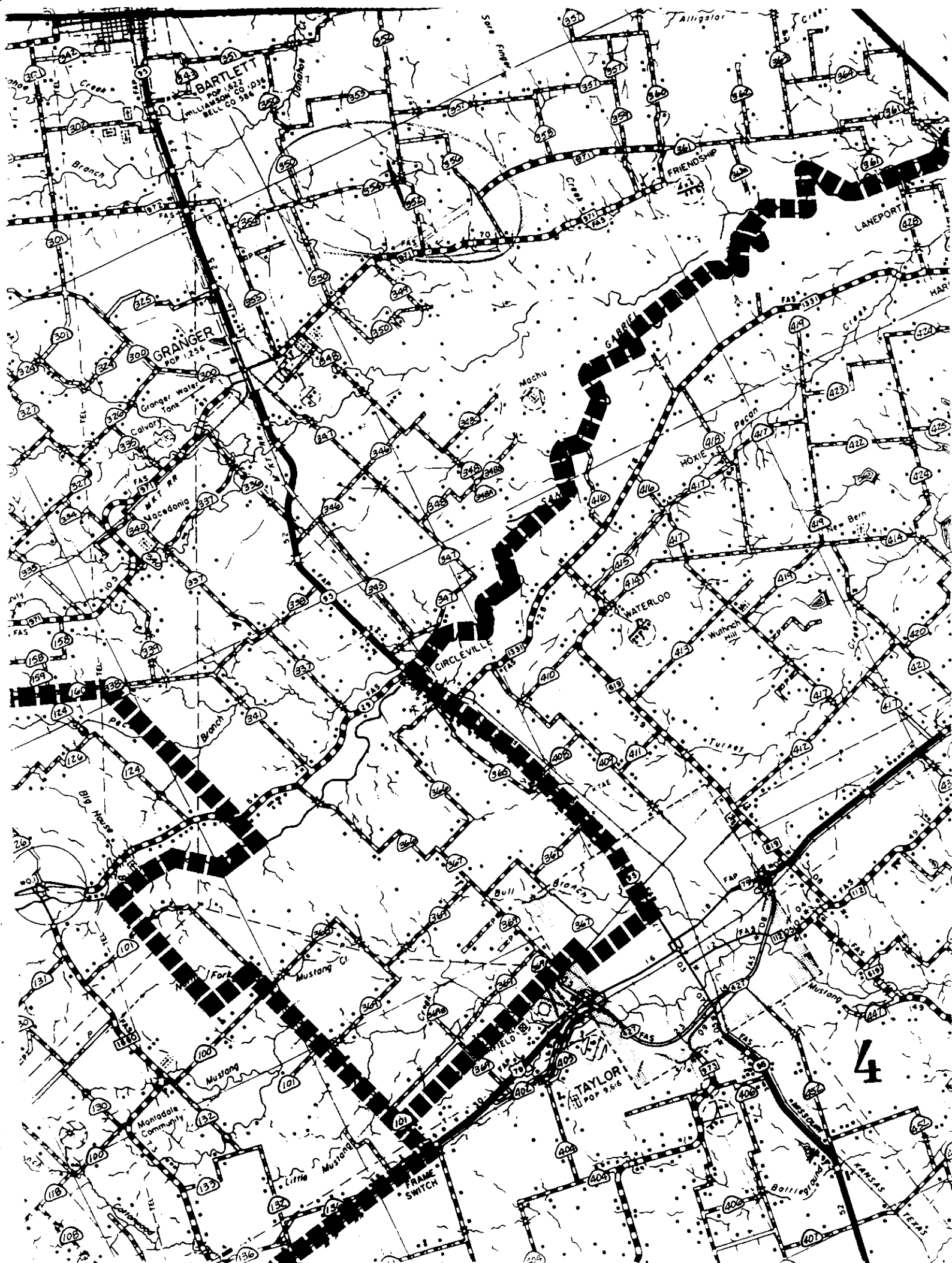

PICKEL

NOTICE OF PROPOSED INSTALLATION

VOL 0103 PAGE 425

UTILITY LINE ON WILLIAMSON COUNTY RIGHT-OF-WAY
ROAD BORE PERMIT

TO: Williamson County Unified Road System
1900 Georgetown Inner Loop, Suite B
Georgetown, Texas 78626

DATE: 2-2-99

Formal notice is hereby given that CHISHOLM TRAIL SPECIAL UTILITY DISTRICT
Company proposes to place a 3/4" waterline in a 4" casing (PVC)
line within the right-of-way of County Road 233 (2350 County Road 233)
as follows: (give location, length, general design, etc.)

Chisholm Trail intends to place a 3/4" waterline in a 4" pvc casing in a road bore at 2350 County Road 233. The existing Chisholm Trail waterline is on the South side fo the road, 30' from the pavement and buried 36" deep. The width of the pavement is 17'. The depth of the road bore to be made will be 40".

Contractor will be Capitol City Construction (Alvin Kerlin)

The line will be constructed and maintained on the road right-of-way as directed by the Williamson County Unified Road System in accordance with governing laws.

Our firm further understands that the County considers proper traffic control measures as those complying with applicable portions of the Texas Manual of Traffic Control Devices required for adoption by the "Transportation Code" (V.C.T.A. CH.251)

The location and description of the proposed line and appurtenances is more fully shown by 2 copies of drawings attached to this notice.

Construction of this line is proposed to begin on or after the 5 day of February 19 99.

APPROVAL

This application is hereby approved subject to the following understandings and restrictions.

It is expressly understood that the said County Commissioners' Court does not imply hereby to grant any right, claim, title or easement in or upon this County Road; and it is further understood that in the future, should Williamson County, for any reason, need to work, improve, relocate, widen, increase, add to, decrease, or in any manner change the structure of this road or right-of-way, this line, if affected, will be moved at the direction of the Williamson County Engineer or County Commissioner. This installation work shall not damage any part of the roadway and adequate provisions shall be made to cause a minimum of inconvenience to traffic and adjacent property owners.

APPROVED BY WILLIAMSON COUNTY COMMISSIONERS' COURT

BY: Arg. Begun
COUNTY ROAD ADMINISTRATOR

DATE: 3/31/99

Firm: Chisholm Trail S.U.D.

Patricia B. Rodgers
Authorized Signature

Patricia B. Rodgers, General Manager

Printed Name

Address: P O Box 249
Florence, Tx 76527

Phone: 254/793-3103

Fax: 254/793-3100

pt. 3

051

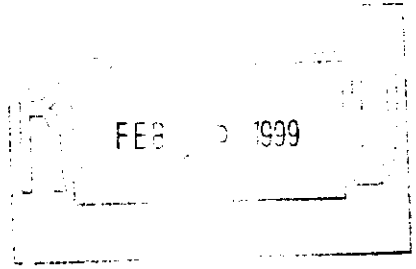

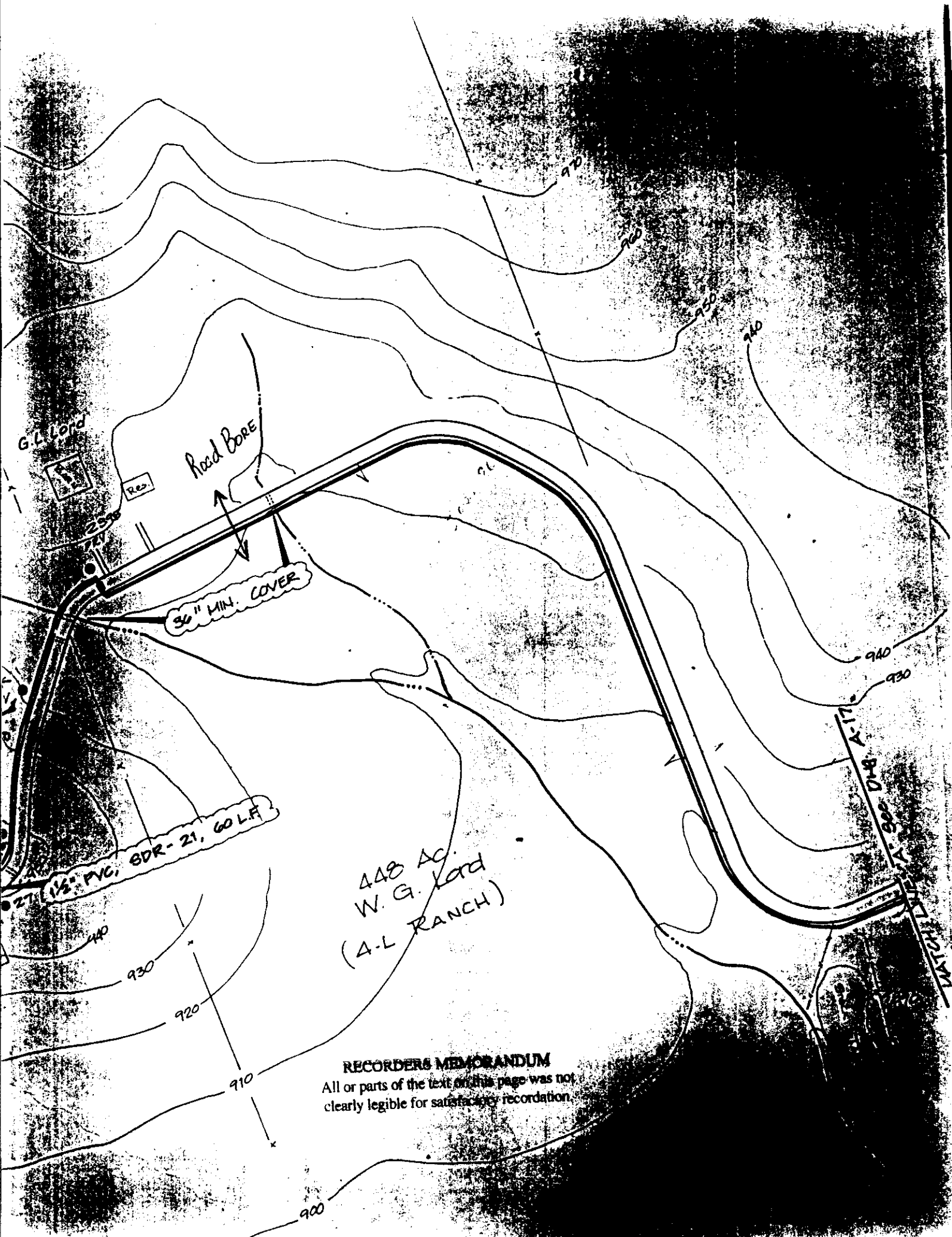

RECORDERS MEMORANDUM
All or parts of the text on this page was not
clearly legible for satisfactory recordation.

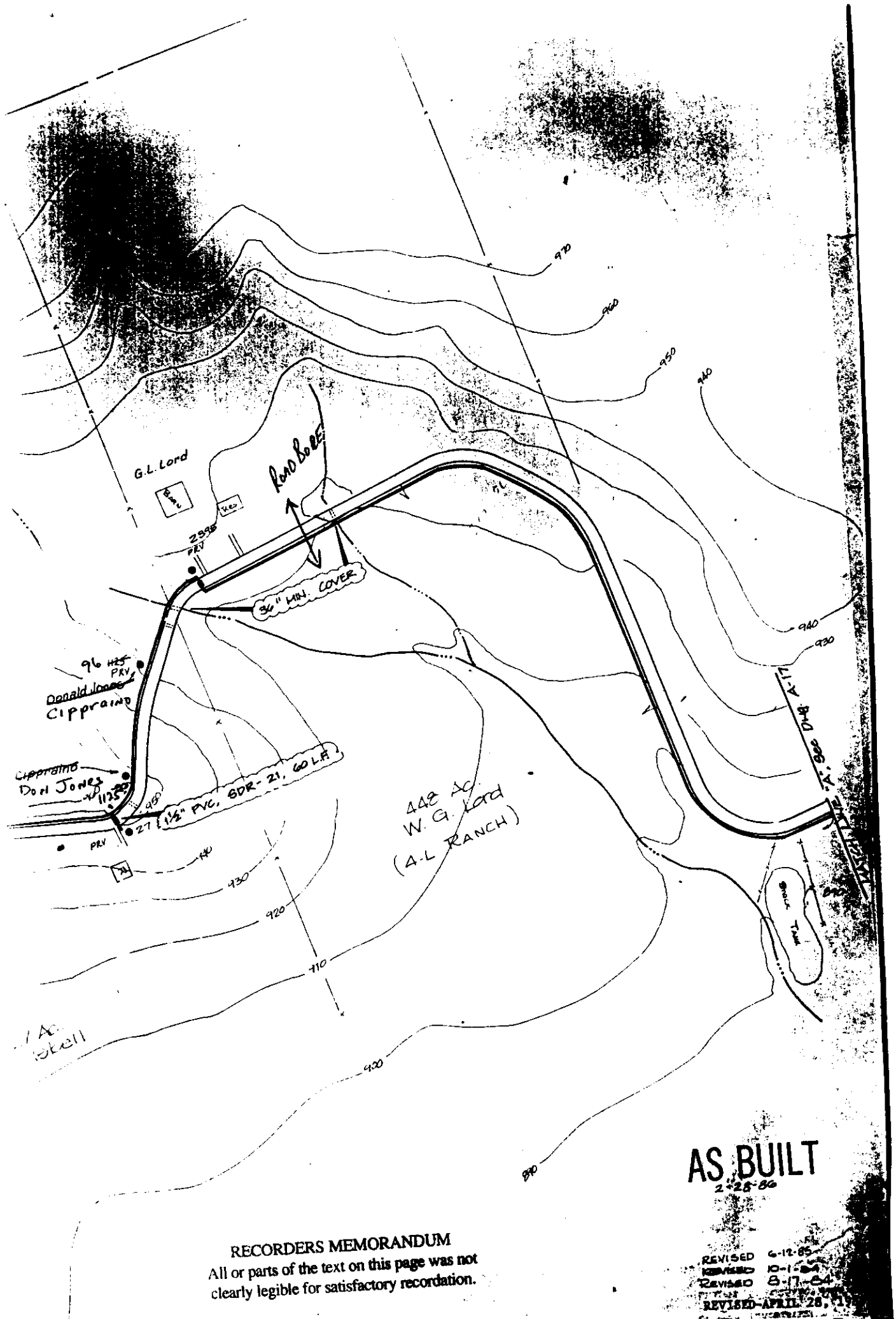

RECORDERS MEMORANDUM
 All or parts of the text on this page was not
 clearly legible for satisfactory recordation.

AS BUILT
 2-25-86

REVISED 6-12-85
 REVISED 10-1-85
 REVISED 8-17-84
 REVISED APRIL 28, 1984

DISTRIBUTION LINES SECTION NO. 5

NOTICE OF PROPOSED INSTALLATION

UTILITY LINE ON WILLIAMSON COUNTY RIGHT-OF-WAY

TO: Williamson County Unified Road System
1900 Georgetown Inner Loop, Suite B
Georgetown, Texas 78626

DATE: 3/29/99Formal notice is hereby given that The City of GeorgetownCompany proposes to place a 2" PVC water lineline within the right-of-way of 212 SPANISH OAK DRIVE
as follows: (give location, length, general design, etc.)

Proposed: A 32' ROAD CUT - 6" wide - 36" Deep To upgrade
water service To 212 SPANISH OAK DR.

Bed w/ sand and BACKFILL w/ ROAD BASE and compact.

CITY OF GEORGETOWN STREET DEPT will CUT BACK and PATCH To county specs

The line will be constructed and maintained on the road right-of-way as directed by the Williamson County Unified Road System in accordance with governing laws.

Our firm further understands that the County considers proper traffic control measures as those complying with applicable portions of the Texas Manual of Traffic Control Devices required for adoption by the "Transportation Code" (V.C.T.A. CH.251)

The location and description of the proposed line and appurtenances is more fully shown by 2 copies of drawings attached to this notice.

Construction of this line is proposed to begin on or after the 12th day of April 1999.

APPROVAL

This application is hereby approved subject to the following understandings and restrictions.

It is expressly understood that the said County Commissioners' Court does not imply hereby to grant any right, claim, title or easement in or upon this County Road; and it is further understood that in the future, should Williamson County, for any reason, need to work, improve, relocate, widen, increase, add to, decrease, or in any manner change the structure of this road or right-of-way, this line, if affected, will be moved at the direction of the Williamson County Engineer or County Commissioner. This installation work shall not damage any part of the roadway and adequate provisions shall be made to cause a minimum of inconvenience to traffic and adjacent property owners.

APPROVED BY WILLIAMSON COUNTY COMMISSIONERS' COURT

BY: [Signature]
COUNTY ROAD ADMINISTRATOR

DATE: 4/5/99Firm: City of GeorgetownAuthorized Signature [Signature]Printed Name GARY A BOFFAddress: 1101 N- CollegeGeorgetown, TX 78626Phone: 512 - 930 - 3555Fax: 512 - 930 - 3509

Pd. 3

received
3-29-99

3-30-99

cut + restore

R.J.

054

CONTRACTOR'S LIABILITY AGREEMENT

VOL 0103 PAGE 429

I, GARY BOOD, Contractor for CITY OF GEORGETOWN
in Williamson County, Texas do hereby agree to the following schedules and conditions for doing work
within the right-of-way of 212 SPANISH OAK DR which is a public
roadway maintained by Williamson County.

1. I will contact the Williamson County Unified Road System at least 48 hours prior to start of construction.
2. All work in the right-of-way will be done between the hours of 8:30 a.m. and 4:30 p.m. on Monday through Friday only.
3. Cuts will be opened for one-half the roadway only, with flagmen on both sides of the work area, allowing one-way traffic through. This type of operation will be held to a minimum and all advance warning signs and barricades shall be as specified in the Texas Manual on Uniform Traffic Control Devices. These cuts will also be filled and entire roadway opened at night and on weekends.
4. Roadside work in ditches alongside the trenched surface may be left opened at night, only if they can be barricaded solidly between open ditch and traveled roadway leaving a minimum 6' of road shoulder between the pavement edge and the barricades. The barricades must be reflectorized and lighted with warning lights and conform to the requirements of the T.M.U.T.C.D. for nighttime use.
5. Any construction area to be maintained from dusk to dawn shall have Type B High Intensity Steady Burn Warning Lights to delineate the traveled way through and around obstructions in a construction or maintenance area. All warning lights shall be installed to a minimum mounting height of 36" to the bottom of the lense.
6. Construction work and road repair on County right-of-way will be done to Williamson County Standards and to the approval of the Williamson County Unified Road System.
7. I will notify the Williamson County Unified Road System and obtain approval prior to any changes from this agreement if required due to soil conditions or other problems.

3/29/99
DATE

Williamson County Unified Road System
1900 Georgetown Inner Loop, Ste. B
Georgetown, Texas 78626

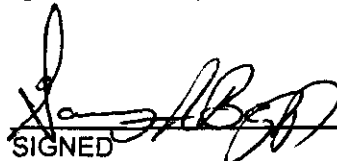
SIGNED

GARY A BOOD
CONTRACTOR (PRINT NAME)

1101 N. College
ADDRESS

Georgetown, TX 78626
CITY, STATE, ZIP CODE

512-930-3555
PHONE

PARALLEL UTILITY CUT DESIGN IN WILLIAMSON COUNTY R.O.W.

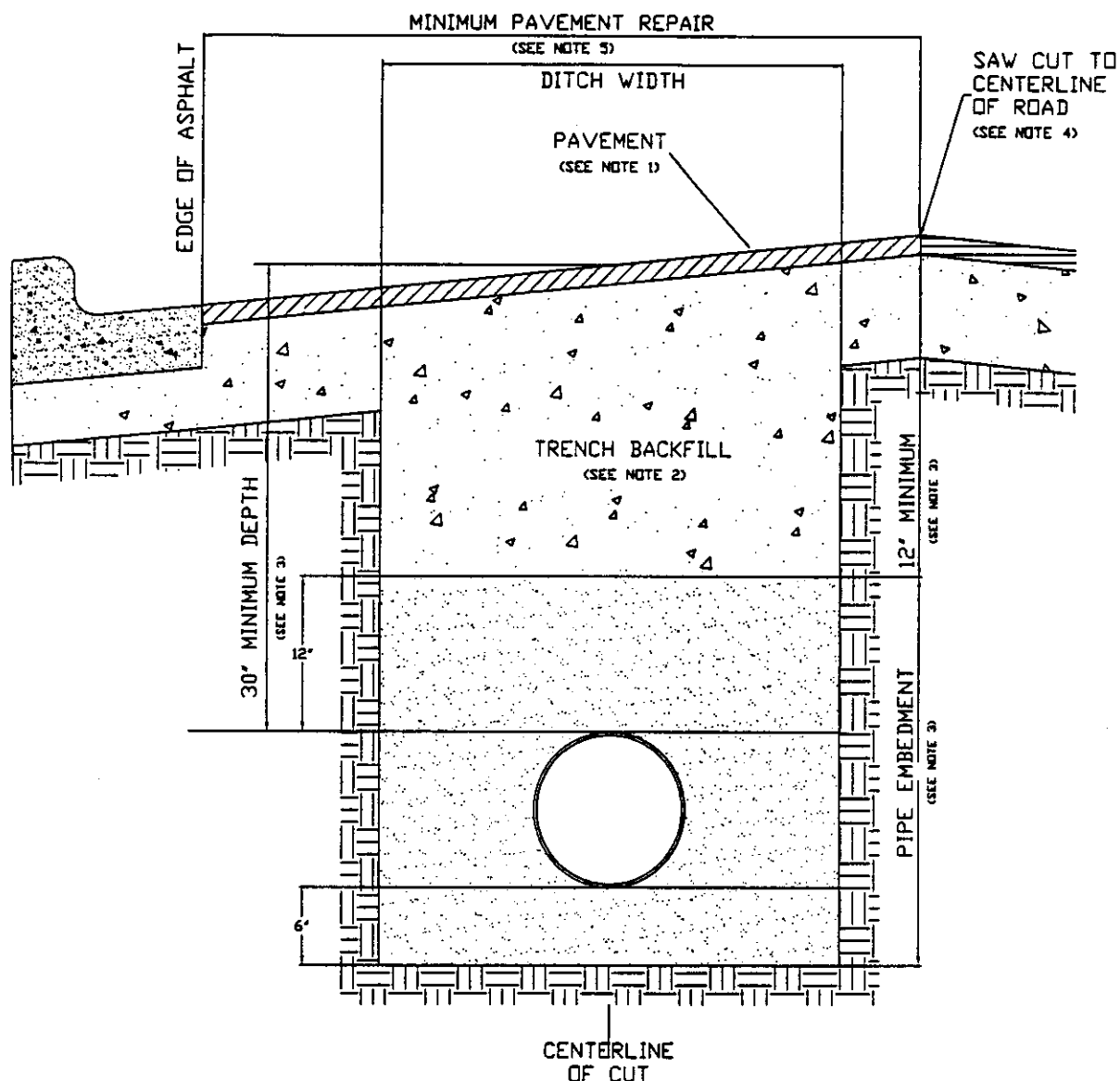

1. Hot mix asphalt to match existing HMA thickness or 2" minimum, whichever is greater. Roll in place to match existing surface, + or - 1/8" tolerance.
2. Trench backfill shall be flexible base, compacted to 95% optimum in 8" layers unless otherwise approved and specified. Flexible base to match existing base thickness or 8", whichever is greater (Specifications: TxDOT Item 247, Type A, Grade 2).
3. Pipe embedment (pipe envelope) size and materials shall be as specified elsewhere by the utility company and/or its engineers. Pipe depth shall be as specified elsewhere provided that minimum depths are met.
4. Saw cut shall be made prior to ditch cut. If pavement is damaged during cut, a new saw cut shall be made beyond the damaged area and new pavement placed.
5. Damage beyond the centerline requires repair over entire roadway width.
6. All pavement repair shall conform to Item 351 Repairing Existing Flexible Pavement Structure as found in the 1993 Texas Department of Transportation Standard Specifications for Construction of Highways, Streets and Bridges.

PERPENDICULAR UTILITY CUT DESIGN IN WILLIAMSON COUNTY R.O.W.

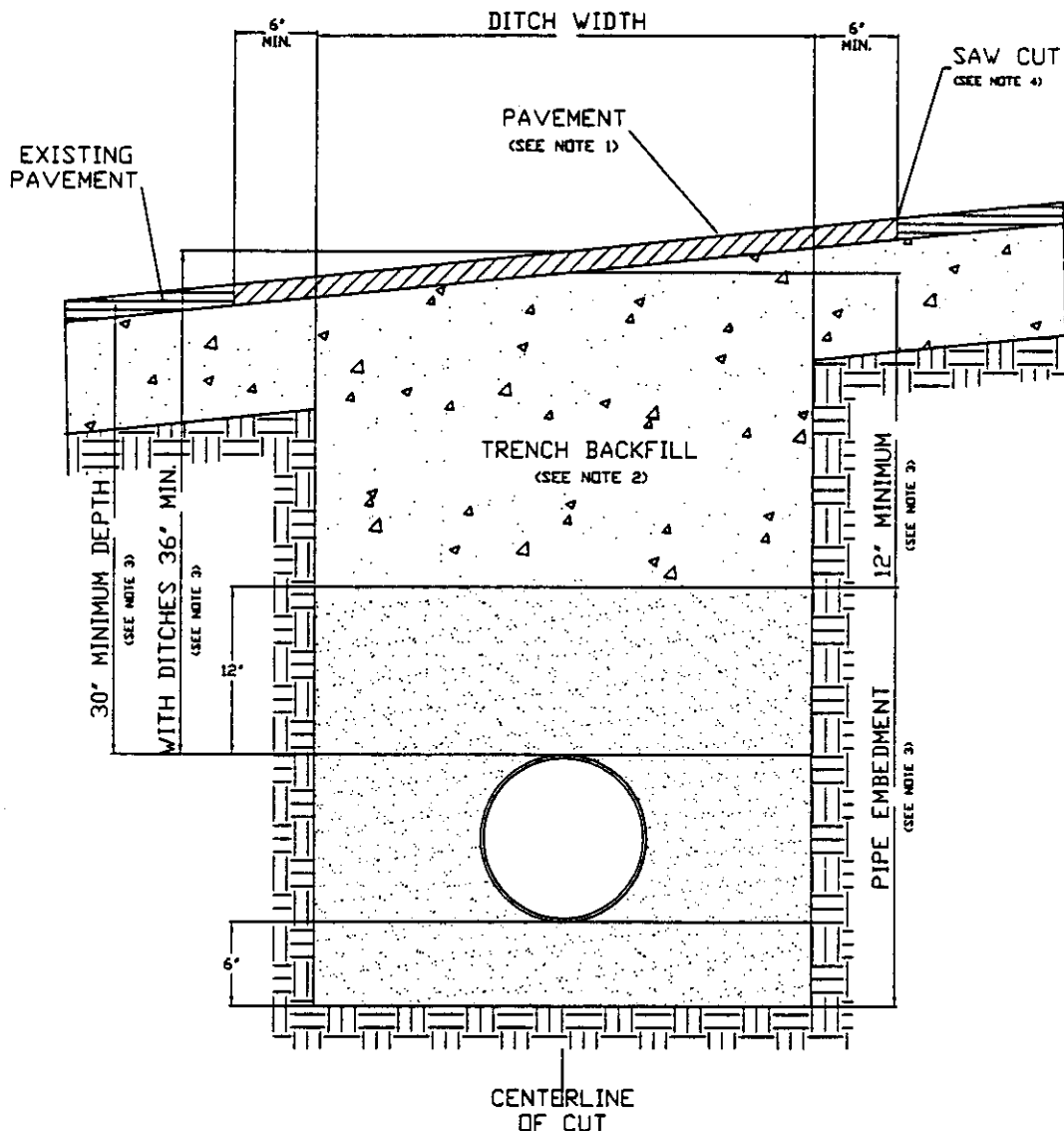

1. Hot mix asphalt 1 1/2" min. thickness. Roll in place to match existing surface, + or - 1/8" tolerance.
2. Trench backfill shall be flexible base, compacted to 95% optimum in 8" layers unless otherwise approved and specified. Flexible base to match existing base thickness or 8 inches, whichever is greater (specifications; TxDOT Item 247, Type A, Grade 2).
3. Pipe embedment (pipe envelope) size and materials shall be as specified elsewhere by utility company and/or its engineers. Pipe depth shall be as specified elsewhere provided that minimum depths are met.
4. Saw cut shall be made prior to ditch cut. If pavement is damaged during cut, a new saw cut shall be made beyond the damaged area and new pavement placed.
5. Where roadside ditches (bar ditches) are crossed by the utility pipe, minimum depth to the top of the pipe from centerline road elevation will be 36".
6. All pavement repair shall conform to Item 351 Repairing Existing Flexible Pavement Structure as found in the 1993 Texas Department of Transportation Standard Specifications for Construction of Highways, Streets and Bridges.

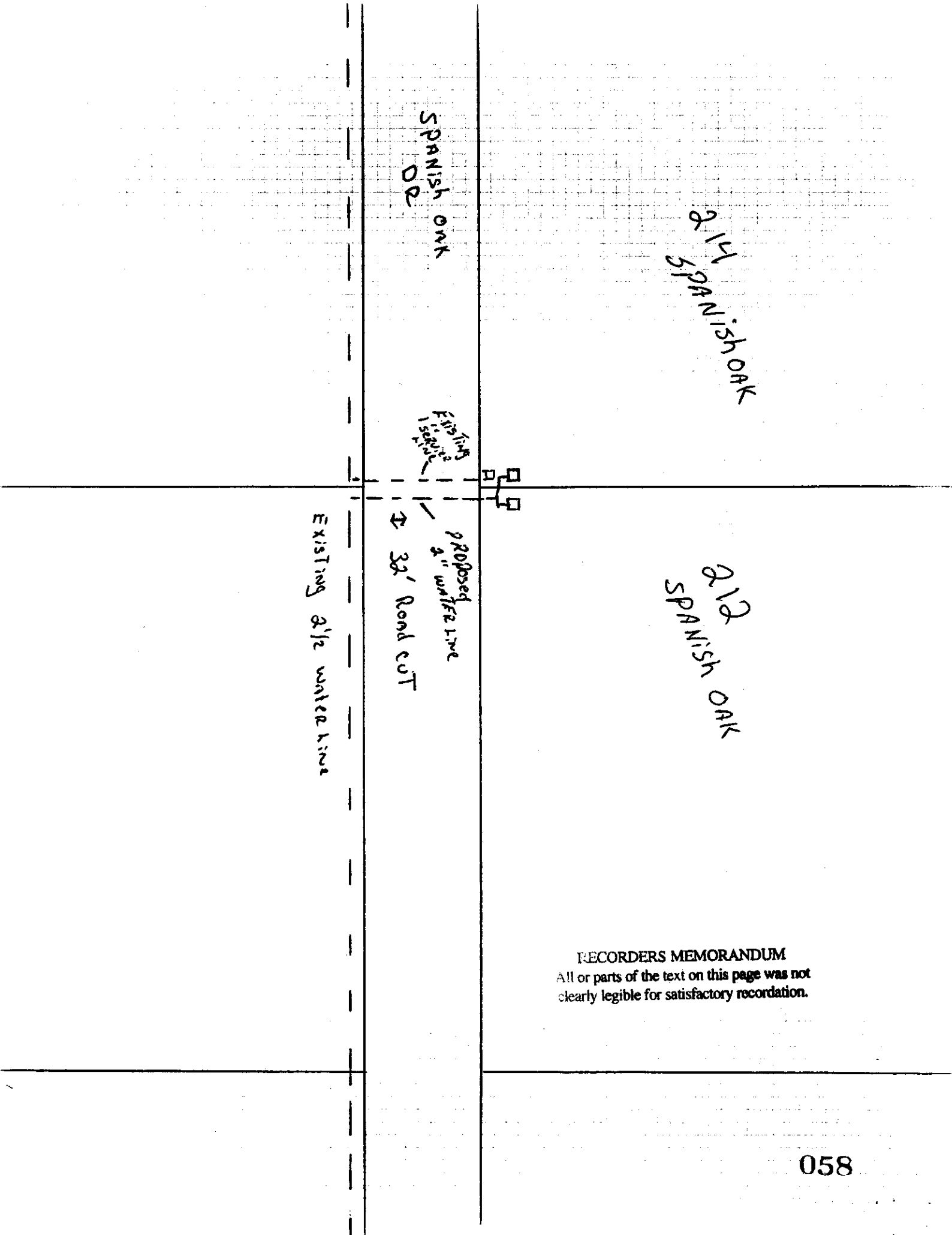

RECORDERS MEMORANDUM
All or parts of the text on this page was not
clearly legible for satisfactory recordation.

NOTICE OF PROPOSED INSTALLATION
UTILITY LINE ON WILLIAMSON COUNTY RIGHT-OF-WAY

VOL 0103 PAGE 433

TO: Williamson County Unified Road System
1900 Georgetown Inner Loop, Suite B
Georgetown, Texas 78626

DATE: 3/29/99

Formal notice is hereby given that The City of Georgetown

Company proposes to place a 2" PVC WATER LINE

line within the right-of-way of 417 Logan Rd
as follows: (give location, length, general design, etc.)

PROPOSE A 8' TO 10' ROAD CUT - 6" WIDE 36" DEEP TO INSTALL A 2" PVC
WATER LINE TO 417 LOGAN RD.
BED W/ SAND AND BACK FILL W/ ROAD BASE + COMPACT -
CITY OF GEORGETOWN STREET DEPT WILL CUT BACK + PATCH TO COUNTY SPECS.

The line will be constructed and maintained on the road right-of-way as directed by the Williamson County Unified Road System in accordance with governing laws.

Our firm further understands that the County considers proper traffic control measures as those complying with applicable portions of the Texas Manual of Traffic Control Devices required for adoption by the "Transportation Code" (V.C.T.A. CH.251)

The location and description of the proposed line and appurtenances is more fully shown by 2 copies of drawings attached to this notice.

Construction of this line is proposed to begin on or after the 12TH day of APRIL 1999.

APPROVAL

This application is hereby approved subject to the following understandings and restrictions.

It is expressly understood that the said County Commissioners' Court does not imply hereby to grant any right, claim, title or easement in or upon this County Road; and it is further understood that in the future, should Williamson County, for any reason, need to work, improve, relocate, widen, increase, add to, decrease, or in any manner change the structure of this road or right-of-way, this line, if affected, will be moved at the direction of the Williamson County Engineer or County Commissioner. This installation work shall not damage any part of the roadway and adequate provisions shall be made to cause a minimum of inconvenience to traffic and adjacent property owners.

APPROVED BY WILLIAMSON COUNTY COMMISSIONERS' COURT

BY: [Signature]
COUNTY ROAD ADMINISTRATOR

DATE: 4/6/99

Firm: City of Georgetown
[Signature]
Authorized Signature

GARY A BOPP
Printed Name
Address: 1101 N. COLLEGE
GEORGETOWN, TX 78626

Phone: 512 - 930 - 3555

Fax: 512 - 930 - 3509

Pd. 3

received
3-29-99

4-5-99

Castro-rectore

R-1

059

CONTRACTOR'S LIABILITY AGREEMENT

I, Barry Bozz, Contractor for City of Georgetown
in Williamson County, Texas do hereby agree to the following schedules and conditions for doing work
within the right-of-way of 417 Logan Rd. which is a public
roadway maintained by Williamson County.

1. I will contact the Williamson County Unified Road System at least 48 hours prior to start of construction.
2. All work in the right-of-way will be done between the hours of 8:30 a.m. and 4:30 p.m. on Monday through Friday only.
3. Cuts will be opened for one-half the roadway only, with flagmen on both sides of the work area, allowing one-way traffic through. This type of operation will be held to a minimum and all advance warning signs and barricades shall be as specified in the Texas Manual on Uniform Traffic Control Devices. These cuts will also be filled and entire roadway opened at night and on weekends.
4. Roadside work in ditches alongside the trenched surface may be left opened at night, only if they can be barricaded solidly between open ditch and traveled roadway leaving a minimum 6' of road shoulder between the pavement edge and the barricades. The barricades must be reflectorized and lighted with warning lights and conform to the requirements of the T.M.U.T.C.D. for nighttime use.
5. Any construction area to be maintained from dusk to dawn shall have Type B High Intensity Steady Burn Warning Lights to delineate the traveled way through and around obstructions in a construction or maintenance area. All warning lights shall be installed to a minimum mounting height of 36" to the bottom of the lense.
6. Construction work and road repair on County right-of-way will be done to Williamson County Standards and to the approval of the Williamson County Unified Road System.
7. I will notify the Williamson County Unified Road System and obtain approval prior to any changes from this agreement if required due to soil conditions or other problems.

3/29/99
DATE

Williamson County Unified Road System
1900 Georgetown Inner Loop, Ste. B
Georgetown, Texas 78626

SIGNED

Barry A Bozz
CONTRACTOR (PRINT NAME)

1101 N. College
ADDRESS

Georgetown, Tx 78626
CITY, STATE, ZIP CODE

512/930-3555
PHONE

PARALLEL UTILITY CUT DESIGN IN WILLIAMSON COUNTY R.O.W.

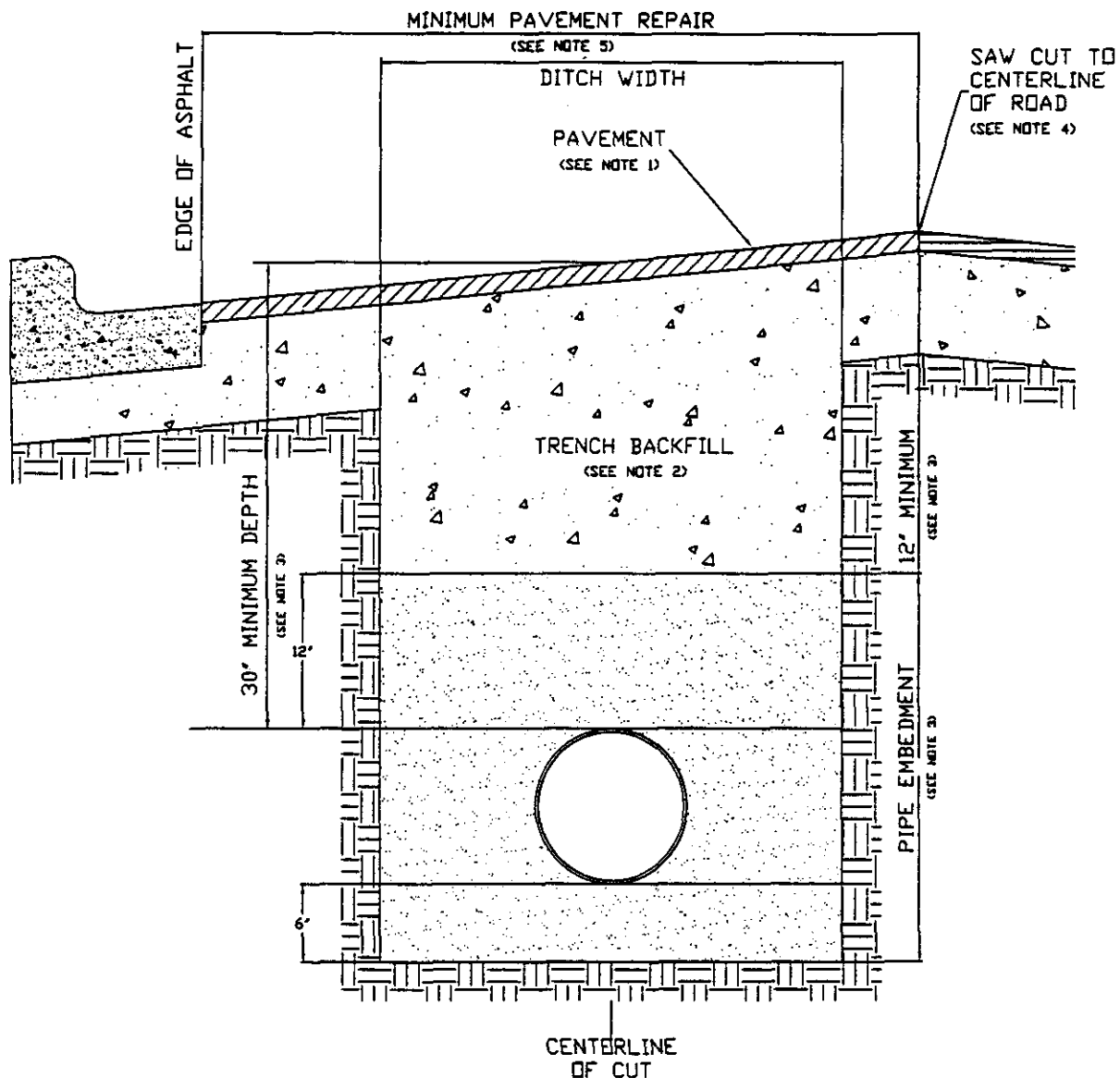

1. Hot mix asphalt to match existing HMAC thickness or 2" minimum, whichever is greater. Roll in place to match existing surface, + or - 1/8" tolerance.
2. Trench backfill shall be flexible base, compacted to 95% optimum in 8" layers unless otherwise approved and specified. Flexible base to match existing base thickness or 8", whichever is greater (Specifications: TxDOT Item 247, Type A, Grade 2).
3. Pipe embedment (pipe envelope) size and materials shall be as specified elsewhere by the utility company and/or its engineers. Pipe depth shall be as specified elsewhere provided that minimum depths are met.
4. Saw cut shall be made prior to ditch cut. If pavement is damaged during cut, a new saw cut shall be made beyond the damaged area and new pavement placed.
5. Damage beyond the centerline requires repair over entire roadway width.
6. All pavement repair shall conform to Item 351 Repairing Existing Flexible Pavement Structure as found in the 1993 Texas Department of Transportation Standard Specifications for Construction of Highways, Streets and Bridges.

PERPENDICULAR UTILITY CUT DESIGN IN WILLIAMSON COUNTY R.O.W.

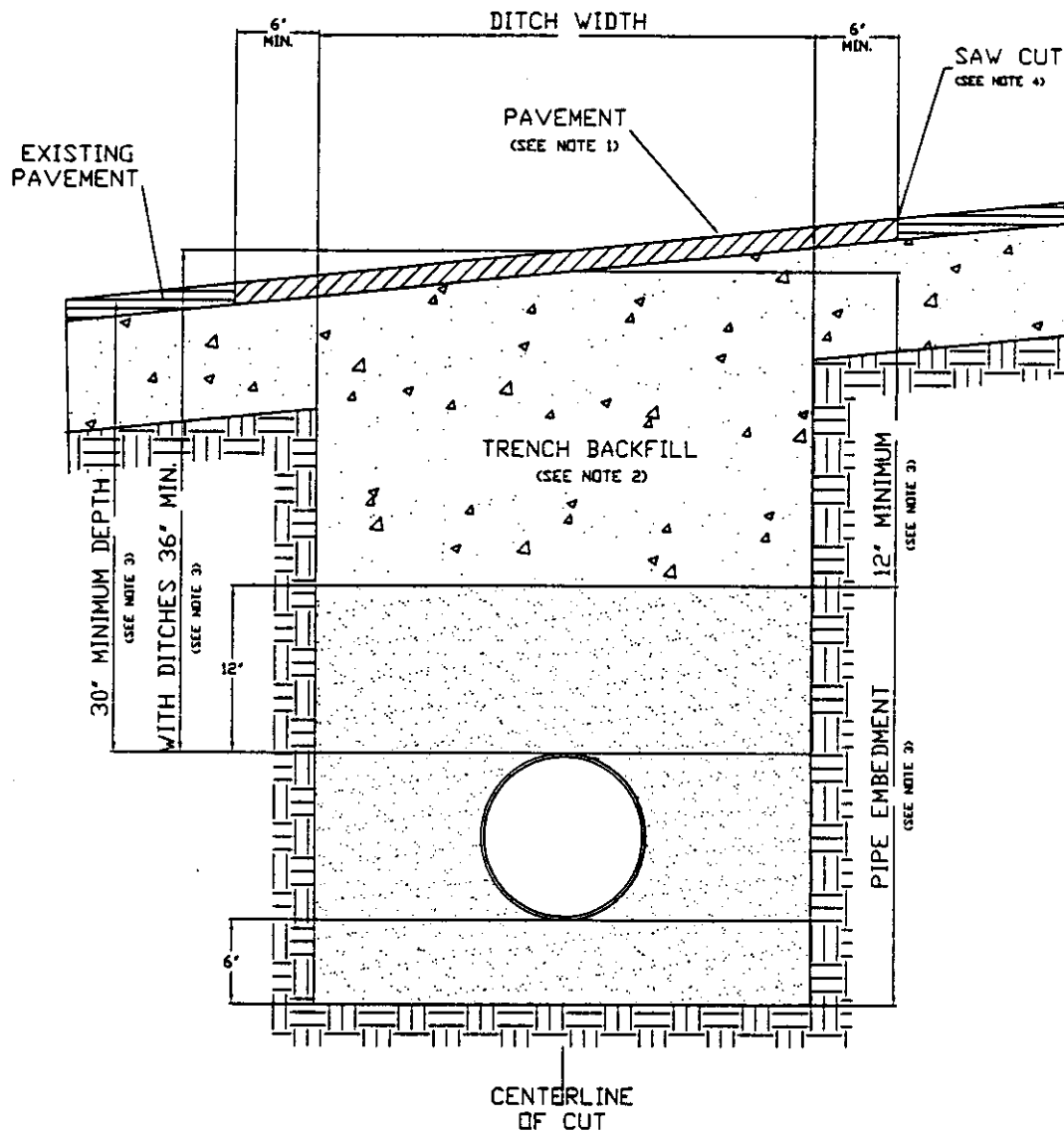

1. Hot mix asphalt 1 1/2" min. thickness. Roll in place to match existing surface, + or - 1/8" tolerance.
2. Trench backfill shall be flexible base, compacted to 95% optimum in 8" layers unless otherwise approved and specified. Flexible base to match existing base thickness or 8 inches, whichever is greater (specifications; TxDOT Item 247, Type A, Grade 2).
3. Pipe embedment (pipe envelope) size and materials shall be as specified elsewhere by utility company and/or its engineers. Pipe depth shall be as specified elsewhere provided that minimum depths are met.
4. Saw cut shall be made prior to ditch cut. If pavement is damaged during cut, a new saw cut shall be made beyond the damaged area and new pavement placed.
5. Where roadside ditches (bar ditches) are crossed by the utility pipe, minimum depth to the top of the pipe from centerline road elevation will be 36".
6. All pavement repair shall conform to Item 351 Repairing Existing Flexible Pavement Structure as found in the 1993 Texas Department of Transportation Standard Specifications for Construction of Highways, Streets and Bridges.

LOGAN RD

8" WATER

8'-10' ROAD CUT

417

LOGAN

Proposed
2" X-overline.

RECORDERS MEMORANDUM
All or parts of the text on this page was not
clearly legible for satisfactory recordation.

063

NOTICE OF PROPOSED INSTALLATION

UTILITY LINE ON WILLIAMSON COUNTY RIGHT-OF-WAY

TO: Williamson County Unified Road System
1900 Georgetown Inner Loop, Suite B
Georgetown, Texas 78626

DATE: 3-18-99Formal notice is hereby given that SOUTHWESTERN BELL TELEPHONECompany proposes to place a BURIED CABLEline within the right-of-way of CR 200
as follows: (give location, length, general design, etc.)LOCATION: 7150 CR 200LENGTH: 50'

BURIED SERVICE DROP 25' EDGE W/UNDER ASPHALT

The line will be constructed and maintained on the road right-of-way as directed by the Williamson County Unified Road System in accordance with governing laws.

Our firm further understands that the County considers proper traffic control measures as those complying with applicable portions of the Texas Manual of Traffic Control Devices required for adoption by the "Transportation Code" (V.C.T.A. CH.251)

The location and description of the proposed line and appurtenances is more fully shown by 3 copies of drawings attached to this notice.

Construction of this line is proposed to begin on or after the 22 day of MARCH 1999.APPROVAL

This application is hereby approved subject to the following understandings and restrictions.

It is expressly understood that the said County Commissioners' Court does not imply hereby to grant any right, claim, title or easement in or upon this County Road; and it is further understood that in the future, should Williamson County, for any reason, need to work, improve, relocate, widen, increase, add to, decrease, or in any manner change the structure of this road or right-of-way, this line, if affected, will be moved at the direction of the Williamson County Engineer or County Commissioner.

This installation work shall not damage any part of the roadway and adequate provisions shall be made to cause a minimum of inconvenience to traffic and adjacent property owners.

APPROVED BY WILLIAMSON COUNTY COMMISSIONERS' COURT

BY: [Signature]
COUNTY ROAD ADMINISTRATORDATE: 3/31/99Firm: SOUTHWESTERN BELL

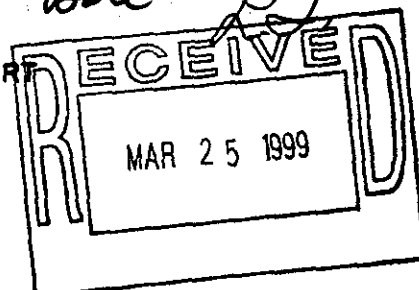

Authorized Signature



TERRY PRINGLE
Printed NameAddress: 1616 GUADALUPEAUSTIN, TEXAS 78701Phone: 512-870-1223Fax: 512-870-33053-29-99 Pd. 2Bue P. 1

4650387

NORTH ARROW

OPERATING RANGE OF JIG STEPS

LINE  TO 

SPLICE  TO 

AFRC 45C

TRANSMISSION ZONE

RZ CT 7

TAPER CODE (11111)

CAUTION HIGH VOLTAGE

☒ AERIAL ☐ BURNED

7.2 KV

SPECIAL CIRCUITS INVOLVED

☐ YES ☒ NO

8203 FORWARDED

☐ YES ☒ NO

PERMIT REQUIRED

☐ YES ☒ NO

POLE CONTACTS

(+) OR (-)

PWR. CO. P.E.C.

NOTES

OUTLET SUBSTATION AT

515-6058 FOR ACCESS

TO PROPERTY

TEAM LOGISTICS

STAGED IN FIELD

REF 463568

ORDER NO. 4650329

TOT. PLANTS 1 PLAT NO. 1

CO. LIBERTY HILL

DIGN. AUSTIN NORTH

TAX DIST. WA014

REG. LOC. XV4778

EMER. TD DRAWING 2

MAP REF.

REC. REF. RPL102

NOTICE OF PROPOSED INSTALLATION

UTILITY LINE ON WILLIAMSON COUNTY RIGHT OF WAY

TO: Williamson County Unified Road System
1900 Georgetown Inner Loop, Suite B
Georgetown, Texas 78626

Date: March 19, 1999

Formal notice is hereby given that Southwestern Bell Telephone

Company proposes to place a Telephone cable

line within the right-of-way of Great Oaks Dr @ Conchos Valley Dr.
as follows: (give location, length, general design, etc.)

See Attached Work Prints (DWO 4643285)

The line will be constructed and maintained on the road right-of-way as directed by the Williamson County Unified Road System in accordance with governing laws.

Our firm further understands that the County considers proper traffic control measures as those complying with applicable portions of the Texas Manual of Traffic Control Devices required for adoption by the "Transportation Code" (V.C.T.A. CH.251)

The location and description of the proposed line and appurtenances is more fully shown by 3 copies of drawings attached to this notice.

Construction of this line is proposed to begin on or after the 1st day of April 1999

APPROVAL

This application is hereby approved subject to the following understanding and restrictions.

It is expressly understood that the said County Commissioners' Court does not imply hereby to grant any right, claim, title or easement in or upon this County Road; and it is further understood that in the future, should Williamson County, for any reason, need to work, improve, relocate, widen, increase, add to, decrease, or in any manner change the structure of this road or right-of-way, this line, if affected, will be moved at the direction of the Williamson County Engineer or County Commissioner. This installation work shall not damage any part of the roadway and adequate provisions shall be made to cause a minimum of inconvenience to traffic and adjacent property owners.

APPROVED BY WILLIAMSON COUNTY COMMISSIONERS' COURT

BY: A. J. Ky
COUNTY ROAD ADMINISTRATOR

DATE: 4/5/99

Firm: Southwestern Bell Telephone Company

Authorized Signature

James Koker

Printed Name

Address: 1616 Guadalupe St., Rm. 406

Austin, Texas 78701

Phone: (512) 870-5298

Fax: (512) 870-3305

Pct. 3

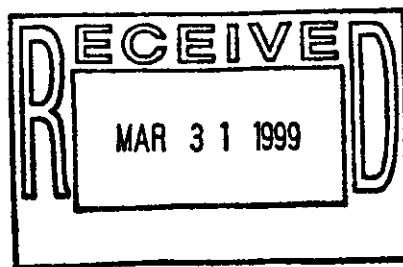

3-31-99

*Bore
R.I.*

066

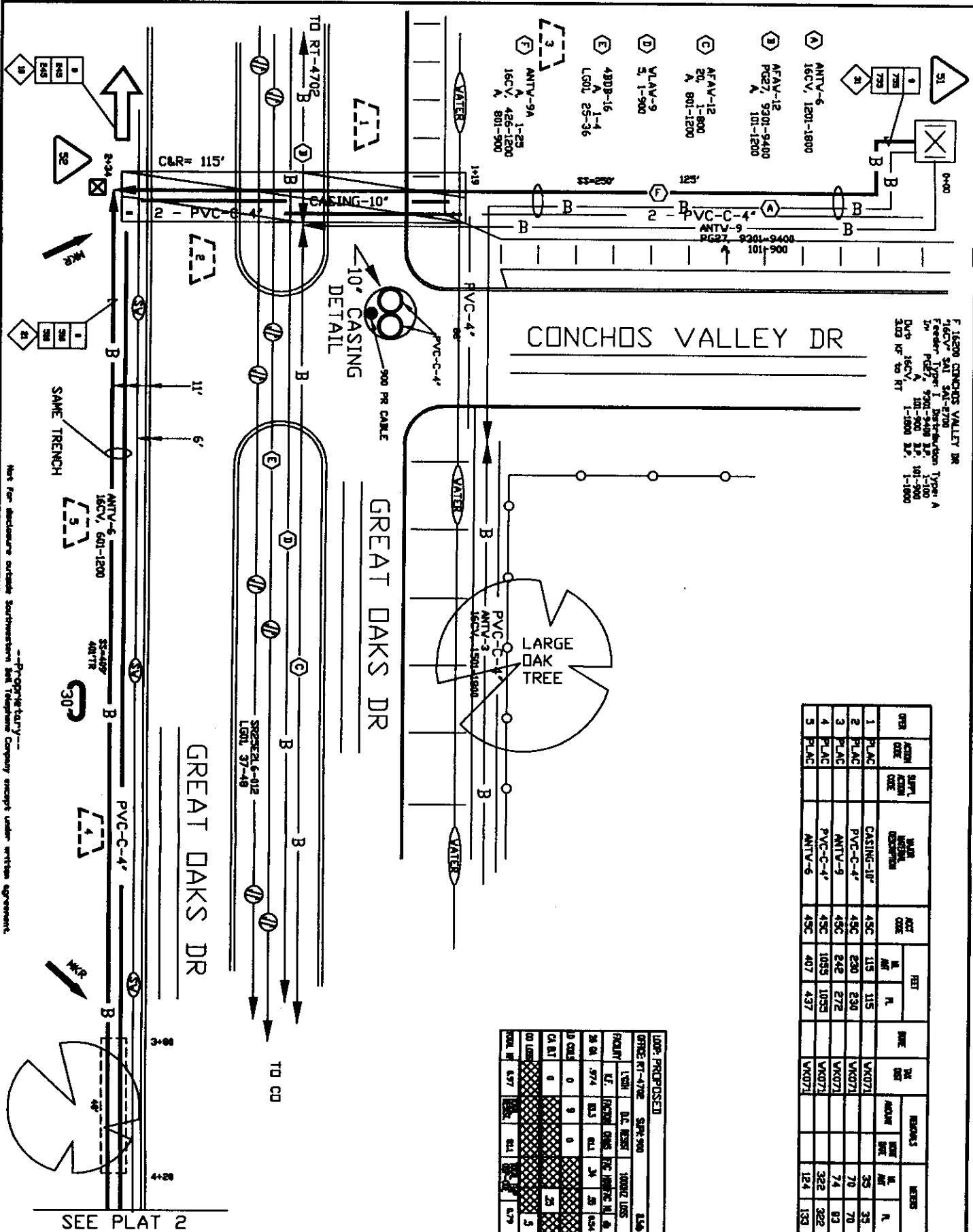

OTHER ACTION CODE	SPL. ACTION CODE	MAIN MESSAGE DESCRIPTION	ACT CODE	FEET		SWR	TK DIST	REMOVALS		WEIGHTS	
				M. AM	F.			REMOVED	RECEIVED	M. AM	F.
1	PLAC	CASING-1P"	45C	115	115		WK071			33	35
2	PLAC	PVC-C-4"	45C	230	230		WK071			70	70
3	PLAC	ANTV-9	45C	272	272		WK071			74	83
4	PLAC	PVC-C-4"	45C	1055	1055		WK071			322	322
5	PLAC	ANTV-6	45C	407	437		WK071			124	133

LUMP - PROPOSED				
OFFICE	RT-470E	SUR-900	L34	
FRANLITY	1201	D.C. REUSE	10000Z	LOS
U.E.	FRANLITY	CHMS	THE	INSTRATE N. A.
26 04	374	01.3	24	28 024
00 0025	0	9	0	
CA 8.7	0			25
00 0025				5
26 04	374	01.3	24	28 024

067

SPECIAL CIRCUITS N 6203 N FORWARDED PERMIT N REQUIRED		 NORTH ARROW	
OPERATING RANGE OF JOB STEPS			
LINE	1 TO 5	5 TO 1	
SPUCE	51 TO 52	52 TO 51	
MTRC	45C		
TRANSMISSION ZONE			
RZ	CZ 9 TAPER CODE 470302		
CAUTION HIGH VOLTAGE			
KV 7.2	AERIAL Y	BURIED N	
POLE CONTACTS (+) (-)			
PWR CO TULEELECTRIC COMPANY			
NOTES			
4515086, 4591284			
ORDER NO.	4643285		
TOT. PRINTS 2	PRINT NO. 1		
NPA/MNK: 512-255	PRT: 512-255		
EXCH. ROUND ROCK			
TAX DIST. WK071			
GEO LOC. XY4255			
ENGR. JKK	DRAWN Z		
TELEPHONE NO. (512) 870-5298			
REC. REF. RPL 300			
MAP REF. 405L			
SCALE NONE			
ISSUE DATE 02/19/99			
DATE REV. 3/1/99			
JOB TITLE	DST-15925 GREAT OA		

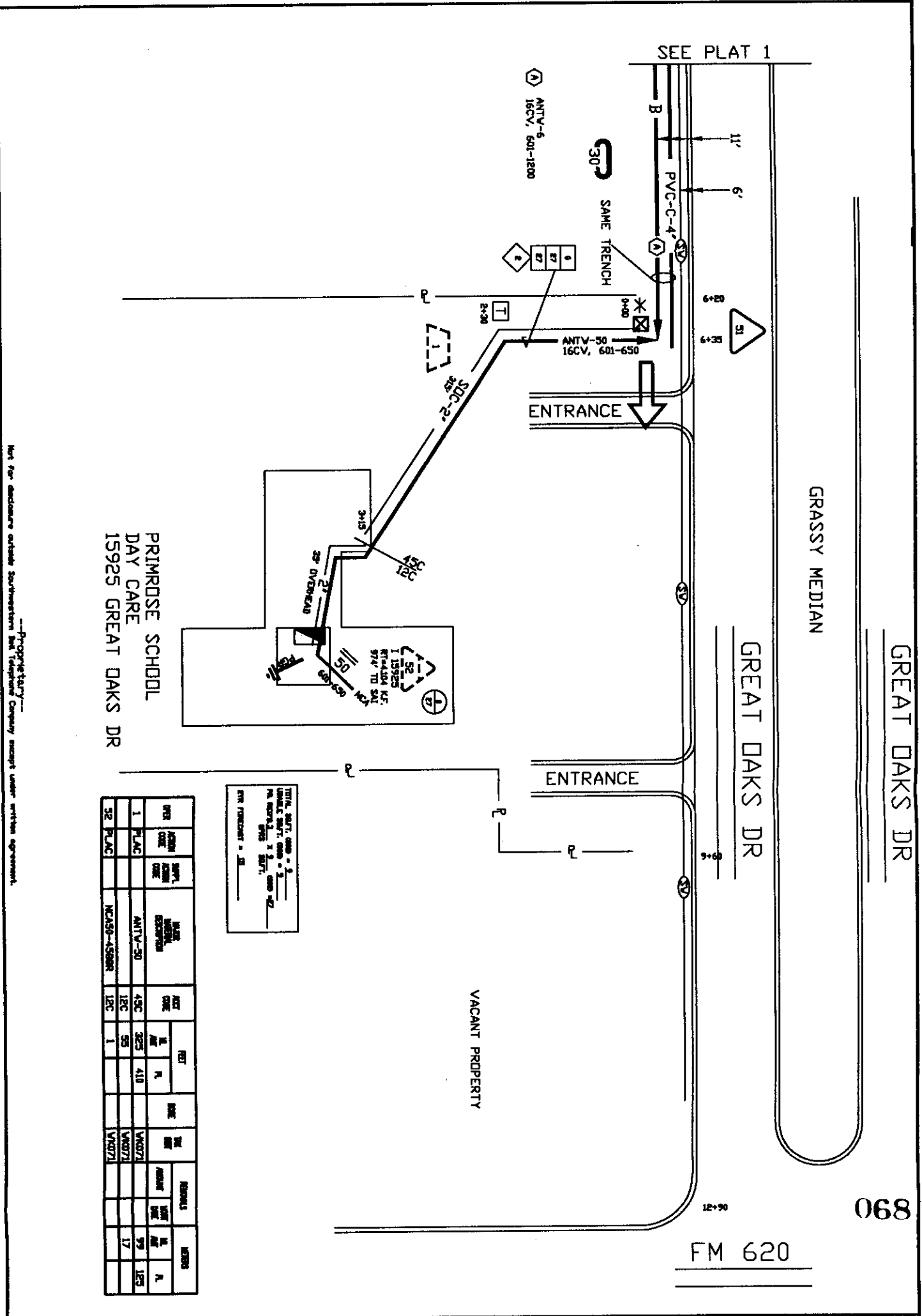

SPECIAL CIRCUITS 6203 FORWARDED PERMIT REQUIRED		N N N N			
OPERATING RANGE OF JOB STEPS					
LINE	1	TO	1	TO	1
SPICE	51	TO	52		
MFR	45C				
TRANSMISSION ZONE					
RZ	CZ 9	TAPER CODE	470302		
KV 7.2 AERIAL Y BURIED N					
CAUTION HIGH VOLTAGE					
POLE CONTACTS (+) (-)					
PWR CO TUELECTRIC COMPANY					
NOTES					
4515086, 4591284					
ORDER NO. 4643285					
TOT. PRINTS 2 PRINT NO. 2					
NPA/NNX-512-255 PRT: 512-255					
EXCH. ROUND ROCK					
TAX DIST. WK071					
GEO LOC. XY4255					
ENGR. JJK DRAWN Z					
TELEPHONE NO. (512) 870-5298					
REC. REF. RPL 300					
MAP REF. 405L					
SCALE NONE					
ISSUE DATE 02/19/99					
DATE REV. 3/1/99					
JOB TITLE DST-15925 GREAT OA					

Not for disclosure outside Southwestern Bell Telephone Company except under written agreement.

NOTICE OF PROPOSED INSTALLATION

VOL 0103 PAGE 443

UTILITY LINE ON WILLIAMSON COUNTY RIGHT-OF-WAY

TO: Williamson County Unified Road System
1900 Georgetown Inner Loop, Suite B
Georgetown, Texas 78626

DATE: 03/29/99

Formal notice is hereby given that Southwest Milam Water Supply Corporation

Company proposes to place a water line

line within the right-of-way of CR 427
as follows: (give location, length, general design, etc.)

Bore and encase a 1 1/4" PVC carrier in a 2" PVC casing across CR 427 approximately 8,976 ft. north of the Hwy. 79 and CR 427 intersection. Pipe to be 3 ft. below ditch line and encase from ditch line to ditch line approximately 50 ft.

The line will be constructed and maintained on the road right-of-way as directed by the Williamson County Unified Road System in accordance with governing laws.

Our firm further understands that the County considers proper traffic control measures as those complying with applicable portions of the Texas Manual of Traffic Control Devices required for adoption by the "Transportation Code" (V.C.T.A. CH.251)

The location and description of the proposed line and appurtenances is more fully shown by 2 copies of drawings attached to this notice.

Construction of this line is proposed to begin on or after the 8th day of April 19 99.

APPROVAL

This application is hereby approved subject to the following understandings and restrictions.

It is expressly understood that the said County Commissioners' Court does not imply hereby to grant any right, claim, title or easement in or upon this County Road; and it is further understood that in the future, should Williamson County, for any reason, need to work, improve, relocate, widen, increase, add to, decrease, or in any manner change the structure of this road or right-of-way, this line, if affected, will be moved at the direction of the Williamson County Engineer or County Commissioner. This installation work shall not damage any part of the roadway and adequate provisions shall be made to cause a minimum of inconvenience to traffic and adjacent property owners.

APPROVED BY WILLIAMSON COUNTY COMMISSIONERS' COURT

BY: [Signature]
COUNTY ROAD ADMINISTRATOR

DATE: 4/6/99

Firm: Southwest Milam Water Supply Corp.

[Signature]
Authorized Signature

Dwayne Jekel
Printed Name

P.O. Box 232
Address:

Rockdale, Texas 76567

Phone: 512-446-2604

Fax: 512-446-7376

Pct. 4

069

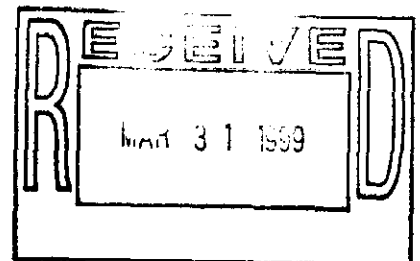

4-1-99
Bme
RJ.

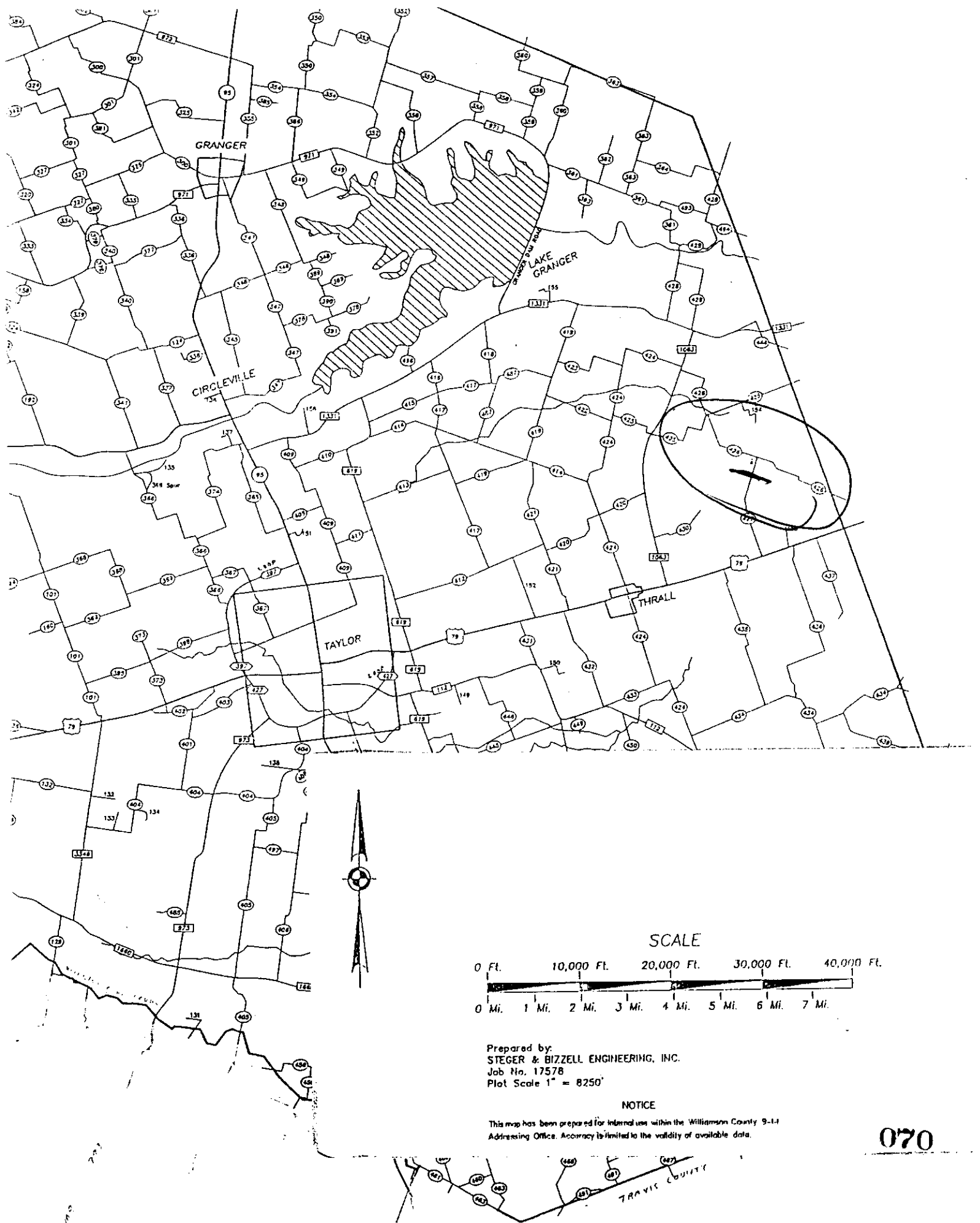

AGENDA ITEM # 5April 6, 1999Consider adopting tree trimming policy for Unified Road and Bridge Department.

Moved: Commissioner Hays

Seconded: Commissioner Heiligenstein

Motion: To approve Williamson County Tree Trimming Policy:

This policy is being implemented to preserve and protect trees along the County's right-of-way. This policy is also being implemented to prevent the spread of OAK WILT.

1. When clearing right-of-way, all trees other than Cedar, Hackberry and Chinaberry shall be trimmed using a chain saw and using proper pruning techniques.
2. Before trimming oak trees (Red Oak, Pin Oak or Live Oak) the chain saw blade is to be washed with a minimum of 10% Clorox/90% water solution. ALL OAK cuts will then be painted with tree paint.
3. The bat wing cutting blade should only be used on Cedar, Hackberry, Chinaberry trees and vines within county right-of-way.
4. Commissioner of the precinct in which the right-of-way is being cleared should be notified for approval prior to clearing and trimming.

Vote: Motion carried 5 - 0

< Clerk copy here >

Williamson County Tree Trimming Policy

This policy is being implemented to preserve and protect trees along the County's right-of-way. This policy is also being implemented to prevent the spread of OAK WILT.

1. When clearing right of way, all trees other than Cedar, ^{Hackberry & chinaberry} shall be trimmed using a chain saw and using proper pruning techniques.
2. Before trimming oak trees (Red Oak, Pin Oak, or Live Oak), the chain saw blade is to be washed with a minimum of 10% Clorox/90% water solution. ALL OAK cuts will then be painted with tree paint.
3. The bat wing cutting blade should only be used on Cedar trees and vines within the County's right-of-way.
4. Commissioner of the precinct in which the right-of-way is being cleared should be notified for approval prior to clearing and trimming.

approved 4-6-99
John C. Daaylen

071