

AGENDA ITEM # 4

June 23, 1998

Consider noting in minutes any off right-of-way work on any county road done by Road and Bridge Unified System.

Moved: Commissioner Mehevec

Seconded: Commissioner Hays

Motion: To note in minutes drainage work in right-of-way and the adjacent property of **Coe Pratt**; dumping spoils on **Shelby Smith** property and note the following utility requests;

Southwestern Bell Telephone Company road cut Elk Horn Mountain and Anderson Mill Road; bore and road cut Lake Creek Blvd., School House Lane, and Deerbrook Trail;

North Austin Municipal Utility District road cut to repair water leak on 13306 Kingman Drive;

City of Georgetown road cut Paleface Street (Indian Creek Subdivision);

Central Telephone Company of Texas bore County Road 136;

Southwest Milam Water Supply Corporation bore on County Roads 427 and 419;

Jonah Water Special Utility District bore on County Road 100 and two locations on County Road 394.

Vote: Motion carried 4 - 0 with Commissioner Boatright absent from the dais
< Clerk copy here >

June 23, 1998

UNIFIED ROAD SYSTEM
OFF RIGHT-OF-WAY WORK

1. Morningside Circle(Hutto) - Drainage work in the R.O.W. and the adjacent property of Coe Pratt.(Pct. 4-EM)
2. 4307 Oak Creek Road - Permission to dump spoils from a nearby County construction project in a pit on the property of Shelby Smith.(Pct. 2-GB)

WILLIAMSON COUNTY URS
Utility Requests - 06/23/98

Precinct I

- A. Southwestern Bell Telephone Co.
 - 1. Elk Horn Mountain – Road cut
- B. North Austin M.U.D. #1/Eco Resources
 - 1. 13306 Kingman Drive – Road cut to repair water leak

Precinct II

- A. Southwestern Bell Telephone Co.
 - 1. Lake Creek Blvd., School House Lane, Deerbrook Trail – ROW, Bore & Road Cut
 - 2. Anderson Mill Rd. – ROW & Road cut

Precinct III

- A. The City of Georgetown
 - 1. Paleface Street(Indian Creek Sub.) – Road cut for W/WW

Precinct IV

- A. Central Telephone Company of Texas
 - 1. CR 136 – Bore
- B. Southwest Milam Water Supply Corporation
 - 1. CR 427 – Bore
 - 2. CR 419 – Bore
- C. Jonah Water Special Utility District
 - 1. CR 394 – Bore
 - 2. CR 394 – Bore(2nd location)
 - 3. CR 100 – Bore

NOTICE OF PROPOSED INSTALLATION

UTILITY LINE ON WILLIAMSON COUNTY RIGHT-OF-WAY

TO: Williamson County Unified Road System
1900 Georgetown Inner Loop, Suite B
Georgetown, Texas 78626

DATE: 5-7-98Formal notice is hereby given that SOUTHWESTERN BELL TELEPHONECompany proposes to place a REPAIR A BROKEN CONDUITline within the right-of-way of ELK HORN MT.
as follows: (give location, length, general design, etc.)

AT 7825 ELK HORN MT. REPAIR BROKEN CONDUIT.
WILL HAVE TO CUT A DRIVEWAY AND REMOVE A SECTION
OF SIDEWALK

The line will be constructed and maintained on the road right-of-way as directed by the Williamson County Unified Road System in accordance with governing laws.

Our firm further understands that the County considers proper traffic control measures as those complying with applicable portions of the Texas Manual of Traffic Control Devices required for adoption by the "Transportation Code" (V.C.T.A. CH.251)

The location and description of the proposed line and appurtenances is more fully shown by _____ copies of drawings attached to this notice.

Construction of this line is proposed to begin on or after the 7 day of MAY 19 98.APPROVAL

This application is hereby approved subject to the following understandings and restrictions.

It is expressly understood that the said County Commissioners' Court does not imply hereby to grant any right, claim, title or easement in or upon this County Road; and it is further understood that in the future, should Williamson County, for any reason, need to work, improve, relocate, widen, increase, add to, decrease, or in any manner change the structure of this road or right-of-way, this line, if affected, will be moved at the direction of the Williamson County Engineer or County Commissioner. This installation work shall not damage any part of the roadway and adequate provisions shall be made to cause a minimum of inconvenience to traffic and adjacent property owners.

APPROVED BY WILLIAMSON COUNTY COMMISSIONERS' COURT

BY: [Signature]
COUNTY ROAD ADMINISTRATORDATE: 6/22/98Firm: SOUTHWESTERN BELL TELEPHONE

[Signature]
Authorized Signature

D.H. SHULTZ
Printed Name

Address: 1616 GUADALUPERM 406 AUSTIN TXPhone: 870-5201Fax: 870-3305

MS 422 DS Pct. 1

5-14-98

Cut & restore
[Signature]

received
5-14-98

NOTICE OF PROPOSED INSTALLATION
UTILITY LINE ON WILLIAMSON COUNTY RIGHT-OF-WAY

4517125

VOL 0098 PAGE 557

TO: Williamson County Unified Road System
1900 Georgetown Inner Loop, Suite B
Georgetown, Texas 78626

DATE: 5-4-98

Formal notice is hereby given that Southwestern Bell Telephone Co
Company proposes to place a Buried

line within the right-of-way of Lake Creek Blvd, School House Ln, Deerbrook,
as follows: (give location, length, general design, etc.)

Bury cable as shown on attached plans approximately
3050' to F 12301 Deerbrook Trail SAI. Environmental
Permit also submitted to The City of Austin.

The line will be constructed and maintained on the road right-of-way as directed by the Williamson County Unified Road System in accordance with governing laws.

Our firm further understands that the County considers proper traffic control measures as those complying with applicable portions of the Texas Manual of Traffic Control Devices required for adoption by the "Transportation Code" (V.C.T.A. CH.251)

The location and description of the proposed line and appurtenances is more fully shown by 3 copies of drawings attached to this notice.

Construction of this line is proposed to begin on or after the 18th day of May 1998.

APPROVAL

This application is hereby approved subject to the following understandings and restrictions.

It is expressly understood that the said County Commissioners' Court does not imply hereby to grant any right, claim, title or easement in or upon this County Road; and it is further understood that in the future, should Williamson County, for any reason, need to work, improve, relocate, widen, increase, add to, decrease, or in any manner change the structure of this road or right-of-way, this line, if affected, will be moved at the direction of the Williamson County Engineer or County Commissioner. This installation work shall not damage any part of the roadway and adequate provisions shall be made to cause a minimum of inconvenience to traffic and adjacent property owners.

APPROVED BY WILLIAMSON COUNTY COMMISSIONERS' COURT

BY: Sue Beyer
COUNTY ROAD ADMINISTRATOR

DATE: 6/22/98

Firm: Southwestern Bell Telephone Co

Authorized Signature

Gil Hoffman

Printed Name

Address: 11465 Bristle Oak Tr.

Austin, Texas 78750

Phone: (512) 870-3443

Fax: (512) 870-3305

Pd. 2

5-12-98

Row

Bore

Cut & Restore

received
5-11-98

77

RECORDERS MEMORANDUM

All or parts of the text on this page was not clearly legible for satisfactory recordation.

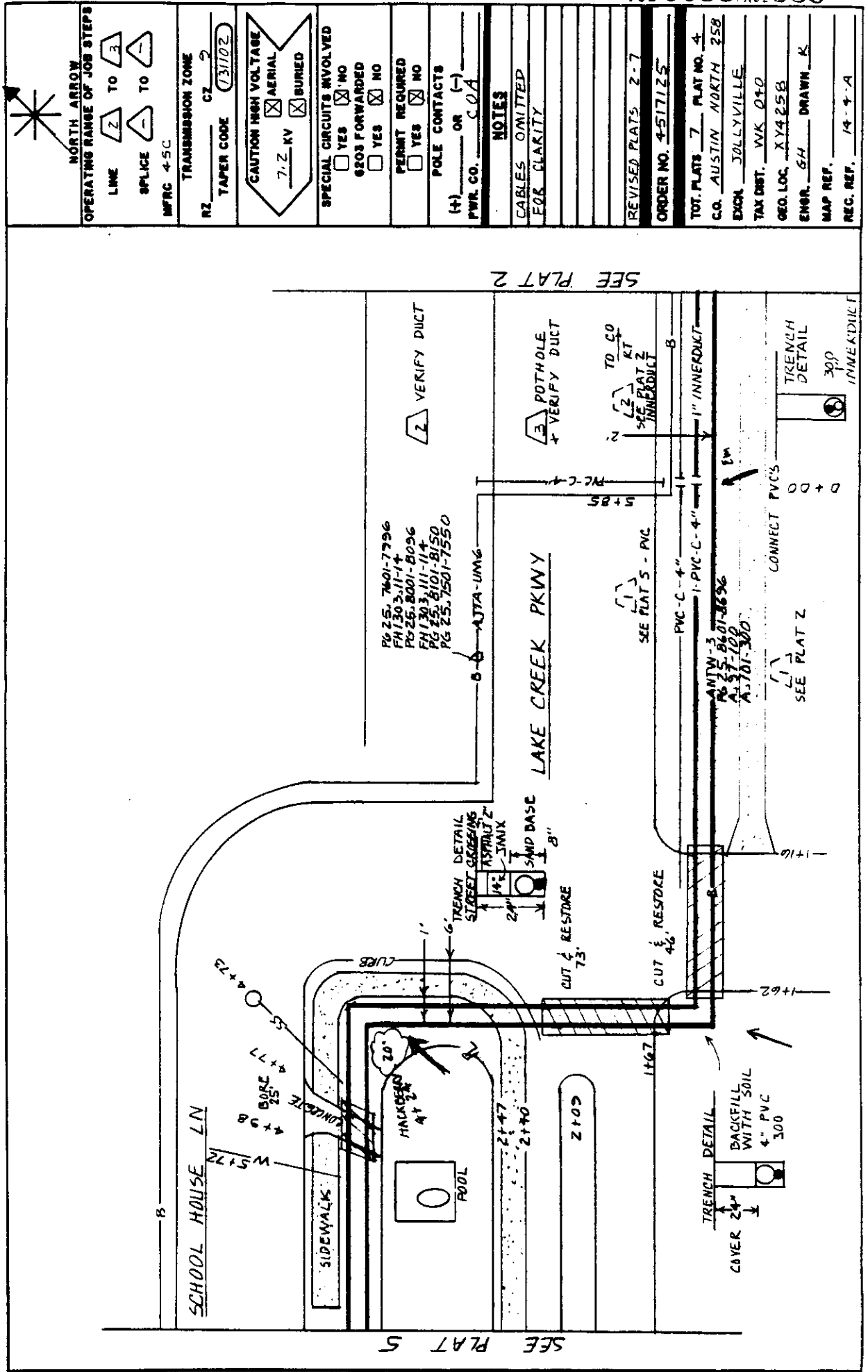

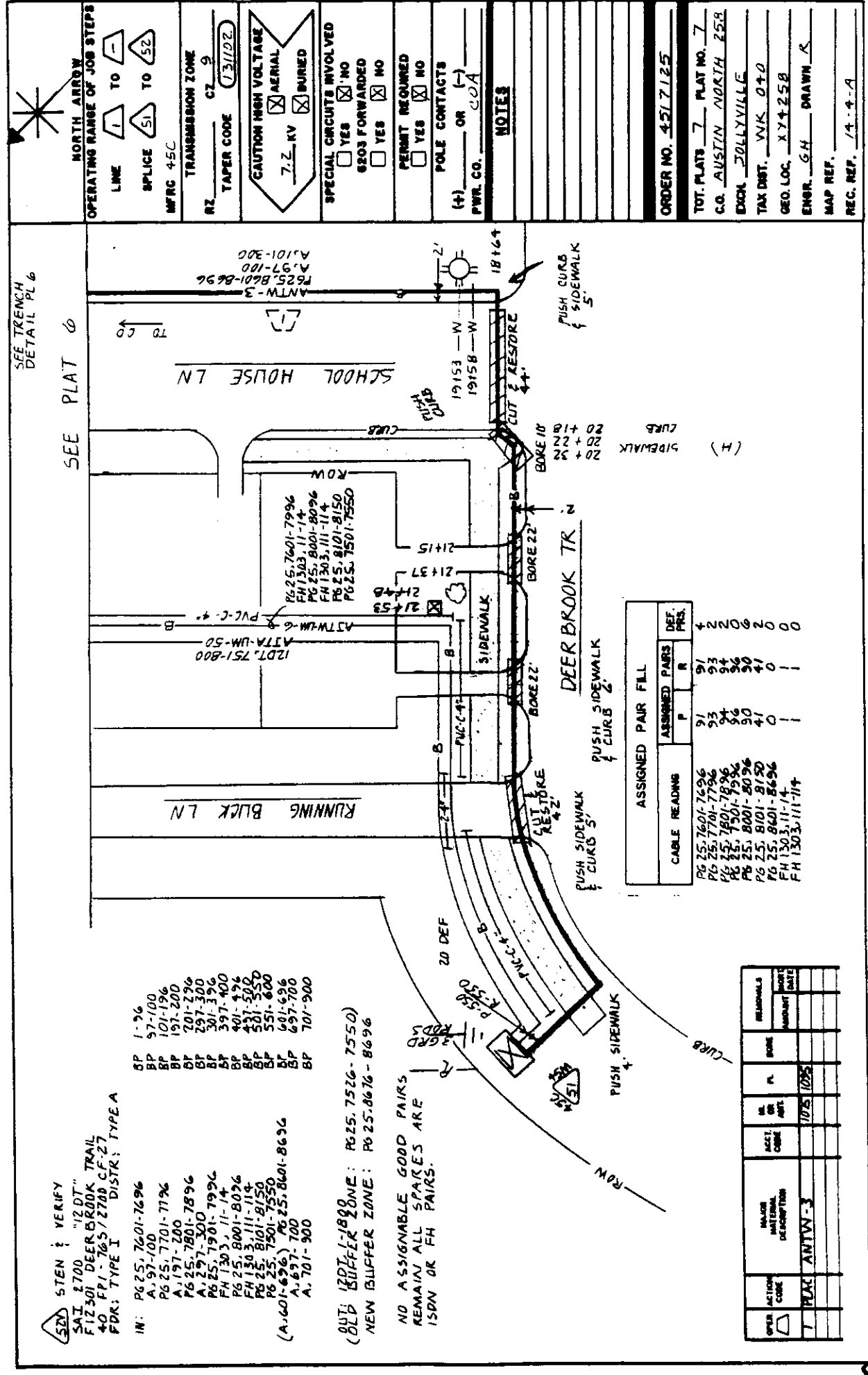

NOTICE OF PROPOSED INSTALLATION

UTILITY LINE ON WILLIAMSON COUNTY RIGHT-OF-WAY

TO: Williamson County Unified Road System
1900 Georgetown Inner Loop, Suite B
Georgetown, Texas 78626

DATE: 6-3-98

Formal notice is hereby given that Southwestern Bell Telephone Co.

Company proposes to place a Buried conduit

line within the right-of-way of Anderson Mill Rd
as follows: (give location, length, general design, etc.)

AS PER ATTACHED CONDUIT DRAWINGS.
WEST OF US 183 FOR APPROXIMATELY 1500'
TO EXISTING LAND M.H.

The line will be constructed and maintained on the road right-of-way as directed by the Williamson County Unified Road System in accordance with governing laws.

Our firm further understands that the County considers proper traffic control measures as those complying with applicable portions of the Texas Manual of Traffic Control Devices required for adoption by the "Transportation Code" (V.C.T.A. CH.251)

The location and description of the proposed line and appurtenances is more fully shown by 3 copies of drawings attached to this notice.

Construction of this line is proposed to begin on or after the 1st day of July 19 98

APPROVAL

This application is hereby approved subject to the following understandings and restrictions.

It is expressly understood that the said County Commissioners' Court does not imply hereby to grant any right, claim, title or easement in or upon this County Road; and it is further understood that in the future, should Williamson County, for any reason, need to work, improve, relocate, widen, increase, add to, decrease, or in any manner change the structure of this road or right-of-way, this line, if affected, will be moved at the direction of the Williamson County Engineer or County Commissioner. This installation work shall not damage any part of the roadway and adequate provisions shall be made to cause a minimum of inconvenience to traffic and adjacent property owners.

APPROVED BY WILLIAMSON COUNTY COMMISSIONERS' COURT

BY: [Signature]
COUNTY ROAD ADMINISTRATOR

DATE: 6/22/98

Firm: Southwestern Bell Telephone

[Signature]
Authorized Signature

Gibson Hoffman Jr.
Printed Name

Address: 1616 Guadalupe Ln 406
Austin, Texas 78701

Phone: (512) 870-3443

Fax: (512) 870-3305

pt. 2

6-8-98

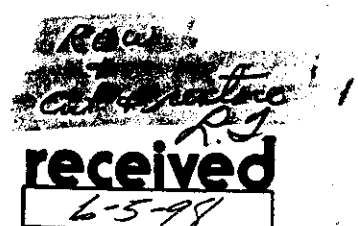

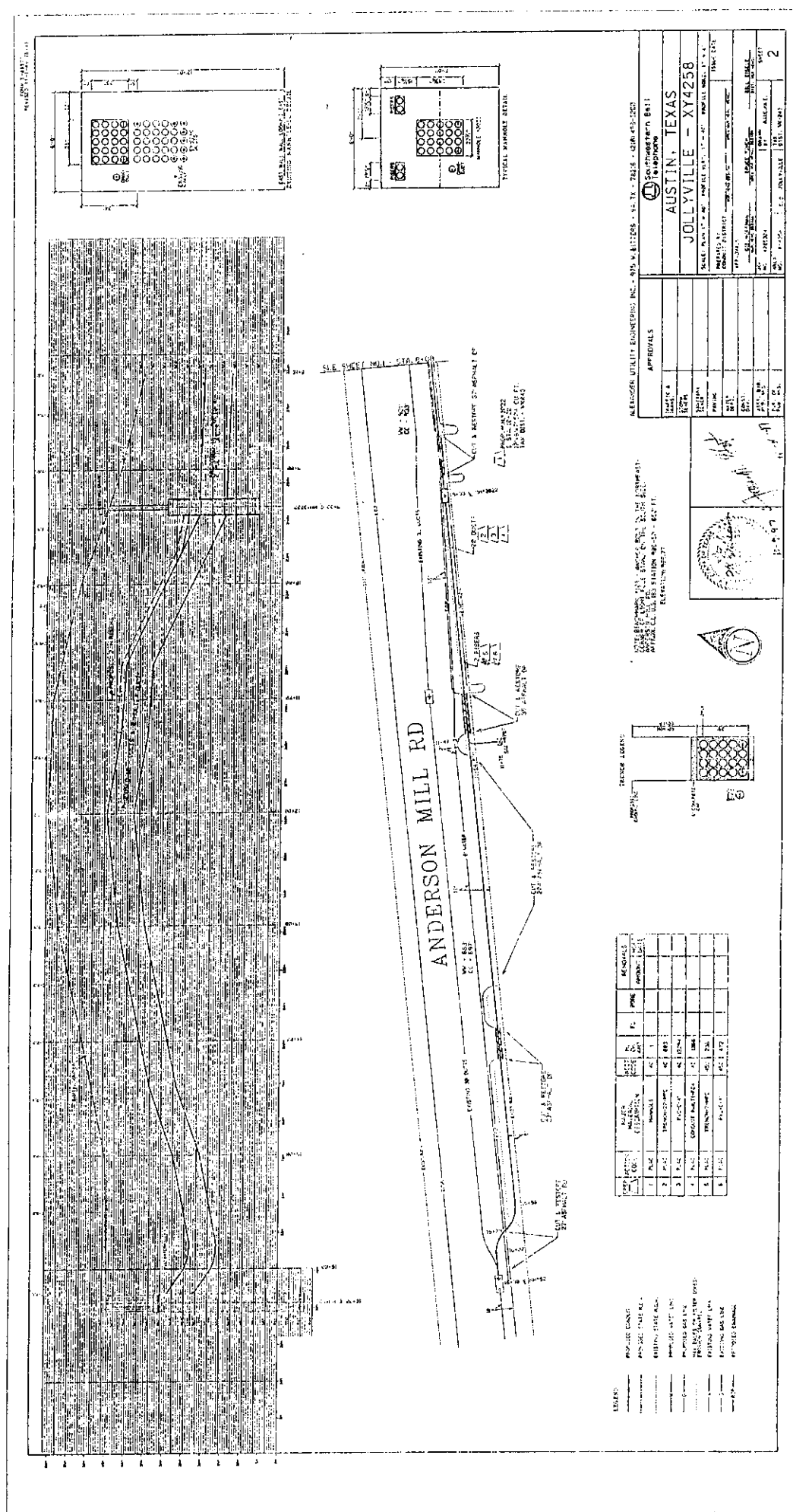

**RECORDERS MEMORANDUM**

RECORDERS MEMORANDUM
All or parts of the text on this page was not
clearly legible for satisfactory recordation.

NOTICE OF PROPOSED INSTALLATION

UTILITY LINE ON WILLIAMSON COUNTY RIGHT-OF-WAY

TO: Williamson County Unified Road System
1900 Georgetown Inner Loop, Suite B
Georgetown, Texas 78626

DATE: 6-2-98Formal notice is hereby given that NORTH Austin M.U.D. #1 / ECO RESOURCESCompany proposes to place a ROAD CUTline within the right-of-way of 13306 KINGMAN DRIVE
as follows: (give location, length, general design, etc.)

Will be Digging up WATER SERVICE DUE TO A LEAK FOUND BY
LCRA LEAK DETECTION. WE WILL PUT ROAD BACK TO PERMIT SPEEDS

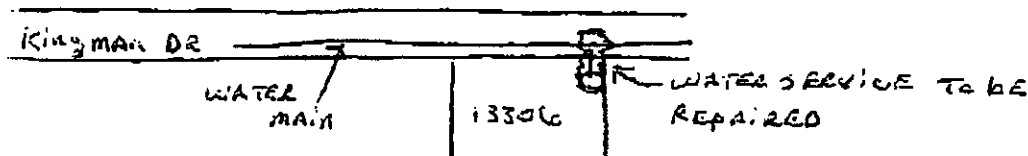

The line will be constructed and maintained on the road right-of-way as directed by the Williamson County Unified Road System in accordance with governing laws.

Our firm further understands that the County considers proper traffic control measures as those complying with applicable portions of the Texas Manual of Traffic Control Devices required for adoption by the "Transportation Code" (V.C.T.A. CH.251)

The location and description of the proposed line and appurtenances is more fully shown by _____ copies of drawings attached to this notice.

Construction of this line is proposed to begin on or after the 5 day of JUNE 19 98.

APPROVAL

This application is hereby approved subject to the following understandings and restrictions.

It is expressly understood that the said County Commissioners' Court does not imply hereby to grant any right, claim, title or easement in or upon this County Road; and it is further understood that in the future, should Williamson County, for any reason, need to work, improve, relocate, widen, increase, add to, decrease, or in any manner change the structure of this road or right-of-way, this line, if affected, will be moved at the direction of the Williamson County Engineer or County Commissioner. This installation work shall not damage any part of the roadway and adequate provisions shall be made to cause a minimum of inconvenience to traffic and adjacent property owners.

APPROVED BY WILLIAMSON COUNTY COMMISSIONERS' COURT

BY: [Signature]
COUNTY ROAD ADMINISTRATOR

DATE: 6/22/98Firm: NORTH Austin M.U.D. #1 / ECO RESOURCESBy: MIKE WHEELER
(Print Name)Title: FOREMANAddress: 9511 RANCH ROAD 620 NORTHAUSTIN, TEXAS 78726-2908Phone: (512) 335-7580Fax: (512) 335-0251pt. 1

6-18-98
cut + restore
R.J.

CONTRACTOR'S LIABILITY AGREEMENTP. 4/5
VOL 0098 PAGE 567

I, ECO RESOURCES, Contractor for NORTH Austin MUD #1
in Williamson County, Texas do hereby agree to the following schedules and conditions for doing work
within the right-of-way of 13306 KINGMAN DRIVE which is a public
roadway maintained by Williamson County.

1. I will contact the Williamson County Unified Road System at least 48 hours prior to start of construction.
2. All work in the right-of-way will be done between the hours of 8:30 a.m. and 4:30 p.m. on Monday through Friday only.
3. Cuts will be opened for one-half the roadway only, with flagmen on both sides of the work area, allowing one-way traffic through. This type of operation will be held to a minimum and all advance warning signs and barricades shall be as specified in the Texas Manual on Uniform Traffic Control Devices. These cuts will also be filled and entire roadway opened at night and on weekends.
4. Roadside work in ditches alongside the trenched surface may be left opened at night, only if they can be barricaded solidly between open ditch and traveled roadway leaving a minimum 6' of road shoulder between the pavement edge and the barricades. The barricades must be reflectorized and lighted with warning lights and conform to the requirements of the T.M.U.T.C.D. for nighttime use.
5. Any construction area to be maintained from dusk to dawn shall have Type B High Intensity Steady Burn Warning Lights to delineate the traveled way through and around obstructions in a construction or maintenance area. All warning lights shall be installed to a minimum mounting height of 36" to the bottom of the lense.
6. Construction work and road repair on County right-of-way will be done to Williamson County Standards and to the approval of the Williamson County Unified Road System.
7. I will notify the Williamson County Unified Road System and obtain approval prior to any changes from this agreement if required due to soil conditions or other problems.

6-2-98

DATE

Williamson County Unified Road System
1900 Georgetown Inner Loop, Ste. B
Georgetown, Texas 78626

Mike W. Haden

SIGNED

ECO RESOURCES
CONTRACTOR (PRINT NAME)

9511 R.R. 620 N
ADDRESS

Austin, TX 78726-2908
CITY, STATE, ZIP CODE

(512) 335-7580
PHONE

VOL 0098 PAGE 588

PARALLEL UTILITY CUT DESIGN IN WILLIAMSON COUNTY R.O.W.

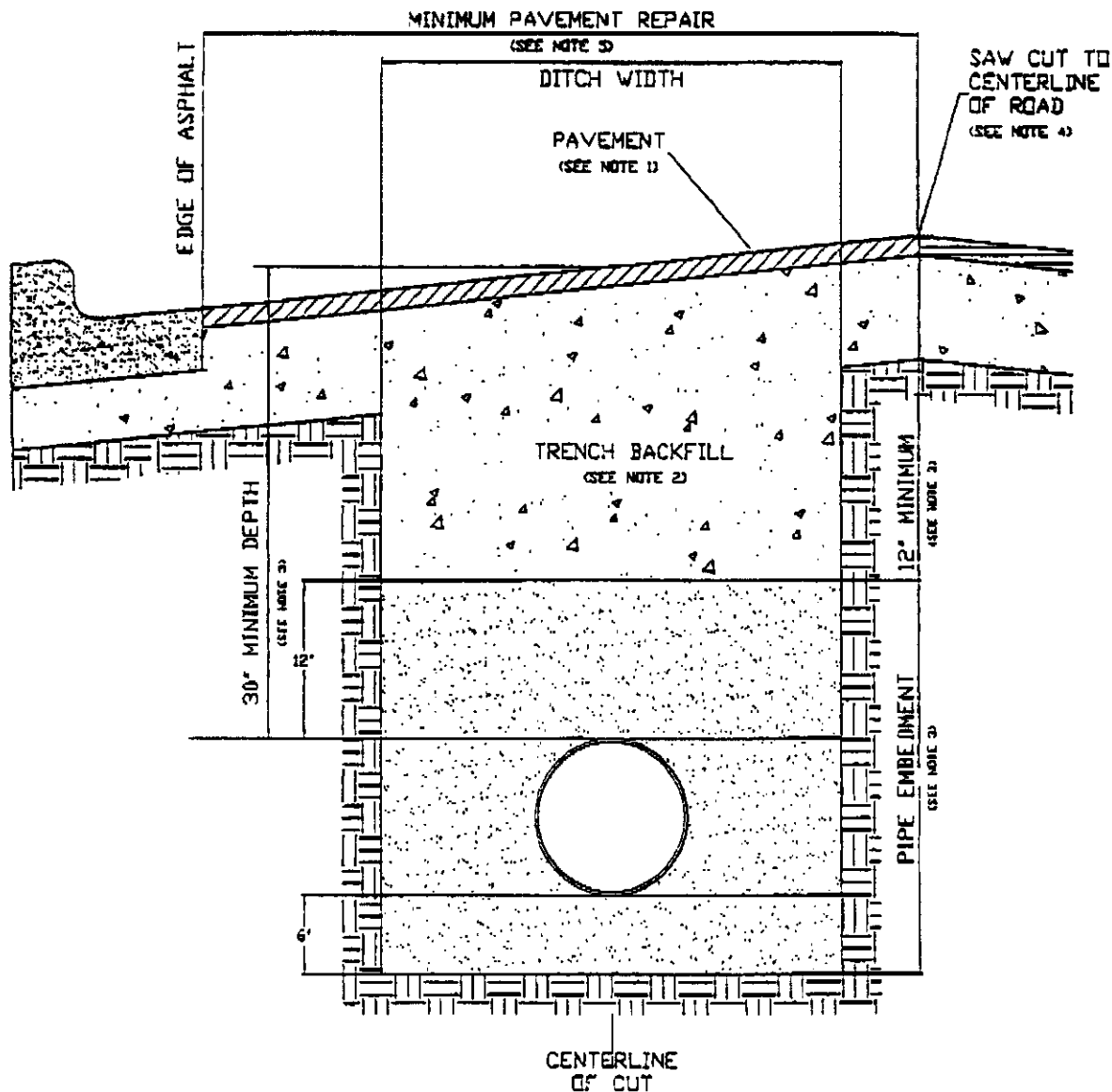

1. Hot mix asphalt to match existing HMA thickness or 2" minimum, whichever is greater. Roll in place to match existing surface, + or - 1/8" tolerance.
2. Trench backfill shall be flexible base, compacted to 95% optimum in 8" layers unless otherwise approved and specified. Flexible base to match existing base thickness or 8", whichever is greater (Specifications: TxDOT Item 247, Type A, Grade 2).
3. Pipe embedment (pipe envelope) size and materials shall be as specified elsewhere by the utility company and/or its engineers. Pipe depth shall be as specified elsewhere provided that minimum depths are met.
4. Saw cut shall be made prior to ditch cut. If pavement is damaged during cut, a new saw cut shall be made beyond the damaged area and new pavement placed.
5. Damage beyond the centerline requires repair over entire roadway width.
6. All pavement repair shall conform to Item 351 Repairing Existing Flexible Pavement Structure as found in the 1993 Texas Department of Transportation Standard Specifications for Construction of Highways, Streets and Bridges.

PERPENDICULAR UTILITY CUT DESIGN IN WILLIAMSON COUNTY R.O.W.

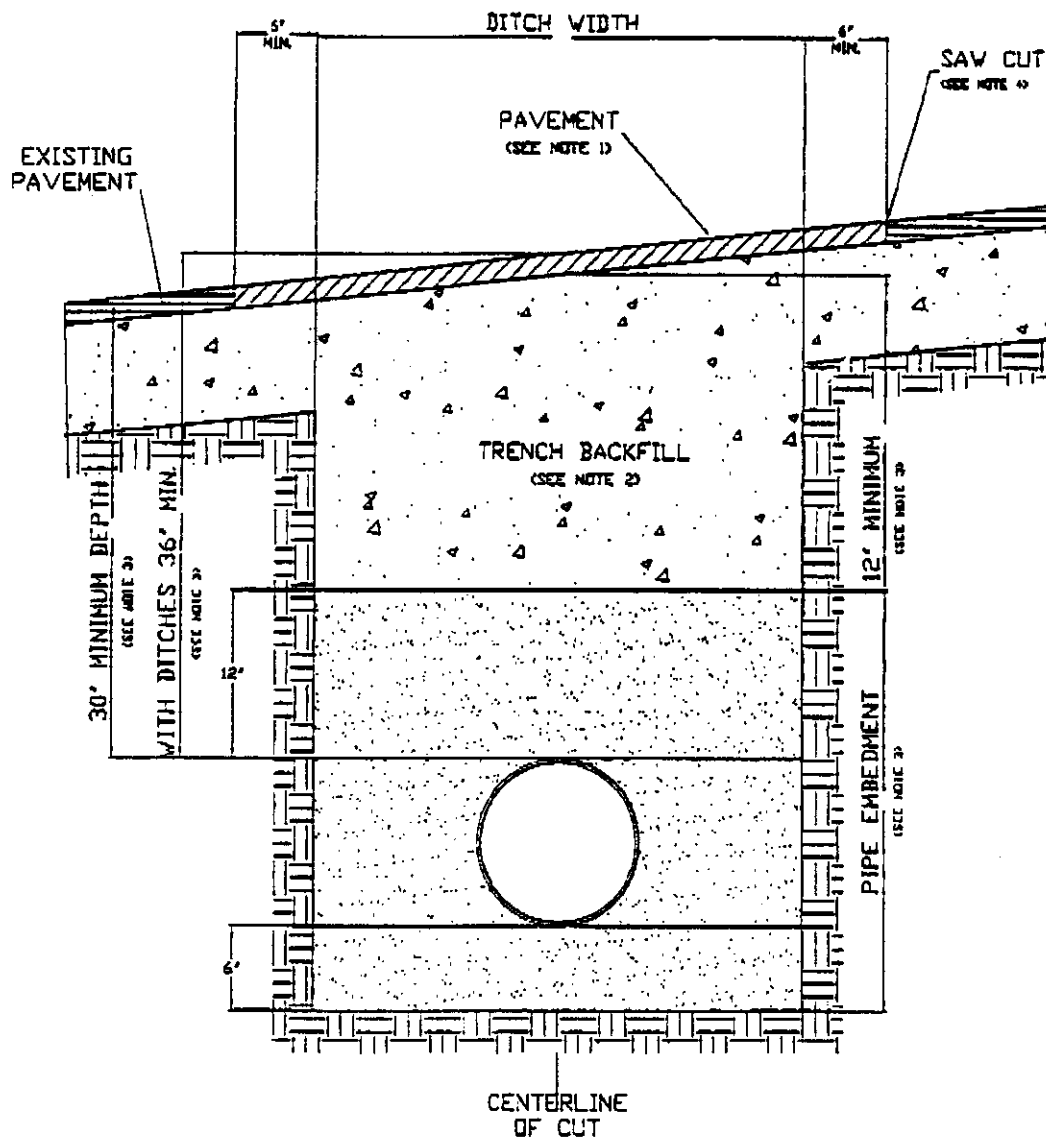

1. Hot mix asphalt 1 1/2" min. thickness. Roll in place to match existing surface, + or - 1/8" tolerance.
2. Trench backfill shall be flexible base, compacted to 95% optimum in 8" layers unless otherwise approved and specified. Flexible base to match existing base thickness or 8 inches, whichever is greater (specifications; TxDOT Item 247, Type A, Grade 2).
3. Pipe embedment (pipe envelope) size and materials shall be as specified elsewhere by utility company and/or its engineers. Pipe depth shall be as specified elsewhere provided that minimum depths are met.
4. Saw cut shall be made prior to ditch cut. If pavement is damaged during cut, a new saw cut shall be made beyond the damaged area and new pavement placed.
5. Where roadside ditches (bar ditches) are crossed by the utility pipe, minimum depth to the top of the pipe from centerline road elevation will be 36".
6. All pavement repair shall conform to Item 351 Repairing Existing Flexible Pavement Structure as found in the 1993 Texas Department of Transportation Standard Specifications for Construction of Highways, Streets and Bridges.

NOTICE OF PROPOSED INSTALLATION

UTILITY LINE ON WILLIAMSON COUNTY RIGHT-OF-WAY

TO: Williamson County Unified Road System
1900 Georgetown Inner Loop, Suite B
Georgetown, Texas 78626

DATE: 5-28-98

Formal notice is hereby given that The City of Georgetown
Company proposes to place a Wastewater Utility Line
line within the right-of-way of Paleface Street, Indian Creek Subd.
as follows: (give location, length, general design, etc.)

See attached Plans

The line will be constructed and maintained on the road right-of-way as directed by the Williamson County Unified Road System in accordance with governing laws.

Our firm further understands that the County considers proper traffic control measures as those complying with applicable portions of the Texas Manual of Traffic Control Devices required for adoption by the "Transportation Code" (V.C.T.A. CH.251)

The location and description of the proposed line and appurtenances is more fully shown by _____ copies of drawings attached to this notice.

Construction of this line is proposed to begin on or after the 28th day of May 1998.

APPROVAL

This application is hereby approved subject to the following understandings and restrictions.

It is expressly understood that the said County Commissioners' Court does not imply hereby to grant any right, claim, title or easement in or upon this County Road; and it is further understood that in the future, should Williamson County, for any reason, need to work, improve, relocate, widen, increase, add to, decrease, or in any manner change the structure of this road or right-of-way, this line, if affected, will be moved at the direction of the Williamson County Engineer or County Commissioner. This installation work shall not damage any part of the roadway and adequate provisions shall be made to cause a minimum of inconvenience to traffic and adjacent property owners.

APPROVED BY WILLIAMSON COUNTY COMMISSIONERS' COURT

BY: [Signature]
COUNTY ROAD ADMINISTRATOR

DATE: 6/23/98

Firm: City of Georgetown

David Munk

Authorized Signature

David Munk

Printed Name

Address: 1101 N. College St.

Phone: 930-3555

Fax: 930-3509

Pct. 3 Bond # TX 511503

6-23-98
cut + restore
R.J.

received
6-22-98

to 12 6-22-98

CONTRACTOR'S LIABILITY AGREEMENT

I, Carol Klugman Contractor for City of Georgetown
 in Williamson County, Texas do hereby agree to the following schedules and conditions for doing work
 within the right-of-way of Poleface St, Indian Creek Sub Div which is a public
 roadway maintained by Williamson County.

1. I will contact the Williamson County Unified Road System at least 48 hours prior to start of construction.
2. All work in the right-of-way will be done between the hours of 8:30 a.m. and 4:30 p.m. on Monday through Friday only.
3. Cuts will be opened for one-half the roadway only, with flagmen on both sides of the work area, allowing one-way traffic through. This type of operation will be held to a minimum and all advance warning signs and barricades shall be as specified in the Texas Manual on Uniform Traffic Control Devices. These cuts will also be filled and entire roadway opened at night and on weekends.
4. Roadside work in ditches alongside the trenched surface may be left opened at night, only if they can be barricaded solidly between open ditch and traveled roadway leaving a minimum 6' of road shoulder between the pavement edge and the barricades. The barricades must be reflectorized and lighted with warning lights and conform to the requirements of the T.M.U.T.C.D. for nighttime use.
5. Any construction area to be maintained from dusk to dawn shall have Type B High Intensity Steady Burn Warning Lights to delineate the traveled way through and around obstructions in a construction or maintenance area. All warning lights shall be installed to a minimum mounting height of 36" to the bottom of the lense.
6. Construction work and road repair on County right-of-way will be done to Williamson County Standards and to the approval of the Williamson County Unified Road System.
7. I will notify the Williamson County Unified Road System and obtain approval prior to any changes from this agreement if required due to soil conditions or other problems.

5-27-98
 DATE

Williamson County Unified Road System
 1900 Georgetown Inner Loop, Ste. B
 Georgetown, Texas 78626

 SIGNED

Carol Klugman
 CONTRACTOR (PRINT NAME)

Rt 1, Box 36
 ADDRESS

Georgetown, TX 78626
 CITY, STATE, ZIP CODE

1-512-930-1140
 PHONE

36198222

NOTICE OF PROPOSED INSTALLATION

UTILITY LINE ON WILLIAMSON COUNTY RIGHT-OF-WAY

TO: Williamson County Unified Road System
1900 Georgetown Inner Loop, Suite B
Georgetown, Texas 78626

DATE: May 28, 1998Formal notice is hereby given that Central Telephone Company of TexasCompany proposes to place a buried cable

line within the right-of-way of CR 136
as follows: (give location, length, general design, etc.)

The work area is in front of the southeast corner of the Clark Crossing Subdivision. From pole #1010-14 on the south side of CR 136 place cable under the road via 3 inch steel pipe bore to our pedestal on the north side of CR 136 and place a pedestal adjacent to the pole.

The line will be constructed and maintained on the road right-of-way as directed by the Williamson County Unified Road System in accordance with governing laws.

Our firm further understands that the County considers proper traffic control measures as those complying with applicable portions of the Texas Manual of Traffic Control Devices required for adoption by the "Transportation Code" (V.C.T.A. CH.251)

The location and description of the proposed line and appurtenances is more fully shown by 2 copies of drawings attached to this notice.

Construction of this line is proposed to begin on or after the 15th day of June, 19 98.

APPROVALFirm: Central Telephone Company of Texas

This application is hereby approved subject to the following understandings and restrictions.

Authorized Signature Bob Williams

It is expressly understood that the said County Commissioners' Court does not imply hereby to grant any right, claim, title or easement in or upon this County Road; and it is further understood that in the future, should Williamson County, for any reason, need to work, improve, relocate, widen, increase, add to, decrease, or in any manner change the structure of this road or right-of-way, this line, if affected, will be moved at the direction of the Williamson County Engineer or County Commissioner. This installation work shall not damage any part of the roadway and adequate provisions shall be made to cause a minimum of inconvenience to traffic and adjacent property owners.

Printed name Bob Williams

Address:

1214 Dogwood Blvd.P. O. Box 1150Killeen, Texas 76540Phone: 254-690-9358Fax: 254-690-9815Pct. 4

APPROVED BY WILLIAMSON COUNTY COMMISSIONERS' COURT

BY: Ray Berger

COUNTY ROAD ADMINISTRATOR

DATE: 6/16/986-15-98BareR.J.

92

received
6-11-98

CONTRACTOR'S LIABILITY AGREEMENT

VOL 0098 PAGE 573

I, Larry Parker, Contractor for Isbell Construction
in Williamson County, Texas do hereby agree to the following schedules and conditions for doing work
within the right-of-way of CR 136 which is a public
roadway maintained by Williamson County.

1. I will contact the Williamson County Unified Road System at least 48 hours prior to start of construction.
2. All work in the right-of-way will be done between the hours of 8:30 a.m. and 4:30 p.m. on Monday through Friday only.
3. Cuts will be opened for one-half the roadway only, with flagmen on both sides of the work area, allowing one-way traffic through. This type of operation will be held to a minimum and all advance warning signs and barricades shall be as specified in the Texas Manual on Uniform Traffic Control Devices. These cuts will also be filled and entire roadway opened at night and on weekends.
4. Roadside work in ditches alongside the trenched surface may be left opened at night, only if they can be barricaded solidly between open ditch and traveled roadway leaving a minimum 6' of road shoulder between the pavement edge and the barricades. The barricades must be reflectorized and lighted with warning lights and conform to the requirements of the T.M.U.T.C.D. for nighttime use.
5. Any construction area to be maintained from dusk to dawn shall have Type B High Intensity Steady Burn Warning Lights to delineate the traveled way through and around obstructions in a construction or maintenance area. All warning lights shall be installed to a minimum mounting height of 36" to the bottom of the lense.
6. Construction work and road repair on County right-of-way will be done to Williamson County Standards and to the approval of the Williamson County Unified Road System.
7. I will notify the Williamson County Unified Road System and obtain approval prior to any changes from this agreement if required due to soil conditions or other problems.

5/28/98

DATE

Williamson County Unified Road System
1900 Georgetown Inner Loop, Ste. B
Georgetown, Texas 78626

SIGNED

LARRY PARKER
CONTRACTOR (PRINT NAME)

PO Box 266
ADDRESS

FLORENCE TX 76527
CITY, STATE, ZIP CODE

254-293-3603
PHONE



3010 LBJ Freeway, Suite 555 • Dallas, TX 75234

LICENSE AND PERMIT BOND

(For County, City, Town or Village Only)

Bond No. RSB- 571436

Know All Men By These Presents:

That we Ishell Construction, Inc.
 of the city of Florence, State of Texas as Principal,
 and the RLI Insurance Company, a corporation duly licensed to do business in the state of Texas, as
 Surety, are held and firmly bound unto the Williamson County Unified Road System
(Valid only when a County, City, Town or Village is named as Obligor)
 State of Texas, Obligor, in penal sum of two thousand (\$ 2,000.00) DOLLARS,
(Not valid if filled in for more than \$25,000)
 lawful money of the United States, to be paid to the said Obligor, for which payment well and truly to be made, we bind ourselves and
 our legal representatives, jointly and severally by these presents.

THE CONDITION OF THE ABOVE OBLIGATION IS SUCH, that whereas, the said Principal has been licensed as _____
street cutting contractor by the Obligor.

NOW, THEREFORE, if the said Principal shall faithfully perform the duties and in all things comply with the laws and ordinances,
 including all Amendments thereto, pertaining to the license or permit applied for, then this obligation to be void, otherwise to remain
 in full force and effect until November 12, 19 98, unless renewed by Continuation Certificate.

This bond may be terminated at any time by the Surety upon sending written notice to the clerk of the Political Subdivision with whom
 this bond is filed and to the Principal, addressed to them at their first known address, and at the expiration of thirty-five (35) days from
 the mailing of said notice, or as soon thereafter as permitted by applicable law, whichever is later, this bond shall ipso facto terminate
 and the Surety shall thereupon be relieved from any liability for any acts or omissions of the Principal subsequent to said date.

Dated this 12th day of November, 19 97.

[Signature]
 Principal
 (Individual, Partner or Corporate Officer)

[Signature]
 Principal
 (Additional Partner or Partners)

Countersigned

By [Signature]
 Resident Agent

RLI INSURANCE COMPANY

By [Signature]
 Jonathan E. Michael, President

Acknowledgement of Surety
(Corporate Officer)

STATE OF ILLINOIS)
) SS
 County of Peoria)

On this _____ day of _____, 19____, before me, the undersigned officer, personally appeared Jonathan E. Michael, who
 acknowledged himself to be the aforesaid officer of the RLI Insurance Company, a corporation, and that he as such officer, being
 authorized so to do, executed the foregoing instrument for the purpose therein contained, by signing the name of the corporation by
 himself as such officer.

IN WITNESS WHEREOF, I have hereunto set my hand and official seal.

Complaint Notice: Should any dispute arise about your premiums or about
 a claim that you have filed, contact the agent or write to the issuer of this
 bond, RLI Insurance Company. If the problem is not resolved, you may also
 write the State Board of Insurance, Department C, 1110 San Jacinto, Austin,
 Texas 78786. This notice of complaint procedure is for information only and
 does not become part or condition of this bond.

OFFICIAL SEAL
 Shelly L. Moore
 Notary Public, State of Illinois
 My Commission Expires 8/31/98

[Signature]
 Notary Public

94

ALP00001X 1-98

101

CLARKS WAY

CLARKS GROVE LN

CR 136

CR 136

25' R.O.W. DEDICATION

95

① SEE SHEET 9

SEE SHEET 14

①
*3248 310'
A-100-24 ALP-SJ-FSF
(1,801-900) 136.1-100
<36198222.0>

①
*10316 310'
A-200-24 ALP-SJ-FSF
(136.101-300)
(PP)

*5173
P.....

②
L.O.#2
421110
423110
411410
421410

*3352
P1010-14

*3365 94'
A-100-24 ASP-SJ-FSF
(A,1-7) 136.101-200
(1,808-824)
(A,25-44)
(1,845-850)
(A,51-75)
(A,76-100)
<36198222.0>

*3216 3187'
A-100-24 ALP-SJ-FSF
(1,801-900) 136.1-100
<36198222.0>

③
L.O.#3
423110
421410
411410

*10340 (PP)
*R102MC
CPLM-8

*3367 220'
A-100-24 ASP-SJ-FSF
(A,1-7) 136.101-200
(1,808-824)
(A,25-44)
(1,845-850)
(A,51-100)

*10339 80'
A-200-24 ALP-SJ-FSF
(136.101-300)
(PP)

<40'x3' GALV STL

<36198222.0>

NOTICE OF PROPOSED INSTALLATION

UTILITY LINE ON WILLIAMSON COUNTY RIGHT-OF-WAY

TO: Williamson County Unified Road System
1900 Georgetown Inner Loop, Suite B
Georgetown, Texas 78626

DATE: June 12, 1998

Formal notice is hereby given that Southwest Milam Water Supply Corporation

Company proposes to place a water line

line within the right-of-way of CR 419
as follows: (give location, length, general design, etc.)

Bore and encase a 1 1/4" PVC carrier in a 2" PVC casing across CR 419 approximately 4,224 ft. south of the CR 422 and CR 419 intersection. Pipe to be 3 ft. below ditch line and encase from ditch line approximately 50 ft.

The line will be constructed and maintained on the road right-of-way as directed by the Williamson County Unified Road System in accordance with governing laws.

Our firm further understands that the County considers proper traffic control measures as those complying with applicable portions of the Texas Manual of Traffic Control Devices required for adoption by the "Transportation Code" (V.C.T.A. CH.251)

The location and description of the proposed line and appurtenances is more fully shown by 2 copies of drawings attached to this notice.

Construction of this line is proposed to begin on or after the 23rd day of June 1998.

APPROVAL

This application is hereby approved subject to the following understandings and restrictions.

It is expressly understood that the said County Commissioners' Court does not imply hereby to grant any right, claim, title or easement in or upon this County Road; and it is further understood that in the future, should Williamson County, for any reason, need to work, improve, relocate, widen, increase, add to, decrease, or in any manner change the structure of this road or right-of-way, this line, if affected, will be moved at the direction of the Williamson County Engineer or County Commissioner. This installation work shall not damage any part of the roadway and adequate provisions shall be made to cause a minimum of inconvenience to traffic and adjacent property owners.

APPROVED BY WILLIAMSON COUNTY COMMISSIONERS' COURT

BY: [Signature]
COUNTY ROAD ADMINISTRATOR

DATE: 6/18/98

Firm: Southwest Milam Water Supply Corp.

[Signature]
Authorized Signature

Dwayne Jekel

Printed Name

Address: P.O. Box 232

Rockdale, Texas 76567

Phone: 512-446-2604

Fax: 512-446-7376

Pet #

6-17-98

Bore
R.J.

received
6-16-98

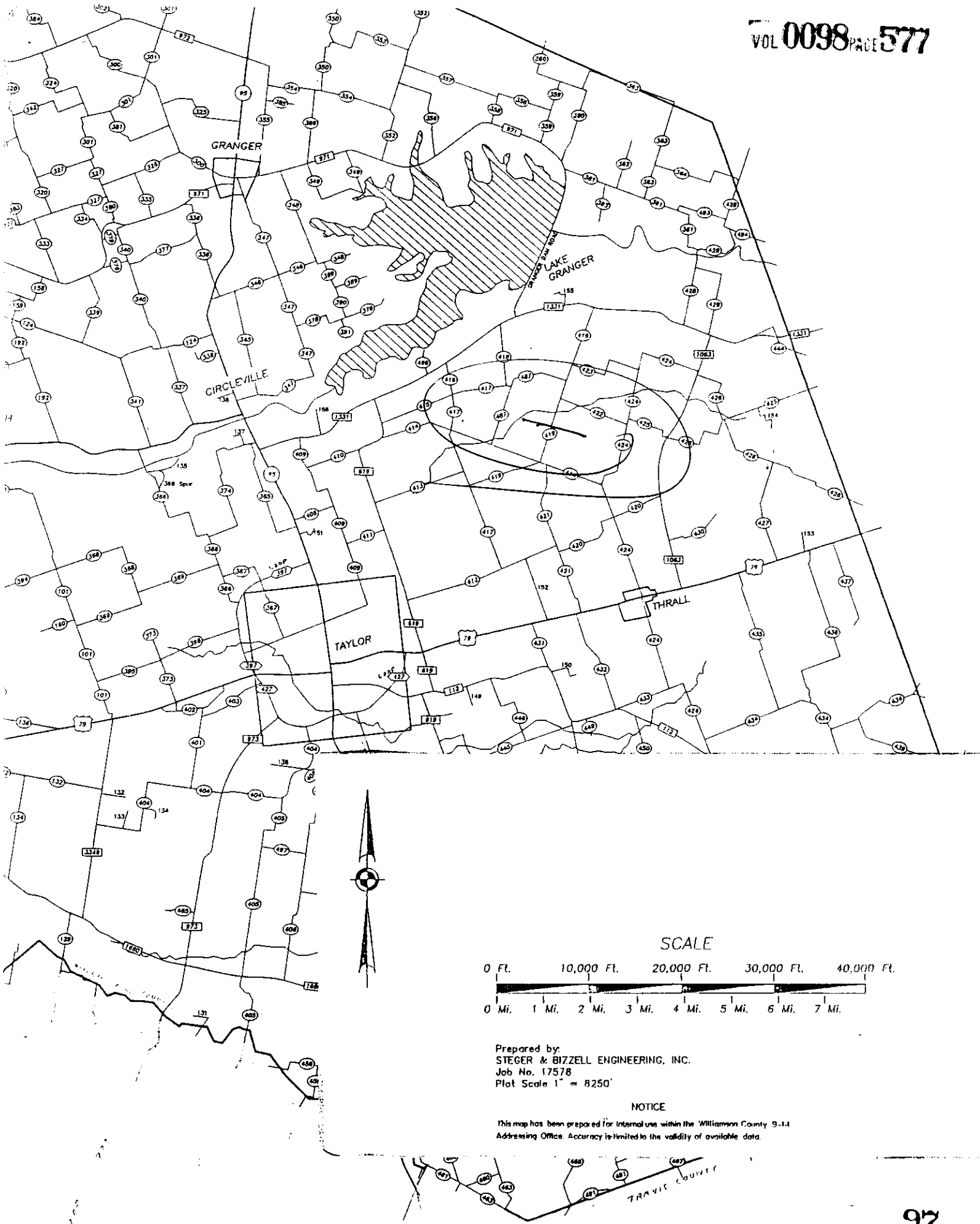

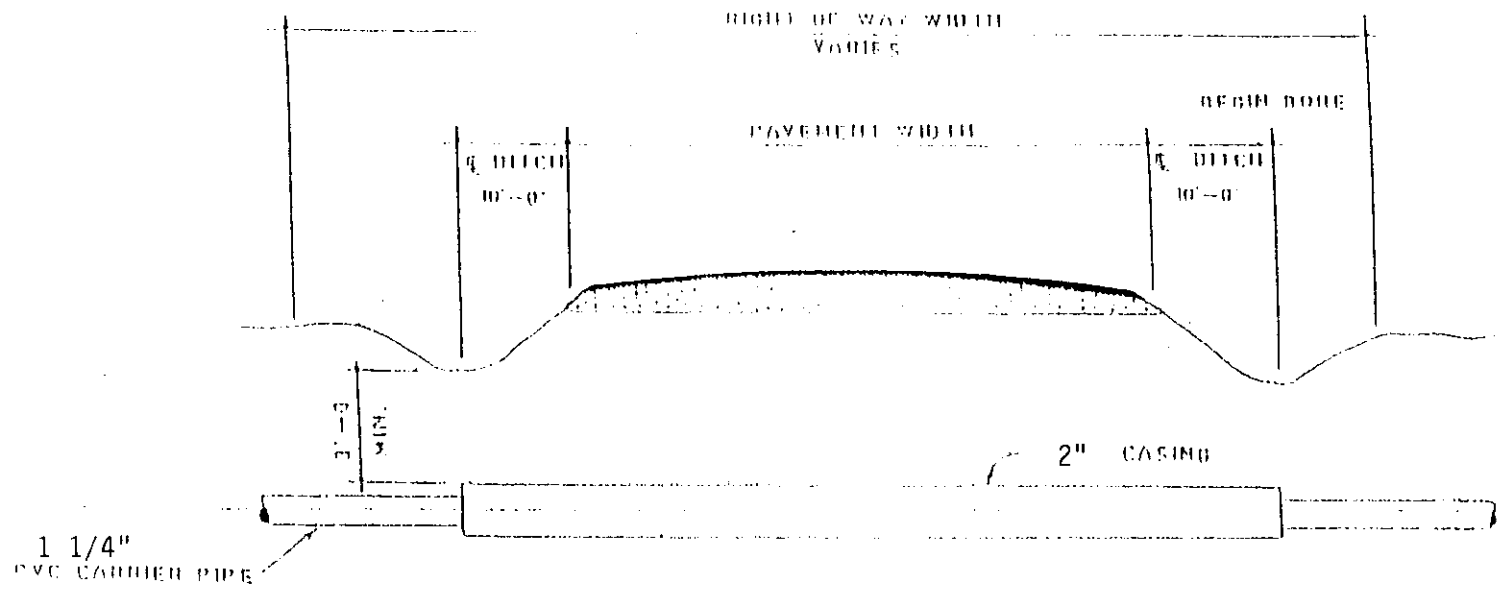

PIPE BORE AND CASING DETAIL

RECORDERS MEMORANDUM
All or parts of the text on this page was not
clearly legible for satisfactory recordation.

NOTICE OF PROPOSED INSTALLATION

UTILITY LINE ON WILLIAMSON COUNTY RIGHT-OF-WAY

TO: Williamson County Unified Road System
1900 Georgetown Inner Loop, Suite B
Georgetown, Texas 78626

DATE: June 12, 1998

Formal notice is hereby given that Southwest Milam Water Supply Corporation

Company proposes to place a water line

line within the right-of-way of CR 427
as follows: (give location, length, general design, etc.)

Bore and encase a 1 1/4" PVC carrier in a 2" PVC casing across CR 427
approximately 2,112 ft. south of the CR 426 and CR 427 intersection. Pipe
to be 3 ft. below ditch line and encase from ditch line to ditch line
approximately 50 ft.

The line will be constructed and maintained on the road right-of-way as directed by the Williamson County
Unified Road System in accordance with governing laws.

Our firm further understands that the County considers proper traffic control measures as those complying
with applicable portions of the Texas Manual of Traffic Control Devices required for adoption by the
"Transportation Code" (V.C.T.A. CH.251)

The location and description of the proposed line and appurtenances is more fully shown
by 2 copies of drawings attached to this notice.

Construction of this line is proposed to begin on or after the 23rd day of June 19 98

APPROVAL

This application is hereby approved subject to the
following understandings and restrictions.

It is expressly understood that the said County
Commissioners' Court does not imply hereby to
grant any right, claim, title or easement in or upon
this County Road; and it is further understood that
in the future, should Williamson County, for any
reason, need to work, improve, relocate, widen,
increase, add to, decrease, or in any manner change
the structure of this road or right-of-way, this line,
if affected, will be moved at the direction of the
Williamson County Engineer or County Commissioner.
This installation work shall not damage any part of the
roadway and adequate provisions shall be made to
cause a minimum of inconvenience to traffic and adjacent
property owners.

APPROVED BY WILLIAMSON COUNTY COMMISSIONERS' COURT

BY: Amy Bergman
COUNTY ROAD ADMINISTRATOR

DATE: 6/18/98

Firm: Southwest Milam Water Supply Corp.

Authorized Signature

Dwayne Jekel

Printed Name

Address: P.O. Box 232

Rockdale, Texas 76567

Phone: 512-446-2604

Fax: 512-446-7376

pt 4

6-17-98

Bore
R.J.

received
6-16-98

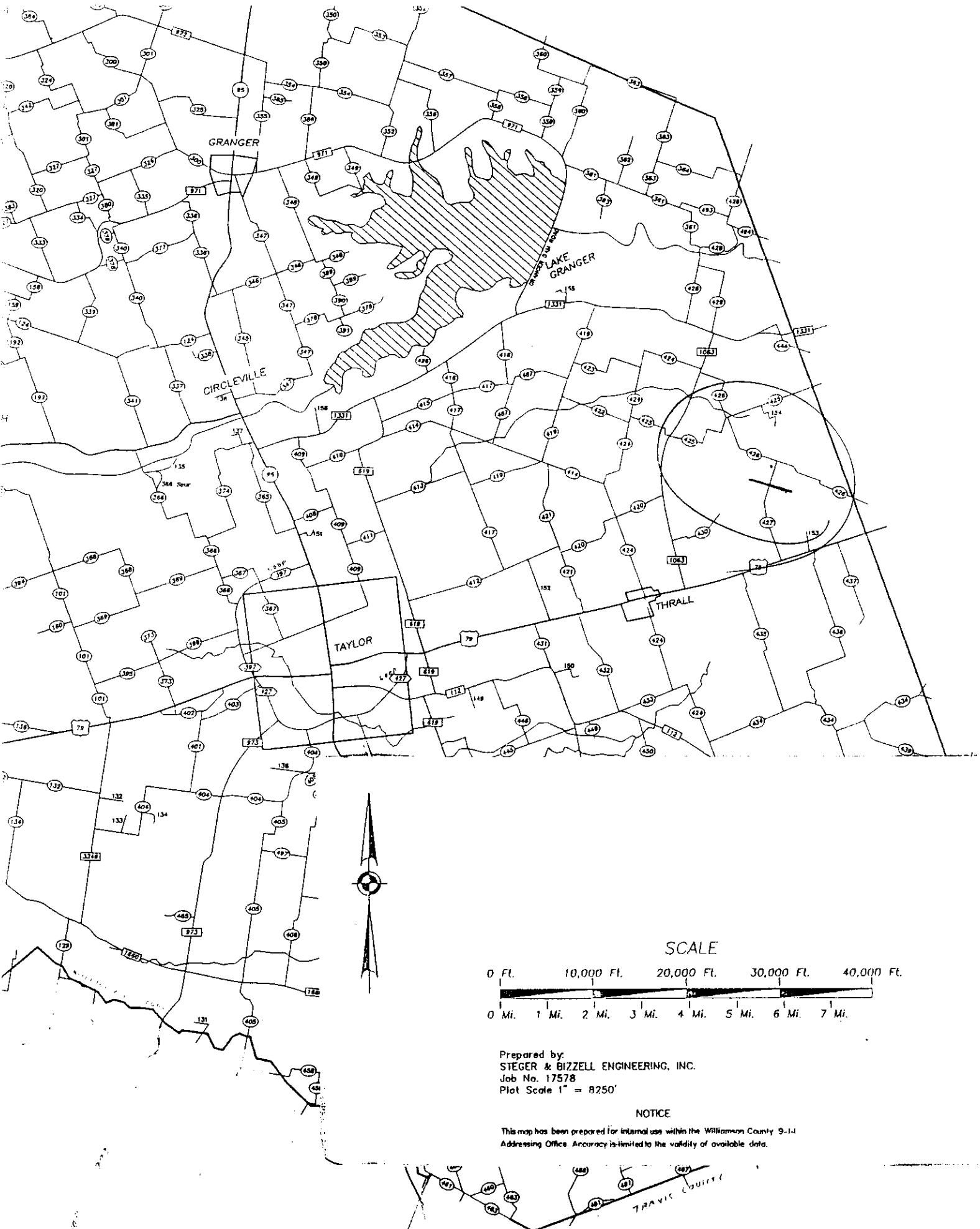

RECORDERS MEMORANDUM
All or parts of the text on this page was not clearly legible for satisfactory recordation.

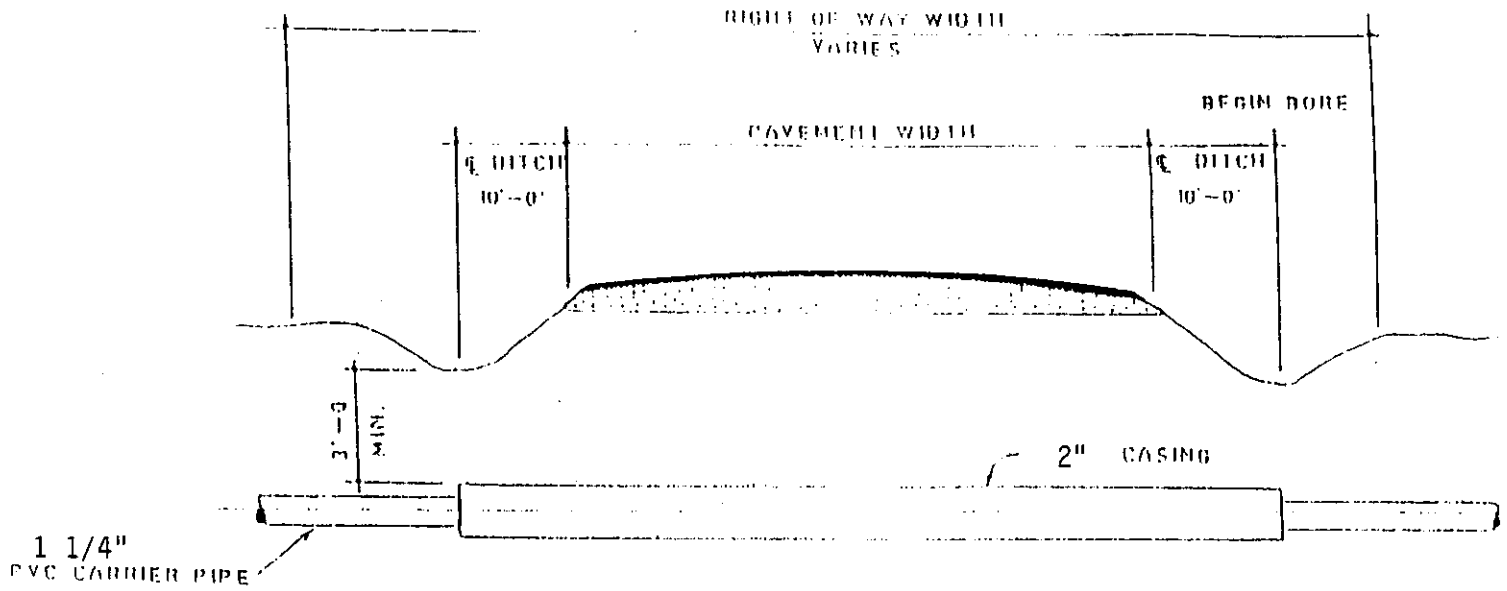

PIPE BORE AND CASING DETAIL

RECORDERS MEMORANDUM
 All or parts of the text on this page was not
 clearly legible for satisfactory recordation.

NOTICE OF PROPOSED INSTALLATION

UTILITY LINE ON WILLIAMSON COUNTY RIGHT-OF-WAY

TO: Williamson County Unified Road System
1900 Georgetown Inner Loop, Suite B
Georgetown, Texas 78626

DATE: 6-4-98

Formal notice is hereby given that SONAH WATER SPECIAL UTILITY DISTRICT
Company proposes to place a 4" WATER LINE (ROAD BORE - 6" Encasement Pipe)
line within the right-of-way of County Road 100
as follows: (give location, length, general design, etc.)

See ATTACHED SHEET

The line will be constructed and maintained on the road right-of-way as directed by the Williamson County Unified Road System in accordance with governing laws.

Our firm further understands that the County considers proper traffic control measures as those complying with applicable portions of the Texas Manual of Traffic Control Devices required for adoption by the "Transportation Code" (V.C.T.A. CH.251)

The location and description of the proposed line and appurtenances is more fully shown by 1 copies of drawings attached to this notice.

Construction of this line is proposed to begin on or after the 9th day of JUNE 1998.

APPROVAL

This application is hereby approved subject to the following understandings and restrictions.

It is expressly understood that the said County Commissioners' Court does not imply hereby to grant any right, claim, title or easement in or upon this County Road; and it is further understood that in the future, should Williamson County, for any reason, need to work, improve, relocate, widen, increase, add to, decrease, or in any manner change the structure of this road or right-of-way, this line, if affected, will be moved at the direction of the Williamson County Engineer or County Commissioner. This installation work shall not damage any part of the roadway and adequate provisions shall be made to cause a minimum of inconvenience to traffic and adjacent property owners.

APPROVED BY WILLIAMSON COUNTY COMMISSIONERS' COURT

BY: [Signature]
COUNTY ROAD ADMINISTRATOR

DATE: 6/9/98

Firm: SONAH WATER S.U.D.

By: KEN HALL

(Print Name) Asst. Manager

Title: 40 C.R. 126

Address: Georgetown Tx. 78626

Phone: (512) 863-2235

Fax: (512) 869-5402

Pct. 3

6-8-98

Bore

R.J.

102

received
6-4-98

CONTRACTOR'S LIABILITY AGREEMENT

I, KEN HALL, Contractor for JONAH WATER S.U.D.
 in Williamson County, Texas do hereby agree to the following schedules and conditions for doing work
 within the right-of-way of County ROAD 100 which is a public
 roadway maintained by Williamson County.

1. I will contact the Williamson County Unified Road System at least 48 hours prior to start of construction.
2. All work in the right-of-way will be done between the hours of 8:30 a.m. and 4:30 p.m. on Monday through Friday only.
3. Cuts will be opened for one-half the roadway only, with flagmen on both sides of the work area, allowing one-way traffic through. This type of operation will be held to a minimum and all advance warning signs and barricades shall be as specified in the Texas Manual on Uniform Traffic Control Devices. These cuts will also be filled and entire roadway opened at night and on weekends.
4. Roadside work in ditches alongside the trenched surface may be left opened at night, only if they can be barricaded solidly between open ditch and traveled roadway leaving a minimum 6' of road shoulder between the pavement edge and the barricades. The barricades must be reflectorized and lighted with warning lights and conform to the requirements of the T.M.U.T.C.D. for nighttime use.
5. Any construction area to be maintained from dusk to dawn shall have Type B High Intensity Steady Burn Warning Lights to delineate the traveled way through and around obstructions in a construction or maintenance area. All warning lights shall be installed to a minimum mounting height of 36" to the bottom of the lense.
6. Construction work and road repair on County right-of-way will be done to Williamson County Standards and to the approval of the Williamson County Unified Road System.
7. I will notify the Williamson County Unified Road System and obtain approval prior to any changes from this agreement if required due to soil conditions or other problems.

6-4-98

DATE

Williamson County Unified Road System
 1900 Georgetown Inner Loop, Ste. B
 Georgetown, Texas 78626

Ken HALL

SIGNED

JONAH WATER S.U.D.

CONTRACTOR (PRINT NAME)

40 C.R. 126

ADDRESS

Georgetown TX. 78626

CITY, STATE, ZIP CODE

(512) 863-2235

PHONE

39

1583

F.V.

- C.R. 130 -

6" VALVE CAPPED

1886 F.H.

6"

F.V.

CROSS
COUNTRY
ESTATES

- C.R. 100 -

Proposed
ROAD

- C.R. 100 -

104

NOTICE OF PROPOSED INSTALLATION

UTILITY LINE ON WILLIAMSON COUNTY RIGHT-OF-WAY

TO: Williamson County Unified Road System
1900 Georgetown Inner Loop, Suite B
Georgetown, Texas 78626

DATE:

6-17-98

Formal notice is hereby given that

SONAH WATER SPECIAL UTILITY DISTRICT

Company proposes to place a

2" WATER MAIN (4" Encasement Pipe)

line within the right-of-way of

County Road 394

as follows: (give location, length, general design, etc.)

See ATTACHED MAP

The line will be constructed and maintained on the road right-of-way as directed by the Williamson County Unified Road System in accordance with governing laws.

Our firm further understands that the County considers proper traffic control measures as those complying with applicable portions of the Texas Manual of Traffic Control Devices required for adoption by the "Transportation Code" (V.C.T.A. CH.251)

The location and description of the proposed line and appurtenances is more fully shown by 1 copies of drawings attached to this notice.

Construction of this line is proposed to begin on or after the 22 day of JUNE 1998.

APPROVAL

This application is hereby approved subject to the following understandings and restrictions.

It is expressly understood that the said County Commissioners' Court does not imply hereby to grant any right, claim, title or easement in or upon this County Road; and it is further understood that in the future, should Williamson County, for any reason, need to work, improve, relocate, widen, increase, add to, decrease, or in any manner change the structure of this road or right-of-way, this line, if affected, will be moved at the direction of the Williamson County Engineer or County Commissioner. This installation work shall not damage any part of the roadway and adequate provisions shall be made to cause a minimum of inconvenience to traffic and adjacent property owners.

APPROVED BY WILLIAMSON COUNTY COMMISSIONERS' COURT

BY:

COUNTY ROAD ADMINISTRATOR

DATE:

6/22/98

Firm:

SONAH WATER S.U.D.

By:

KEN HALL

(Print Name)

Title:

ASST. Manager

Address:

40 CR 126

Georgetown TX. 78626

Phone:

(512) 863-2235

Fax:

(512) 869-5402

Pg. 4

6-18-98

Bene
d.g.

received

6-17-98

105

CONTRACTOR'S LIABILITY AGREEMENT

I, KEN HALL, Contractor for SONAH WATER S.U.D.
in Williamson County, Texas do hereby agree to the following schedules and conditions for doing work
within the right-of-way of County ROAD 394 which is a public
roadway maintained by Williamson County.

1. I will contact the Williamson County Unified Road System at least 48 hours prior to start of construction.
2. All work in the right-of-way will be done between the hours of 8:30 a.m. and 4:30 p.m. on Monday through Friday only.
3. Cuts will be opened for one-half the roadway only, with flagmen on both sides of the work area, allowing one-way traffic through. This type of operation will be held to a minimum and all advance warning signs and barricades shall be as specified in the Texas Manual on Uniform Traffic Control Devices. These cuts will also be filled and entire roadway opened at night and on weekends.
4. Roadside work in ditches alongside the trenched surface may be left opened at night, only if they can be barricaded solidly between open ditch and traveled roadway leaving a minimum 6' of road shoulder between the pavement edge and the barricades. The barricades must be reflectorized and lighted with warning lights and conform to the requirements of the T.M.U.T.C.D. for nighttime use.
5. Any construction area to be maintained from dusk to dawn shall have Type B High Intensity Steady Burn Warning Lights to delineate the traveled way through and around obstructions in a construction or maintenance area. All warning lights shall be installed to a minimum mounting height of 36" to the bottom of the lense.
6. Construction work and road repair on County right-of-way will be done to Williamson County Standards and to the approval of the Williamson County Unified Road System.
7. I will notify the Williamson County Unified Road System and obtain approval prior to any changes from this agreement if required due to soil conditions or other problems.

6-17-98

DATE

Williamson County Unified Road System
1900 Georgetown Inner Loop, Ste. B
Georgetown, Texas 78626

KEN HALL

SIGNED

SONAH WATER S.U.D.

CONTRACTOR (PRINT NAME)

40 C.R. 126

ADDRESS

Georgetown Tx. 78626

CITY, STATE, ZIP CODE

(512) 863-2235

PHONE

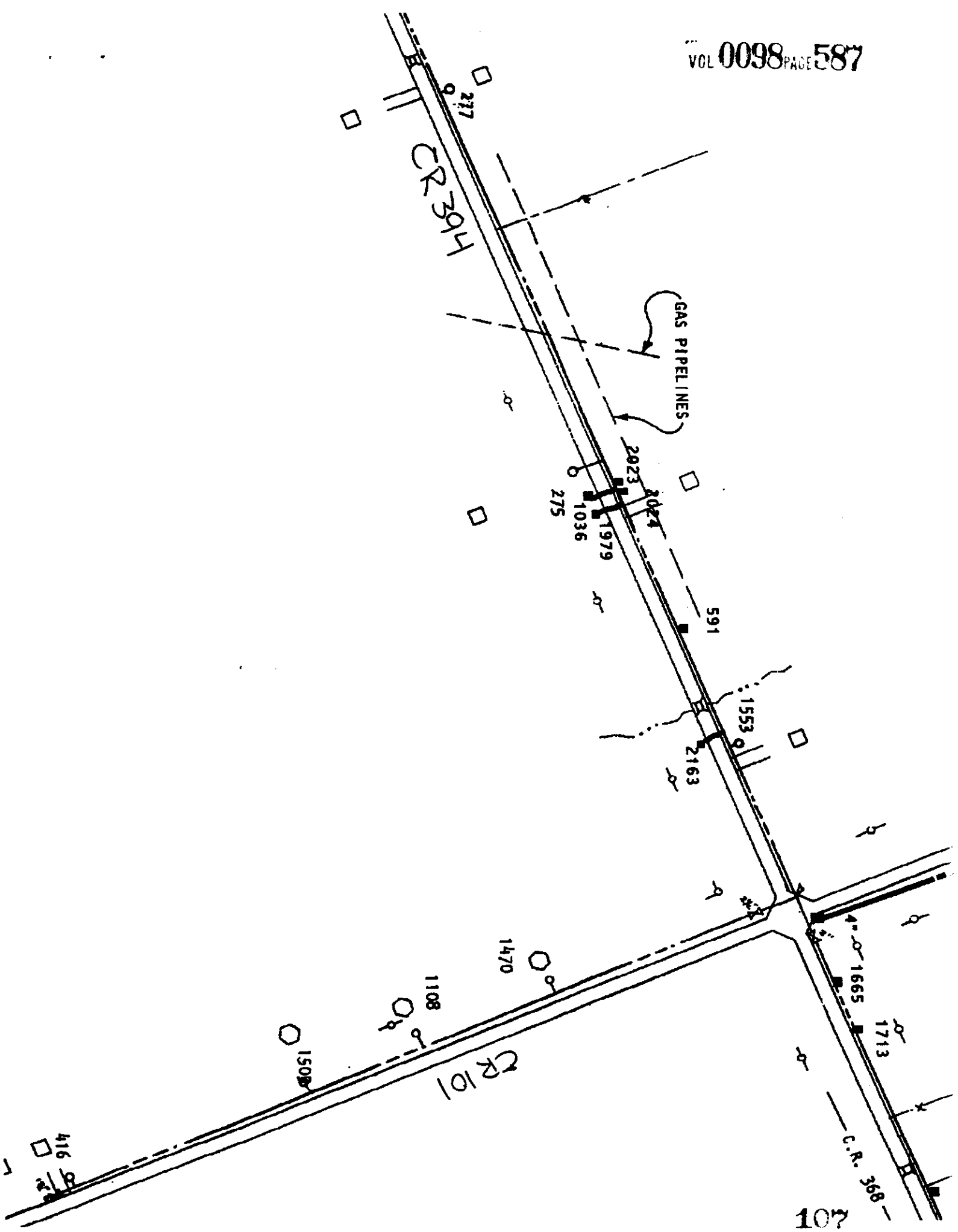

NOTICE OF PROPOSED INSTALLATION

UTILITY LINE ON WILLIAMSON COUNTY RIGHT-OF-WAY

TO: Williamson County Unified Road System
1900 Georgetown Inner Loop, Suite B
Georgetown, Texas 78626

DATE: 6-17-98

Formal notice is hereby given that JONAH WATER SPECIAL UTILITY DISTRICT
Company proposes to place a 2" WATER LINE (4" Encasement Pipe)
line within the right-of-way of County Road 394
as follows: (give location, length, general design, etc.)
See ATTACHED SHEET

The line will be constructed and maintained on the road right-of-way as directed by the Williamson County Unified Road System in accordance with governing laws.

Our firm further understands that the County considers proper traffic control measures as those complying with applicable portions of the Texas Manual of Traffic Control Devices required for adoption by the "Transportation Code" (V.C.T.A. CH.251)

The location and description of the proposed line and appurtenances is more fully shown by 1 copies of drawings attached to this notice.

Construction of this line is proposed to begin on or after the 22 day of JUNE 1998.

APPROVAL

This application is hereby approved subject to the following understandings and restrictions.

It is expressly understood that the said County Commissioners' Court does not imply hereby to grant any right, claim, title or easement in or upon this County Road; and it is further understood that in the future, should Williamson County, for any reason, need to work, improve, relocate, widen, increase, add to, decrease, or in any manner change the structure of this road or right-of-way, this line, if affected, will be moved at the direction of the Williamson County Engineer or County Commissioner. This installation work shall not damage any part of the roadway and adequate provisions shall be made to cause a minimum of inconvenience to traffic and adjacent property owners.

APPROVED BY WILLIAMSON COUNTY COMMISSIONERS' COURT

BY: My Bergen
COUNTY ROAD ADMINISTRATOR

DATE: 6/22/98

Firm: JONAH WATER S.U.D.
By: KEN HALL
(Print Name)
Title: ASST. Manager
Address: 40 C.R. 126
Georgetown Tx. 78626
Phone: (512) 863-2235
Fax: (512) 869-5402
Pct. 4

6-18-98

Bone
received
6-17-98

108

CONTRACTOR'S LIABILITY AGREEMENT

I, KEN HALL, Contractor for SONAH WATER S.U.D.
 in Williamson County, Texas do hereby agree to the following schedules and conditions for doing work
 within the right-of-way of County ROAD 394 which is a public
 roadway maintained by Williamson County.

1. I will contact the Williamson County Unified Road System at least 48 hours prior to start of construction.
2. All work in the right-of-way will be done between the hours of 8:30 a.m. and 4:30 p.m. on Monday through Friday only.
3. Cuts will be opened for one-half the roadway only, with flagmen on both sides of the work area, allowing one-way traffic through. This type of operation will be held to a minimum and all advance warning signs and barricades shall be as specified in the Texas Manual on Uniform Traffic Control Devices. These cuts will also be filled and entire roadway opened at night and on weekends.
4. Roadside work in ditches alongside the trenched surface may be left opened at night, only if they can be barricaded solidly between open ditch and traveled roadway leaving a minimum 6' of road shoulder between the pavement edge and the barricades. The barricades must be reflectorized and lighted with warning lights and conform to the requirements of the T.M.U.T.C.D. for nighttime use.
5. Any construction area to be maintained from dusk to dawn shall have Type B High Intensity Steady Burn Warning Lights to delineate the traveled way through and around obstructions in a construction or maintenance area. All warning lights shall be installed to a minimum mounting height of 36" to the bottom of the lense.
6. Construction work and road repair on County right-of-way will be done to Williamson County Standards and to the approval of the Williamson County Unified Road System.
7. I will notify the Williamson County Unified Road System and obtain approval prior to any changes from this agreement if required due to soil conditions or other problems.

6-17-98

DATE

Williamson County Unified Road System
 1900 Georgetown Inner Loop, Ste. B
 Georgetown, Texas 78626

KEN HALL

SIGNED

SONAH WATER S.U.D.
 CONTRACTOR (PRINT NAME)

40 C.R. 126
 ADDRESS

Georgetown Tx. 78626
 CITY, STATE, ZIP CODE

(512) 863-2235
 PHONE

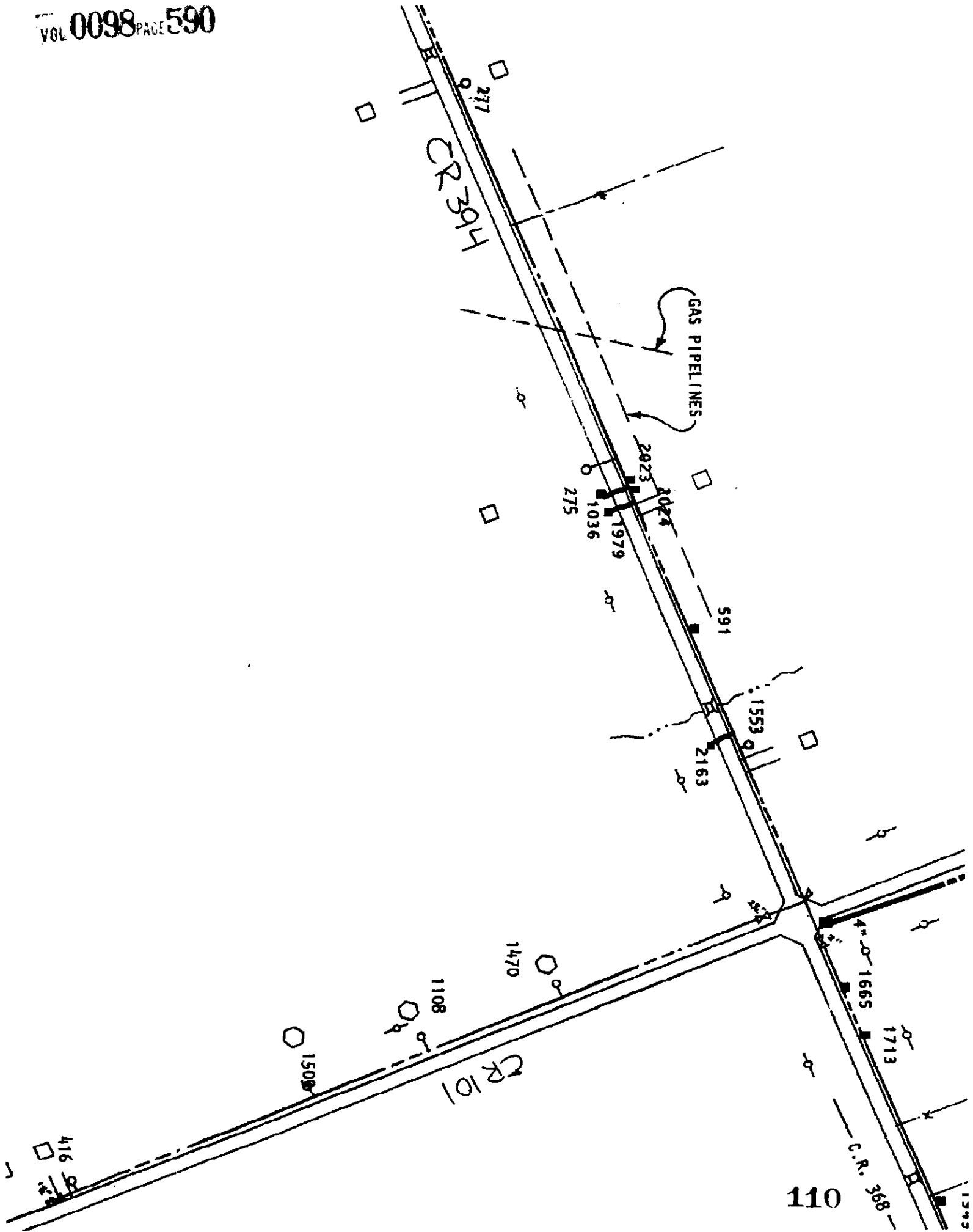

AGENDA ITEM # 5**June 23, 1998**Consider granting preliminary plat approval of Heritage Oaks.

Joe England stated the City of Austin has approved this plat. The only way in and out of subdivision is through a culdesac.

Commissioner Heiligenstein requested Joe England to talk with the City of Austin to see if there is any other access available to the property.

Moved: Commissioner Boatright

Seconded: Commissioner Mehevec

Motion: To table granting preliminary plat approval of Heritage Oaks until June 30, 1998.

Vote: Motion carried 4 - 0 with Commissioner Hays absent from the dais

AGENDA ITEM # 6**June 23, 1998**Consider authorizing advertising and setting date for public hearing, B.R.T. & W. subdivision (Amendment of lots 78a, 78b, 79b, & 80a Logan Ranch)

Joe England stated this is in the Georgetown ETJ. Mr. England questioned whether we needed to hold a public hearing. First Assistant County Attorney Dale Rye stated we did, if no one else was holding one.

Moved: Judge Doerfler

Seconded: Commissioner Boatright

Motion: To authorize Steger & Bizzell to advertise July 21, 1998 at 10:00 A.M. for public hearing of Amendment to Lots 78a, 78b, 79b & 80a Logan Ranch being B.R.T. & W. Subdivision.

Vote: Motion carried 4 - 0 with Commissioner Hays absent from the dais

Moved: Judge Doerfler

Seconded: Commissioner Boatright

Motion: To authorize Steger & Bizzell to advertise July 28, 1998 at 10:00 A.M. instead of July 21, for public hearing of Amendment to Lots 78a, 78b, 79b, & 80a Logan Ranch being B.R.T. & W. Subdivision.

Vote: Motion carried 4 - 0 with Commissioner Heiligenstein absent from the dais

AGENDA ITEM # 7**June 23, 1998**Consider granting plat approval of revised preliminary Stone Canyon, Sec. 6-C, 7 and 8.

Joe England stated this is in the Round Rock ETJ, and has not been approved by the city. He stated concern with the street Magic Mountain being a long street and the possibility of fast speeds. An acceptable solution was presented to the court. He requested the court to approve and it would be shown on the final plat.

Commissioner Heiligenstein questioned Wyoming Springs Dr. and the plan for securing the right-of-way for arterial two.

Moved: Commissioner Heiligenstein

Seconded: Commissioner Mehevec

Motion: To table preliminary plat approval of Stone Canyon, Sections 6-C, 7 and 8, Revised until Commissioner Hays can give a recommendation on Wyoming Springs Dr.

Vote: Motion carried 4 - 0 with Commissioner Hays absent from the dais

AGENDA ITEM # 8**June 23, 1998**Consider approving dedication of portion of Innerloop Road to City of Georgetown.

Moved: Commissioner Mehevec

Seconded: Judge Doerfler

Motion: To approve dedication of portion of Innerloop Road to City of Georgetown.

Vote: Motion carried 4 - 0 with Commissioner Hays absent from the dais **111**
< Clerk copy here >