

AGENDA:

MINUTES

*

*

of the

WILLIAMSON COUNTY COMMISSIONERS COURT MEETING

SEPTEMBER 8, 1998

THE STATE OF TEXAS) (

COUNTY OF WILLIAMSON) (BE IT REMEMBERED that at 9:30 a.m. on this the 8th day of September A.D., 1998, there was begun and holden a REGULAR SESSION of the Commissioners Court of Williamson County, Texas, the following members being present, to-wit:

JOHN C. DOERFLER, County Judge
MICHAEL L. HEILIGENSTEIN, Commissioner, Precinct 1
GREGORY W. BOATRIGHT, Commissioner, Precinct 2
DAVID S. HAYS, Commissioner, Precinct 3
JERRY L. MEHEVEC, Commissioner, Precinct 4
EUGENE D. TAYLOR, County Attorney
NANCY E. RISTER, County Clerk
DAVID U. FLORES, County Auditor

AGENDA ITEM # 1

September 8, 1998

*

Hear any interested person and consider forming the next agenda or adding items to today's agenda.

No one addressed the court under this agenda item.

AGENDA ITEM # 2

September 8, 1998

*

Read and approve the minutes of the last meeting.

Moved: Commissioner Mehevec

Seconded: Judge Doerfler

Motion: To approve the minutes of the meeting of September 1, 1998.

Vote: Motion carried 5 - 0

AGENDA ITEM # 3

September 8, 1998

*

Hear County Auditor concerning invoices and bills submitted for payment and take appropriate action including, but not limited to approval for payment provided said items are found by the County Auditor to be legal obligations of the County.

Moved: Commissioner Mehevec

Seconded: Judge Doerfler

Motion: To authorize the payment of \$ 676,923.22 in computer print-out from the proper line items, if found by the County Auditor to be legal expenses as appropriated in the 1997/98 County Budget.

Vote: Motion carried 5 - 0

< Clerk copy here >

VOL 0099 PAGE 803

Vendor..... Invoice Id Inv Date Account Number Expense Amount Description.....

208

ALAMO TITLE COMPANY	279619	09/03/98	100-208-5000	\$ 33.79	SEP 3, REISSUE REFUND CHECK, TAX A/C
TEXAS PARKS & WILDLIFE	279321	08/20/98	100-208-6000	88.19	CA#98-1571933, FINE COLLECTED, JP#3
TEXAS PARKS & WILDLIFE	279322	08/13/98	100-208-6000	42.50	CA#98-1614733, FINE COLLECTED, JP#3
TEXAS PARKS & WILDLIFE	279323	08/17/98	100-208-6000	60.14	CA#98-1683033, FINE COLLECTED, JP#3
TEXAS PARKS & WILDLIFE	279324	08/14/98	100-208-6000	60.14	CA#98-1692633, FINE COLLECTED, JP#3
TEXAS PARKS & WILDLIFE	279601	08/28/98	100-208-6000	60.14	CA#98-1668933, FINE COLLECTED, JP#3
Total 208				\$ 344.90	

341

TRAVIS CO SHERIFF'S DEPT	279461	08/24/98	100-341-7000	\$ 40.00	CA#98-001-T277, SHF FEE, CITY OF TAYLOR VS B
HARRIS COUNTY SHERIFF	279462	08/24/98	100-341-7000	50.00	CA#98-348-T26, SHF FEE, TISD VS A.B., D/CLK
HARRIS COUNTY SHERIFF	279463	08/24/98	100-341-7000	95.00	CA#98-008-T26, SHF FEE, WMSON CO VS S.V., D/
Total 341				\$ 185.00	

400-CO JUDGE

BESTLINE COMMUNICATIONS	279639	08/31/98	100-400-4211	\$ 15.46	PUG 98, A#6705, CO JUDGE
CANON U.S.A., INC.	279468	08/14/98	100-400-4500	195.69	INV NR085433, PO 33405, JUL 98, C/JUDGE
Total 400-CO JUDGE				\$ 211.15	

402-HUMAN RESOURCES

KILLEEN DAILY HERALD	279589	07/25/98	100-402-4310	\$ 20.00	INV 30207678, JUL 26, BUILDING, HUM RES
TEMPLE DAILY TELEGRAM	279590	08/09/98	100-402-4310	36.54	INV 10080451, A#12465967, AUG 9, SECRETARY,
KILLEEN DAILY HERALD	279591	08/17/98	100-402-4310	20.00	INV 60033249, AUG 17, ASSISTANT, HUM RES
KILLEEN DAILY HERALD	279592	07/19/98	100-402-4310	25.50	INV 30197874, JUL 19, ROAD & B,K HUM RES
TEMPLE DAILY TELEGRAM	279593	07/25/98	100-402-4310	40.02	INV 10073667, A#12465967, BUILDING, HUM RES
TEMPLE DAILY TELEGRAM	279594	07/25/98	100-402-4310	34.80	INV 10073561, A#12465967, TIRE SERVICE, HUM
TAYLOR DAILY PRESS	279600	07/17/98	100-402-4310	26.40	INV B1070080, A#A104288, JUL 17, ROAD & BRID
dba ROUND ROCK LEADER	279605	08/17/98	100-402-4310	14.70	INV 02501025, A#01100030, ASSISTANT TREAS, H
Total 402-HUMAN RESOURCES				\$ 217.96	

403-CO CLERK

NANCY RISTER	279387	08/19/98	100-403-3100	\$ 14.95	AUG 14-18, EXP REIMB, C/CLK
ROBERTS PRINTING CO., INC	279532	08/13/98	100-403-3100	192.50	INV 3753, PO 39188, STAMP NEW DIES/STMP PADS
GTE SOUTHWEST	279643	08/22/98	100-403-4211	265.47	PUG 98, 930-4312, CO CLK
POSTMASTER	279498	08/31/98	100-403-4212	100.00	PO 39899, 2 DOLLAR STAMPS, C/CLK
NANCY RISTER	279387	08/19/98	100-403-4231	116.35	PUG 14-18, EXP REIMB, C/CLK
NANCY RISTER	279387	08/19/98	100-403-4232	34.47	PUG 14-18, EXP REIMB, C/CLK
CANON U.S.A., INC.	279467	08/14/98	100-403-4500	120.00	INV NR085440, PO 34898, JUL 98, C/CLK
CANON U.S.A., INC.	279470	08/14/98	100-403-4500	183.93	INV NR085435, PO 34897, JUL 98, D/CLK
Total 403-CO CLERK				\$ 1,027.67	

409-NON DEPT

GTE WIRELESS	279631	08/25/98	100-409-4211	\$ 209.26	AUG 98, 008-2723, GAME WARDEN
WILLIAMSON CO SUN, INC.	279538	08/06/98	100-409-4310	65.80	AUG 9, NOTICE OF BUDGET HEARING
TAYLOR DAILY PRESS	279541	08/11/98	100-409-4310	55.00	INV B1072690, A#A102741, WMSON CO BUDGET

VOL 0099 PAGE 804

Vendor.....	Invoice Id	Inv Date	Account Number	Expense Amount	Description.....
TAYLOR DAILY PRESS	279587	07/31/98	100-409-4310	45.10	INV A5313300, A#A106981, JUL 27, BUDGET HEAR
WILLIAMSON CO APPRAISAL DISTRI	279586	08/14/98	100-409-4711	96,687.00	1998 4TH QTR BUDGET ALLOCATION
dba ROUND ROCK OFFICE MACHINES	279454	08/13/98	100-409-4992	166.36	INV 1303, PO 39584, THR CRTDG/SVC COPIER, PO
TEXAS CORRECTIONAL INDUSTRIES	279623	07/28/98	100-409-4999	1,050.00	INV 40653, PO 38629, PICNIC TABLES, CEDAR PA
DELL COMPUTER CORP.	279529	08/17/98	100-409-5000	3,290.00	INV 175815752, PO 39563, COMPUTER SYSTEM
Total 409-NON DEPT				\$ 101,568.52	
427-CO CT AT LAW #2					
WAL-MART #1303 (GEORGETOWN)	278758	08/17/98	100-427-3100	\$ 27.40	INV 6402651, AUDIO TAPES, CC#2
Total 427-CO CT AT LAW #2				\$ 27.40	
435-DIST COURTS					
MINOLTA CORPORATION	279338	08/18/98	100-435-4500	\$ 319.26	INV 8081880439, PO 38823, JUL 98, 368TH DIST
Total 435-DIST COURTS				\$ 319.26	
436-26TH JUD DIST CT					
PETERSON & PETERSON	279159	08/20/98	100-436-4130	\$ 200.00	CA#95-1169-F26, R.& A. AGUILAR, 26TH DIST CT
CHRISTOPHER STANLEY	279165	08/19/98	100-436-4130	600.00	CA#97-435-F26, WEATHERS CHILDREN, 26TH DIST
Total 436-26TH JUD DIST CT				\$ 800.00	
437-277TH JUD DIST CT					
MICHAEL JERGINS	279160	08/20/98	100-437-4130	\$ 350.00	CA#98-050-J368, B.M.S., 368TH DIST CT
MICHAEL JERGINS	279161	08/20/98	100-437-4130	350.00	CA#97-223-J368, J.W.M., 368TH DIST CT
LACEY A. NULLOWNEY	279162	08/20/98	100-437-4130	350.00	CA#98-422-K277, REYNALDO GARZA, 277TH DIST C
LACEY A. NULLOWNEY	279163	08/10/98	100-437-4130	350.00	CA#98-566-K277, REYNALDO GARZA, 277TH DIST C
RUSSELL D. HUNT, JR.	279164	08/20/98	100-437-4130	350.00	CA#98-285-K277, LEROY WILSON, 277TH DIST CT
Total 437-277TH JUD DIST CT				\$ 1,750.00	
438-368TH JUD DIST CT					
MICHAEL B. WALKER	279155	08/24/98	100-438-4130	\$ 1,050.00	CA#98-160-K368, MARION LEON TOW, 368TH DIST
EVA EAKIN, ATTORNEY AT LAW	279156	08/24/98	100-438-4130	425.00	CA#98-046-K368, CLIFTON RAY HARRIS, 368TH DI
PETER L. BLOODWORTH	279157	08/24/98	100-438-4130	75.00	CA#98-498-K368, GARY SMITH, 368TH DIST CT
BETSY F. LAMBETH	279158	08/19/98	100-438-4130	3,500.00	CA#96-542-K368, GARY EVAN PERDUE, 368TH DIST
JANICE C. MCKENNON	279167	08/19/98	100-438-4130	300.00	CA#95-1190-F368, J.A., 368TH DIST CT
WAL-MART #1303 (GEORGETOWN)	279079	11/01/96	100-438-4235	175.36	INV 2252346, PO 30354, AUDIO TAPES, 368TH DI
Total 438-368TH JUD DIST CT				\$ 5,525.36	
440-DIST ATTY					
WAL-MART #1303 (GEORGETOWN)	279525	06/29/98	100-440-3100	\$ 108.61	INV 5513492, VIDEOS/POST-ITS/SPIRALS, D/ATTY
HERITAGE PRINTING, INC.	279622	07/15/98	100-440-3100	305.72	JUL 15, PO 39104, FAX FARTRIDGE/FASTENERS, D
GTE SOUTHWEST	279565	08/22/98	100-440-4211	30.31	AUG 98, 930-3158, D/ATTY
BESTLINE COMMUNICATIONS	279567	08/31/98	100-440-4211	227.25	AUG 98, A#6754, D/ATTY
TRAVEL 'N TOURS	279543	08/14/98	100-440-4236	1,100.00	INV 047595, D.DUTTON, D/ATTY
FGB, INC.	279421	08/21/98	100-440-4544	325.00	INV 231, PO 39316, REPAIR MONITOR/REPLC FLYB
TEXAS DIST & CO	279524	09/01/98	100-440-4999	30.00	SEP 98-99, CHRIS HERNDON, D/ATTYU
MINOLTA CORPORATION	279339	08/18/98	100-440-5750	319.26	INV 8081880354, PO 35056, JUL 98, D/ATTY

VOL 0099 PAGE 805

Vendor.....	Invoice Id	Inv Date	Account Number	Expense Amount	Description.....
Total 440-DIST ATTY				\$ 2,446.15	
450-DIST CLERK					
BONNIE WOLBRUECK	279360	08/24/98	100-450-4231	\$ 167.43	JUL 23-AUG 18, EXP REIMB, D/CLK
BONNIE WOLBRUECK	279360	08/24/98	100-450-4232	45.15	JUL 23-AUG 18, EXP REIMB, D/CLK
MELBA KEMBLE	279361	08/07/98	100-450-4232	18.20	AUG 7, EXP REIMB, D/CLK
THE SOFTWARE GROUP, INC.	279477	08/21/98	100-450-4350	1,490.24	INV 19509, PO 39595, JURY SUMMONS CARDS, D/C
MINOLTA CORPORATION	279342	08/18/98	100-450-4500	382.87	INV 8081880353, PO 35355, JUL 98, D/CLK
IKON OFFICE SOLUTIONS	279585	08/18/98	100-450-4500	630.00	INV 097310, A#W40837, AUG 98-99, D/CLK
U.S. OFFICE PRODUCTS	279478	08/21/98	100-450-5750	112.42	INV 607667-0, PO 39693, ELECTRIC 3-HOLE PNCH
U.S. OFFICE PRODUCTS	279479	08/21/98	100-450-5750	46.41	INV 606785-0, PO 39596, DESKTOP CALC, D/CLK
PATRIOT GROUP	279494	08/04/98	100-450-5750	3,832.92	INV 541376, PO 39332, FORMSMASER 8003/STAND
Total 450-DIST CLERK				\$ 6,725.64	
451-JP PCT #1					
MARTHA HILL BLACKMON	279382	08/24/98	100-451-4002	\$ 6.00	AUG 24, JUROR FEE, JP#1
DELORES RIETHMEYER NAIVAR	279385	08/24/98	100-451-4002	6.00	AUG 24, JUROR FEE, JP#1
EDWARD FRIAS	279386	08/24/98	100-451-4002	10.00	AUG 24, JUROR FEE, JP#1
TERESA TURNER EDWARDS	279388	08/24/98	100-451-4002	6.00	AUG 24, JUROR FEE, JP#1
LONNIE A. URBAN	279389	08/24/98	100-451-4002	10.00	AUG 24, JUROR FEE, JP#1
MICHAEL BRUCE CHRISTIAN	279390	08/24/98	100-451-4002	6.00	AUG 24, JUROR FEE, JP#1
ROBERT LAWRENCE KOSTA	279391	08/24/98	100-451-4002	6.00	AUG 24, JUROR FEE, JP#1
LITA HERNANDEZ KIPLIN	279392	08/24/98	100-451-4002	10.00	AUG 24, JUROR FEE, JP#1
JOHN HAROLD CHILDRESS	279393	08/24/98	100-451-4002	10.00	AUG 24, JUROR FEE, JP#1
HAROLD IRA JARMON	279395	08/24/98	100-451-4002	6.00	AUG 24, JUROR FEE, JP#1
ROBERT JOHN MROSKI	279398	08/24/98	100-451-4002	10.00	AUG 24, JUROR FEE, JP#1
LINDA ROBICHAU ALLEN	279399	08/24/98	100-451-4002	6.00	AUG 24, JUROR FEE, JP#1
CYNTHIA ANN VOHIKEN	279400	08/24/98	100-451-4002	10.00	AUG 24, JUROR FEE, JP#1
RICHARD TODD WOLFE	279401	08/24/98	100-451-4002	6.00	AUG 24, JUROR FEE, JP#1
DAVID GARY JOHNSON	279402	08/24/98	100-451-4002	6.00	AUG 24, JUROR FEE, JP#1
JESUS ALBERT GUTIERREZ	279403	08/24/98	100-451-4002	6.00	AUG 24, JUROR FEE, JP#1
PEGGY IRENE ALMQUIST	279404	08/24/98	100-451-4002	6.00	AUG 24, JUROR FEE, JP#1
ALICE MATETZSCHK	279405	08/24/98	100-451-4002	10.00	AUG 24, JUROR FEE, JP#1
WILMA SHIRLEY STULL	279406	08/24/98	100-451-4002	10.00	AUG 24, JUROR FEE, JP#1
ARNOLD DANIEL REED	279407	08/24/98	100-451-4002	6.00	AUG 24, JUROR FEE, JP#1
KEVIN D. OLIVER	279408	08/24/98	100-451-4002	6.00	AUG 24, JUROR FEE, JP#1
ROBERT LOUIS KILLINGSWORTH	279409	08/24/98	100-451-4002	10.00	AUG 24, JUROR FEE, JP#1
IRENE HUNTER MENCHACA	279410	08/24/98	100-451-4002	6.00	AUG 24, JUROR FEE, JP#1
JANET YVONNE ARLITT	279411	08/24/98	100-451-4002	6.00	AUG 24, JUROR FEE, JP#1
DENNY RAY REEVES	279412	08/24/98	100-451-4002	6.00	AUG 24, JUROR FEE, JP#1
MARIE SANDRIA LANDIS	279413	08/24/98	100-451-4002	6.00	AUG 24, JUROR FEE, JP#1
JAN DAVID SHADDEN	279414	08/24/98	100-451-4002	10.00	AUG 24, JUROR FEE, JP#1
DAVID JOSEPH GESSLER	279415	08/24/98	100-451-4002	10.00	AUG 24, JUROR FEE, JP#1
CAROLYNN SUE PICKLE	279446	08/24/98	100-451-4002	6.00	AUG 24, JUROR FEE, JP#1
BRUCE DONALD RANDUS	279447	08/24/98	100-451-4002	6.00	AUG 24, JUROR FEE, JP#1
JUDITH MARIE GORDON	279448	08/24/98	100-451-4002	6.00	AUG 24, JUROR FEE, JP#1
MICHAEL DEEN WISE	279449	08/24/98	100-451-4002	10.00	AUG 24, JUROR FEE, JP#1
BESTLINE COMMUNICATIONS	279569	08/31/98	100-451-4211	6.57	AUG 98, A#6045, JP#1
MINOLTA CORPORATION	279343	08/18/98	100-451-4500	192.98	INV 8081880547, PO 35402, JUL 98, JP#1

VOL 0099 PAGE 806

Vendor.....	Invoice Id	Inv Date	Account Number	Expense Amount	Description.....
Total 451-JP PCT #1				\$ 439.55	
452-JP PCT #2					
AT&T	279632	08/18/98	100-452-4211	\$ 5.76	AUG 98, A#019 916 8453 001, JP#2
ALECIA A. COX	279356	08/20/98	100-452-4231	14.63	AUG 7-14, EXP REIMB, JP#2
IKON OFFICE SOLUTIONS	279211	05/27/98	100-452-4544	91.35	INV 544778, LABOR SEGMENT 2, JP#2
Total 452-JP PCT #2				\$ 111.74	
453-JP PCT #3					
BEXAR COUNTY FORENSIC SCIENCE	279457	08/19/98	100-453-4190	\$ 800.00	INV 019476, SHARON RUSS, AUTOPSY, JP#3
BECK FUNERAL HOME LTD	279458	08/07/98	100-453-4190	125.00	AUG 7, NELDA OVERALL, TRANSPORTATION, JP#3
THE GABRIELS FUNERAL CHAPEL	279614	08/24/98	100-453-4190	95.00	AUG 24, PAULINE BOATRIGHT, TRANSPORTATION, J
THE GABRIELS FUNERAL CHAPEL	279615	08/19/98	100-453-4190	95.00	AUG 19, GREGORY MORRIS FRAME, TRANSPORTATION
MINOLTA CORPORATION	279340	08/18/98	100-453-4500	244.41	INV 8081888398, JUL 98, JP#3
Total 453-JP PCT #3				\$ 1,359.41	
454-JP PCT #4					
JUDY S. HOBBS	279506	08/13/98	100-454-4211	\$ 14.45	JUL 98, PHONE REIMB, JP#4
SOUTHWESTERN BELL	279563	08/19/98	100-454-4211	85.52	AUG 98, 352-2161, JP#4
JUDY S. HOBBS	279349	08/24/98	100-454-4231	87.91	AUG 12-21, EXP REIMB, JP#4
Total 454-JP PCT #4				\$ 187.88	
475-CO ATTY					
WAL-MART #1303 (GEORGETOWN)	278904	08/05/98	100-475-3399	\$ 39.81	INV 6402831, EQUATE/PAIN RELIEVER, C/ATTY
TEXAS DIST & CO	279613	09/01/98	100-475-3900	35.00	SEP 98-99, LAVONNE M.GROSSMANN, MEMBER DUES,
LAVONNE GROSSMANN	279374	08/24/98	100-475-4211	17.28	JUL 13-17, EXP REIMB, C/ATTY
DAVID GLICKLER	279362	08/19/98	100-475-4231	26.03	JUL 28-AUG 7, EXP REIMB, C/ATTY
MARCELINO RODRIGUEZ	279363	08/03/98	100-475-4231	117.00	JUN 23-JUL 10, EXP REIMB, C/ATTY
MARCELINO RODRIGUEZ	279363	08/03/98	100-475-4232	7.80	JUN 23-JUL 10, EXP REIMB, C/ATTY
DANKA INDUSTRIES, INC.	279608	08/06/98	100-475-4500	13.86	INV 3371263, JUL 98, C/ATTY
BRIGHT & ASSOCIATES	279610	08/11/98	100-475-4932	205.81	INV 17804, COPY OF DEPOSITION, C/ATTY
BRIGHT & ASSOCIATES	279611	08/11/98	100-475-4932	112.92	INV 17801, COPY OF DEPOSITION, C/ATTY
Total 475-CO ATTY				\$ 575.51	
492-ELECTIONS					
MARY ANN GRAHAM	279364	08/20/98	100-492-4231	\$ 9.75	AUG 7, EXP REIMB, ELECTIONS
dba D & L PRINTING	279416	07/21/98	100-492-4251	190.43	INV 2204, PO 39089, VOTER REG CARDS, ELECTIO
dba D & L PRINTING	279417	08/06/98	100-492-4251	349.00	INV 2256, PO 39234, DEPUTY REG RECEIPT BOOKS
dba D & L PRINTING	279418	08/06/98	100-492-4251	163.69	INV 2296, PO 39234, ENVELOPES W/ELECTIONS LO
DANKA INDUSTRIES, INC.	279319	08/06/98	100-492-4500	38.50	INV 3371316, AUG 98, ELECTIONS
Total 492-ELECTIONS				\$ 751.37	
495-CO AUDITOR					
B T MILLER OFFICE PRODUCTS	279377	08/25/98	100-495-3100	\$ 558.62	INV 43951940, PO 39760, EXP PKTS/MISC OFFICE
TEXAS ASSOC OF CO AUDITORS	279500	08/28/98	100-495-4232	330.00	PO 39850, OCT 14-15 CONF, D.FLORES/R.SPACE,
ALAMO AREA TASBO	279653	09/04/98	100-495-4232	15.00	PO 39979, INVESTMENT TRAINING SEMINAR, D.FLO

VOL 0099 PAGE 807

Vendor.....	Invoice Id	Inv Date	Account Number	Expense Amount	Description.....
MINDLTA CORPORATION	279330	08/18/98	100-495-4500	294.40	INV 8081888397, PO 35413, JUL 98, AUDITOR
OZARKA NATURAL SPRING WATER	279376	08/16/98	100-495-4999	70.50	INV 08H0011107133, A#0011107133, AUDITOR
"SUPER COMPUTERS"	279612	06/11/98	100-495-5750	250.00	INV 1001072, 6.4 GB HARD DRIVE, AUDITOR
Total 495-CO AUDITOR				\$ 1,518.52	
497-CO TREAS					
BESTLINE COMMUNICATIONS	279649	08/31/98	100-497-4211	12.71	AUG 98, A#6708, TREAS
VIVIAN WOOD	279369	08/21/98	100-497-4231	32.50	AUG 6-7, EXP REIMB, TREAS
CANON U.S.A., INC.	279469	08/14/98	100-497-4620	120.00	INV NR085434, PO 37144, JUL 98, TREAS
"SUPER COMPUTERS"	279640	07/23/98	100-497-5750	35.00	INV 1001085, PO 39211, LABOR CHARGE, TREAS
PATRIOT GROUP	279645	08/12/98	100-497-5750	315.00	INV 541616, PO 39424, PRINT STAND, TREAS
Total 497-CO TREAS				\$ 515.21	
499-CO TAX ASSR/COLL					
SOUTHWESTERN BELL	279561	08/19/98	100-499-4211	175.02	AUG 98, 352-6932, TAX A/C
GTE SOUTHWEST	279580	08/22/98	100-499-4211	110.39	AUG 98, 930-4440, TAX A/C
BESTLINE COMMUNICATIONS	279641	08/31/98	100-499-4211	142.87	AUG 98, A#6707, TAX A/C
LESLIE A. WEST	279354	08/19/98	100-499-4231	27.30	AUG 12-19, EXP REIMB, TAX A/C
CYNTHIA OLGIN	279355	06/26/98	100-499-4231	7.15	AUG 26, EXP REIMB, TAX A/C
VALISSA SAULS	279583	07/06/98	100-499-4232	164.60	AUG 22, EXP REIMB, TAX A/C
IKON OFFICE SOLUTIONS	279534	08/19/98	100-499-4500	10.13	INV 097716, A#W4D137, BASE RATE, TAX A/C
Total 499-CO TAX ASSR/COLL				\$ 637.46	
503-INFORMATION SYSTEMS					
ALTEX ELECTRONICS	279505	08/17/98	100-503-3115	19.95	INV 0821906, PO 39713, ADAPTER, IS
GTE SOUTHWEST	279562	08/22/98	100-503-4210	84.37	AUG 98, IDH-8011, IS
BESTLINE COMMUNICATIONS	279582	08/31/98	100-503-4211	11.97	AUG 98, A#6714, IS
MINDLTA CORPORATION	279331	07/31/98	100-503-4500	81.60	INV 8081888580, PO 38621, JUL 98, IS
LASER IMPACT	279456	08/21/98	100-503-4544	245.00	INV 559155, PO 39304, LASER PRINTER, IS
dba MTI	279501	08/27/98	100-503-4544	1,215.00	INV 808090, PO 39333, REPAIR TERMINALS/KEYBD
ALTEX ELECTRONICS	279502	08/07/98	100-503-4544	469.10	INV 0813220, PO 39439, PORT CARD/DDS3 4MM PR
SPECIALIZED PRODUCTS CO.	279504	08/24/98	100-503-4991	4.73	INV 10-758909, PO 39599, CRIMP TOOL/SCREWDR
SPECIALIZED PRODUCTS CO.	279504	08/24/98	100-503-5000	168.00	INV 10-758909, PO 39599, CRIMP TOOL/SCREWDR
Total 503-INFORMATION SYSTEMS				\$ 2,299.72	
509-WMSON CO BLDGS					
CINTAS CORPORATION	279430	08/21/98	100-509-3311	48.60	INV 086209988, UNIFORMS, MAINT
GULF COAST PAPER COMPANY	279451	08/14/98	100-509-3318	3,461.70	INV 350075, PO 39587, JANITORIAL SUPPLIES, M
GULF COAST PAPER COMPANY	279452	08/20/98	100-509-3318	79.95	INV 350452, PO 39587, URINAL BLK, MAINT
GULF COAST PAPER COMPANY	279453	08/20/98	100-509-3318	49.17	INV 350453, PO 39587, 4X6 OLEFIN PLSH TF, MA
SOUTHWESTERN BELL	279559	08/19/98	100-509-4211	64.79	AUG 98, 352-9275, MAIN
GTE WIRELESS	279564	08/28/98	100-509-4211	40.11	AUG 98, 217-1254, MAINT
Total 509-WMSON CO BLDGS				\$ 3,744.32	
510-CO CTHOUSE					
OZARKA NATURAL SPRING WATER	279510	07/16/98	100-510-4430	253.80	INV 0860012685210, A#0012685210, CTHSE
OZARKA NATURAL SPRING WATER	279511	07/14/98	100-510-4430	52.50	INV 0866300359509, A#6300359509, CTHSE

VOL 0099 PAGE 808

Vendor.....	Invoice Id	Inv Date	Account Number	Expense Amount	Description.....
CITY OF GEORGETOWN	279551	08/31/98	100-510-4430	4,180.16	AUG 98, A#06-1100-00, CTHSE
Total 510-CO CTHOUSE				\$ 4,486.46	
511-HISTORICAL SOCIETY					
CITY OF GEORGETOWN	279552	08/31/98	100-511-4430	\$ 121.21	AUG 98, A#06-0450-00, HIST SOC
CITY OF GEORGETOWN	279553	08/31/98	100-511-4430	28.35	AUG 98, A#06-0455-01, HIST SOC
Total 511-HISTORICAL SOCIETY				\$ 149.56	
513-TAYLOR OFF BLDG					
CITY OF TAYLOR	279546	08/31/98	100-513-4430	\$ 228.18	AUG 98, A#05-2170-01, TAYLOR ANNEX
BERRY HARDWARE CO	279436	08/20/98	100-513-4510	33.76	INV 2138381, PO 39268, ELASTO SEAL, TAYLOR A
Total 513-TAYLOR OFF BLDG				\$ 261.94	
515-ROUND ROCK OFF BLDG					
LONE STAR GAS CO	279492	08/21/98	100-515-4430	\$ 27.46	AUG 98, A#473-5489-99-1, RR ANNEX
BERRY HARDWARE CO	279444	08/24/98	100-515-4510	5.83	INV 2138508, PO 39268, HOUSEHOLD SPRAYER, RR
Total 515-ROUND ROCK OFF BLDG				\$ 33.29	
517-WMSON CO JAIL					
ENVIRO WASTE MANAGEMENT	279540	08/14/98	100-517-4430	\$ 190.00	INV C2113710, GREASE TRAP WASTE, JAIL
BERRY HARDWARE CO	279431	08/03/98	100-517-4510	96.96	INV 2137655, PO 39268, FILTER, SO
BERRY HARDWARE CO	279432	08/18/98	100-517-4510	28.77	INV 2138312, PO 39268, DRAIN LINE OPENER, SO
BERRY HARDWARE CO	279434	08/19/98	100-517-4510	5.04	INV 2138346, PO 39268, ANCHOR, SO
BERRY HARDWARE CO	279435	08/19/98	100-517-4510	41.20	INV 2138368, PO 39268, PLUMBING SUPPLIES, SO
BERRY HARDWARE CO	279437	08/20/98	100-517-4510	0.77	INV 2138392, PO 39268, NUTS/FERREALS, SO
BERRY HARDWARE CO	279438	08/20/98	100-517-4510	2.18	INV 2138394, PO 39268, BRASS UNION COMP, SO
BERRY HARDWARE CO	279439	08/21/98	100-517-4510	11.58	INV 2138451, PO 39268, BULBS, SO
BERRY HARDWARE CO	279440	08/21/98	100-517-4510	2.40	INV 2138434, PO 39268, SCREWS, SO
BERRY HARDWARE CO	279442	08/24/98	100-517-4510	0.99	INV 2138522, PO 39268, BOLTS/NUTS/WSHRS, SO
BERRY HARDWARE CO	279443	08/24/98	100-517-4510	10.76	INV 2138507, PO 39268, CROME WALL PLATE/SCRE
Total 517-WMSON CO JAIL				\$ 390.65	
519-LIBERTY HILL ANNEX					
LIBERTY HILL W.S.C.	279549	08/30/98	100-519-4430	\$ 20.69	AUG 98, A#268, LIB HILL ANNEX
Total 519-LIBERTY HILL ANNEX				\$ 20.69	
523-TAYLOR TAX OFFICE					
CITY OF TAYLOR	279545	08/31/98	100-523-4430	\$ 31.50	AUG 98, A#03-1940-03, TAYLOR TAX OFF
Total 523-TAYLOR TAX OFFICE				\$ 31.50	
524-JP #4 BLDG					
BRITTAIN PLUMBING	279429	08/17/98	100-524-4510	\$ 139.80	INV 17443, PO 39271, SVC CALL/LABOR, JP#4
Total 524-JP #4 BLDG				\$ 139.80	

VPL 0099 PAGE 809

Vendor.....	Invoice Id	Inv Date	Account Number	Expense Amount	Description.....
525-ADULT PROB TAYLOR					
CITY OF TAYLOR	279548	08/31/98	100-525-4430	\$ 36.50	AUG 98, A#03-1970-01, A/PROB-TAYLOR
Total 525-ADULT PROB TAYLOR				\$ 36.50	
529-EMS STATION, 305 MLK, GEO					
CITY OF GEORGETOWN	279554	08/31/98	100-529-4430	\$ 222.48	AUG 98, A#12-0305-02, EMS-GPTWN
Total 529-EMS STATION, 305 MLK, GEO				\$ 222.48	
535-EMS TAYLOR 1427 N. MAIN					
CITY OF TAYLOR	279547	08/31/98	100-535-4430	\$ 61.18	AUG 98, A#18-1070-01, EMS-TAYLOR
Total 535-EMS TAYLOR 1427 N. MAIN				\$ 61.18	
538-CENTRAL MAINT FACILITY					
OZARKA NATURAL SPRING WATER	279520	08/16/98	100-538-4430	\$ 283.50	INV 08H0013250311, A#0013250311, CENT MAIN F
OZARKA NATURAL SPRING WATER	279651	07/16/98	100-538-4430	114.45	INV 08G0013250311, A#013250311, CENT MAINT F
dba VENTANA MIRROR & GLASS	279450	08/17/98	100-538-4510	135.00	INV 82260463, PO 39628, REPAIR BAY DOOR/LABO
Total 538-CENTRAL MAINT FACILITY				\$ 532.95	
540-ENS					
WAL-MART #01-0475 (RR)	279246	07/28/98	100-540-3200	\$ 152.01	INV 6468266, PO 37020, STORAGE CONTAINERS, E
WAL-MART #01-0475 (RR)	279247	08/13/98	100-540-3200	24.84	INV 8870660, PO 39588, MAILBOXES/SUPPORTS, E
PROMEDIX	279256	08/06/98	100-540-3200	254.00	INV 1179443-03, PO 39053, BURETROL SETS, EMS
FUELMAN	279633	08/24/98	100-540-3301	397.09	INV 11081, A#2303050, AUG 17-23, EMS
FUELMAN	279634	08/31/98	100-540-3301	477.76	INV 11348, A#2303050, AUG 24-30, EMS
CHEVRON USA, INC.	279635	08/27/98	100-540-3301	305.37	AUG 98, A#789-878-046-0, EMS
EXXON CARD SERVICES	279636	08/13/98	100-540-3301	48.07	AUG 98, A#1828062446-08, EMS
SRI MONOGRAMMING, INC.	279250	05/15/98	100-540-3311	21.00	INV 5669, GOLF CAPS, EMS
MILLER UNIFORM & EMBLEMS, INC.	279251	07/30/98	100-540-3311	154.80	INV 68872, PO 39200, UNIFORMS, EMS
MILLER UNIFORM & EMBLEMS, INC.	279252	08/14/98	100-540-3311	154.80	INV 69302, PO 39200, UNIFORMS, EMS
SPECIALIZED BILLING & COLLECTI	279242	07/31/98	100-540-4101	3,467.28	INV 98-91, COLLECTIONS, EMS
SPECIALIZED BILLING & COLLECTI	279243	08/04/98	100-540-4101	2,614.54	INV 98-92, COLLECTIONS, EMS
SPECIALIZED BILLING & COLLECTI	279244	08/10/98	100-540-4101	2,986.29	INV 98-93, COLLECTIONS, EMS
SPECIALIZED BILLING & COLLECTI	279245	08/12/98	100-540-4101	1,030.55	INV 98-94, COLLECTIONS, EMS
AT&T WIRELESS SERVICES	279626	08/21/98	100-540-4211	682.56	AUG 98, A#60146602, EMS
SOUTHWESTERN BELL	279627	08/21/98	100-540-4211	116.73	AUG 98, 255-0855, EMS
AIRTOUCH PAGING (PAC TEL)	279637	09/01/98	100-540-4211	784.45	INV H4210241199809, A#H4-210241, SEP 98, EMS
BESTLINE COMMUNICATIONS	279638	08/31/98	100-540-4211	29.94	AUG 98, A#6737, EMS
SOUTHWESTERN BELL	279647	08/19/98	100-540-4211	80.56	AUG 98, 918-9878, EMS
THOMAS BRADFORD	279350	08/23/98	100-540-4232	203.45	JUL 12, EXP REIMB, EMS
KEVIN CASTELLO	279365	08/24/98	100-540-4232	146.63	AUG 15-22, EXP REIMB, EMS
79 TIRE AND AUTO CENTER	279254	08/12/98	100-540-4541	55.00	INV 057699, TIRE REPAIR/S.C., EMS
GLASS WRECKER SERVICE, INC.	279271	07/01/98	100-540-4541	75.00	INV 6 13000, TOWING, LIC 715705, EMS
GLASS WRECKER SERVICE, INC.	279272	07/02/98	100-540-4541	75.00	INV A 7698, TOWING, LIC 735-508, EMS
GLASS WRECKER SERVICE, INC.	279273	07/15/98	100-540-4541	45.00	INV 4 7721, TOWING, LIC 533-152, EMS
GLASS WRECKER SERVICE, INC.	279274	07/19/98	100-540-4541	75.00	INV 4 7731, TOWING, LIC NONE, UNIT 807, EMS
GLASS WRECKER SERVICE, INC.	279275	07/28/98	100-540-4541	45.00	INV 6 13102, TOWING, LIC 533 152, EMS
dba RED DOOR ELECTRONICS	279248	08/12/98	100-540-4548	140.00	INV 11303, REINSTALL VHF/REPROGRAM, EMS

VOL 0099 PAGE 810

Vendor.....	Invoice Id	Inv Date	Account Number	Expense Amount	Description.....
dba RED DOOR ELECTRONICS	279249	08/12/98	100-540-4548	73.00	INV 11301, REPAIR MIC/REPLC STROBE TUBE, EMS
GEORGETOWN FIRE DEPARTMENT	279270	08/17/98	100-540-4599	12.50	INV 6305, FIRE EXTING RECHARGE, EMS
TODD LEMASTER	279253	08/28/98	100-540-4610	850.00	AUG 28, SEP 98 RENT, 209 W.WILLIS, EMS
HGAC	279255	07/30/98	100-540-5730	2,573.17	INV 7935, PO 38524, MOTOROLA EQUIP & ACCESS,
CARGO FURNITURE/USA	279257	08/19/98	100-540-5750	957.90	INV 611710, PO 37649, LAD BACK CHAIRS, EMS
Total 540-EMS				\$ 19,109.29	
543-ALT SCHOOL/AUSTIN @ UNIVERSITY					
CITY OF GEORGETOWN	279556	08/31/98	100-543-4430	\$ 73.77	AUG 98, A#61-1025-01, ACADEMY
CITY OF GEORGETOWN	279557	08/31/98	100-543-4430	1,128.03	AUG 98, A#61-1020-01, ACADEMY
BERRY HARDWARE CO	279433	08/19/98	100-543-4510	34.92	INV 2138329, PO 39268, GARDEN HOSES, ACADEMY
Total 543-ALT SCHOOL/AUSTIN @ UNIVERSITY				\$ 1,236.72	
545-MAINTENANCE DEPT SHOP					
BERRY HARDWARE CO	279441	08/21/98	100-545-4510	\$ 586.05	INV 2138423, PO 39268, MAINT
MINOLTA CORPORATION	279332	07/31/98	100-545-4999	106.50	INV 8081888563, JUL 98, MAINT
Total 545-MAINTENANCE DEPT SHOP				\$ 692.55	
548-LEANDER EMS STATION					
CITY OF LEANDER UTILITIES	279550	08/28/98	100-548-4430	\$ 46.50	AUG 98, A#5-000372-10, EMS-LEANDER
Total 548-LEANDER EMS STATION				\$ 46.50	
551-CONST PCT #1					
EAGLE OFFICE PRODUCTS	279425	08/25/98	100-551-3100	\$ 6.34	INV 01206, PO 39684, STAMP PAD, CONST#1
EAGLE OFFICE PRODUCTS	279428	08/17/98	100-551-3100	214.36	INV 01019, PO 39684, KYBRD/CRTDG/STMPs, CONS
MILLER UNIFORM & EMBLEMS, INC.	279486	07/16/98	100-551-3311	373.60	INV 68509, PO 39095, UNIFORMS, CONST#1
GTE WIRELESS	279487	08/28/98	100-551-4211	7.28	AUG 98, 517-5874, CONST#1
WEST PUBLISHING CO	279459	08/17/98	100-551-4232	184.00	INV 47023, PO 39669, A#375-163-232, CONST#1
MINOLTA CORPORATION	279341	08/18/98	100-551-4500	76.40	INV 8081888548, PO 35678, JUL 98, CONST#1
Total 551-CONST PCT #1				\$ 861.98	
552-CONST PCT #2					
WAL-MART #1303 (GEORGETOWN)	279210	08/25/98	100-552-3100	\$ 109.93	INV 5512769, PO 39745, WHEEL CVRS/STENOBKS/T
BESTLINE COMMUNICATIONS	279570	08/31/98	100-552-4211	5.73	AUG 98, A#6037, CONST#2
Total 552-CONST PCT #2				\$ 115.66	
553-CONST PCT #3					
EXXON CARD SERVICES	279460	08/13/98	100-553-3301	\$ 26.88	AUG 98, A#1828054617-08, CONST#3
MILLER UNIFORM & EMBLEMS, INC.	279604	06/03/98	100-553-3311	762.80	INV 67832, PO 38278, PATCHES & ROCKERS, CONS
CAPCO	279536	06/23/98	100-553-4232	50.00	JUN 23, TRAINING, B.SCHWETTMANN/C.RITENOUR,
AMERICAN EXPRESS	279625	06/28/98	100-553-4232	996.23	JUN 98, A#3783-053789-22006, CONST#3
WAL-MART #1303 (GEORGETOWN)	279539	08/20/98	100-553-4999	17.51	INV 6402715, SCREEN DOOR/COPY PAPER, CONST#3
Total 553-CONST PCT #3				\$ 1,853.42	

VOL 0099 PAGE 811

Vendor.....	Invoice Id	Inv Date	Account Number	Expense Amount	Description.....
554-CONST PCT #4					
ROY ROGERS OIL, INC.	279514	08/24/98	100-554-3301	\$ 90.31	AUG 98, A#31013-00178, CONST#4
G T DISTRIBUTORS, INC.	279496	12/22/97	100-554-3311	128.00	INV 84071, PO 35238, DEP CONST BADGE, CONST#
AT&T WIRELESS SERVICES	279464	08/22/98	100-554-4211	19.08	INV 8433345, A#530-011479-28, CONST#4
BESTLINE COMMUNICATIONS	279648	08/31/98	100-554-4211	5.66	AUG 98, A#6694, CONST #4
POSTMASTER	279652	09/04/98	100-554-4212	192.00	PO 39972, STAMPS, CONST#4
Total 554-CONST PCT #4				\$ 435.05	
560-CO SHERIFF					
EXXON CARD SERVICES	279485	08/13/98	100-560-3301	\$ 160.03	AUG 98, A#1828075992-08, SHF
TEXAS DEPT OF PUBLIC SAFETY	279655	09/04/98	100-560-3530	220.00	PO 39784, SPECIMEN KITS, SHF
SOUTHWESTERN BELL	279483	08/17/98	100-560-4211	37.65	AUG 98, 331-8893, SHF
SOUTHWESTERN BELL	279484	08/17/98	100-560-4211	31.31	AUG 98, 331-1988, SHF
FEDERAL EXPRESS CORP	279508	08/24/98	100-560-4212	16.75	INV 4-623-50430, A#1913-2222-3, SHF
PUBLIC AGENCY TRAINING COUNCIL	279277	07/16/98	100-560-4232	380.00	INV 49281, PO 39197, LEAD SKILLS SEM/AUG 17
HOLIDAY INN - ARLINGTON	279503	08/31/98	100-560-4232	210.00	PO 39897, RM RESV SGTs HUGHEY/CHANDLER, SHF
PUBLIC AGENCY TRAINING COUNCIL	279620	04/15/98	100-560-4232	570.00	INV 46010, PO 37876, SKILLS SEMINAR APR 27-2
MINOLTA CORPORATION	279333	08/18/98	100-560-4500	551.43	INV 8081888282, PO 32477, JUL 98, SHF
MINOLTA CORPORATION	279335	08/18/98	100-560-4500	229.49	INV 8081889708, PO 37919, JUL 98, SHF
MINOLTA CORPORATION	279336	08/18/98	100-560-4500	120.21	INV 8081888286, PO 37300, JUL 98, SHF
MIDWEST RADAR & EQUIPMENT, INC	279307	08/12/98	100-560-4548	184.00	INV 39169, PO 39676, REPAIR & CERTIFICATION
MIDWEST RADAR & EQUIPMENT, INC	279308	08/11/98	100-560-4548	117.25	INV 39170, PO 39676, REPAIR & CERTIFICATION
AUSTIN AVENUE ANIMAL HOSPITAL	279325	08/11/98	100-560-4990	568.00	INV 2349, APR 22-AUG 11, BOARD/IMPOUND, SHF
AUSTIN AVENUE ANIMAL HOSPITAL	279326	08/11/98	100-560-4990	1,170.00	INV 2346, APR 17-AUG 11, BOARD/IMPOUND, SHF
AUSTIN AVENUE ANIMAL HOSPITAL	279327	05/08/98	100-560-4990	480.00	INV 3410, MAY 8-AUG 11, COW, SHF
AUSTIN AVENUE ANIMAL HOSPITAL	279328	05/28/98	100-560-4990	400.00	INV 3457, MAY 28, HORSE BOARDED, SHF
AUSTIN AVENUE ANIMAL HOSPITAL	279329	08/03/98	100-560-4990	225.00	INV 4861, JUL 20-AUG 3, 3 HORSES IMPOUNDED,
LIGHTNING POWDER CO., INC.	279283	08/14/98	100-560-5720	105.80	INV 151560, PO 39260, ULTRA LOUPE 5X MAGNIFI
AQUATIC ADVENTURES	279309	08/19/98	100-560-5720	714.00	INV 20177-1, PO 39664, AIR TANKS, SHF
MOTOROLA, INC.	279266	08/17/98	100-560-5730	2,707.01	INV 90937044, PO 39718, BATTERIES FOR MTS 20
G T DISTRIBUTORS, INC.	279284	07/17/98	100-560-5735	2,967.65	INV 91998, PO 38822, AMMUNITION, SHF
G T DISTRIBUTORS, INC.	279285	08/04/98	100-560-5735	2,565.40	INV 92535, PO 38822, AMMUNITION, SHF
Total 560-CO SHERIFF				\$ 14,730.98	
562-DPS & ABC GEORGETOWN					
BESTLINE COMMUNICATIONS	279489	08/21/98	100-562-4211	\$ 100.23	JUL 22-AUG 21, A#7884, DPS
SOUTHWESTERN BELL	279512	08/19/98	100-562-4211	29.23	AUG 98, 352-3121, DPS
SOUTHWESTERN BELL	279513	08/19/98	100-562-4211	29.23	AUG 98, 352-6087, DPS-TAYLOR
GTE WIRELESS	279515	08/19/98	100-562-4211	24.47	AUG 98, 217-6051, DPS & ABC
GTE WIRELESS	279516	08/22/98	100-562-4211	15.41	AUG 98, 217-6052, DPS & ABC
GTE WIRELESS	279519	08/28/98	100-562-4211	14.19	AUG 98, 217-6054, DPS & ABC
WAL-MART #1303 (GEORGETOWN)	279526	08/18/98	100-562-4999	72.78	INV 6402678, INSTANT CAMERA/FILM, DPS & ABC
Total 562-DPS & ABC GEORGETOWN				\$ 285.54	
570-CO JAIL & LAW ENF					
AL KIRCHER	279495	08/21/98	100-570-1106	\$ 1,260.00	AUG 13-21, JAIL MAGISTRATION, JAIL
WAL-MART #1303 (GEORGETOWN)	279314	06/25/98	100-570-3100	3.44	INV 5512615, PO 38530, PHONE ACC, JAIL
WAL-MART #1303 (GEORGETOWN)	279315	06/12/98	100-570-3100	6.32	INV 5513481, PO 38530, PLANNERS/COMP BOOKS,

VOL 0099 PAGE 812

Vendor.....	Invoice Id	Inv Date	Account Number	Expense Amount	Description.....
WAL-MART #1303 (GEORGETOWN)	279316	06/10/98	100-570-3100	14.10	INV 5513450, PO 38530, HI LITERS, JAIL
ABL MANAGEMENT, INC.	279288	08/14/98	100-570-3315	6,444.50	INV 21835, AUG 8-14, INMATE MEALS, JAIL
ABL MANAGEMENT, INC.	279289	08/21/98	100-570-3315	6,446.47	INV 21836, AUG 15-21, INMATE MEALS, JAIL
HARRIS DENTAL & MEDICAL SUPPLY	279310	08/14/98	100-570-3315	301.40	INV 11168, PO 39549, POWDER FREE GLOVES, JAI
GULF COAST PAPER COMPANY	279317	08/24/98	100-570-3315	2,164.25	INV 350565, PO 39674, BLEACH/DETERGENT, JAIL
AUSTIN RADIOLOGICAL ASSN	279259	07/07/98	100-570-3316	137.00	JUL 7, 07 99578, ROSA RODRIGUEZ, JAIL
AUSTIN RADIOLOGICAL ASSN	279260	07/11/98	100-570-3316	219.00	JUL 11, 07 99578, ROSA RODRIGUEZ, JAIL
AUSTIN RADIOLOGICAL ASSN	279261	07/11/98	100-570-3316	37.00	JUL 11, 07 99677, JAMES CUNNINGHAM, JAIL
AUSTIN RADIOLOGICAL ASSN	279262	07/13/98	100-570-3316	41.00	JUL 13, 07 99677, JAMES CUNNINGHAM, JAIL
AUSTIN RADIOLOGICAL ASSN	279263	07/10/98	100-570-3316	176.00	JUL 10, 07 649725, JAMES BURTON, JAIL
AUSTIN RADIOLOGICAL ASSN	279264	07/15/98	100-570-3316	373.00	JUL 15, 07 649725A, JAMES BURTON, JAIL
AUSTIN RADIOLOGICAL ASSN	279265	07/11/98	100-570-3316	64.00	JUL 11, 07 649725B, JAMES BURTON, JAIL
CENTRAL TEXAS RAD ASSOC, P.A.	279278	08/04/98	100-570-3316	64.00	AUG 4, CT6-8556-1, BRYANT JOHNSON, JAIL
CENTRAL TEXAS RAD ASSOC, P.A.	279279	08/04/98	100-570-3316	31.00	AUG 4, CT6-8557-1, REGULO REYNOSO, JAIL
CENTRAL TEXAS RAD ASSOC, P.A.	279280	08/04/98	100-570-3316	33.00	AUG 4, CT6-8560-1, VINCENT GUTIERREZ, JAIL
CENTRAL TEXAS RAD ASSOC, P.A.	279281	08/04/98	100-570-3316	31.00	AUG 4, CT6-8559-1, ROBERT MOORE, JAIL
CENTRAL TEXAS RAD ASSOC, P.A.	279282	08/04/98	100-570-3316	31.00	AUG 4, CT6-8558-1, DALE MANESS, JAIL
DALLAS COUNTY	279286	08/12/98	100-570-3316	106.00	INV 10998, JUL 98, DMI & DUID ANALYSIS, JAIL
GEO HEALTHCARE SYSTEM, INC.	279291	08/07/98	100-570-3316	56.00	INV 49403/347115, JIMMY D STEAPLES, JAIL
GEO HEALTHCARE SYSTEM, INC.	279292	08/07/98	100-570-3316	473.00	INV 49403/347076, JIMMY D STEAPLES, JAIL
GEO HEALTHCARE SYSTEM, INC.	279293	08/08/98	100-570-3316	140.39	INV 88419/347208, JASON ORONA, JAIL
GEO HEALTHCARE SYSTEM, INC.	279294	08/08/98	100-570-3316	78.00	INV 88419/347213, JASON ORONA, JAIL
GEO HEALTHCARE SYSTEM, INC.	279295	08/07/98	100-570-3316	94.00	INV 99991/347044, ROBERT DALE MANESS, JAIL
GEO HEALTHCARE SYSTEM, INC.	279296	08/11/98	100-570-3316	102.00	INV 100426/347584, TERESA M GRAHAM, JAIL
GEO HEALTHCARE SYSTEM, INC.	279297	08/11/98	100-570-3316	197.47	INV 100426/347581, TERESA GRAHAM, JAIL
GEO HEALTHCARE SYSTEM, INC.	279298	08/12/98	100-570-3316	116.00	100470/347809, ERIC E CASTILLO, JAIL
GEO HEALTHCARE SYSTEM, INC.	279299	08/12/98	100-570-3316	104.00	INV 62874/347808, KEITH BLACKSHIRE, JAIL
GEO HEALTHCARE SYSTEM, INC.	279300	08/07/98	100-570-3316	245.61	INV 99991/347042, ROBERT DALE MANESS, JAIL
GEO HEALTHCARE SYSTEM, INC.	279301	08/08/98	100-570-3316	107.00	INV 607883/347214, CHRISTPHER EPPS, JAIL
GEO HEALTHCARE SYSTEM, INC.	279302	08/08/98	100-570-3316	173.55	INV 607883/347209, CHRISTPHER EPPS, JAIL
GEO HEALTHCARE SYSTEM, INC.	279303	08/08/98	100-570-3316	126.00	INV 62700/347288, MATTHEW S WHITE, JAIL
GEO HEALTHCARE SYSTEM, INC.	279304	08/08/98	100-570-3316	115.70	INV 62700/347280, MATTHEW S WHITE, JAIL
GEO HEALTHCARE SYSTEM, INC.	279305	08/07/98	100-570-3316	32.00	INV 62874/347138, KEITH R BLACKSHIRE, JAIL
GEO HEALTHCARE SYSTEM, INC.	279306	08/07/98	100-570-3316	145.00	INV 100347/347137, CHRISTPHER DELOSANTOS, JA
CLIFTON B. O'MEARA MD	279311	08/10/98	100-570-3316	118.00	AUG 10, 5622-9808007C, ROBERT DURBIN, JAIL
WAL-MART #1303 (GEORGETOWN)	279312	08/25/98	100-570-3318	140.40	INV 5512771, PO 39673, TOOLS, JAIL
GULF COAST PAPER COMPANY	279318	08/24/98	100-570-3318	1,110.00	INV 350566, PO 39678, 2-PLY TIS, JAIL
BRETT ROBINSON	279258	02/26/98	100-570-4231	3.11	FEB 26, EXP REIMB, SHF, REISSUE CHECK
KATHLEEN POKLUDA	279346	08/19/98	100-570-4231	7.35	AUG 14, EXP REIMB, JAIL
VAUGHN MCWILLIAMS	279347	08/21/98	100-570-4231	7.70	AUG 21, EXP REIMB, JAIL
ALBERT CABRERA	279348	08/21/98	100-570-4231	58.27	AUG 21, EXP REIMB, JAIL
VAUGHN MCWILLIAMS	279358	08/19/98	100-570-4231	8.90	AUG 19, EXP REIMB, JAIL
ALLAN SMITH	279359	08/19/98	100-570-4231	9.72	AUG 19, EXP REIMB, JAIL
DERRICK DUTTON	279366	08/21/98	100-570-4231	14.10	AUG 17-19, EXP REIMB, JAIL
ALLAN SMITH	279367	08/18/98	100-570-4231	77.58	AUG 17-18, EXP REIMB, JAIL
DIANE NEWSON	279584	08/21/98	100-570-4231	76.42	AUG 20, EXP REIMB, JAIL
CLAYTON KLEEN	279357	08/19/98	100-570-4232	34.85	AUG 16-18, EXP REIMB, JAIL
CHRISTOPHER MATTS	279368	08/18/98	100-570-4232	43.31	AUG 16-18, EXP REIMB, JAIL
MINOLTA CORPORATION	279334	08/18/98	100-570-4500	481.50	INV 8081888278, PO 32477, JUL 98, JAIL

Total 570-CO JAIL & LAW ENF

\$ 22,480.41

VOL 0099 PAGE 813

Vendor.....	Invoice Id	Inv Date	Account Number	Expense Amount	Description.....
576-JUVENILE SERVICES					
ACA INSURANCE TRUST, INC.	279654	09/04/98	100-576-4410	\$ 277.68	PO 39990, PROFESSIONAL LIAB INS, J/SERV
AERIE AWARDS & SIGNS	279276	08/19/98	100-576-4999	100.00	INV 396414, PO 37837, NAME BADGES, J/SERV
Total 576-JUVENILE SERVICES				\$ 377.68	
581-9-1-1 COMMUNICATIONS					
B T MILLER OFFICE PRODUCTS	279472	08/18/98	100-581-3100	\$ 274.00	INV 43945920, PO 39602, COPY PAPER, 911 COMM
Total 581-9-1-1 COMMUNICATIONS				\$ 274.00	
645-CHILD WELFARE					
SHIRLEY D'AGUANNO	277757	08/17/98	100-645-4115	\$ 200.00	JUL 98, CLOTHING, S.DAG
ROGER TONY LOPEZ	277785	08/17/98	100-645-4115	200.00	JUL 98, CLOTHING, R.T.LOP
Total 645-CHILD WELFARE				\$ 400.00	
665-EXTENSION SERVICE					
COMP USA, INC.	279474	08/18/98	100-665-3115	\$ 52.00	INV 521104457, PO 39650, MS INTELIMSE, IS
BRODERBUND SOFTWARE	279621	08/12/98	100-665-3115	64.90	INV 420443600016, PO 39369, CLICKART 200K, E
GTE WIRELESS	279518	08/28/98	100-665-4211	179.22	AUG 98, 869-6767, EXT SVC
MINOLTA CORPORATION	279344	08/18/98	100-665-4500	389.37	INV 8081880559, PO 36835, JUL 98, EXT SERV
CHEVRON USA, INC.	279507	08/27/98	100-665-4541	12.74	AUG 98, A#789-878-048-6, EXT SVC
LINKS COMMUNICATINS, INC.	279602	07/23/98	100-665-4544	60.00	INV 1514, LABOR, ISOLATE DIAL OUT PROBLEM, U
Total 665-EXTENSION SERVICE				\$ 750.23	
690-EMS ADMIN					
CITY OF GEORGETOWN	279558	08/31/98	100-690-4430	\$ 271.18	AUG 98, A#12-0304-01, EMS-ADMIN
Total 690-EMS ADMIN				\$ 271.18	
694-RR ANNEX ADDITION					
LONE STAR GAS CO	279493	08/21/98	100-694-4430	\$ 32.92	AUG 98, A#473-5490-99-9, RR ADDITION
Total 694-RR ANNEX ADDITION				\$ 32.92	
699-CEDAR PARK ANNEX					
CITY OF CEDAR PARK WATER DEPT.	279490	08/25/98	100-699-4430	\$ 385.76	AUG 98, A#056-000011-001, CP ANNEX
CITY OF CEDAR PARK WATER DEPT.	279491	08/25/98	100-699-4430	118.38	AUG 98, A#056-000010-001, CP ANNEX
PEDERNALES ELECTRIC COOP	279544	08/31/98	100-699-4430	3,647.77	JUL 98, A#1357-9487-00, CP ANNEX
Total 699-CEDAR PARK ANNEX				\$ 4,151.91	
702-EMS-TAYLOR FACILITY					
TUELECTRIC	279509	08/26/98	100-702-4430	\$ 124.43	AUG 98, A#804-7637-99-9, EMS-TAYLOR
Total 702-EMS-TAYLOR FACILITY				\$ 124.43	

VOL 0099 PAGE 814

Vendor..... Invoice Id Inv Date Account Number Expense Amount Description.....

Total Fund Expenditures	\$ 207,895.15
Less Fund Discounts	0.00
Less Fund Credits	0.00
Cash Required 100-GENERAL FUND	\$ 207,895.15

Vendor..... Invoice Id Inv Date Account Number Expense Amount Description.....

210-UNIFIED SYSTEM

EAGLE ENTERPRISES	279237	08/10/98	200-210-3102	\$ 162.40	INV 5791, PO 39485, 2 CASES 911 SPRAY, URS
TEXAS FUEL & ASPHALT	279220	08/05/98	200-210-3550	5,426.83	INV 44921, PO 38586, AC-10, URS
TEXAS FUEL & ASPHALT	279221	07/31/98	200-210-3550	2,479.29	INV 44827, PO 38949, AC-5, URS
SIDCO ENTERPRISES, INC	279239	08/17/98	200-210-3550	140.00	INV 46347, 4 HRS DEMURRAGE, URS
GEORGETOWN TRANSPORTATION, INC	279187	08/14/98	200-210-3551	359.22	INV 92786, PO 38358, HAULING, URS
PIONEER CONCRETE OF TEXAS	279201	08/11/98	200-210-3551	2,534.17	INV 693517, PO 39339, BASE, URS
PIONEER CONCRETE OF TEXAS	279202	08/06/98	200-210-3551	151.20	INV 692865, PO 39340, GGR 3 CVRSTN, URS
PIONEER CONCRETE OF TEXAS	279204	08/07/98	200-210-3551	631.77	INV 692888, PO 39341, GR 3 CVRSTN, URS
PIONEER CONCRETE OF TEXAS	279205	08/06/98	200-210-3551	963.76	INV 692866, PO 39341, GR 3 CVRSTN, URS
PIONEER CONCRETE OF TEXAS	279206	08/10/98	200-210-3551	1,278.26	INV 693495, PO 39341, GR 3 CVRSTN, URS
PIONEER CONCRETE OF TEXAS	279207	08/11/98	200-210-3551	633.78	INV 693518, PO 39341, GR 3 CVRSTN, URS
TEXAS CRUSHED STONE CO	279216	08/17/98	200-210-3551	191.30	INV 732883, PO 39527, BASE, URS
TEXAS CRUSHED STONE CO	279217	08/18/98	200-210-3551	539.89	INV 733061, PO 39527, BASE, URS
TEXAS CRUSHED STONE CO	279218	08/19/98	200-210-3551	530.39	INV 733215, PO 39527, BASE, URS
CARL'S FLORENCE HARDWARE	279183	08/19/98	200-210-3552	5.98	INV 081980020, PO 39483, CONCRETE MIX, URS
GRANGER LUMBER COMPANY	279190	08/14/98	200-210-3555	3.70	INV 4706, PO 39487, INSULATORS, URS
dba D & L PRINTING	279235	08/19/98	200-210-4100	15.32	INV 2-6149, PO 000811L, MAP COPIES FOR INNER
AT&T WIRELESS SERVICES	279455	08/21/98	200-210-4211	1,066.81	AUG 98, A#60378965, URS
SOUTHWESTERN BELL	279466	08/15/98	200-210-4211	36.70	AUG 98, 778-5655, URS
WILLIAMSON CO SUN, INC.	279241	08/12/98	200-210-4310	11.25	AUG 16, A#072595-00000, NOTICE PUBLIC HEARIN
CITY OF GEORGETOWN	279465	08/21/98	200-210-4430	7.50	AUG 98, A#37-0615-00, URS
TUELECTRIC	279573	08/26/98	200-210-4430	88.98	AUG 98, A#281-1891-99-9, URS
CITY OF TAYLOR	279574	08/31/98	200-210-4430	22.43	AUG 98, A#22-0160-01, URS
PEDERNALES ELECTRIC COOP	279575	07/31/98	200-210-4430	60.72	JUL 98, A#0088-5616-00, URS
LONE STAR GAS CO	279576	08/24/98	200-210-4430	14.76	AUG 98, A#552-4688-99-0, URS
LIBERTY HILL W.S.C.	279577	08/30/98	200-210-4430	19.08	AUG 98, A#34, URS
GRANGER LUMBER COMPANY	279189	08/14/98	200-210-4540	19.95	INV 4705, PO 39487, 2-1/2 GAL CLEANER, URS
KENNEDY AIRGAS	279199	07/31/98	200-210-4540	4.40	INV 789404, PO 39012, OXYGEN, URS
ARNOLD OIL COMPANY	279168	08/13/98	200-210-4900	87.00	INV 50-65341, PO 39470, OIL, URS
CAPITOL BEARING SERVICE OF AUS	279170	08/11/98	200-210-4900	46.53	INV 278981, PO 39475, 4 BOLT FLANGE, URS
CENTRAL TEXAS DIESEL	279171	08/14/98	200-210-4900	380.09	INV 84346, PO 000807L, BLADES/VALVE/PLNGR, U
CONLEY LOTT NICHOLS MACHINERY	279172	08/11/98	200-210-4900	397.50	INV P81682, PO 39517, BLOCK, URS
DRAEGER MOTOR CO., INC	279173	08/14/98	200-210-4900	58.81	INV 34115, PO 39482, RELAY ASY, URS
DRAEGER MOTOR CO., INC	279174	08/17/98	200-210-4900	82.11	INV 34142, PO 39482, REGULATOR, URS
DRAEGER MOTOR CO., INC	279175	08/18/98	200-210-4900	228.92	INV 34189, PO 39482, VALVE ASY, URS
DRAEGER MOTOR CO., INC	279176	08/18/98	200-210-4900	49.21	INV 34195, PO 39482, ACCUMULATOR, URS
DRAEGER MOTOR CO., INC	279177	08/18/98	200-210-4900	107.76	INV 34207, PO 39482, SHOE & LIN, URS
DRAEGER MOTOR CO., INC	279178	08/18/98	200-210-4900	1,004.82	INV 34197, PO 39626, MANIFOLD E, URS
DRAEGER MOTOR CO., INC	279179	08/20/98	200-210-4900	42.46	INV 34272, PO 000812L, HEADLIGHT SWITCH, URS
FREIGHTLINER OF AUSTIN	279184	08/14/98	200-210-4900	53.94	INV 402172, PO 39484, VALVE RELAY, URS
FREIGHTLINER OF AUSTIN	279185	08/14/98	200-210-4900	38.88	INV 402194, PO 39484, MUDFLAP, URS
FREIGHTLINER OF AUSTIN	279186	08/14/98	200-210-4900	105.78	INV 402198, PO 39484, VALVE RELAY, URS
HOLT COMPANY OF TEXAS	279193	08/17/98	200-210-4900	9.30	INV P1010040652, PO 39489, PAINT, URS
HOLT COMPANY OF TEXAS	279194	08/11/98	200-210-4900	640.91	INV P1010040032, PO 39455, PIN/RETAINER/BOLT
HOLT COMPANY OF TEXAS	279195	08/13/98	200-210-4900	35.10	INV P1010040345, PO 39489, BULB, URS
HOLT COMPANY OF TEXAS	279196	08/14/98	200-210-4900	62.22	INV P1010040471, PO 39489, SWITCH, URS
INTERSTATE BATTERY SYSTEM	279197	08/19/98	200-210-4900	239.80	INV 501875, PO 39491, BATTERIES, URS
INTERSTATE BATTERY SYSTEM	279198	08/14/98	200-210-4900	203.85	INV 501836, PO 39491, BATTERIES, URS
LONGHORN INTERNATIONAL	279200	08/12/98	200-210-4900	109.09	INV 427526, PO 39497, CORE, URS
RAVEY CHRYSLER	279208	08/14/98	200-210-4900	14.96	INV 2454, PO 000805L, COOLANT/LUG NUT, URS

VOL 0099 PAGE 815

Vendor.....	Invoice Id	Inv Date	Account Number	Expense Amount	Description.....
RIVER CITY MACHINERY	279213	08/10/98	200-210-4900	47.13	INV 1334684-001, PO 39510, FEM.90/COMB NPL/S
RIVER CITY MACHINERY	279214	08/14/98	200-210-4900	7.56	INV 1353293-001, PO 39510, GASKET, URS
TEXANA MACHINERY, INC.	279219	08/13/98	200-210-4900	7.20	INV CA29243A, PO 39500, BREAKER, URS
TEX-CON OIL	279222	08/18/98	200-210-4900	113.30	INV 56573, PO 39515, OIL, URS
TEX-CON OIL	279223	08/20/98	200-210-4900	149.05	INV 56814, PO 39515, OIL, URS
G T DISTRIBUTORS, INC.	279225	08/20/98	200-210-4900	15.00	INV 93054, PO 39486, PSE ROTATING FLTR RED M
WALKER TIRE COMPANY	279226	08/19/98	200-210-4900	266.76	INV LT-24504, PO 39654, TIRES, URS
WALKER TIRE COMPANY	279227	08/19/98	200-210-4900	365.46	INV LT-24505, PO 39624, TIRES, URS
WALKER TIRE COMPANY	279228	08/13/98	200-210-4900	224.00	INV LT-24450, PO 39566, TIRES, URS
WALKER TIRE COMPANY	279229	08/17/98	200-210-4900	93.50	INV LT-24475, PO 39619, TIRES, URS
WAUKESHA-PEARCE INDUSTRIES, IN	279230	08/11/98	200-210-4900	64.30	INV 20-36299, PO 39170, BMG STRG COLUMN, URS
WAUKESHA-PEARCE INDUSTRIES, IN	279231	08/12/98	200-210-4900	54.30	INV 20-36544, PO 000799L, BMG KIT/SEAL, URS
WAUKESHA-PEARCE INDUSTRIES, IN	279233	08/11/98	200-210-4900	77.30	INV 20-35148, PO 000775L, LESS CM 20-36587,
WILLIAMSON CO EQUIP CO., INC.	279234	08/18/98	200-210-4900	18.15	INV IN97959, PO 39506, DIPSTICK/CAP, URS
DEALERS TRUCK EQUIPMENT CO., IN	279236	08/11/98	200-210-4900	80.44	INV A110382, PO 39523, FLIP TOP PRO, URS
dba RUSSELL GLASS & MIRROR	279238	08/19/98	200-210-4900	39.95	INV 05524, PO 000808L, GLASS REPAIR, URS
TAYLOR EQUIPMENT CO, INC.	279240	08/14/98	200-210-4900	4.36	INV 10728, PO 39514, METRIC/PIN, URS
LONGHORN INTERNATIONAL	279267	08/14/98	200-210-4900	10.44	INV 427732, PO 39497, LESS CM 427913, KIT, U
LONGHORN INTERNATIONAL	279268	08/17/98	200-210-4900	92.88	INV 427867, PO 39497, ADAPTER, URS
LONGHORN INTERNATIONAL	279269	08/14/98	200-210-4900	10.44	INV 427734, PO 39497, SWITCH, URS
GULF COAST PAPER COMPANY	279192	08/13/98	200-210-4992	504.00	INV 350041, PO 39521, SUPPLIES, URS
TAYLOR FIRE SUPPLY	279215	08/01/98	200-210-4993	865.00	INV 970662, PO 38542, ANNUAL FIRE EXT INSPEC
WAL-MART #1303 (GEORGETOWN)	278875	08/12/98	200-210-4999	91.36	INV 6402933, PO 39505, INST FILM, URS
CARL'S FLORENCE HARDWARE	279180	08/14/98	200-210-4999	12.20	INV 081480023, PO 39483, WELDING ROD, URS
CARL'S FLORENCE HARDWARE	279181	08/14/98	200-210-4999	8.85	INV 081480030, PO 39483, PVC PIPE/CAP, URS
CARL'S FLORENCE HARDWARE	279182	08/14/98	200-210-4999	7.00	INV 195826, PO 39483, PIPE, URS
GRANGER LUMBER COMPANY	279188	08/01/98	200-210-5000	23.87	INV 4704, PO 39487, STREET BROOMS, URS
GRANGER LUMBER COMPANY	279191	08/17/98	200-210-5000	18.75	INV 4707, PO 39487, FIBER GLASS HANDLE, URS
CITY OF AUSTIN	279607	08/13/98	200-210-5200	10,590.33	AUG 13, FILE #38969, REROUTING FAC FOR RR XI
TRANSIT MIX	279224	08/10/98	200-210-5400	459.50	INV 4016996, PO 39509, 3000 PSI, URS
WAUKESHA-PEARCE INDUSTRIES, IN	279232	08/11/98	200-210-5751	25,984.00	INV 20-36474, PO 37733, WALDON 250 SWEEPMAST
S & M VACUUM	279212	08/10/98	200-210-5753	135.00	INV 034174, PO 39622, PUMP SEPTIC TANK, URS

Total 210-UNIFIED SYSTEM

\$ 61,840.26

211-R & B GEN FUND, R&B #1

ADVANCED/SUPERIOR PAGING	279482	08/22/98	200-211-4211	\$ 53.85	INV 10887122, SEP 1-NOV 30, A#31024, PCT#1
AT&T WIRELESS SERVICES	279531	08/13/98	200-211-4211	103.16	AUG 98, A#61427688, PCT#1
BESTLINE COMMUNICATIONS	279644	08/31/98	200-211-4211	20.15	AUG 98, A#6064, PCT#1
MINOLTA CORPORATION	279337	08/18/98	200-211-5750	100.07	INV 8081888379, PO 35091, JUL 98, PCT#1

Total 211-R & B GEN FUND, R&B #1

\$ 277.23

212-R & B GEN FUND, R&B #2

BESTLINE COMMUNICATIONS	279568	08/31/98	200-212-4211	\$ 7.67	AUG 98, A#6036, PCT#2
GREG BOATRIGHT	279351	08/25/98	200-212-4231	365.30	JUL 98, EXP REIMB, PCT#2
OZARKA NATURAL SPRING WATER	279571	08/16/98	200-212-4999	34.20	INV 08H0114744683, A#0114744683, PCT#2

Total 212-R & B GEN FUND, R&B #2

\$ 407.17

213-R & B GEN FUND, R&B #3

HERITAGE PRINTING, INC.	279533	08/18/98	200-213-3100	\$ 13.00	INV 17173, PO 39559, DAY MINDER, PCT#3
-------------------------	--------	----------	--------------	----------	--

VOL 0099 PAGE 816

Vendor.....	Invoice Id	Inv Date	Account Number	Expense Amount	Description.....
BESTLINE COMMUNICATIONS	279581	08/31/98	200-213-4211	11.02	AUG 98, A#6721, PCT#3
COUNTY JUDGES & COMMISSIONERS	279499	08/31/98	200-213-4232	160.00	PO 39907, REG FEE D.HAYS, SEP 21-24, PCT#3
Total 213-R & B GEN FUND, R&B #3				\$ 184.02	
214-R & B GEN FUND, R&B #4					
WAL-MART #77 (TAYLOR)	278735	07/04/98	200-214-3100	\$ 3.96	INV 5035328, PO 39404, POLY WRAP, PCT#4
WAL-MART #77 (TAYLOR)	278736	07/20/98	200-214-3100	2.28	INV 5130606, PO 39404, ADDROLLS, PCT#4
Total 214-R & B GEN FUND, R&B #4				\$ 6.24	
Total Fund Expenditures				\$ 62,714.92	
Less Fund Discounts				0.00	
Less Fund Credits				0.00	
Cash Required 200-R & B GEN FUND				\$ 62,714.92	

Vendor.....	Invoice Id	Inv Date	Account Number	Expense Amount	Description.....
385-CO CLK RECORDS CTMP, INC.	279473	07/31/98	385-385-5750	\$ 12,645.00	INV 45814, PO 39192, PLAT COPIER, C/CLK
Total 385-CO CLK RECORDS				\$ 12,645.00	
Total Fund Expenditures				\$ 12,645.00	
Less Fund Discounts				0.00	
Less Fund Credits				0.00	
Cash Required 385-RCDS MGMT & PRSRV FUND (COUNTY CLERK)				\$ 12,645.00	

Vendor.....	Invoice Id	Inv Date	Account Number	Expense Amount	Description.....
341 SHARON ELAINE MEREDITH	279521	08/31/98	406-341-3000	\$ 10.00	AUG 31, REFUND OF DUPLICATE PAYMENT, C/ATTY
Total 341				\$ 10.00	
696-CO ATTY HOT CKS					
SRI MONOGRAMMING, INC.	279419	08/20/98	406-696-4999	\$ 216.25	INV 7024, NAVY CAPS, C/ATTY
Total 696-CO ATTY HOT CKS				\$ 216.25	
Total Fund Expenditures				\$ 226.25	
Less Fund Discounts				0.00	
Less Fund Credits				0.00	
Cash Required 406-CO ATTY HOT CK FUND				\$ 226.25	

VOL 0099 PAGE 817

Vendor.....	Invoice Id	Inv Date	Account Number	Expense Amount	Description.....
408-DARE PROGRAM					
AUSTIN ISD	279617	08/20/98	408-408-3100	\$ 595.00	AUG 20, DARE SUPPLIES, DRUG ENFORCEMENT FUND
Total 408-DARE PROGRAM				\$ 595.00	
Total Fund Expenditures				\$ 595.00	
Less Fund Discounts				0.00	
Less Fund Credits				0.00	
Cash Required 408-D/A DRUG ENF FUND				\$ 595.00	

Vendor.....	Invoice Id	Inv Date	Account Number	Expense Amount	Description.....
500-STATE JAIL					
CCA/CONCEPT	279345	07/31/98	503-500-4142	\$ 344,564.00	JUL 98, INMATE BILLING, TX
Total 500-STATE JAIL				\$ 344,564.00	
Total Fund Expenditures				\$ 344,564.00	
Less Fund Discounts				0.00	
Less Fund Credits				0.00	
Cash Required 503-OUT OF STATE INMATE BILLING FUND				\$ 344,564.00	

Vendor.....	Invoice Id	Inv Date	Account Number	Expense Amount	Description.....
693-ANDERSON MILL ROAD EXTENSION					
GARDNER APPRAISAL GROUP, INC.	279628	08/19/98	701-693-4100	\$ 3,000.00	AUG 19, LIMITED APPRAISAL, AND MILL RD
Total 693-ANDERSON MILL ROAD EXTENSION				\$ 3,000.00	
699-CEDAR PARK ANNEX					
SPENCER GODFREY	279530	08/20/98	701-699-4100	\$ 1,180.69	1HV 98-209, PROJ 98005, WC ANNEX FINISH-OUT,
Total 699-CEDAR PARK ANNEX				\$ 1,180.69	
Total Fund Expenditures				\$ 4,180.69	
Less Fund Discounts				0.00	
Less Fund Credits				0.00	
Cash Required 701-1996 CAPITAL PROJECTS FUND				\$ 4,180.69	

VOL 0099 PAGE 818

Vendor.....	Invoice Id	Inv Date	Account Number	Expense Amount	Description.....
701-TAYLOR ANNEX					
R. GILL & ASSOC.	279422	08/06/98	702-701-4100	\$ 4,500.00	INV 698, REBID PHASE, TAYLOR ANNEX
Total 701-TAYLOR ANNEX				\$ 4,500.00	
Total Fund Expenditures				\$ 4,500.00	
Less Fund Discounts				0.00	
Less Fund Credits				0.00	
Cash Required 702-JULY 1997 CO ISSUANCE				\$ 4,500.00	

Vendor.....	Invoice Id	Inv Date	Account Number	Expense Amount	Description.....
703					
PRINE STRATEGIES, INC.	279629	07/13/98	703-703-4100	\$ 9,860.97	INV 000891, REF:WC-0093, JUN 2-30, PROFESSION
PRINE STRATEGIES, INC.	279630	08/05/98	703-703-4100	19,295.40	INV 000917, REF:WC-0093, JUL 98, PROFESSIONA
Total 703				\$ 29,156.37	
Total Fund Expenditures				\$ 29,156.37	
Less Fund Discounts				0.00	
Less Fund Credits				0.00	
Cash Required 703-7/97 CAP PROJ - ROADS				\$ 29,156.37	

Vendor.....	Invoice Id	Inv Date	Account Number	Expense Amount	Description.....
806-WILLIAMSON COUNTY BENEFITS PROGRAM					
HAYNES & BOONE, LLP	279603	08/18/98	885-886-4100	\$ 56.00	INV 9822055, RESEARCH FMLA QUESTION, BENEFIT
BENEFITS MANAGEMENT & TOUR EXP	279595	03/10/98	885-886-4232	697.00	INV 1970, PO 39105, SEP 13-16, J.SNEED, BENE
BENEFITS MANAGEMENT & TOUR EXP	279596	03/10/98	885-886-4232	697.00	INV 1972, PO 39105, SEP 13-16, G.BOATRIGHT,
BENEFITS MANAGEMENT & TOUR EXP	279597	03/10/98	885-886-4232	697.00	INV 1973, PO 39105, SEP 13-16, L.ZIRKLE, BE
BENEFITS MANAGEMENT & TOUR EXP	279598	03/10/98	885-886-4232	797.00	INV 1775, PO 39105, SEP 13-16, J.DOERFLER, B
BENEFITS MANAGEMENT & TOUR EXP	279599	03/10/98	885-886-4232	797.00	INV 1738, PO 39112, SEP 13-16, K.WILSON, BEN
dba D & L PRINTING	279378	08/19/98	885-886-4350	120.00	INV 2315, PO 39324, WELLNESS PARTIC RECPTS,
CANON U.S.A., INC.	279471	08/14/98	885-886-5750	150.00	INV NR085436, PO 33383, JUL 98, BENEFITS
Total 806-WILLIAMSON COUNTY BENEFITS PROGRAM				\$ 4,011.00	
Total Fund Expenditures				\$ 4,011.00	
Less Fund Discounts				0.00	
Less Fund Credits				0.00	
Cash Required 805-WMSON CO BENEFITS PROG				\$ 4,011.00	

VOL 0099 PAGE 819

Vendor.....	Invoice Id	Inv Date	Account Number	Expense Amount	Description.....
902-911 ADDRESSING 97-98					
BESTLINE COMMUNICATIONS	279566	08/31/98	902-902-4211	\$ 3.59	AUG 98, A#6735, 911 ADD
SHANNAN HICKS	279618	09/02/98	902-902-4212	10.96	AUG 11-SEP 1, EXP REIMB, 911 MAINT
DESKMAP SYSTEM, INC.	279320	08/27/98	902-902-4232	857.14	INV 808163, MAPINFO TRAINING/2 PERSONS, 911
SHANNAN HICKS	279618	09/02/98	902-902-4232	113.28	AUG 11-SEP 1, EXP REIMB, 911 MAINT
COMP USA, INC.	279475	08/18/98	902-902-5750	185.00	INV 748001569, PO 38810, IOME ZIP PLUS DR, 9
COMP USA, INC.	279476	08/17/98	902-902-5750	295.00	INV 521104344, PO 39593, UMAX ASTRA 1200S, 9
Total 902-911 ADDRESSING 97-98				\$ 1,464.97	
Total Fund Expenditures				\$ 1,464.97	
Less Fund Discounts				0.00	
Less Fund Credits				0.00	
Cash Required 902-911 ADDRESSING 97-98				\$ 1,464.97	

Vendor.....	Invoice Id	Inv Date	Account Number	Expense Amount	Description.....
914-VICTIMS ASST GRANT 98-99					
B T MILLER OFFICE PRODUCTS	279420	08/17/98	914-914-3000	\$ 208.98	INV 43946020, PO 39575, STORAGE CABINET, VIC
GTE WIRELESS	279517	08/28/98	914-914-3000	32.49	AUG 98, 940-5094, VICT ASSIST
Total 914-VICTIMS ASST GRANT 98-99				\$ 241.47	
Total Fund Expenditures				\$ 241.47	
Less Fund Discounts				0.00	
Less Fund Credits				0.00	
Cash Required 914-VICTIMS ASST GRANT 98-99				\$ 241.47	

Vendor.....	Invoice Id	Inv Date	Account Number	Expense Amount	Description.....
923-COMMUNITY CORRECTIONS ASSISTANCE 97-98					
WAL-MART #1303 (GEORGETOWN)	278800	08/13/98	923-923-3000	\$ 79.96	INV 6402949, PO 39116, CRDLS PHONE, J/SERV
WAL-MART #1303 (GEORGETOWN)	278573	07/15/98	923-923-3317	191.60	INV 5513089, PO 38899, MISC SUPPLIES, J/SERV
WAL-MART #1303 (GEORGETOWN)	278575	08/13/98	923-923-3317	251.27	INV 6402944, PO 39302, MISC SUPPLIES, J/SERV
WAL-MART #1303 (GEORGETOWN)	278833	07/10/98	923-923-3317	25.33	INV 5513032, PO 38898, CLEANER/EQUATE, J/SERV
WAL-MART #1303 (GEORGETOWN)	278834	07/21/98	923-923-3317	170.83	INV 5513130, PO 38890, MENS SOCKS/SOAP, J/SE
LINDA TAYLOR	279370	08/24/98	923-923-3317	80.08	AUG 4-11, EXP REIMB, J/SERV
FORREST MULLINS	279371	08/21/98	923-923-3317	19.88	AUG 11-20, EXP REIMB, J/SERV
CHARLES M. SKAGGS	279372	08/22/98	923-923-3317	100.52	JUN 22-AUG 22, EXP REIMB, J/SERV
LINDA TAYLOR	279370	08/24/98	923-923-4231	0.56	AUG 4-11, EXP REIMB, J/SERV
Total 923-COMMUNITY CORRECTIONS ASSISTANCE 97-98				\$ 920.03	
Total Fund Expenditures				\$ 920.03	
Less Fund Discounts				0.00	
Less Fund Credits				0.00	
Cash Required 923-COMMUNITY CORRECTIONS ASSISTANCE 97-98				\$ 920.03	

VOL 0099 PAGE 820

Vendor.....	Invoice Id	Inv Date	Account Number	Expense Amount	Description.....
352					
MARY RODRIGUEZ	279352	08/20/98	947-352-5000	\$ 5.95	JUN 28-AUG 19, EXP REIMB, TASK FORCE
Total 352				\$ 5.95	
947-CARADA TASK FORCE 98-99					
FAYETTE COUNTY AUDITOR	279537	08/19/98	947-947-1100	\$ 2,554.75	JUL 98, SALARY & FRINGE, R.BLIESE, TASK FORC
FAYETTE COUNTY AUDITOR	279537	08/19/98	947-947-2010	195.43	JUL 98, SALARY & FRINGE, R.BLIESE, TASK FORC
FAYETTE COUNTY AUDITOR	279537	08/19/98	947-947-2020	199.02	JUL 98, SALARY & FRINGE, R.BLIESE, TASK FORC
FAYETTE COUNTY AUDITOR	279537	08/19/98	947-947-2030	5.00	JUL 98, SALARY & FRINGE, R.BLIESE, TASK FORC
FAYETTE COUNTY AUDITOR	279537	08/19/98	947-947-2050	127.74	JUL 98, SALARY & FRINGE, R.BLIESE, TASK FORC
FAYETTE COUNTY AUDITOR	279537	08/19/98	947-947-2060	5.11	JUL 98, SALARY & FRINGE, R.BLIESE, TASK FORC
MARY RODRIGUEZ	279352	08/20/98	947-947-3000	2.70	JUN 28-AUG 19, EXP REIMB, TASK FORCE
CCS & GEORGETOWN INTERNET	279423	09/01/98	947-947-3000	15.98	INV 22933, INTERNET ACCOUNT, TASK FORCE
GTE WIRELESS	279481	08/25/98	947-947-3000	5.56	AUG 98, 217-3723, TASK FORCE
GTE WIRELESS	279488	08/28/98	947-947-3000	35.04	AUG 98, 940-4794, TASK FORCE
NOTARY PUBLIC UNDERWRITERS AGE	279497	08/31/98	947-947-3000	92.00	PO 39893, NOTARY BOND/FILING FEE/STAMP, TASK
WAL-MART #01-0475 (RR)	279528	08/24/98	947-947-3000	9.72	INV 6467164, PO 38889, TRASHBAGS, TASK FORCE
AT&T WIRELESS SERVICES	279560	08/27/98	947-947-3000	226.19	AUG 98, A#60605581, TASK FORCE
FEDERAL EXPRESS CORP	279572	08/27/98	947-947-3000	20.50	INV 4-627-30896, A#1320-2477-4, TASK FORCE
MARY RODRIGUEZ	279352	08/20/98	947-947-4231	10.14	JUN 28-AUG 19, EXP REIMB, TASK FORCE
JOE BAXTER	279373	08/25/98	947-947-4231	22.54	AUG 11-18, EXP REIMB, TASK FORCE
PUBLIC AGENCY TRAINING COUNCIL	279445	08/20/98	947-947-4231	275.00	INV 50993, PO 39774, SEMINAR SEP 28-30, TASK
Total 947-CARADA TASK FORCE 98-99				\$ 3,802.42	
Total Fund Expenditures				\$ 3,808.37	
Less Fund Discounts				0.00	
Less Fund Credits				0.00	
Cash Required 947-CARADA TASK FORCE 98-99				\$ 3,808.37	

Vendor.....	Invoice Id	Inv Date	Account Number	Expense Amount	Description.....
TOTAL Cash Required, ALL FUNDS				\$ 676,923.22	

Approved 9-8-98
John C. Daerfler

AGENDA ITEM # 4**September 8, 1998**

*

Consider noting in minutes any off right-of-way work on any county road done by Road and Bridge Unified System.

Moved: Judge Doerfler

Seconded: Commissioner Mehevec

Motion: To note in minutes utility requests from **General Telephone Company** bore on County Road 481 & Adina Church Road and;

Southwestern Bell Telephone bore on County Roads 419 & 422.

Vote: Motion carried 5 - 0

< Clerk copy here >

WILLIAMSON COUNTY URS

Utility Requests - 09/08/98

Precinct I

Precinct II

Precinct III

Precinct IV

A. GTE

1. CR 481 & Adina Church Rd. - Bore

B. SWBT

1. CR 419 & CR 422 - Bore

*noted 9-8-98
John C. Doerfler*

NOTICE OF PROPOSED INSTALLATION

UTILITY LINE ON WILLIAMSON COUNTY RIGHT-OF-WAY

TO: Williamson County Unified Road System
1900 Georgetown Inner Loop, Suite B
Georgetown, Texas 78626

DATE: 20 JULY 98Formal notice is hereby given that GTECompany proposes to place a BURIED COPPERline within the right-of-way of CR 481 & ADINA CHURCH Rd.
as follows: (give location, length, general design, etc.)

BEGINNING AT STA. 0+00 A BURIED LINE TO BE PLACED
6' INSIDE NORTH ROW FOR 2806' TO STA. 28+06.
THAN 1560' ALONG ADINA CHURCH Rd.
END OF CONST. CABLE TO BE PLACED 30" DEEP.

The line will be constructed and maintained on the road right-of-way as directed by the Williamson County Unified Road System in accordance with governing laws.

Our firm further understands that the County considers proper traffic control measures as those complying with applicable portions of the Texas Manual of Traffic Control Devices required for adoption by the "Transportation Code" (V.C.T.A. CH.251)

The location and description of the proposed line and appurtenances is more fully shown by _____ copies of drawings attached to this notice.

Construction of this line is proposed to begin on or after the 1 day of AUG. 19 98APPROVAL

This application is hereby approved subject to the following understandings and restrictions.

It is expressly understood that the said County Commissioners' Court does not imply hereby to grant any right, claim, title or easement in or upon this County Road; and it is further understood that in the future, should Williamson County, for any reason, need to work, improve, relocate, widen, increase, add to, decrease, or in any manner change the structure of this road or right-of-way, this line, if affected, will be moved at the direction of the Williamson County Engineer or County Commissioner. This installation work shall not damage any part of the roadway and adequate provisions shall be made to cause a minimum of inconvenience to traffic and adjacent property owners.

APPROVED BY WILLIAMSON COUNTY COMMISSIONERS' COURT

BY: [Signature]
COUNTY ROAD ADMINISTRATORDATE: 9/8/98Firm: GTE

Authorized Signature

JIMMIE VACLAVIK
Printed NameAddress: 1700 N. AUSTIN AVE.GEORGETOWN, TEXAS 78626Phone: 512-869-2234Fax: 512-869-2291pd. 49-4-98Base & ROWRJ.

STA. 0+00

STA. 5+25

STA. 5+65

STA. 28+06

EXISTING CABLE 3'

TREE TO
BE BORED

NEW CABLE TO BE 6' IN R.O.W.

STA. 0+00

BORE 50'

STA. 0+50

BURIED CABLE TO BE PLACED
36" DEEP & IN ROW

STA. 15+60

ADAINA CHURCH RD.

C R 481

27

RECORDERS MEMORANDUM
All or parts of the text on this page was not
clearly legible for satisfactory recordation.

BURIED CABLE PERMIT
FOR MORE INFORMATION
CONTACT ANTHONY
AT 512-869-2290

NOTICE OF PROPOSED INSTALLATION

UTILITY LINE ON WILLIAMSON COUNTY RIGHT-OF-WAY

TO: Williamson County Unified Road System
1900 Georgetown Inner Loop, Suite B
Georgetown, Texas 78626

DATE: 7-22-98
4583562

Formal notice is hereby given that SOUTHWESTERN BELL

Company proposes to place a COPPER COMMUNICATIONS CABLE

line within the right-of-way of CR 419 AND CR 422

as follows: (give location, length, general design, etc.)

BEGINNING AT INTERSECTION OF CR 419 AND CR 422
BORE CR 419 30' AND PLACE CABLE IN 3' RUC UNDER
CR 419 AND ALONG ROW OF CR 422 FOR A DISTANCE OF 30'

The line will be constructed and maintained on the road right-of-way as directed by the Williamson County Unified Road System in accordance with governing laws.

Our firm further understands that the County considers proper traffic control measures as those complying with applicable portions of the Texas Manual of Traffic Control Devices required for adoption by the "Transportation Code" (V.C.T.A. CH.251)

The location and description of the proposed line and appurtenances is more fully shown by 3 copies of drawings attached to this notice.

Construction of this line is proposed to begin on or after the 27 day of JULY 1998.

APPROVAL

This application is hereby approved subject to the following understandings and restrictions.

It is expressly understood that the said County Commissioners' Court does not imply hereby to grant any right, claim, title or easement in or upon this County Road; and it is further understood that in the future, should Williamson County, for any reason, need to work, improve, relocate, widen, increase, add to, decrease, or in any manner change the structure of this road or right-of-way, this line, if affected, will be moved at the direction of the Williamson County Engineer or County Commissioner. This installation work shall not damage any part of the roadway and adequate provisions shall be made to cause a minimum of inconvenience to traffic and adjacent property owners.

APPROVED BY WILLIAMSON COUNTY COMMISSIONERS' COURT

BY: My Peyer
COUNTY ROAD ADMINISTRATOR

DATE: 9/8/98

Firm: SOUTHWESTERN BELL

Lester J. Kothmann
Authorized Signature

LESTER KOTHMANN

Printed Name

Address: 117 N 1ST ST.

TEMPLE TX

Phone: 254-773-8502

Fax: 254-773-8574

Pct. 4

9-3-98

Bore

received
9-3-98

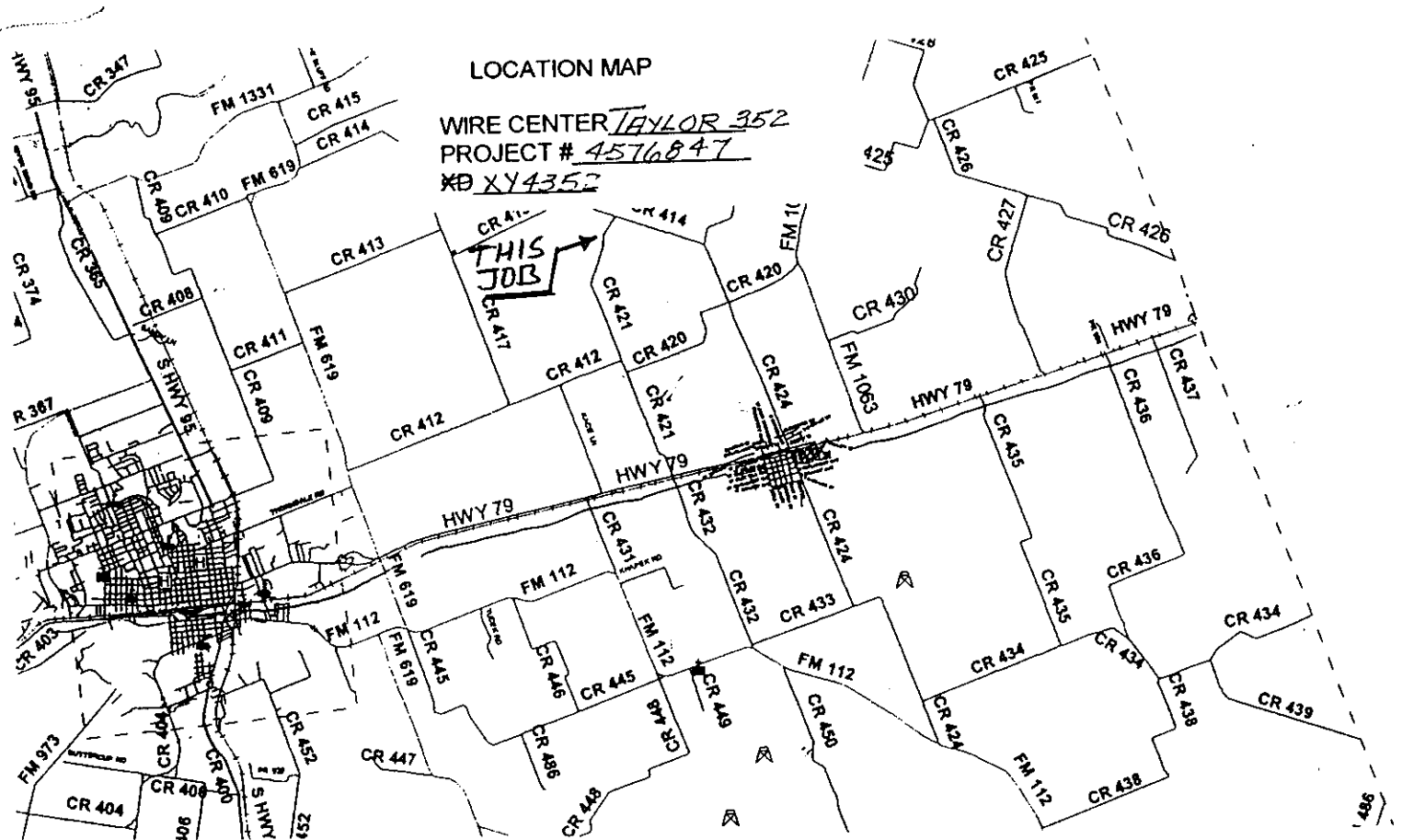

RECORDERS MEMORANDUM
All or parts of the text on this page was not
clearly legible for satisfactory recordation.

All or parts of the text on this page was not clearly legible for satisfactory recordation.

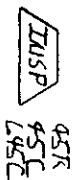
[illegible]

360°

PROPOSED LCOP			
GA	LGTH	OHMS	dB
72	4.2	137	1.4
24	6.4	332	2.8
26	1.1	91	.6
<hr/>		560	4.8

JOE MILLER PAGE 431

VOL 0099 PAGE 827

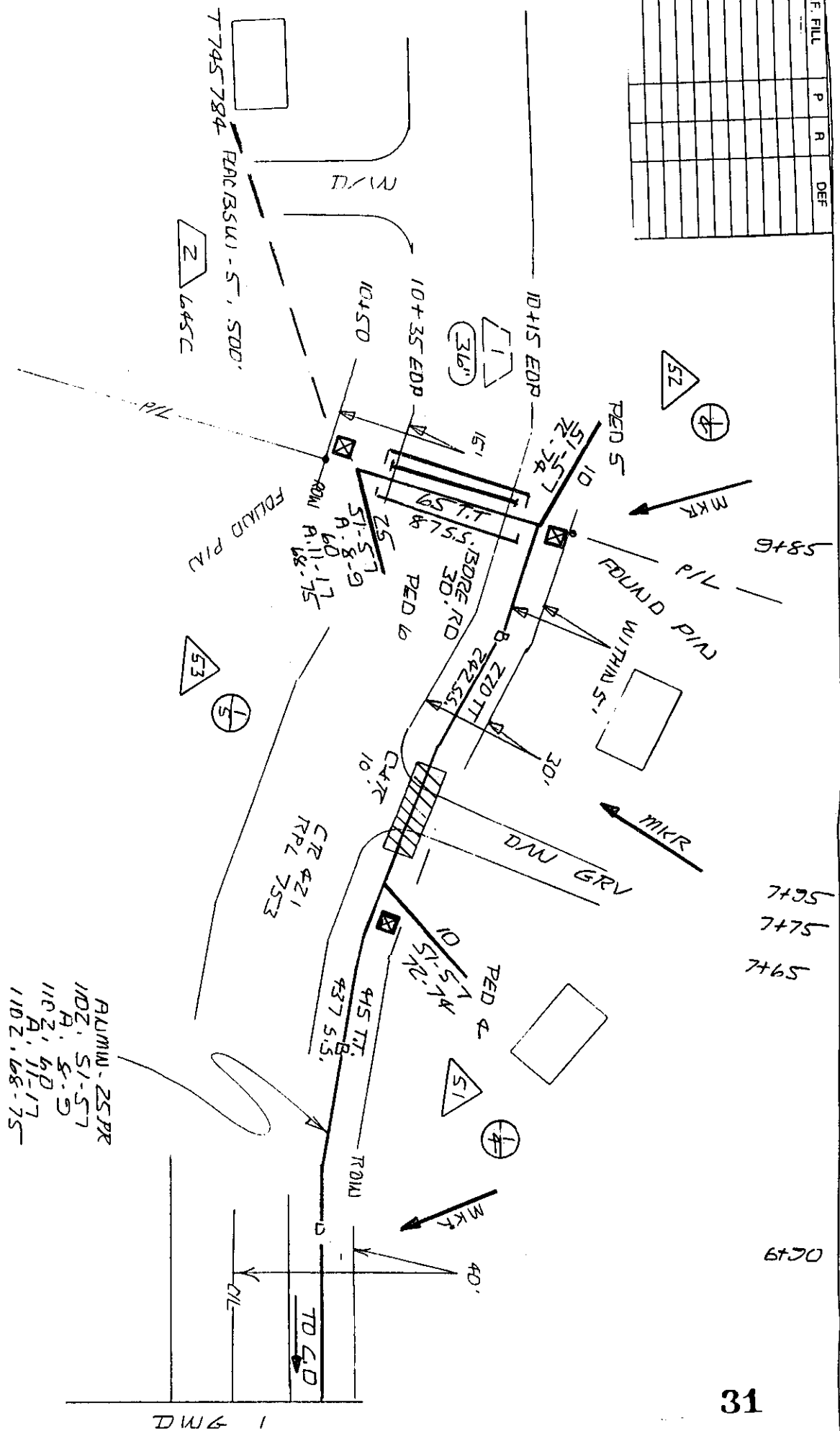
[illegible]

31

SPECIAL CIRCUITS 6203 FORWARDED	✓	
PERMIT REQUIRED	✓	
OPERATING RANGE OF JOB STEPS		NORTH ARROW
LINE	1 TO 2	
SPD	51 TO 53	
WRC 452		
TRANSMISSION ZONE		
RZ	C22	TAPER CODE 2755022
CAUTION HIGH VOLTAGE		
W	WERN	BURED
POLE CONTACTS (+) (-)		
PWR CD		
NOTES		
ORDER NO. 4576847		
TOTPRINTS	2	PRINT NO. 2
C.O. 512-352		
DGLT7A3LDR		
TAX. DIST. W/K	026	
CEO LOC.	X94352	
DGR LK		DRYAN ✓
TELEPHONE NO.	(24) 773-857	
REC. RT.	17PL	753
WAP RT.		
SCALE	NONE	
DATE INT.		
DATE REV.		
JOB TIME		14.42

AGENDA ITEM # 5**September 8, 1998**

*

Consider granting final plat approval to Sutton Subdivision (A re-subdivision of Anderson Mill West, Section Nine-A).

Mark Kronkosky of the office of the County Engineer advised the majority of this subdivision is located within the city limits of City of Cedar Park which has approved the subdivision. Hatch Street is built as a curb and guttered street with 60' right-of-way noted on plat.

Moved: Commissioner Boatright

Seconded: Judge Doerfler

Motion: To grant final plat approval to Sutton Subdivision which is a re-subdivision of Anderson Mill West, Section Nine-A.

Vote: Motion carried 5 - 0

AGENDA ITEM # 6**September 8, 1998**

*

Consider granting final plat approval to State Farm Subdivision, Section Two.

Mark Kronkosky of the office of the County Engineer advised the City of Austin has approved this plat.

Jim Gallegos of Bury Pittman, Inc. Engineers advised the City of Austin signed the plat this morning and he has a check for scanning fees and letter from the owner in hand. This plat is a reduction of 7 lots to 4. The property is located within the North Austin Municipal Utility District as well as the extra territorial jurisdiction of the City of Austin.

Commissioner Heiligenstein asked if street name changes were involved. Mr. Gallegos advised Amberoaks Boulevard has been changed to Amberglen Boulevard with Travis County 911 addressing. Shannon Hicks from Williamson County 911 addressing stated she had not seen the plat but had talked to Travis County 911 and had no problem with the name change.

Adjustments have been made along the west side of the property providing drainage improvements to adjoining property owners advised Mr. Gallegos.

Moved: Commissioner Heiligenstein

Seconded: Commissioner Boatright

Motion: To grant final plat approval to State Farm Subdivision, Section Two.

Vote: Motion carried 4 - 0 with Commissioner Hays absent from the dais.

AGENDA ITEM # 7**September 8, 1998**

*

32

Consider granting final plat approval to RRISD Commercial.

Mark Kronkosky of the office of the County Engineer advised this 2 lot subdivision has letter from Brushy Creek Municipal Utility District for water and sewer service to the Primrose School which is to be located on Lot 1. The property is located within the extra territorial jurisdiction of the City of Round Rock.

Commissioner Heiligenstein asked what the office of the County Engineer is doing for driveway requests for other public entities such as this one. Mr. Kronkosky advised the County Engineer requests up to 100 feet and beyond that usually follows the lead of the city in which the subdivision is located.

Commissioner Heiligenstein explained if proposed State Highway 45 should be routed through this area, insufficient available right-of-way could cause re-routing of State Highway 45.

Commissioner Hays advised we have no knowledge of the future plans of the school for the balance of their property in this area and suggested another 150' of right-of-way.

Commissioner Heiligenstein requested Mark Kronkosky approach TxDOT for information on State Highway 45 - where they are in the process, how much right-of-way will be needed plus utilities and any other pertinent information he could obtain.

Commissioner Hays suggested contacting the Turnpike Committee for additional information and table this item until the meeting of September 29, 1998.

No action was taken on this agenda item.

AGENDA ITEM # 8

September 8, 1998

Consider granting variance of centerline radius for White Rock Estate, Phase One.

Don Bizzell of Steger and Bizzell Engineering advised White Rock Estates, Phase One is located within the extra territorial jurisdiction of the City of Georgetown which has approved the engineering concept plan and preliminary and final plat of Phase One.

The 250' centerline radius requirement of the City of Georgetown is 50' less than the Williamson County 300' requirement. Therefore, the request for a variance from the 30 mile per hour design requirement for Mulberry Drive, to allow for centerline radii of 250 feet.

Moved: Commissioner Hays

Seconded: Commissioner Boatright

Motion: To grant variance of centerline radius for White Rock Estates, Phase One.

Vote: Motion carried 5 - 0

< Clerk copy here >

09-03-1998 10:04AM

STEGER & BIZZELL ENG. INC

512 930 9416

P.02



Steger & Bizzell Engineering, Inc.
Consulting Engineers

Surveyors

1973 South Austin Avenue

Telephone: (512) 930-9416
Facsimile: (512) 930-9416

September 3, 1998

Mr. Joe England, P.E.
County Engineer, Williamson County
1900 Georgetown Inner Loop, Suite B
Georgetown, TX 78626

RE: White Rock Estates, Phase One

33

Dear Mr. England:

Regarding the curve radii for the above-referenced subdivision, on behalf of the owner, we are requesting a variance from the 30 miles per hour design requirement for Mulberry Drive, to allow for centerline radii of 250 feet, as approved by the City of Georgetown.

If you should have any questions, please give me a call.

Respectfully,

Richard Fink

approved 9-8-98
John C. Daehler