

Consider noting in minutes any off right-of-way work on any county road done by Road and Bridge Unified System, or any road cuts.

Moved: Commissioner Mehevec

Seconded: Commissioner Boatright

Motion: To note off right-of-way work on **Wallace Seggren** property cleaning willow trees;

and to note the following utility requests from

City of Austin road cut McNeil Road and Pecan Street;

Central Telephone Company of Texas buried communication on County Roads 220 & 222;

General Telephone & Electronics Company buried communication on County Roads 105, 313 & 472; and

Lone Star Gas Company road cut Great Oaks and Racine

Vote: Motion carried 4 - 0 with Commissioner Heiligenstein absent from the dais

< Clerk copy here - Utility Proposals >

WILLIAMSON COUNTY URS

Utility Requests - 08/26/97

Precinct I

A. City of Austin

1. McNeil Road - Road cut

Precinct II

Precinct III

A. Central Telephone Company of Texas

1. CR 220 - Bore & ROW

B. Central Telephone Company of Texas

1. CR 222 - ROW

C. GTE

1. CR 313 - Road cut

2. CR 105 - Bore & ROW

D. Lone Star Gas

1. Great Oaks @ Racine - Road Cut

Precinct IV

A. GTE

1. CR 472 - ROW

*noted 8-26-97
John C. Daehler*

August 26, 1997

UNIFIED ROAD SYSTEM
OFF RIGHT-OF-WAY WORK

1. CR 368 - Cleaning willow trees on the Wallace Seggern property from the channel downstream at the new bridge.(Pct. 4-GB)

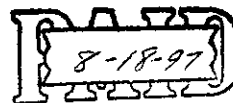

8/18/97
city receipt # 334

GREG BERGERON
COUNTY ROAD ADMINISTRATOR



1900 Georgetown Inner Loop, Suite B
Georgetown, Texas 78626
Telephone (512) 930-3330
Fax (512) 930-3335

Williamson County
Unified Road System

UTILITY INSTALLATION REQUEST

DATE: August 18, 1997

TO: Williamson County Commissioners' Court
c/o County Engineer, County Road Administrator or County Commissioner

Formal notice is hereby given that City of Austin W+WW proposes to place
an 8-inch sewer line within the right-of-way of McNeil
and Pecan St. County Road as follows:
99.5 linear feet of 8-inch sewer line from the intersection of
McNeil and Pecan St, and the length of Pecan St.

The location and description of the proposed line and appurtenances is more
fully shown on the drawing attached hereto. The line will be constructed &
maintained on the County right-of-way in accordance with current Williamson
County Specifications as directed by the County Engineer, County Road
Administrator or County Commissioner.

Construction will begin on or after the 13th day of August 1997, and
is estimated to be completed in 45 calendar days.

SUBMITTED BY FIRM: City of Austin, Water & Wastewater Utility - Rehab AUTHORIZED

SIGNATURE: [Signature] PRINTED NAME: LISA E. SANCHEZ

TITLE: ENGR. TECH FIRM ADDRESS: 6301 Harold Court, Austin TX 78721

PHONE # 927-4380 Bid B

CONTRACTOR (IF DIFFERENT FROM FIRM): SAME AS ABOVE

AUTHORIZED SIGNATURE: _____ PRINTED NAME: _____

TITLE: _____ ADDRESS: _____

PHONE # _____

Precinct #: 1

APPROVAL

This application is hereby approved subject to the following understandings and restrictions.

It is expressly understood that the said County Commissioners' Court does not imply hereby
to grant any right, claim, title or easement in or upon this County Road; and it is further
understood that in the future, should Williamson County, for any reason, need to work,
improve, relocate, widen, increase, add to, decrease, or in any manner change the structure
of this road or right-of-way, this line, if affected, will be moved at the direction of the
Williamson County Engineer or County Commissioner. This installation work shall not damage
any part of the roadway and adequate provisions shall be made to cause a minimum of
inconvenience to traffic and adjacent property owners.

APPROVED BY WILLIAMSON COUNTY COMMISSIONERS' COURT

BY: [Signature]
COUNTY ROAD ADMINISTRATOR

DATE: 8/20/97

GREG BERGERON
County Road Administrator



1900 Georgetown Loop, Ste. B
Georgetown, Texas 78626
Telephone (512) 930-3330
Fax (512) 930-3335

**Williamson County
Unified Road System**

When specifically agreed to in writing and signed by a Williamson County Commissioner, or the County Road Administrator, Williamson County will permit the cutting of a roadbed in lieu of core drilling, provided the contractor or contractors agree to the following installation:

SPECIFICATION FOR CUTTING ROADBED IN LIEU OF CORE DRILLING

1. Compacted base material with concrete cap.
2. The utility shall be placed a minimum of 30" below the flow line.
3. Layer compacted and topped with 3" hot mix asphalt.
4. A performance bond, or other securities agreed upon by the County, must be pledged in the amount of the estimated cost of the road repairs, as agreed to by the contractor and Williamson County, prior to the commencing of a cutting of the roadbed.
5. A road cut permit fee, in the amount of \$120.00 per roadbed cut, must be submitted to the County Road Administrator's office prior to cutting the roadbed.

**SPECIFICATION FOR CUTTING ROADBED IN LIEU OF CORE DRILLING
WITHIN AUSTIN ETJ**

1. Roadbed cuts to be repaired in accordance with City of Austin specifications as outlined in their standard Specifications for Cuts in Public Right of Way Manual.
2. The utility shall be placed a minimum of 30" below the flow line.
3. The installation to be free from defects for a period of one (1) year from completion date. Any maintenance required during this period, caused by the cutting of a road, will be done by the contractor or contractors without cost to the County.
4. A performance bond, or other securities agreed upon by the County, must be pledged in the amount of the estimated cost of the road repairs, as agreed to by the contractor and County, prior to the commencing of a cutting of the roadbed.
5. A roadbed cut permit fee, in the amount of \$120.00 per roadbed cut, must be submitted to the County Road Administrator's office prior to cutting the roadbed.

This agreement must be entered into prior to the commencing of the cutting of a roadbed.

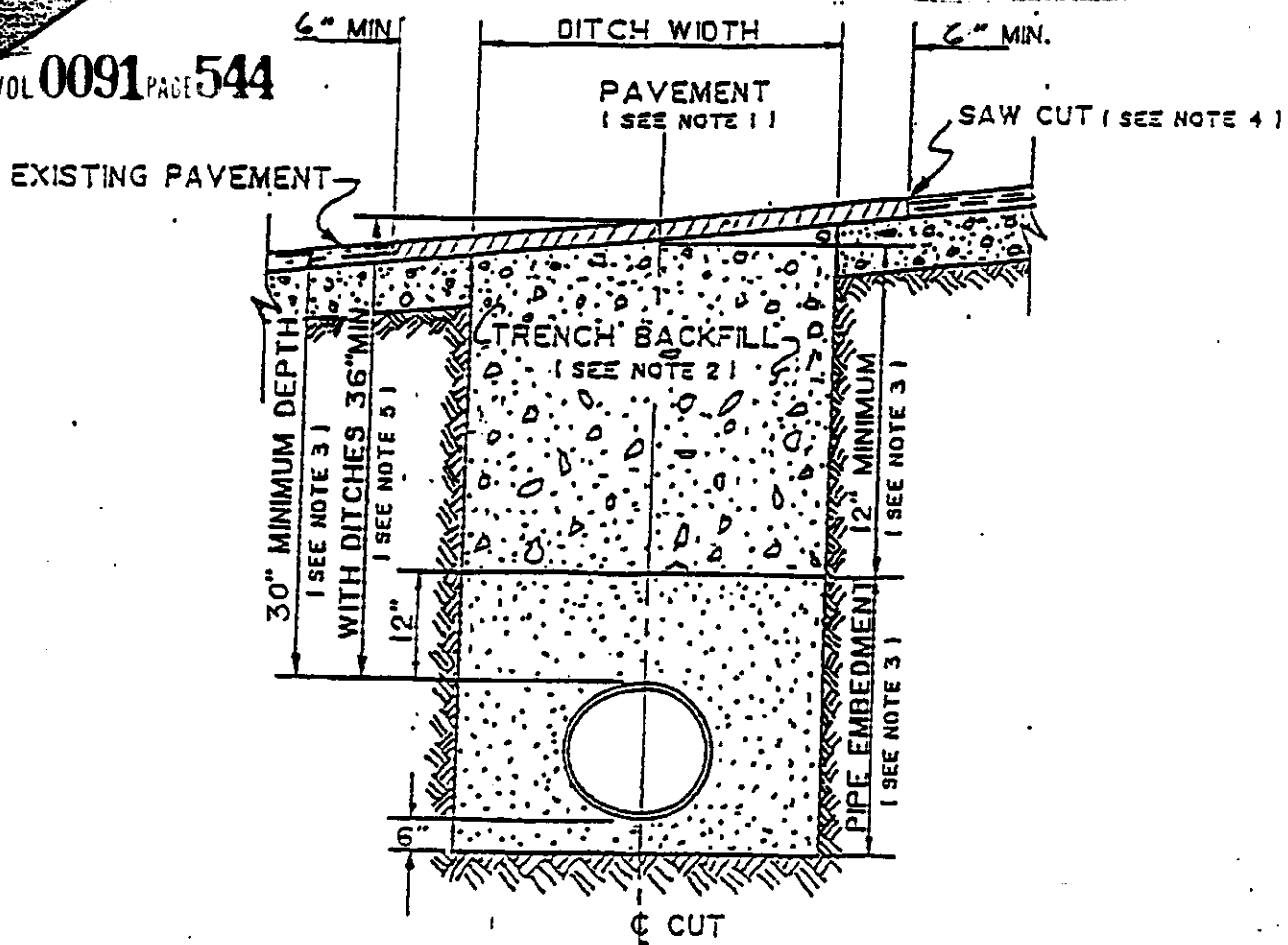

1. Hot mix asphalt 1 1/2" min. thickness. Roll in place to match existing surface. $\pm 1/8"$ tolerance.
2. Trench backfill shall be flexible base, compacted to 95% optimum in 8" layers unless otherwise approved and specified. Flexible base to match existing base thickness or 8 inches, whichever is greater (specifications: TSHD Item 248, Type A, Grade 2).
3. Pipe embedment (pipe envelope) size and materials shall be as specified elsewhere by the utility company and/or its engineers. Pipe depth shall be as specified elsewhere provided minimum depths are met.
4. Saw cut shall be made prior to ditch cut. If pavement is damaged during cut, a new saw cut shall be made beyond the damaged area and new pavement placed.
5. Where roadside ditches (bar ditches) are crossed by the utility pipe, minimum depth to the top of the pipe from centerline road elevation will be 36".

36177705.

GREG BERGERON
County Road Administrator

Received
8-13-97

VOL 0091 PAGE 545

1900 Georgetown Inner Loop, Suite B
Georgetown, Texas 78626
Telephone (512) 930-3330
Fax (512) 930-3335

Williamson County
Unified Road System

UTILITY INSTALLATION REQUEST

DATE: August 13, 1997

TO: Williamson County Commissioners' Court c/o County Engineer or County Commissioner

Formal notice is hereby given that Central Telephone Company of Texas proposes to place a buried communication within the right-of-way of County Road 220 as follows:

Beginning approximately 5,000 feet from the intersection of CR 226 & CR 220 from the south right-of-way by boring at 36 inches for 30 feet to the north right-of-way continuing west at a depth of 30 inches and at a distance of 3 feet from the rear of the right-of-way for 230 feet then continuing from the beginning point in north right-of-way continuing east at a depth of 30 inches and at a distance of 3 feet from the rear of the right-of-way for 770 feet.

The location and description of the proposed line and appurtenances is more fully shown on the drawing attached hereto. The line will be constructed & maintained on the County right-of-way in accordance with current Williamson County Specifications as directed by the County Engineer or County Commissioner.

Construction will begin on or after the 3rd day of September, 1997, and is estimated to be completed in 2 calendar days.

SUBMITTED BY FIRM: Central Telephone Company of Texas AUTHORIZED
SIGNATURE: Ken Chester Ken Chester TITLE: Network Engineer
FIRM ADDRESS: 1214 Dogwood, P.O. Box 1150, Killeen, TX 76540 PHONE # 817-690-9325
CONTRACTOR (IF DIFFERENT FROM FIRM:)
AUTHORIZED SIGNATURE: TITLE:
ADDRESS: PHONE #

Precinct # 3

APPROVAL

The application is hereby approved subject to the following understandings and restrictions.

It is expressly understood that the said County Commissioners' Court does not imply hereby to grant any right, claim, title or easement in or upon this County Road; and it is further understood that in the future, should Williamson County, for any reason, need to work, improve, relocate, widen, increase, add to, decrease, or in any manner change the structure of this road or right-of-way, this line, if affected, will be moved at the direction of the Williamson County Engineer or County Commissioner. This installation work shall not damage any part of the roadway and adequate provisions shall be made to cause a minimum of inconvenience to traffic and adjacent property owners.

APPROVED BY WILLIAMSON COUNTY COMMISSIONERS' COURT

BY: [Signature]
COUNTY ROAD ADMINISTRATOR

DATE: 8/19/97

55

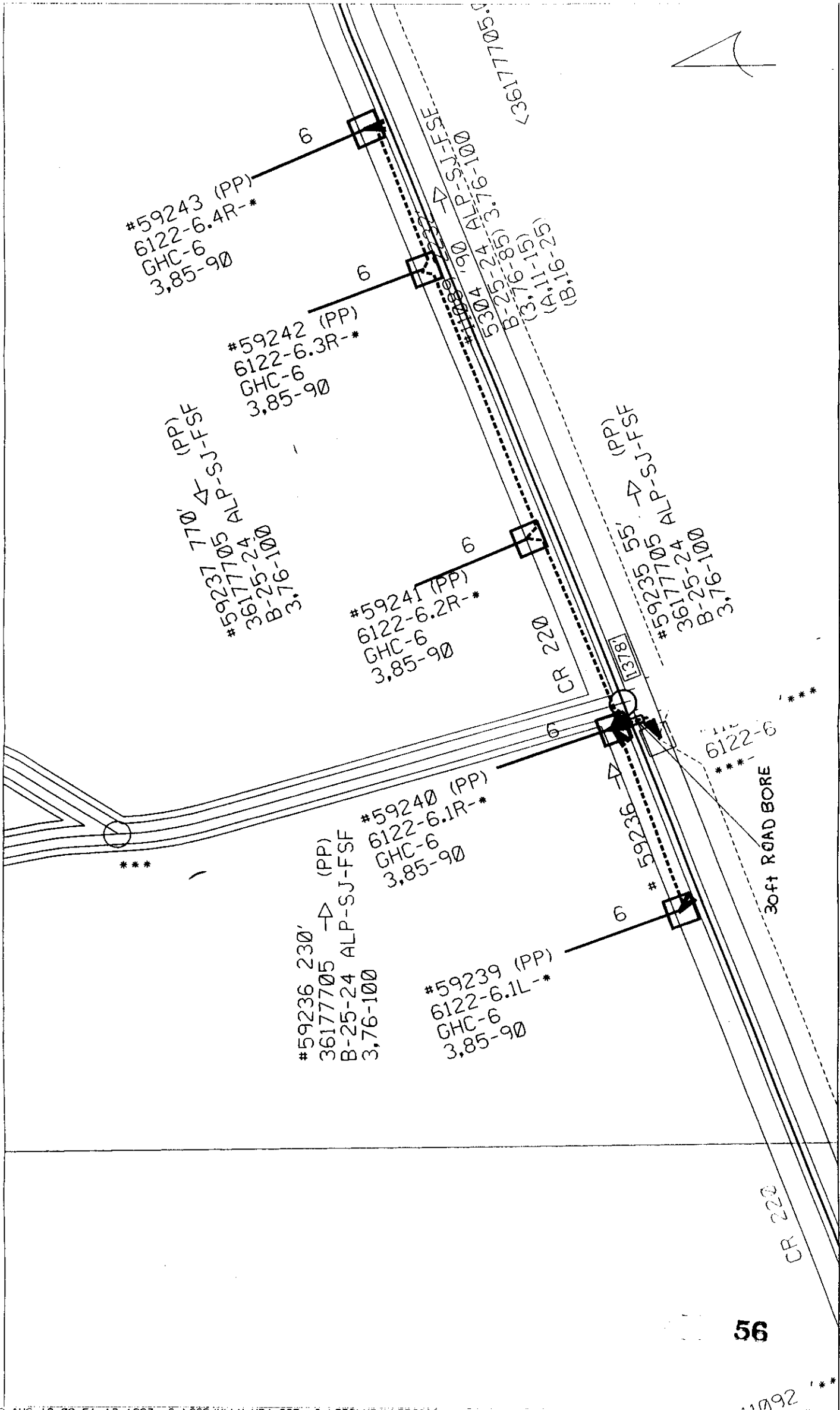

Company Code 36	Store TX	Exch FLRNTX	Title DSO-N707220/ACEVEDO	T.O.	Engineer KEC3	T.O.	T.O.	T.O.	T.O.	T.O.	T.O.
SHEET 2 OF 4	Scale 1"=100'	WORK ORDER 36177705									

United Telephone
A SPRINT COMPANY

56

1092

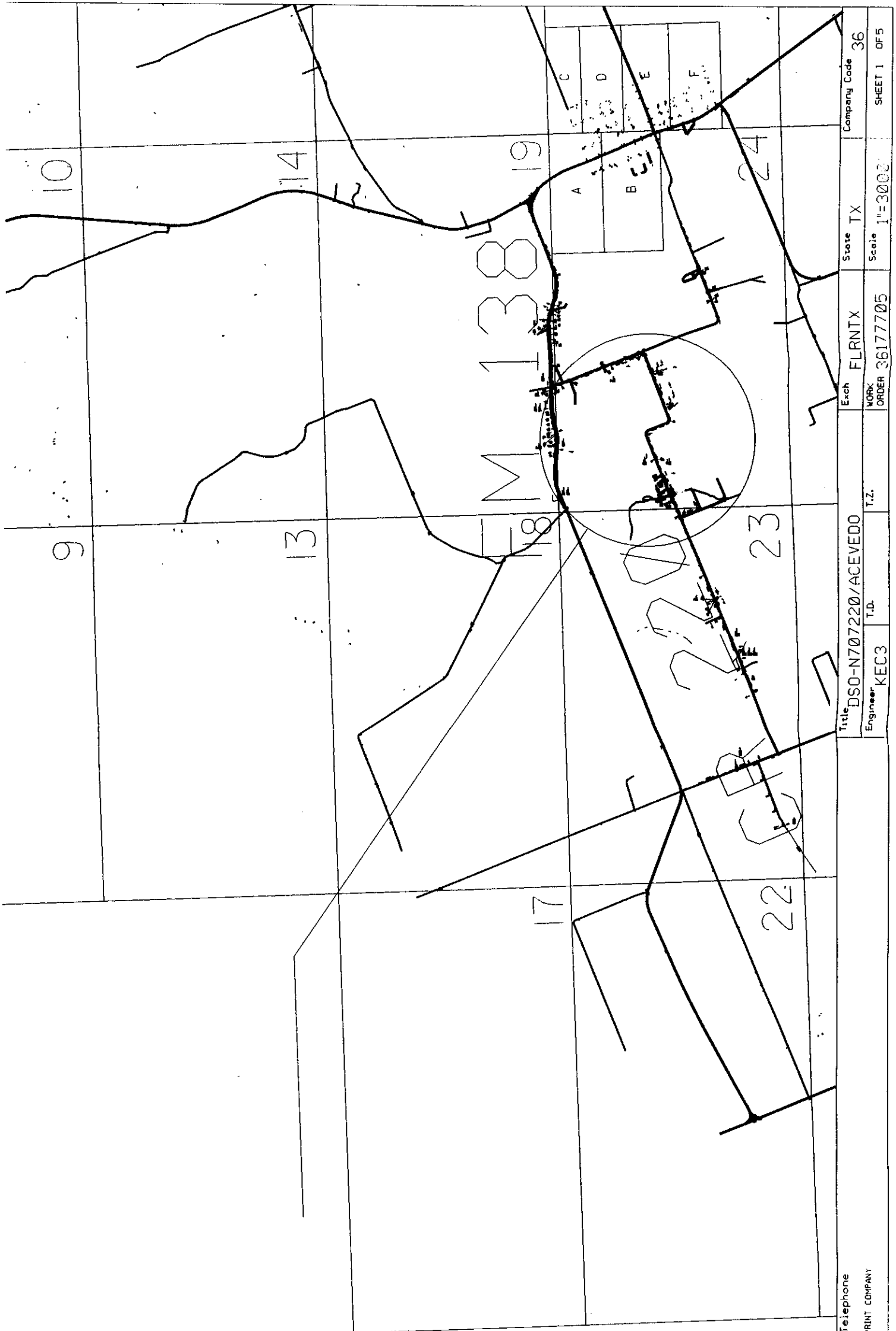

GREG BERGERON
County Road Administrator

1900 Georgetown Inner Loop, Suite B
Georgetown, Texas 78626
Telephone (512) 930-3330
Fax (512) 930-3335

Williamson County
Unified Road System

UTILITY INSTALLATION REQUEST

DATE: August 11, 1997
TO: Williamson County Commissioners' Court c/o County Engineer or County Commissioner

Formal notice is hereby given that Central Telephone Company of Texas proposes to place a buried communication within the right-of-way of County Road 222 as follows:

Beginning at the intersection of Hwy. 138 and CR 222 continuing north in the west right-of-way at a depth of 30 inches for 1,065 feet then continuing by boring for a distance of 40 feet at a depth of 36 inches to clear an Oak tree in the right-of-way then continuing for 1,250 feet at a depth of 30 inches at either 4 feet from the rear of the right-of-way or in the lowest point of the right-of-way.

The location and description of the proposed line and appurtenances is more fully shown on the drawing attached hereto. The line will be constructed & maintained on the County right-of-way in accordance with current Williamson County Specifications as directed by the County Engineer or County Commissioner.

Construction will begin on or after the 28th day of August, 1997, and is estimated to be completed in 2 calendar days.

SUBMITTED BY FIRM: Central Telephone Company of Texas AUTHORIZED
SIGNATURE: Ken Chester Ken Chester TITLE: Network Engineer
FIRM ADDRESS: 1214 Dogwood, P.O. Box 1150, Killeen, TX 76540 PHONE # 817-690-9325
CONTRACTOR (IF DIFFERENT FROM FIRM:)
AUTHORIZED SIGNATURE: TITLE:
ADDRESS: PHONE #

Precinct # 5

APPROVAL

The application is hereby approved subject to the following understandings and restrictions.

It is expressly understood that the said County Commissioners' Court does not imply hereby to grant any right, claim, title or easement in or upon this County Road; and it is further understood that in the future, should Williamson County, for any reason, need to work, improve, relocate, widen, increase, add to, decrease, or in any manner change the structure of this road or right-of-way, this line, if affected, will be moved at the direction of the Williamson County Engineer or County Commissioner. This installation work shall not damage any part of the roadway and adequate provisions shall be made to cause a minimum of inconvenience to traffic and adjacent property owners.

APPROVED BY WILLIAMSON COUNTY COMMISSIONERS' COURT

BY: [Signature]
COUNTY ROAD ADMINISTRATOR

DATE: 8/19/97

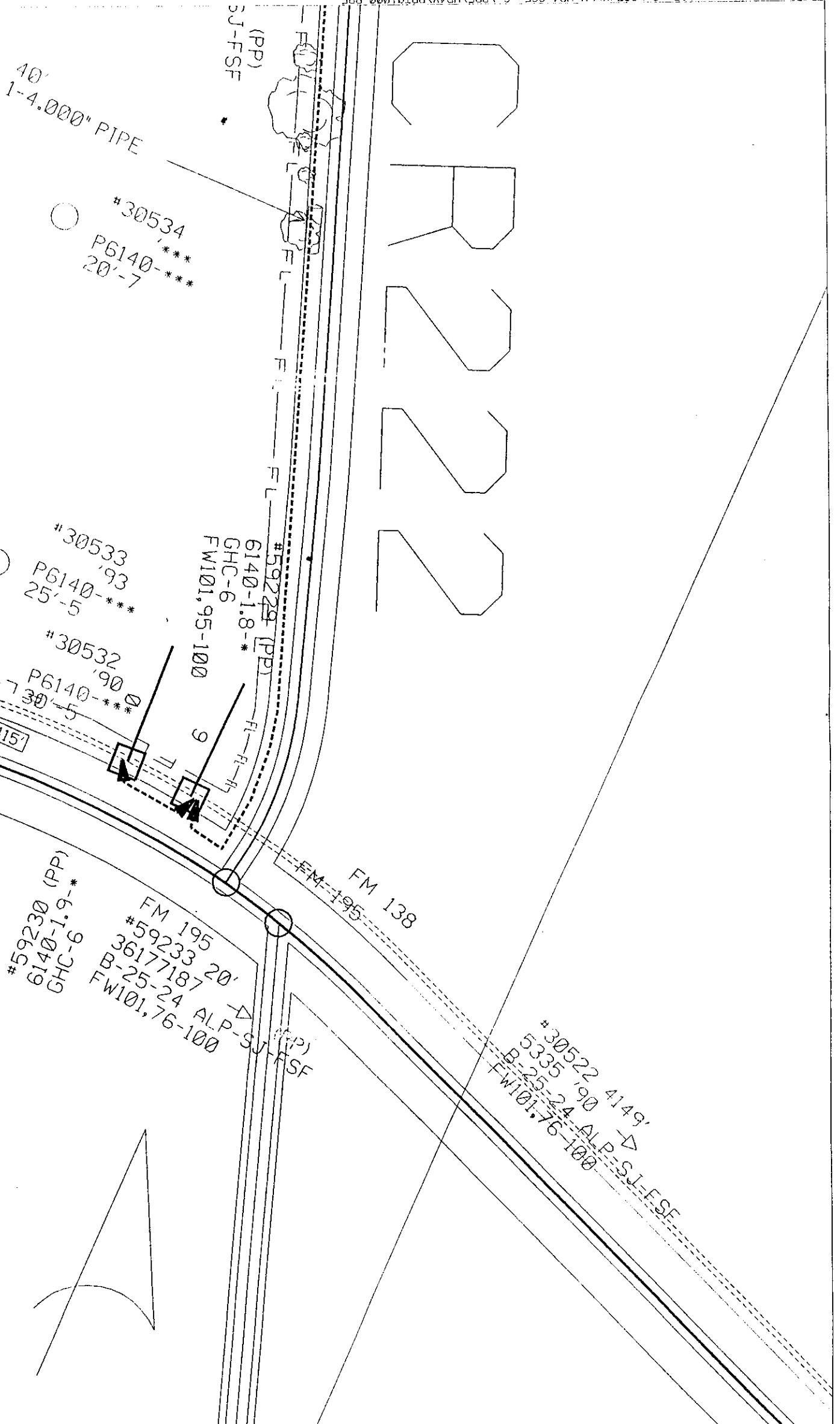
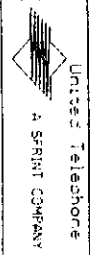

DSO-N707202/N707194	1.0.	1.2.	Even	FLRNTX	State	TX	Company Code	36
ESD-11-11-03			WORK	36177187	Scale	1"=100'	SHEET 2	OF 4

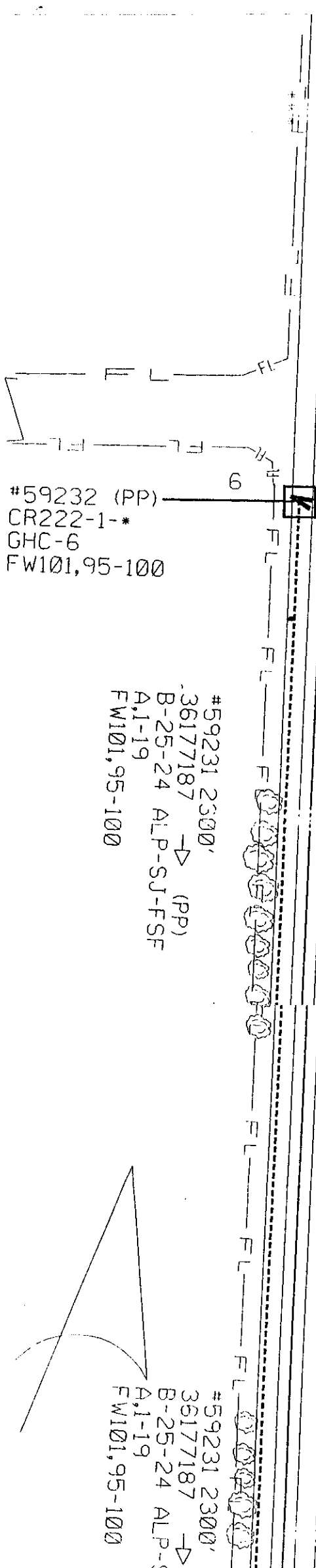

Title	DSC-N707202/N707194	Scale	1"=12'	Sheet	3 OF 4
Engineer	WEC3	Work Order	36177187	Company Code	36

MON AUG 11 10:43:07 1997 G:\OCF\KLLN\HP4\OCF G:\PRF\HP4V\PR100000.PRF

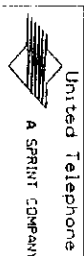

Title		DSO-N707202/N707194	Exch	FLRNTX	State	TX	Company Code	36
Engineer	KEC3	T.D.	T.Z.	WORK	ORDER	36177187	Scale	1"=4000'
								SHEET 1 OF 4

VOL 0091 PAGE 552

received
8-18-97

#9
6102-9P706GR

GREG BERGERON
COUNTY ROAD ADMINISTRATOR



1900 Georgetown Inner Loop, Suite B
Georgetown, Texas 78626
Telephone (512) 930-3330
Fax (512) 930-3335

Williamson County
Unified Road System

UTILITY INSTALLATION REQUEST

DATE: August 7, 1997

TO: Williamson County Commissioners' Court
c/o County Engineer, County Road Administrator or County Commissioner

Formal notice is hereby given that GTE proposes to place a buried Communications line within the right-of-way of CO RD 472 County Road as follows: Begin construction of buried cable on CO RD 472 at GTE STA 0+00 and proceeding in a Northwest direction along the North R.O.W. for a distance of 2500' to GTE STA 25+00. END OF CONSTRUCTION. Cable to be placed 30" deep.

The location and description of the proposed line and appurtenances is more fully shown on the drawing attached hereto. The line will be constructed & maintained on the County right-of-way in accordance with current Williamson County Specifications as directed by the County Engineer, County Road Administrator or County Commissioner.

Construction will begin on or after the 11th day of August 1997, and is estimated to be completed in 30 calendar days.

SUBMITTED BY FIRM: GTE AUTHORIZED SIGNATURE: _____ TITLE: Sr. Designer FIRM ADDRESS: 1700 N. Austin Ave. Georgetown PHONE # 869-2234
CONTRACTOR (IF DIFFERENT FROM FIRM): _____
AUTHORIZED SIGNATURE: _____ TITLE: _____
ADDRESS: _____ PHONE # _____

Precinct #: 4

APPROVAL

This application is hereby approved subject to the following understandings and restrictions.

It is expressly understood that the said County Commissioners' Court does not imply hereby to grant any right, claim, title or easement in or upon this County Road, and it is further understood that in the future, should Williamson County, for any reason, need to work, improve, relocate, widen, increase, add to, decrease, or in any manner change the structure of this road or right-of-way, this line, if affected, will be moved at the direction of the Williamson County Engineer or County Commissioner. This installation work shall not damage any part of the roadway and adequate provisions shall be made to cause a minimum of inconvenience to traffic and adjacent property owners.

APPROVED BY WILLIAMSON COUNTY COMMISSIONERS' COURT

BY: [Signature]
COUNTY ROAD ADMINISTRATOR

DATE: 8/20/97

62

8-20-97

ROW.

4-1

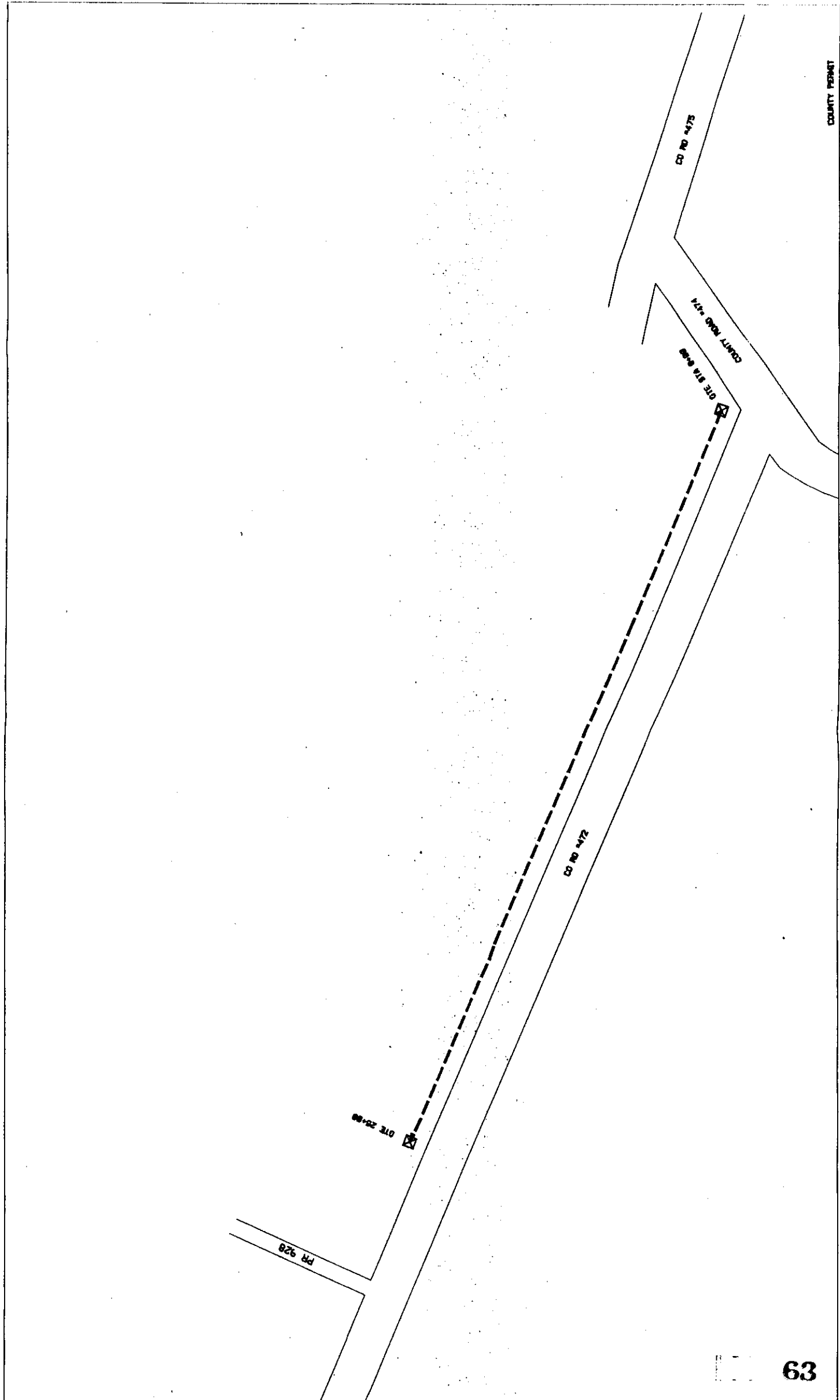

COUNTY PERMIT									
CD	CD	AREA	STATE	TO	CD	CD	CD	CD	CD
DIVISION, TOWN AND RANGE, SECTION AND MERIDIAN									
W-1-A, B, C, D, E, F, G, H, I, J, K, L, M, N, O, P, Q, R, S, T, U, V, W, X, Y, Z									
TITLE, N. OR TO NEW ORANGE, TAC, DIST.									
TAX, DIST.									
DATE, MONTH, DAY, YEAR									
FILE, NAME, NUMBER, SCALE, DIST.									
NOTE AREA									

GREG BERGERON
COUNTY ROAD ADMINISTRATOR



311 Main St.
Georgetown, TX 78626
(512) 930-3330

Williamson County
Unified Road System

UTILITY INSTALLATION REQUEST

DATE: 8/22/97

TO: Williamson County Commissioners' Court
c/o County Engineer, County Road Administrator or County Commissioner

Formal notice is hereby given that GTE proposes to place a BURIED CABLE line within the right-of-way of CR 105 CR 104 & 110 County Road as follows: 600' EAST of INTERSECTION of CR 104 & 110 EASTWARD FROM DISTANCE OF 1300' TO INTERSECTION of CR 100

The location and description of the proposed line and appurtenances is more fully shown on the drawing attached hereto. The line will be constructed & maintained on the County right-of-way in accordance with current Williamson County Specifications as directed by the County Engineer, County Road Administrator or County Commissioner.

Construction will begin on or after the 1 day of Aug 1997, and is estimated to be completed in 90 calendar days.

SUBMITTED BY FIRM: GTE AUTHORIZED
SIGNATURE: Billy A. Shad TITLE: ODT FIRM ADDRESS: 1700 N
Austin Ave, Georgetown TX PHONE # 869-2241
CONTRACTOR (IF DIFFERENT FROM FIRM):
AUTHORIZED SIGNATURE: TITLE:
ADDRESS: PHONE #

APPROVAL

Date: _____

This application is hereby approved subject to the following understandings and restrictions.

It is expressly understood that the said County Commissioners' Court does not imply hereby to grant any right, claim, title or easement in or upon this County Road; and it is further understood that in the future, should Williamson County, for any reason, need to work, improve, relocate, widen, increase, add to, decrease, or in any manner change the structure of this road or right-of-way, this line, if affected, will be moved at the direction of the Williamson County Engineer or County Commissioner. This installation work shall not damage any part of the roadway and adequate provisions shall be made to cause a minimum of inconvenience to traffic and adjacent property owners.

APPROVED BY WILLIAMSON COUNTY COMMISSIONERS' COURT

BY: [Signature] PRECINCT # 3
COMMISSIONER

DATE: 8/22/97

LUARIC L 02

TEXAS GENERAL EXCHANGE TARIFF
 SUPPLEMENT SECTION 6

GEORGETOWN, TEXAS
 Exchange Area Boundary

sed SHEET NO. 90A
 ING 5th Revised SHEET NO. 90A

OSCAR C. GOMEZ
 Resident - Regulatory & Governmental Affairs

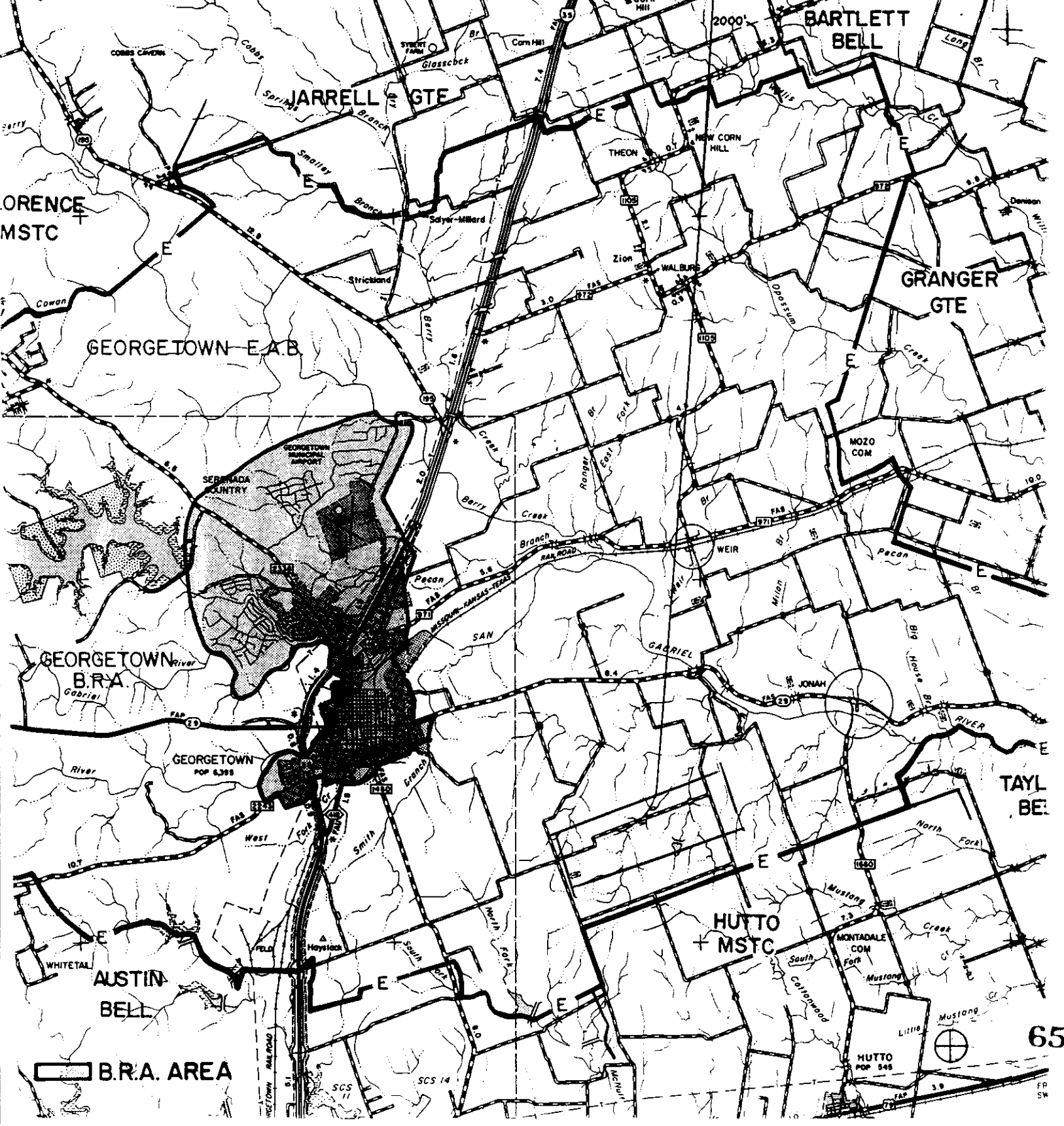

THE AREA—

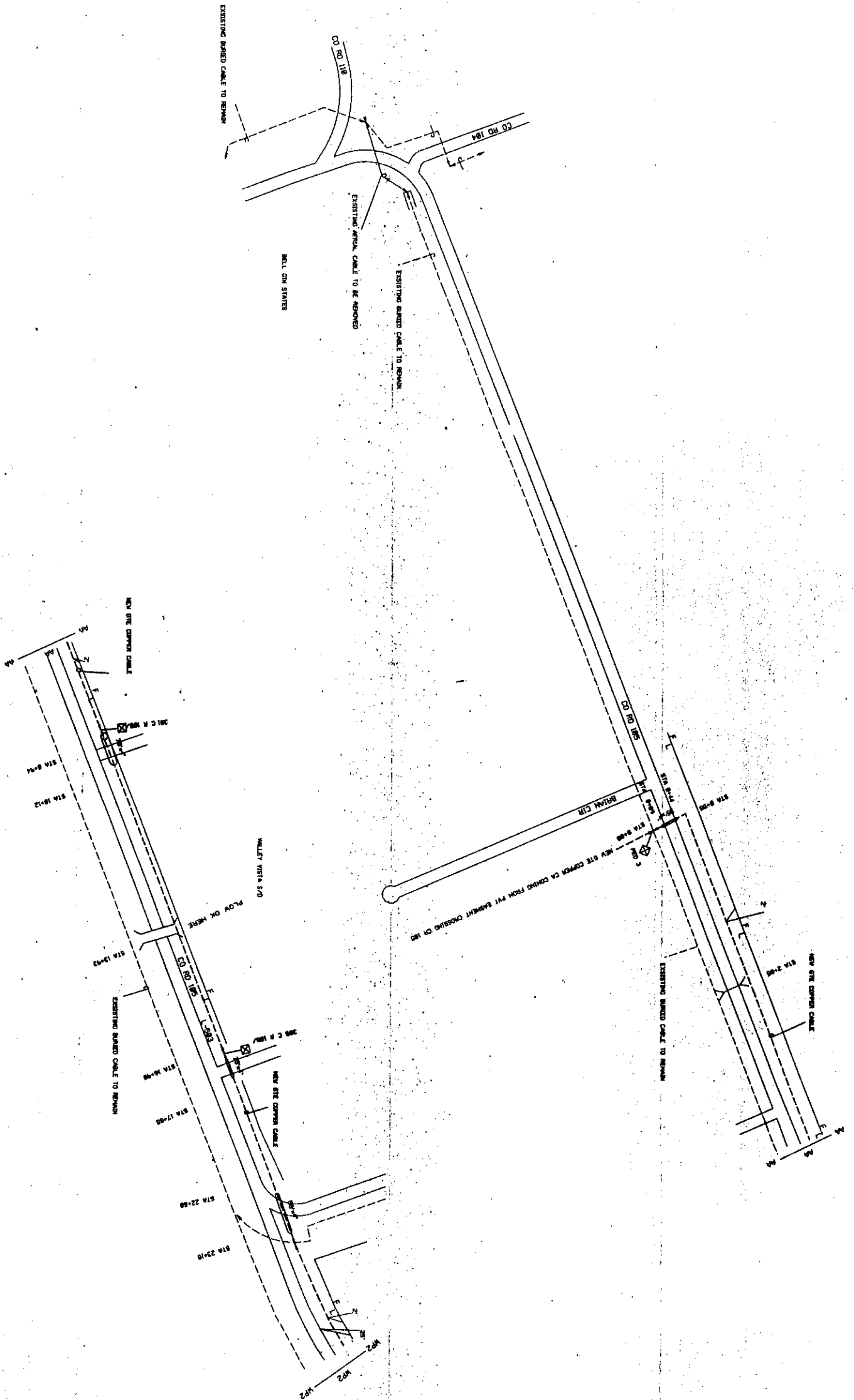

PROJECT		AREA		STATE	
DIVISION		ROADS		TX	
PROJECT NO.		100-1000		100-1000	
TITLE		WATER PUMPING TANK		WATER PUMPING TANK	
DATE		10/1/77		10/1/77	
SCALE		1" = 40'		1" = 40'	
DRAWN BY		JAY		JAY	
CHECKED BY		JAY		JAY	
DATE		10/1/77		10/1/77	

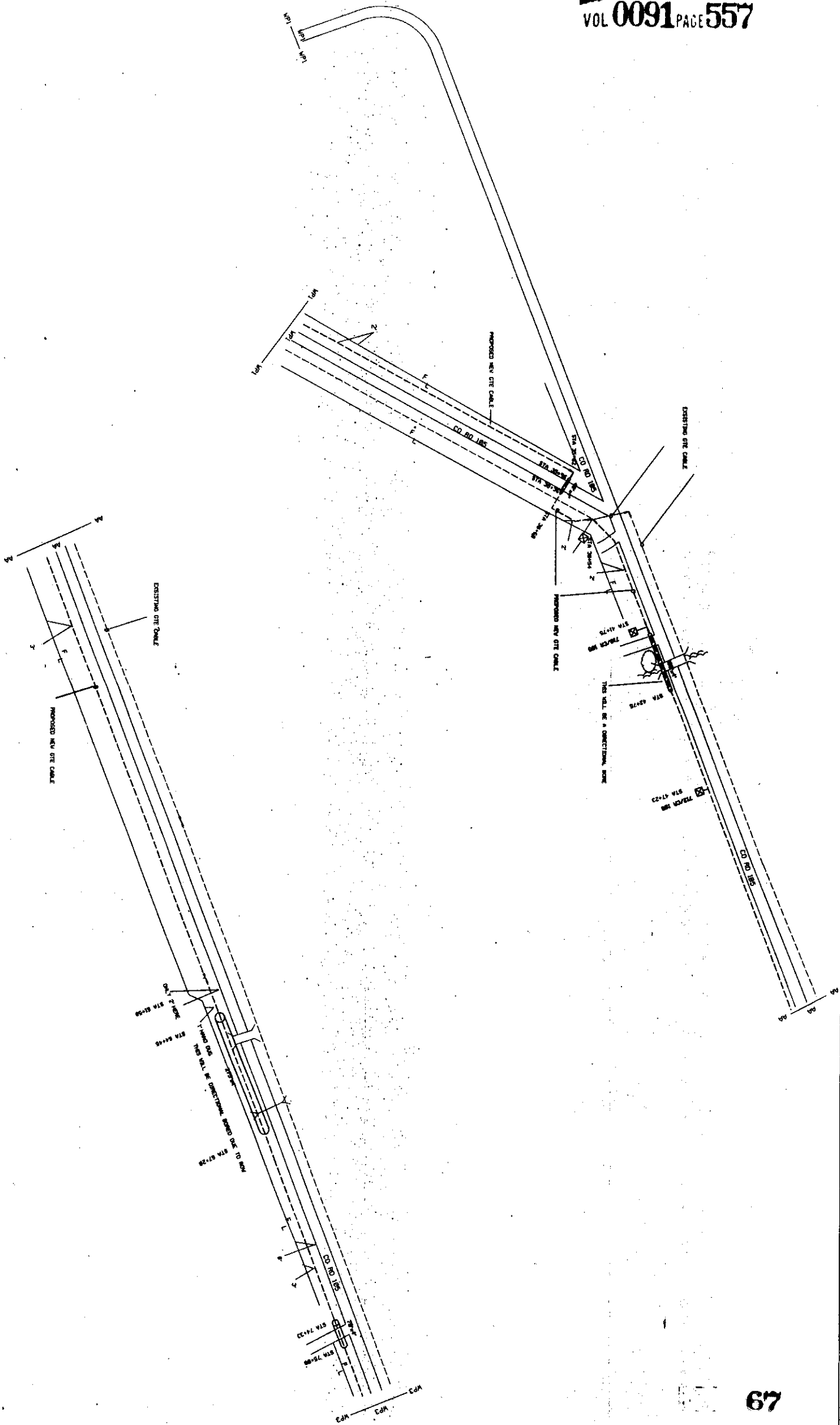
[illegible]

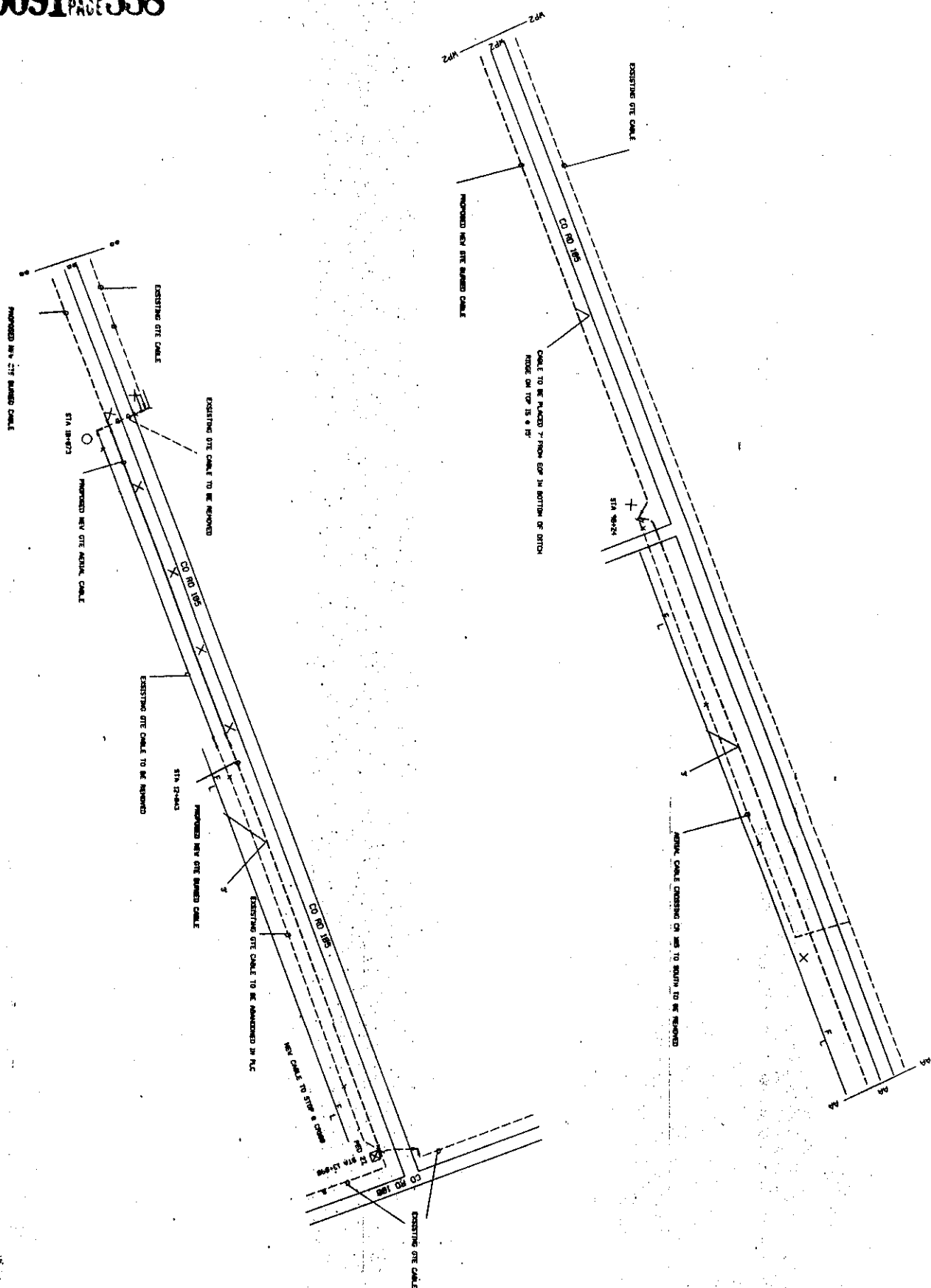

CD	AREA	STATE	TX
DIVISION, TEXAS A&M, BOULDER BRN, COL, 1980			
MCCORMICK AND HIS SISTER			
TITLE	NAME ON REPORT	TAX DIST.	6511
DATE	1984	SECT.	
DATE RECEIVED	REV. DATE	SOL. 2001	
FILE	ORIGIN	DATE	REV. DATE
	BUS	BUS	LTW
			3 OF

GREG BERGERON
County Road Administrator



**Williamson County
Unified Road System**

VOL 0091 PAGE 559

1900 Georgetown Loop, Ste. B
Georgetown, Texas 78626
Telephone (512) 930-3330
Fax (512) 930-3335

When specifically agreed to in writing and signed by a Williamson County Commissioner, or the County Road Administrator, Williamson County will permit the cutting of a roadbed in lieu of core drilling, provided the contractor or contractors agree to the following installation:

SPECIFICATION FOR CUTTING ROADBED IN LIEU OF CORE DRILLING

1. Compacted base material with concrete cap.
2. The utility shall be placed a minimum of 30" below the flow line.
3. Layer compacted and topped with 3" hot mix asphalt.
4. A performance bond, or other securities agreed upon by the County, must be pledged in the amount of the estimated cost of the road repairs, as agreed to by the contractor and Williamson County, prior to the commencing of a cutting of the roadbed.
5. A road cut permit fee, in the amount of \$120.00 per roadbed cut, must be submitted to the County Road Administrator's office prior to cutting the roadbed.

**SPECIFICATION FOR CUTTING ROADBED IN LIEU OF CORE DRILLING
WITHIN AUSTIN ETJ**

1. Roadbed cuts to be repaired in accordance with City of Austin specifications as outlined in their standard Specifications for Cuts in Public Right of Way Manual.
2. The utility shall be placed a minimum of 30" below the flow line.
3. The installation to be free from defects for a period of one (1) year from completion date. Any maintenance required during this period, caused by the cutting of a road, will be done by the contractor or contractors without cost to the County.
4. A performance bond, or other securities agreed upon by the County, must be pledged in the amount of the estimated cost of the road repairs, as agreed to by the contractor and County, prior to the commencing of a cutting of the roadbed.
5. A roadbed cut permit fee, in the amount of \$120.00 per roadbed cut, must be submitted to the County Road Administrator's office prior to cutting the roadbed.

This agreement must be entered into prior to the commencing of the cutting of a roadbed.

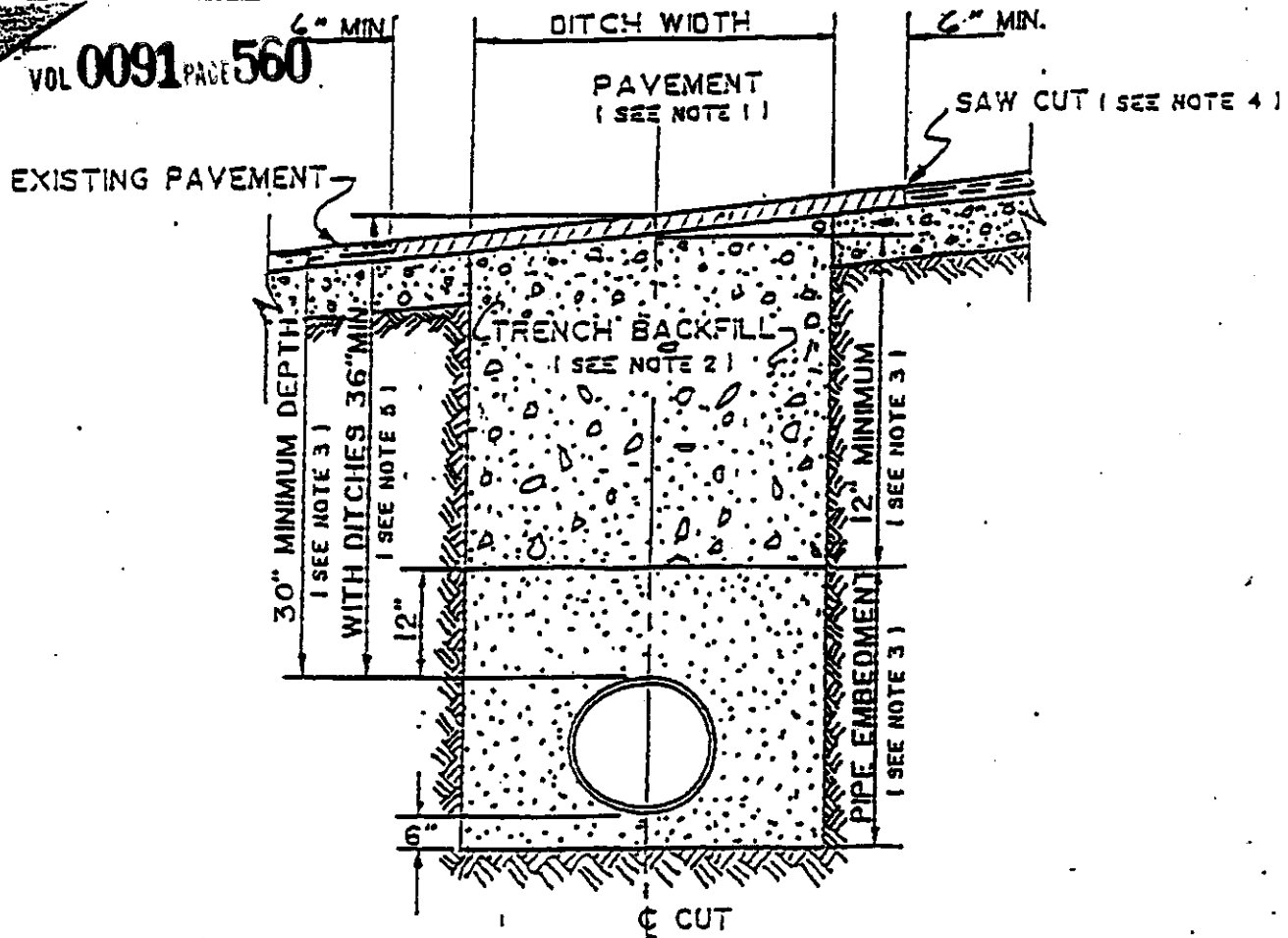

1. Hot mix asphalt 1 1/2" min. thickness. Roll in place to match existing surface. $\pm 1/8"$ tolerance.
2. Trench backfill shall be flexible base, compacted to 95% optimum in 8" layers unless otherwise approved and specified. Flexible base to match existing base thickness or 8 inches, whichever is greater (specifications: TSHD Item 248, Type A, Grade 2).
3. Pipe embedment (pipe envelope) size and materials shall be as specified elsewhere by the utility company and/or its engineers. Pipe depth shall be as specified elsewhere provided minimum depths are met.
4. Saw cut shall be made prior to ditch cut. If pavement is damaged during cut, a new saw cut shall be made beyond the damaged area and new pavement placed.
5. Where roadside ditches (bar ditches) are crossed by the utility pipe, minimum depth to the top of the pipe from centerline road elevation will be 36".

received

8-18-97

5437 3P001BB

GREG BERGERON
COUNTY ROAD ADMINISTRATORWilliamson County
Unified Road System1900 Georgetown Inner Loop, Suite B
Georgetown, Texas 78626
Telephone (512) 930-3330
Fax (512) 930-3335

VOL. 0091 PAGE 561

UTILITY INSTALLATION REQUEST

DATE: 8-14-97TO: Williamson County Commissioners' Court
c/o County Engineer, County Road Administrator or County CommissionerFormal notice is hereby given that GTE proposes to place
a BURIED SERVICE LINE line within the right-of-way of A
WILLIAMSON CR 313 County Road as follows:
SEE ATTACHED SKETCH

The location and description of the proposed line and appurtenances is more fully shown on the drawing attached hereto. The line will be constructed & maintained on the County right-of-way in accordance with current Williamson County Specifications as directed by the County Engineer, County Road Administrator or County Commissioner.

Construction will begin on or after the 15 day of AUGUST 1997, and is estimated to be completed in 30 calendar days.

SUBMITTED BY FIRM: GTE AUTHORIZED
SIGNATURE: [Signature] TITLE: Service Design FIRM ADDRESS: 1700 W. LAUSTON AVE
PHONE # 865-2234

CONTRACTOR (IF DIFFERENT FROM FIRM):

AUTHORIZED SIGNATURE: TITLE:
ADDRESS: PHONE #Precinct #: 3

APPROVAL

This application is hereby approved subject to the following understandings and restrictions.

It is expressly understood that the said County Commissioners' Court does not imply hereby to grant any right, claim, title or easement in or upon this County Road; and it is further understood that in the future, should Williamson County, for any reason, need to work, improve, relocate, widen, increase, add to, decrease, or in any manner change the structure of this road or right-of-way, this line, if affected, will be moved at the direction of the Williamson County Engineer or County Commissioner. This installation work shall not damage any part of the roadway and adequate provisions shall be made to cause a minimum of inconvenience to traffic and adjacent property owners.

APPROVED BY WILLIAMSON COUNTY COMMISSIONERS' COURT

BY: [Signature]
COUNTY ROAD ADMINISTRATORDATE: 8/22/97

71

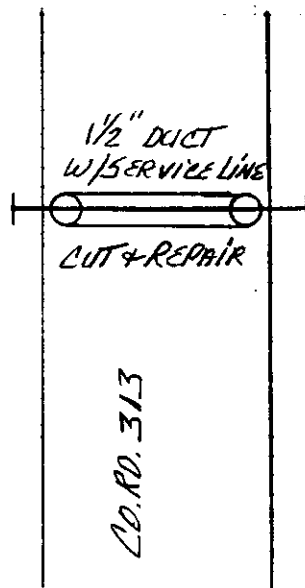

72

MC 600664
FORM ES-02
REV 5-78

AREA _____
TAX DIST. _____
ENG'D BY Bo. STERN DATE 8-14-97
DRAWN BY _____ DATE _____
APPROVED BY _____ DATE _____
REVISED BY _____ DATE _____

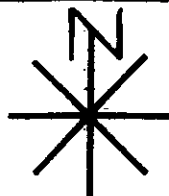

SCALE NTS

GENERAL TELEPHONE COMPANY
OF THE SOUTHWEST

LOCATION 5437 JARRELL
DESCRIPTION PERMIT TO CUT &
REPAIR ROAD

SHEET 1 OF 1 W. O. NO. 3P00188

ISSUED 8-12-77 EFFECTIVE 1-18-77 DOCKET 15	 GENERAL TELEPHONE COMPANY OF THE SOUTHWEST	TEXAS GENERAL EXCHANGE TARIFF MAP SUPPLEMENT SECTION 6 JARRELL, TEXAS Exchange Area Boundary
SCALE 1 inch = 2 Mi.	CANCELLING-Original	First Revised SHEET NO. 125A SHEET NO. 125A

ALL BOUNDARIES ARE 600 FEET FROM
ROADS UNLESS OTHERWISE NOTED

R. REX BAILEY
VICE PRESIDENT--REVENUE REQUIREMENTS

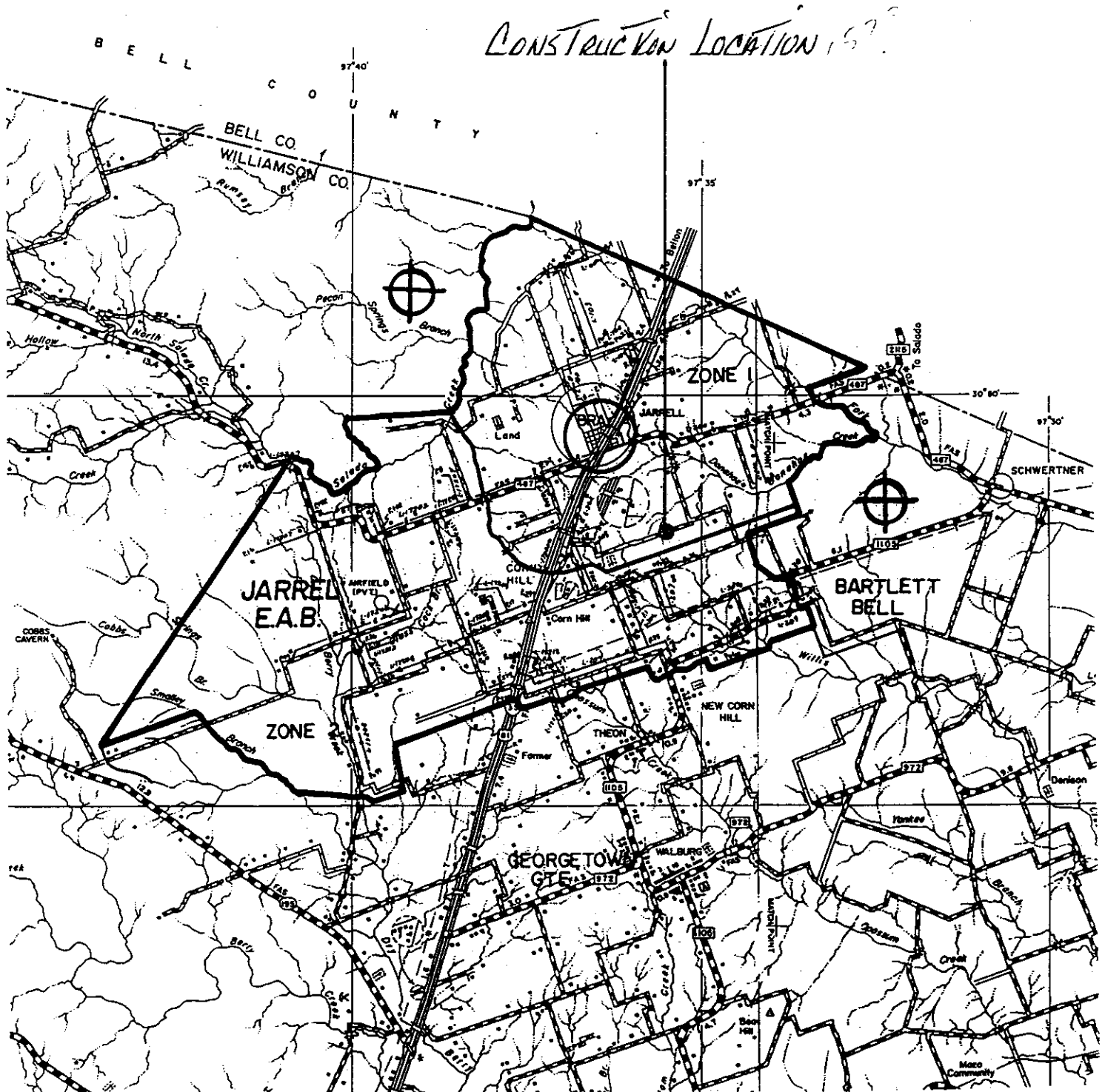

GREG BERGERON
County Road Administrator



1900 Georgetown Loop, Ste. B
Georgetown, Texas 78626
Telephone (512) 930-3330
Fax (512) 930-3335

Williamson County
Unified Road System

When specifically agreed to in writing and signed by a Williamson County Commissioner, or the County Road Administrator, Williamson County will permit the cutting of a roadbed in lieu of core drilling, provided the contractor or contractors agree to the following installation:

SPECIFICATION FOR CUTTING ROADBED IN LIEU OF CORE DRILLING

1. Compacted base material with concrete cap.
2. The utility shall be placed a minimum of 30" below the flow line.
3. Layer compacted and topped with 3" hot mix asphalt.
4. A performance bond, or other securities agreed upon by the County, must be pledged in the amount of the estimated cost of the road repairs, as agreed to by the contractor and Williamson County, prior to the commencing of a cutting of the roadbed.
5. A road cut permit fee, in the amount of \$120.00 per roadbed cut, must be submitted to the County Road Administrator's office prior to cutting the roadbed.

SPECIFICATION FOR CUTTING ROADBED IN LIEU OF CORE DRILLING
WITHIN AUSTIN ETJ

1. Roadbed cuts to be repaired in accordance with City of Austin specifications as outlined in their standard Specifications for Cuts in Public Right of Way Manual.
2. The utility shall be placed a minimum of 30" below the flow line.
3. The installation to be free from defects for a period of one (1) year from completion date. Any maintenance required during this period, caused by the cutting of a road, will be done by the contractor or contractors without cost to the County.
4. A performance bond, or other securities agreed upon by the County, must be pledged in the amount of the estimated cost of the road repairs, as agreed to by the contractor and County, prior to the commencing of a cutting of the roadbed.
5. A roadbed cut permit fee, in the amount of \$120.00 per roadbed cut, must be submitted to the County Road Administrator's office prior to cutting the roadbed.

This agreement must be entered into prior to the commencing of the cutting of a roadbed.

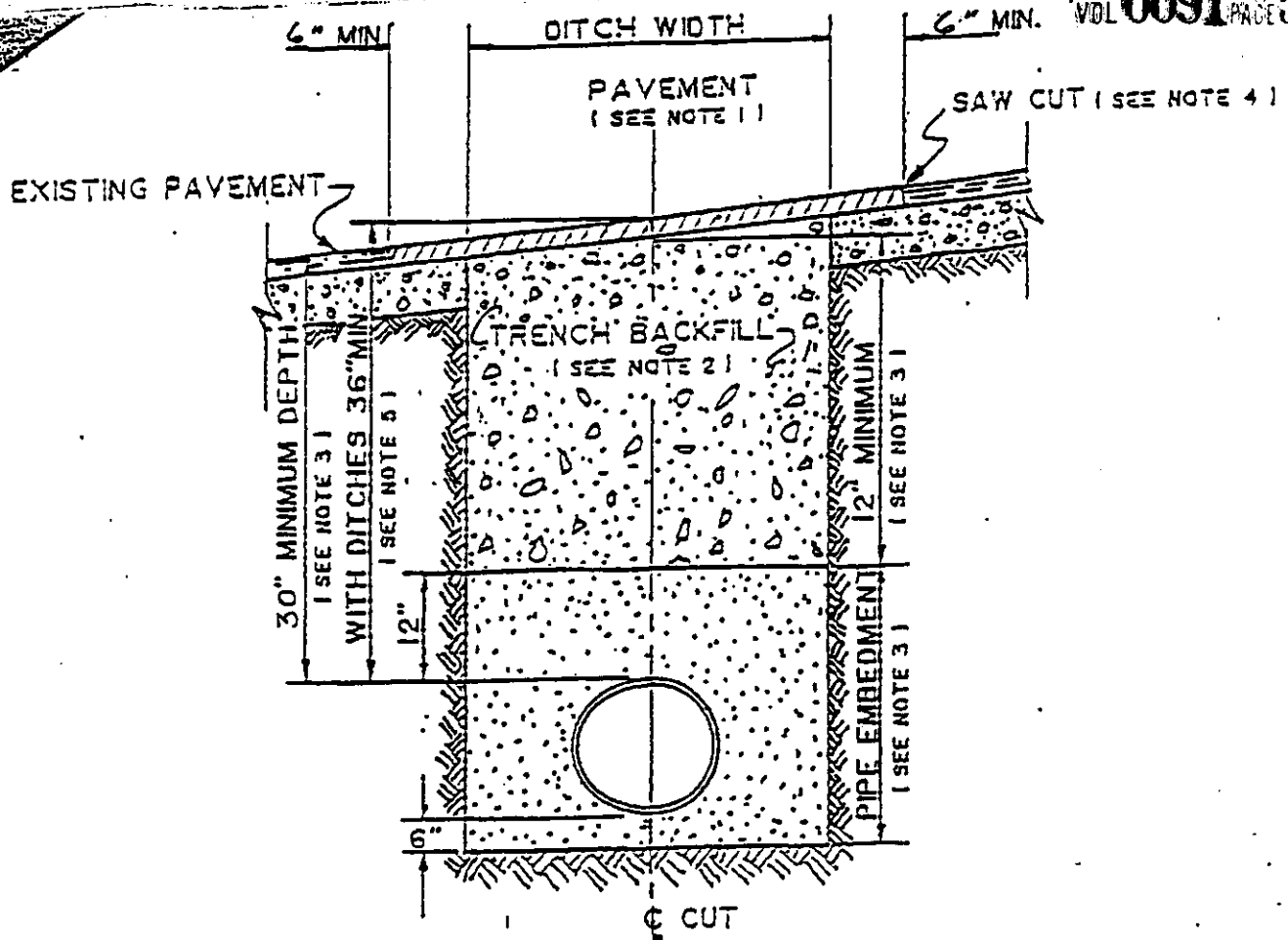

1. Hot mix asphalt 1 1/2" min. thickness. Roll in place to match existing surface. $\pm 1/8"$ tolerance.
2. Trench backfill shall be flexible base, compacted to 95% optimum in 8" layers unless otherwise approved and specified. Flexible base to match existing base thickness or 8 inches, whichever is greater (specifications: TSHD Item 248, Type A, Grade 2).
3. Pipe embedment (pipe envelope) size and materials shall be as specified elsewhere by the utility company and/or its engineers. Pipe depth shall be as specified elsewhere provided minimum depths are met.
4. Saw cut shall be made prior to ditch cut. If pavement is damaged during cut, a new saw cut shall be made beyond the damaged area and new pavement placed.
5. Where roadside ditches (bar ditches) are crossed by the utility pipe, minimum depth to the top of the pipe from centerline road elevation will be 36".

GREG BERGERON
COUNTY ROAD ADMINISTRATOR**received**

8-18-97

Williamson County
Unified Road System1900 Georgetown Inner Loop, Suite B
Georgetown, Texas 78626
Telephone (512) 930-3330
Fax (512) 930-3335

UTILITY INSTALLATION REQUEST

DATE: 8-15-97TO: Williamson County Commissioners' Court
c/o County Engineer, County Road Administrator or County Commissioner

Formal notice is hereby given that Long Star Gas proposes to place a 6" Poly II Gas main line within the right-of-way of Great Oaks at Racine Tr. County Road as follows: cut Great Oaks from Media north to Row and install the 6" Poly II Gas main. See Attached.

The location and description of the proposed line and appurtenances is more fully shown on the drawing attached hereto. The line will be constructed & maintained on the County right-of-way in accordance with current Williamson County Specifications as directed by the County Engineer, County Road Administrator or County Commissioner.

Construction will begin on or after the 18 day of August 1997, and is estimated to be completed in 60 calendar days.

SUBMITTED BY FIRM: Long Star Gas AUTHORIZED
SIGNATURE: Loyd Davis PRINTED NAME: Loyd Davis
TITLE: BD Mgr. FIRM ADDRESS: 3110 N. IH-35, Round Rock 78681
PHONE # 512-244-6234
CONTRACTOR (IF DIFFERENT FROM FIRM) Blund/Schroeder
AUTHORIZED SIGNATURE: Joe Blund PRINTED NAME: Joe Blund
TITLE: Pres. ADDRESS: 11111 8705 Schaefer Blvd #101
PHONE # 488-8285 Austin 78757

Precinct #: 3

APPROVAL

This application is hereby approved subject to the following understandings and restrictions.

It is expressly understood that the said County Commissioners' Court does not imply hereby to grant any right, claim, title or easement in or upon this County Road; and it is further understood that in the future, should Williamson County, for any reason, need to work, improve, relocate, widen, increase, add to, decrease, or in any manner change the structure of this road or right-of-way, this line, if affected, will be moved at the direction of the Williamson County Engineer or County Commissioner. This installation work shall not damage any part of the roadway and adequate provisions shall be made to cause a minimum of inconvenience to traffic and adjacent property owners.

APPROVED BY WILLIAMSON COUNTY COMMISSIONERS' COURT

BY: Greg Bergeron
COUNTY ROAD ADMINISTRATORDATE: 8/22/97

76

8-21-97
cut + restore
R.J.

water side - 6' D.P. under sidewalk

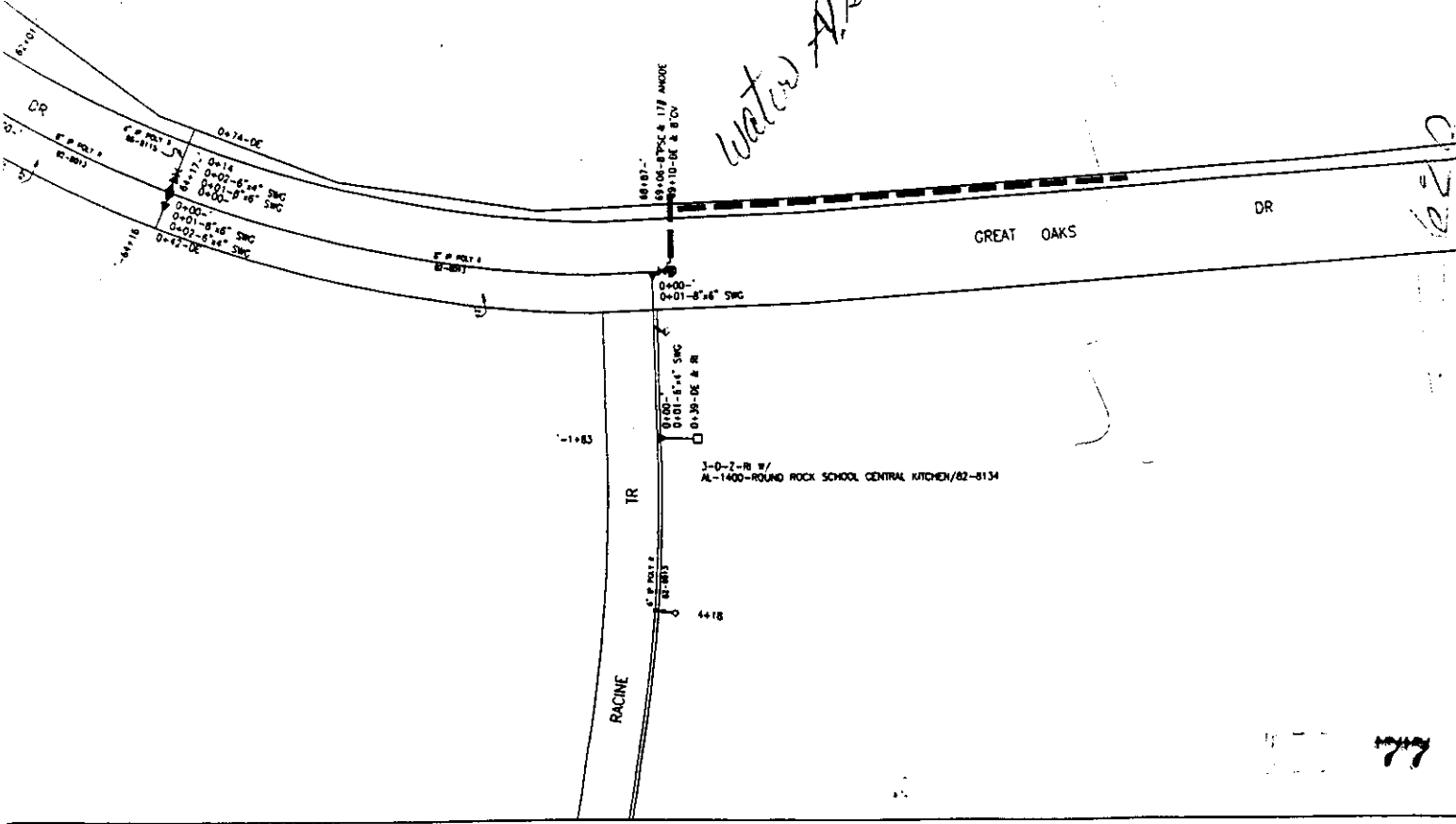

AL816308

LONE STAR GAS COMPANY
BRUSHY CREEK SHEET NO. AL816310

AL819310

GREG BERGERON
County Road Administrator



1900 Georgetown Loop, Ste. B
Georgetown, Texas 78626
Telephone (512) 930-3330
Fax (512) 930-3335

Williamson County
Unified Road System

When specifically agreed to in writing and signed by a Williamson County Commissioner, or the County Road Administrator, Williamson County will permit the cutting of a roadbed in lieu of core drilling, provided the contractor or contractors agree to the following installation:

SPECIFICATION FOR CUTTING ROADBED IN LIEU OF CORE DRILLING

1. Compacted base material with concrete cap.
2. The utility shall be placed a minimum of 30" below the flow line.
3. Layer compacted and topped with 3" hot mix asphalt.
4. A performance bond, or other securities agreed upon by the County, must be pledged in the amount of the estimated cost of the road repairs, as agreed to by the contractor and Williamson County, prior to the commencing of a cutting of the roadbed.
5. A road cut permit fee, in the amount of \$120.00 per roadbed cut, must be submitted to the County Road Administrator's office prior to cutting the roadbed.

SPECIFICATION FOR CUTTING ROADBED IN LIEU OF CORE DRILLING
WITHIN AUSTIN ETJ

1. Roadbed cuts to be repaired in accordance with City of Austin specifications as outlined in their standard Specifications for Cuts in Public Right of Way Manual.
2. The utility shall be placed a minimum of 30" below the flow line.
3. The installation to be free from defects for a period of one (1) year from completion date. Any maintenance required during this period, caused by the cutting of a road, will be done by the contractor or contractors without cost to the County.
4. A performance bond, or other securities agreed upon by the County, must be pledged in the amount of the estimated cost of the road repairs, as agreed to by the contractor and County, prior to the commencing of a cutting of the roadbed.
5. A roadbed cut permit fee, in the amount of \$120.00 per roadbed cut, must be submitted to the County Road Administrator's office prior to cutting the roadbed.

This agreement must be entered into prior to the commencing of the cutting of a roadbed.

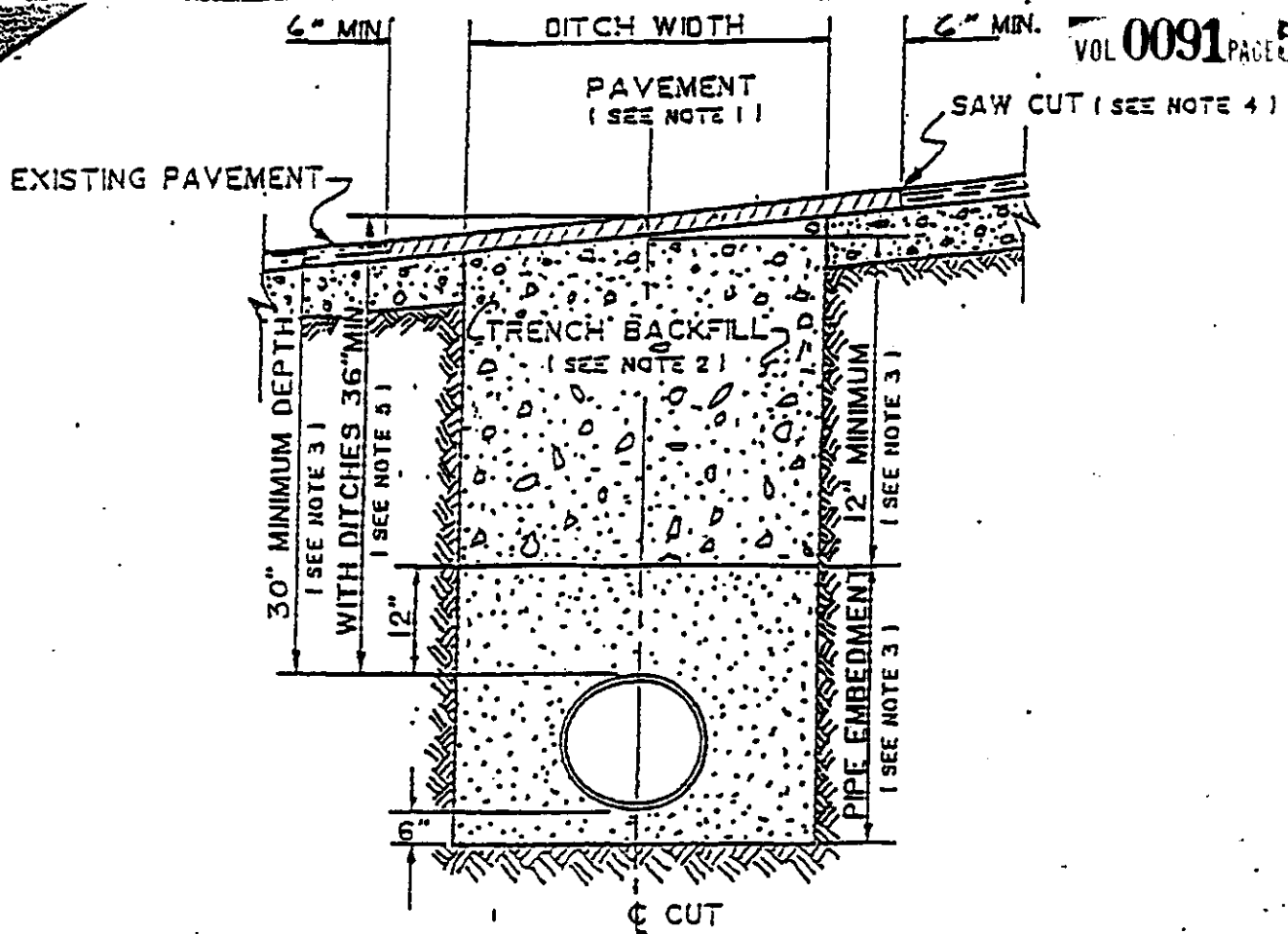

1. Hot mix asphalt 1 1/2" min. thickness. Roll in place to match existing surface. $\pm 1/8"$ tolerance.
2. Trench backfill shall be flexible base, compacted to 95% optimum in 8" layers unless otherwise approved and specified. Flexible base to match existing base thickness or 8 inches, whichever is greater (specifications: TSHD Item 248, Type A, Grade 2).
3. Pipe embedment (pipe envelope) size and materials shall be as specified elsewhere by the utility company and/or its engineers. Pipe depth shall be as specified elsewhere provided minimum depths are met.
4. Saw cut shall be made prior to ditch cut. If pavement is damaged during cut, a new saw cut shall be made beyond the damaged area and new pavement placed.
5. Where roadside ditches (bar ditches) are crossed by the utility pipe, minimum depth to the top of the pipe from centerline road elevation will be 36".

AGENDA ITEM # 5

August 26, 1997

*

Consider noting reports from TxDOT on over axle/over weight tolerance permits.

Moved: Judge Doerfler

Seconded: Commissioner Boatright

Motion: To note reports from TxDOT on over axle/over weight tolerance permits.

Vote: Motion carried 4 - 0 with Commissioner Heiligenstein absent from the dais

< Clerk copy here >

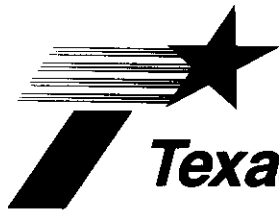

Texas Department of Transportation

DEWITT C. GREER STATE HIGHWAY BLDG. • 125 E. 11TH STREET • AUSTIN, TEXAS 78701-2483 • (512) 463-8585

August 14, 1997

Attn: County Clerks,

In accordance with HB 1547, 74th Legislature, enclosed is the notification to counties concerning the issuance of Over Axle / Over Gross Weight Tolerance Permits. HB 1547, 74th Legislature directs the Texas Department of Transportation to notify each county listed in the permit application for a permit issued under authority of TVCS 6701d-11 Sec. 5B, and the Texas Transportation Code, Chapter 623 that the person intends to operate or cause to be operated an overweight vehicle in the county.

If this report is going to the incorrect address please notify the Motor Carrier Division of any mailing address changes.

If you have any questions concerning this information, please contact Curtis Wagner at 512-465-3500.

*noted 8-26-97
John C. Doerfler*

Sincerely,

for: Larry A. Chamberlain
Lawrance R. Smith, Director
Motor Carrier Division

Enclosure

80