

AGENDA ITEM # 4August 19, 1997*

Consider noting in minutes any right-of-way work on any county road done by Road & Bridge Unified System.

Moved: Judge Doerfler

Seconded: Commissioner Boatright

Motion: To note off right-of-way work on **Joe Bohanon** property to remove fence and clear site line on County Road 340;

Beck Chastain property to clear sight line for 20 feet off the corner on County Road 130 and to note the following Utility Requests from **Central Telephone Company of Texas** right-of-way work order # 36174129 on County Road 233;

GTE road cut on County Road 313;

Manville Water Supply Company right-of-way on County Road 198.

Vote: Motion carried 3 - 0

< Clerk copy here >

August 19, 1997

UNIFIED ROAD SYSTEM
OFF RIGHT-OF-WAY WORK

1. CR 340 - Remove fence at Joe Bohanon property and clear site line.(Pct. 4-DA)
2. CR 130 - Clear sight line for 20' off of the corner of the Becky Chastain property.(Pct. 4-DA)

WILLIAMSON COUNTY URS
Utility Requests - 08/19/97

Precinct I

Precinct II

Precinct III

- A. Central Telephone Company of Texas
 - 1. CR 233, work order #36174129 - ROW
- B. GTE
 - 1. CR 313 - Road cut

Precinct IV

- A. Manville Water Supply Co.
 - 1. CR 198 - ROW

noted 8-19-97
John C. Daefler

GREG BERGERON
County Road Administrator

1900 Georgetown Inner Loop, Suite B
Georgetown, Texas 78626
Telephone (512) 930-3330
Fax (512) 930-3335

**Williamson County
Unified Road System**

received
8-8-97

UTILITY INSTALLATION REQUEST

DATE: July 28, 1997

TO: Williamson County Commissioners' Court c/o County Engineer or County Commissioner

Formal notice is hereby given that Central Telephone Company of Texas proposes to place a telephone cable within the right-of-way of County Road 233 as follows:

On the north side of the road from the driveway at #900 CR 233 to a power pole approximately 1,100 feet east. Placement will be within 3 feet of back of right-of-way.

The location and description of the proposed line and appurtenances is more fully shown on the drawing attached hereto. The line will be constructed & maintained on the County right-of-way in accordance with current Williamson County Specifications as directed by the County Engineer or County Commissioner.

Construction will begin on or after the 18th day of August, 1997, and is estimated to be completed in 3 calendar days.

SUBMITTED BY FIRM: Central Telephone Company of Texas AUTHORIZED
SIGNATURE: Bob Williams TITLE: Network Engineer
FIRM ADDRESS: 1214 Dogwood, P.O. Box 1150, Killeen, TX 76540 PHONE # 254-690-9358
CONTRACTOR (IF DIFFERENT FROM FIRM): _____
AUTHORIZED SIGNATURE: _____ TITLE: _____
ADDRESS: _____ PHONE # _____

Precinct # 5

APPROVAL

The application is hereby approved subject to the following understandings and restrictions.

It is expressly understood that the said County Commissioners' Court does not imply hereby to grant any right, claim, title or easement in or upon this County Road; and it is further understood that in the future, should Williamson County, for any reason, need to work, improve, relocate, widen, increase, add to, decrease, or in any manner change the structure of this road or right-of-way, this line, if affected, will be moved at the direction of the Williamson County Engineer or County Commissioner. This installation work shall not damage any part of the roadway and adequate provisions shall be made to cause a minimum of inconvenience to traffic and adjacent property owners.

APPROVED BY WILLIAMSON COUNTY COMMISSIONERS' COURT

BY: Greg Bergeron
COUNTY ROAD ADMINISTRATOR

DATE: 8/14/97

39

FN 187

36174129
FLRN/0812
DON-PLCA CASKE-1 N7C

DWG 1 of 2

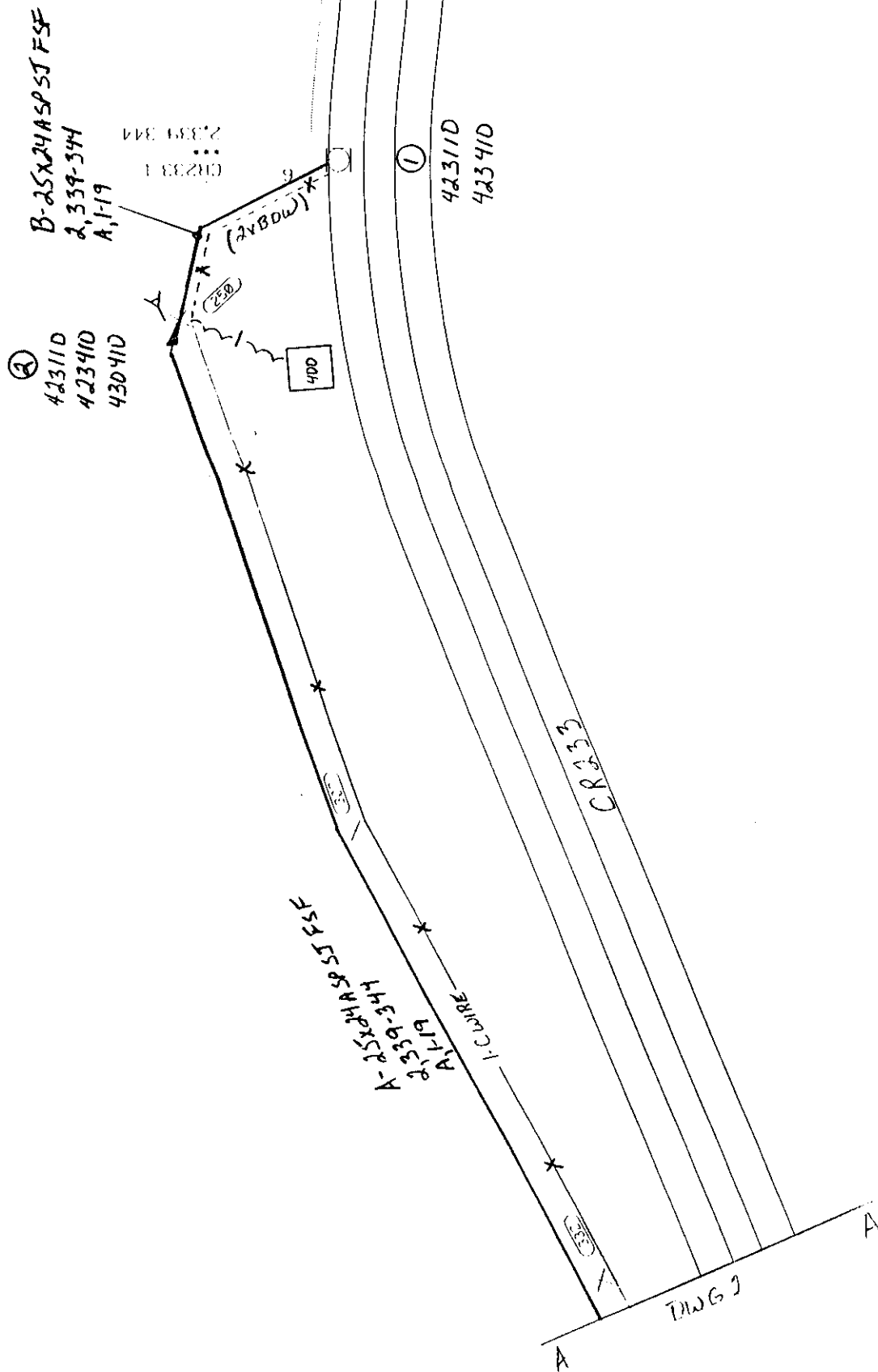

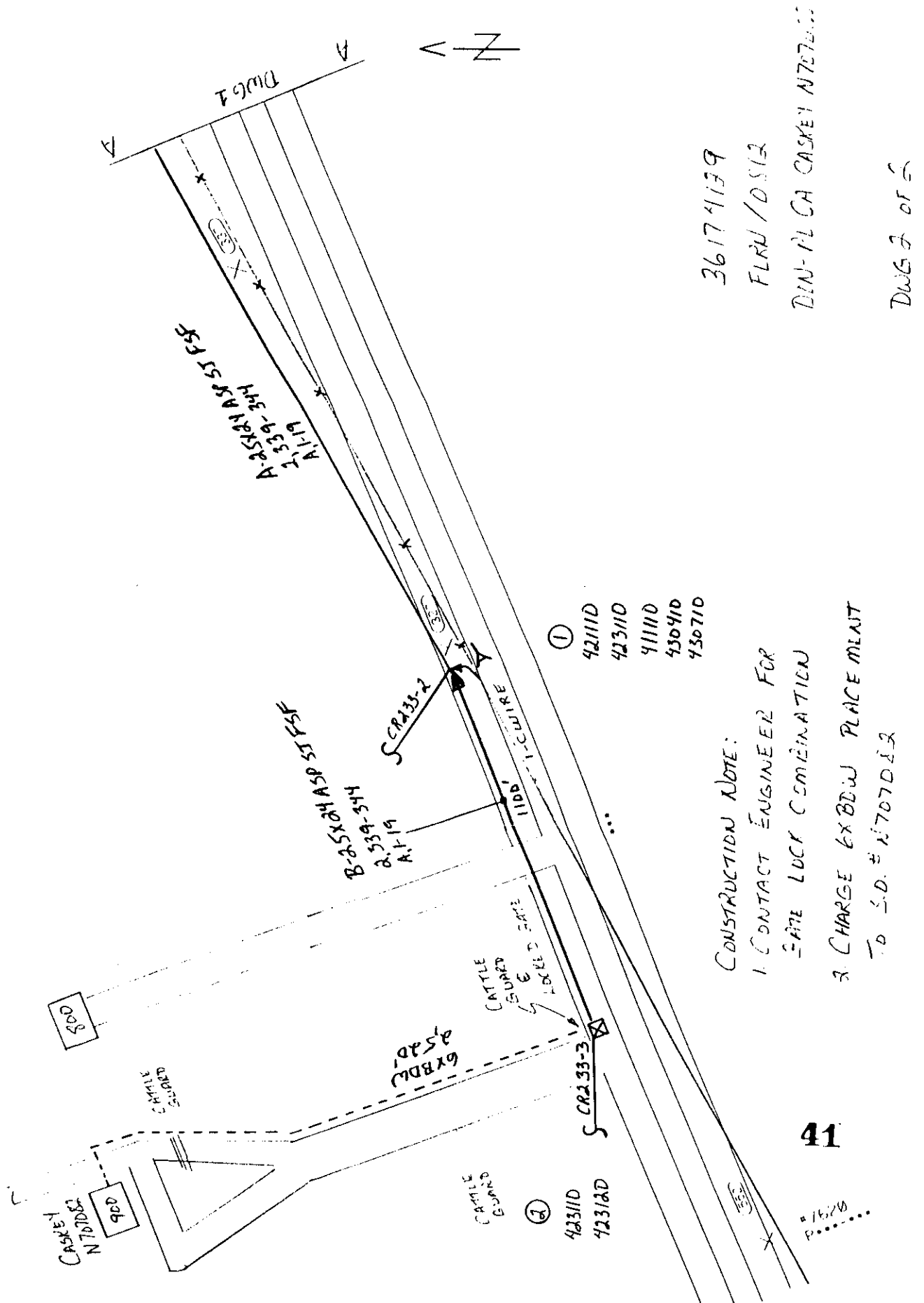

GREG BERGERON
County Road Administrator



1900 Georgetown Loop, Ste. B
Georgetown, Texas 78626
Telephone (512) 930-3330
Fax (512) 930-3335

Williamson County
Unified Road System

When specifically agreed to in writing and signed by a Williamson County Commissioner, or the County Road Administrator, Williamson County will permit the cutting of a roadbed in lieu of core drilling, provided the contractor or contractors agree to the following installation:

SPECIFICATION FOR CUTTING ROADBED IN LIEU OF CORE DRILLING

1. Compacted base material with concrete cap.
2. The utility shall be placed a minimum of 30" below the flow line.
3. Layer compacted and topped with 3" hot mix asphalt.
4. A performance bond, or other securities agreed upon by the County, must be pledged in the amount of the estimated cost of the road repairs, as agreed to by the contractor and Williamson County, prior to the commencing of a cutting of the roadbed.
5. A road cut permit fee, in the amount of \$120.00 per roadbed cut, must be submitted to the County Road Administrator's office prior to cutting the roadbed.

SPECIFICATION FOR CUTTING ROADBED IN LIEU OF CORE DRILLING
WITHIN AUSTIN ETJ

1. Roadbed cuts to be repaired in accordance with City of Austin specifications as outlined in their standard Specifications for Cuts in Public Right of Way Manual.
2. The utility shall be placed a minimum of 30" below the flow line.
3. The installation to be free from defects for a period of one (1) year from completion date. Any maintenance required during this period, caused by the cutting of a road, will be done by the contractor or contractors without cost to the County.
4. A performance bond, or other securities agreed upon by the County, must be pledged in the amount of the estimated cost of the road repairs, as agreed to by the contractor and County, prior to the commencing of a cutting of the roadbed.
5. A roadbed cut permit fee, in the amount of \$120.00 per roadbed cut, must be submitted to the County Road Administrator's office prior to cutting the roadbed.

This agreement must be entered into prior to the commencing of the cutting of a roadbed.

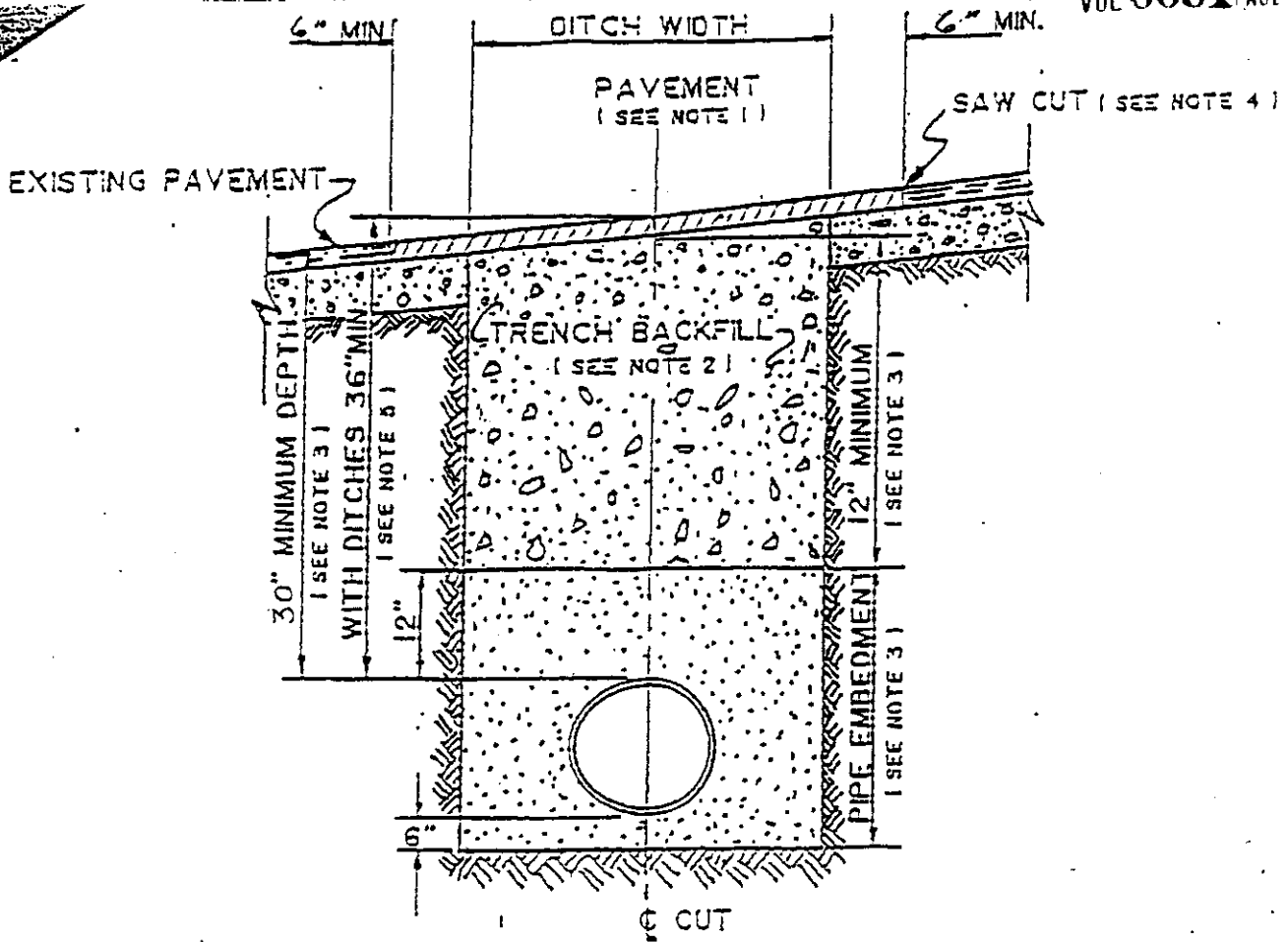

1. Hot mix asphalt 1 1/2" min. thickness. Roll in place to match existing surface. $\pm 1/8"$ tolerance.
2. Trench backfill shall be flexible base, compacted to 95% optimum in 8" layers unless otherwise approved and specified. Flexible base to match existing base thickness or 8 inches, whichever is greater (specifications: TSHD Item 248, Type A, Grade 2).
3. Pipe embedment (pipe envelope) size and materials shall be as specified elsewhere by the utility company and/or its engineers. Pipe depth shall be as specified elsewhere provided minimum depths are met.
4. Saw cut shall be made prior to ditch cut. If pavement is damaged during cut, a new saw cut shall be made beyond the damaged area and new pavement placed.
5. Where roadside ditches (bar ditches) are crossed by the utility pipe, minimum depth to the top of the pipe from centerline road elevation will be 36".

VOL 0091 PAGE 420

GREG BERGERON
COUNTY ROAD ADMINISTRATORWilliamson County
Unified Road System

received

8-14-97

1800 Georgetown Inner Loop, Suite B
Georgetown, Texas 78626
Telephone (512) 930-3330
Fax (512) 930-3335

UTILITY INSTALLATION REQUEST

DATE: 7-30-97TO: Williamson County Commissioners' Court
c/o County Engineer, County Road Administrator or County CommissionerFormal notice is hereby given that GTE proposes to place
a Buried Communications line within the right-of-way of CR 313
A WILLIAMSON County Road as follows: SEE SKETCH

The location and description of the proposed line and appurtenances is more fully shown on the drawing attached hereto. The line will be constructed & maintained on the County right-of-way in accordance with current Williamson County Specifications as directed by the County Engineer, County Road Administrator or County Commissioner.

Construction will begin on or after the 22 day of AUGUST 1997, and is estimated to be completed in 30 calendar days.

SUBMITTED BY FIRM: GTE AUTHORIZED
SIGNATURE: [Signature] TITLE: Geny FIRM ADDRESS: 1700
N. AUSTIN AVE. GEORGETOWN TX 78626 PHONE # 867-2234
CONTRACTOR (IF DIFFERENT FROM FIRM):
AUTHORIZED SIGNATURE: TITLE:
ADDRESS: PHONE #

Precinct #: 3

APPROVAL

This application is hereby approved subject to the following understandings and restrictions.

It is expressly understood that the said County Commissioners' Court does not imply hereby to grant any right, claim, title or easement in or upon this County Road; and it is further understood that in the future, should Williamson County, for any reason, need to work, improve, relocate, widen, increase, add to, decrease, or in any manner change the structure of this road or right-of-way, this line, if affected, will be moved at the direction of the Williamson County Engineer or County Commissioner. This installation work shall not damage any part of the roadway and adequate provisions shall be made to cause a minimum of inconvenience to traffic and adjacent property owners.

APPROVED BY WILLIAMSON COUNTY COMMISSIONERS' COURT

BY: [Signature]
COUNTY ROAD ADMINISTRATORDATE: 8/15/97

44

8-14-97
cut & restore
R-1

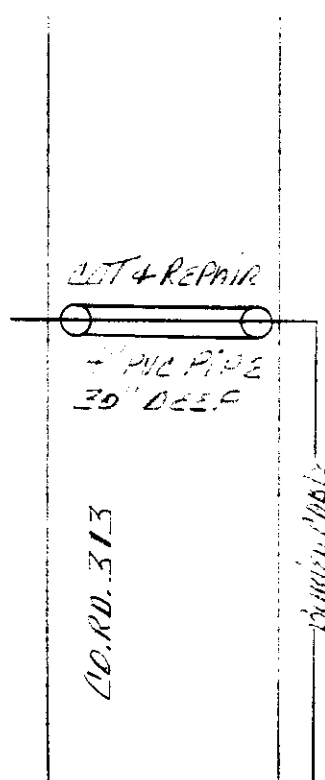

MC 600664
FORM ED-172
(REV. 6-78)

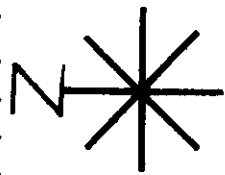
AREA <u>CENTRAL</u>				GENERAL TELEPHONE COMPANY OF THE SOUTHWEST		45
TAX DIST. _____				LOCATION <u>5437 JARRELL</u>		
ENGINE BY <u>BO STEARNS</u> DATE <u>2-30-97</u>				DESCRIPTION <u>PERMIT TO CUT & REPAIR ROAD</u>		
DRAWN BY _____ DATE _____				SHEET <u>1</u> OF <u>1</u>		
APPROVED BY _____ DATE _____				W.O. NO. <u>3P001BB</u>		
REVISED BY _____ DATE _____		SCALE <u>NTS</u>				

ISSUED 8-12-77
EFFECTIVE 1-18-77
DOCKET 15

GTE

GENERAL
TELEPHONE
COMPANY
OF THE
SOUTHWEST

TEXAS GENERAL EXCHANGE TARIFF
MAP SUPPLEMENT SECTION 6

JARRELL, TEXAS
Exchange Area Boundary

SCALE 1 inch = 2 Mi.

ALL BOUNDARIES ARE 600 FEET FROM
ROADS UNLESS OTHERWISE NOTED

First Revised SHEET NO. 125A
CANCELLING-Original SHEET NO. 125A

R. REX BAILEY
VICE PRESIDENT--REVENUE REQUIREMENTS

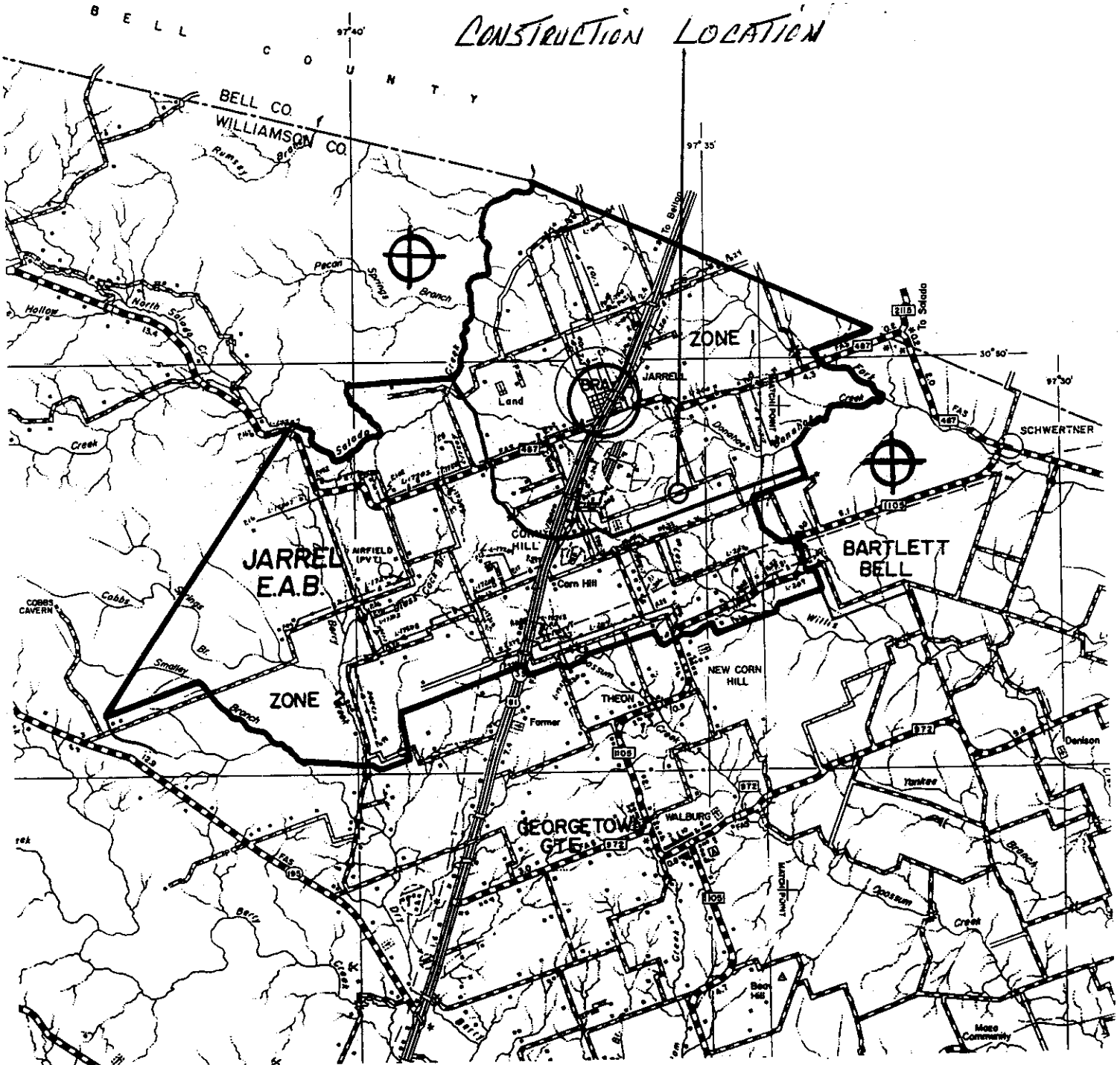

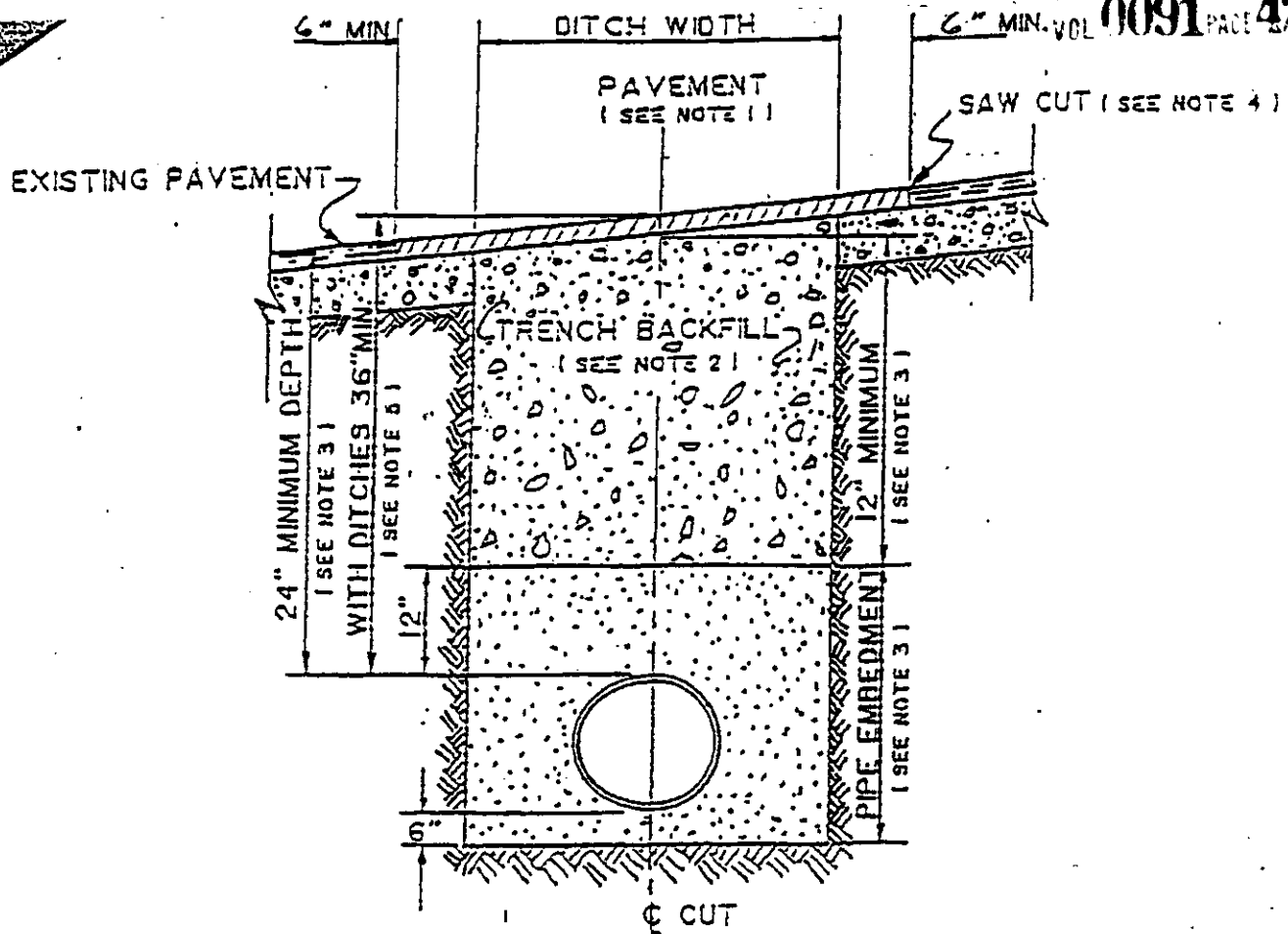

1. Hot mix asphalt 1 1/2" min. thickness. Roll in place to match existing surface. $\pm 1/8"$ tolerance.
2. Trench backfill shall be flexible base, compacted to 95% optimum in 8" layers unless otherwise approved and specified. Flexible base to match existing base thickness or 8 inches, whichever is greater (specifications: TSHD Item 248, Type A, Grade 2).
3. Pipe embedment (pipe envelope) size and materials shall be as specified elsewhere by the utility company and/or its engineers. Pipe depth shall be as specified elsewhere provided minimum depths are met.
4. Saw cut shall be made prior to ditch cut. If pavement is damaged during cut, a new saw cut shall be made beyond the damaged area and new pavement placed.
5. Where roadside ditches (bar ditches) are crossed by the utility pipe, minimum depth to the top of the pipe from centerline road elevation will be 36".

GREG BERGERON
County Road Administrator



1900 Georgetown Loop, Sta. B
Georgetown, Texas 78626
Telephone (512) 930-3330
Fax (512) 930-3335

Williamson County
Unified Road System

When specifically agreed to in writing and signed by a Williamson County Commissioner, or the County Road Administrator, Williamson County will permit the cutting of a roadbed in lieu of core drilling, provided the contractor or contractors agree to the following installation:

SPECIFICATION FOR CUTTING ROADBED IN LIEU OF CORE DRILLING

1. Compacted base material with concrete cap.
2. The utility shall be placed a minimum of 30" below the flow line.
3. Layer compacted and topped with 3" hot mix asphalt.
4. A performance bond, or other securities agreed upon by the County, must be pledged in the amount of the estimated cost of the road repairs, as agreed to by the contractor and Williamson County, prior to the commencing of a cutting of the roadbed.
5. A road cut permit fee, in the amount of \$120.00 per roadbed cut, must be submitted to the County Road Administrator's office prior to cutting the roadbed.

SPECIFICATION FOR CUTTING ROADBED IN LIEU OF CORE DRILLING
WITHIN AUSTIN ETJ

1. Roadbed cuts to be repaired in accordance with City of Austin specifications as outlined in their standard Specifications for Cuts in Public Right of Way Manual.
2. The utility shall be placed a minimum of 30" below the flow line.
3. The installation to be free from defects for a period of one (1) year from completion date. Any maintenance required during this period, caused by the cutting of a road, will be done by the contractor or contractors without cost to the County.
4. A performance bond, or other securities agreed upon by the County, must be pledged in the amount of the estimated cost of the road repairs, as agreed to by the contractor and County, prior to the commencing of a cutting of the roadbed.
5. A roadbed cut permit fee, in the amount of \$120.00 per roadbed cut, must be submitted to the County Road Administrator's office prior to cutting the roadbed.

This agreement must be entered into prior to the commencing of the cutting of a roadbed.

GREG BERGERON
COUNTY ROAD ADMINISTRATOR



1900 Georgetown Inner Loop, Suite 8
Georgetown, Texas 78626
Telephone (512) 930-3330
Fax (512) 930-3335

**Williamson County
Unified Road System**

UTILITY INSTALLATION REQUEST

DATE: August 12, 1997

TO: Williamson County Commissioners' Court
c/o County Engineer, County Road Administrator or County Commissioner

Formal notice is hereby given that Manville Water Supply proposes to place
a 6" PVC water line line within the right-of-way of
198 County Road as follows:
Starting 800 Ft. from C R 139 going east 3100 Ft. to Melber Lane,
in the right-of-way.

The location and description of the proposed line and appurtenances is more fully shown on the drawing attached hereto. The line will be constructed & maintained on the County right-of-way in accordance with current Williamson County Specifications as directed by the County Engineer, County Road Administrator or County Commissioner.

Construction will begin on or after the 14th day of August 19 97, and is estimated to be completed in 11 calendar days.

SUBMITTED BY FIRM: Manville Water Supply Corp. AUTHORIZED
SIGNATURE: [Signature] TITLE: Manager FIRM ADDRESS: P.O. Box 248
Coupland, Texas 78615 PHONE # 272-4044

CONTRACTOR (if different from firm): _____
 AUTHORIZED SIGNATURE: _____ TITLE: _____
 ADDRESS: _____ PHONE # _____

Precinct #: 4

APPROVAL

This application is hereby approved subject to the following understandings and restrictions.

It is expressly understood that the said County Commissioners' Court does not imply hereby to grant any right, claim, title or easement in or upon this County Road; and it is further understood that in the future, should Williamson County, for any reason, need to work, improve, relocate, widen, increase, add to, decrease, or in any manner change the structure of this road or right-of-way, this line, if affected, will be moved at the direction of the Williamson County Engineer or County Commissioner. This installation work shall not damage any part of the roadway and adequate provisions shall be made to cause a minimum of inconvenience to traffic and adjacent property owners.

APPROVED BY WILLIAMSON COUNTY COMMISSIONERS' COURT

BY: [Signature]
COUNTY ROAD ADMINISTRATOR

DATE: 8/8/87

B.W. GAMMER

332-376

120.33 AC

CR 139

EXISTING 6" WATER LINE

EXISTING 6" WATER LINE
630
620
610
620
630
640

CHARLIE ZIMMERHAEZEL

435-99

PRV

4 AC

CR 198

PRV

PROPOSED 6" WATER LINE

650

640
630
630
620
630

200 AC

390-334

PRV

ELMER H. TIMMERMAN

129+72.8 CURB
(35' P.D.R.)

NEW PAVEMENT FOR CONDUIT

140+75 END 3" FLUSHING VALVE

JOHN C. D.
A-235 TRAVEL

50

JOHN SAL

(44' P.D.R.)

EXISTING 3" WATER LINE

640

GREG BERGERON
County Road Administrator



1900 Georgetown Loop, Ste. B
Georgetown, Texas 78626
Telephone (512) 930-3330
Fax (512) 930-3335

Williamson County
Unified Road System

When specifically agreed to in writing and signed by a Williamson County Commissioner, or the County Road Administrator, Williamson County will permit the cutting of a roadbed in lieu of core drilling, provided the contractor or contractors agree to the following installation:

SPECIFICATION FOR CUTTING ROADBED IN LIEU OF CORE DRILLING

1. Compacted base material with concrete cap.
2. The utility shall be placed a minimum of 30" below the flow line.
3. Layer compacted and topped with 3" hot mix asphalt.
4. A performance bond, or other securities agreed upon by the County, must be pledged in the amount of the estimated cost of the road repairs, as agreed to by the contractor and Williamson County, prior to the commencing of a cutting of the roadbed.
5. A road cut permit fee, in the amount of \$120.00 per roadbed cut, must be submitted to the County Road Administrator's office prior to cutting the roadbed.

SPECIFICATION FOR CUTTING ROADBED IN LIEU OF CORE DRILLING
WITHIN AUSTIN ETJ

1. Roadbed cuts to be repaired in accordance with City of Austin specifications as outlined in their standard Specifications for Cuts in Public Right of Way Manual.
2. The utility shall be placed a minimum of 30" below the flow line.
3. The installation to be free from defects for a period of one (1) year from completion date. Any maintenance required during this period, caused by the cutting of a road, will be done by the contractor or contractors without cost to the County.
4. A performance bond, or other securities agreed upon by the County, must be pledged in the amount of the estimated cost of the road repairs, as agreed to by the contractor and County, prior to the commencing of a cutting of the roadbed.
5. A roadbed cut permit fee, in the amount of \$120.00 per roadbed cut, must be submitted to the County Road Administrator's office prior to cutting the roadbed.

This agreement must be entered into prior to the commencing of the cutting of a roadbed.

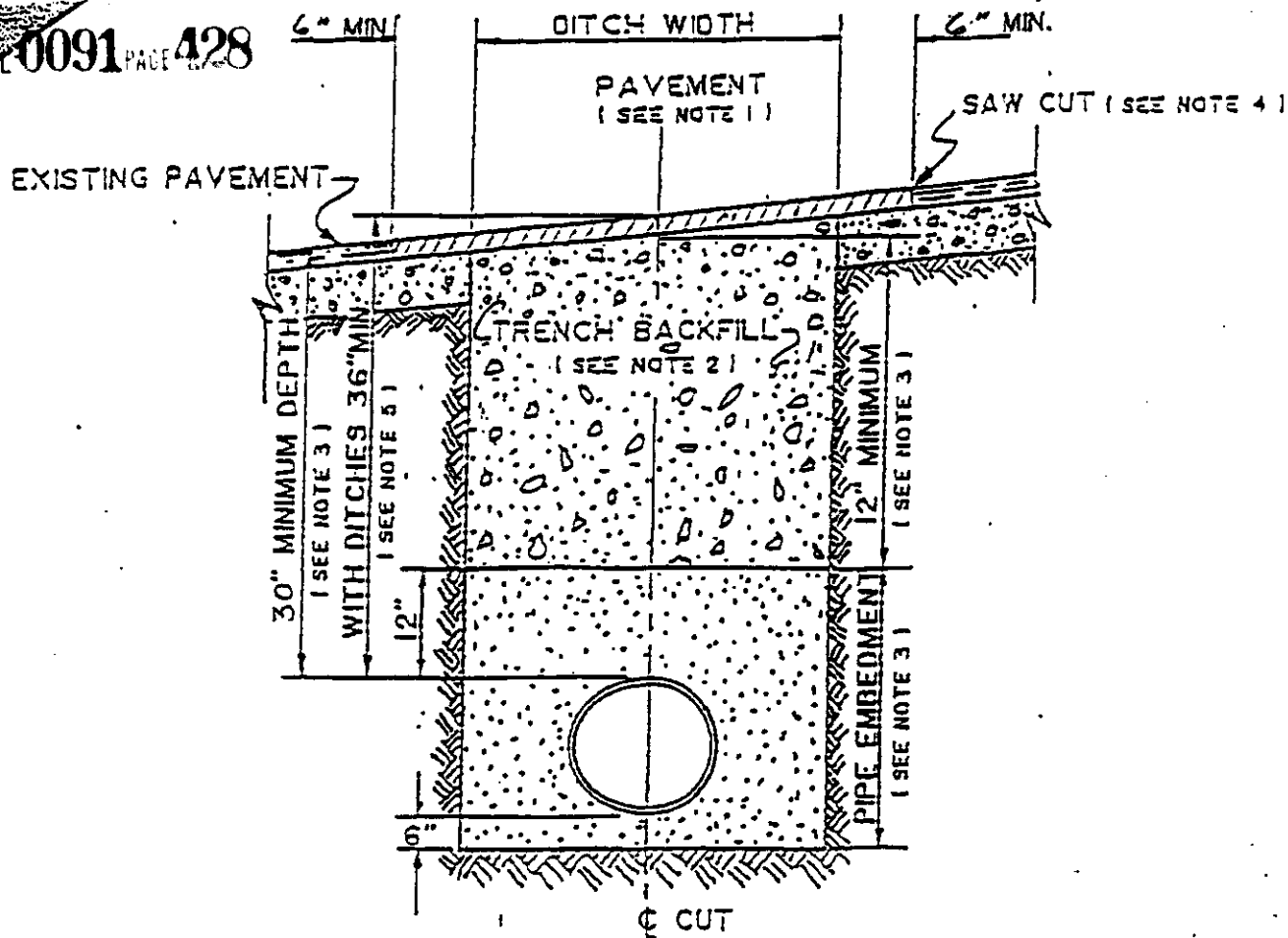

1. Hot mix asphalt 1 1/2" min. thickness. Roll in place to match existing surface. $\pm 1/8"$ tolerance.
2. Trench backfill shall be flexible base, compacted to 95% optimum in 8" layers unless otherwise approved and specified. Flexible base to match existing base thickness or 8 inches, whichever is greater (specifications: TSHD Item 248, Type A, Grade 2).
3. Pipe embedment (pipe envelope) size and materials shall be as specified elsewhere by the utility company and/or its engineers. Pipe depth shall be as specified elsewhere provided minimum depths are met.
4. Saw cut shall be made prior to ditch cut. If pavement is damaged during cut, a new saw cut shall be made beyond the damaged area and new pavement placed.
5. Where roadside ditches (bar ditches) are crossed by the utility pipe, minimum depth to the top of the pipe from centerline road elevation will be 36".

AGENDA ITEM # 5August 19, 1997*Consider granting final plat approval to The Ranch at Cypress Creek, Section 12.

Moved: Commissioner Heiligenstein

Seconded: Commissioner Boatright

Motion: To grant final plat approval to The Ranch at Cypress Creek, Section 12.

Vote: Motion carried 3 - 0

AGENDA ITEM # 6August 19, 1997*Consider setting date for public hearing on Thomas Subdivision.

Moved: Judge Doerfler

Seconded: Commissioner Boatright

Motion: To set 10:30 a.m. on September 16, 1997 as date for public hearing on Thomas Subdivision.

Vote: Motion carried 3 - 0

AGENDA ITEM # 7August 19, 1997*Consider granting final plat approval to Chandler Creek, Section 8.

Moved: Commissioner Heiligenstein

Seconded: Commissioner Boatright

Motion: To approve final plat to Chandler Creek, Section 8.

Vote: Motion carried 3 - 0

AGENDA ITEM # 8August 19, 1997*Discuss and take any appropriate action on San Gabriel River Estates (gated community with home owner maintained private streets).

Agenda item tabled until further notice.

AGENDA ITEM # 9August 19, 1997*Consider hiring surveyor to survey school lands.

Agenda item tabled until further notice.