

AGENDA ITEM # 4August 12, 1997*Consider noting in minutes any right-of-way work on any county road done by Road & Bridge Unified System.

Moved: Judge Doerfler

Seconded: Commissioner Mehevec

Motion: To note in minutes permission to dump spoils from drainage work on the property of **Clark Street Properties** in Garden Park Subdivision and**General Telephone Company** County Roads 106 and 470;**Southwestern Bell Telephone** on County Roads 204, 273, 272 and 170;**Southwest Milam Water** on County Road 425;**Sprint** on County Road 108;**The City of Thrall** on County Road 424.

Vote: Motion carried 5 - 0

< Clerk copy here >

WILLIAMSON COUNTY URS

Utility Requests - 08/12/97

Precinct I**Precinct II**

A. SWBT

1. CR 204, D652468 - Road Cut
2. CR 204, D650296 - Road Cut
3. CR 273 & Cr 272, D655656 - Bore & ROW

Precinct III

A. GTE

1. CR 106 - Bore

Precinct IV

A. The City of Thrall

1. CR 424 - Bore for water line

B. GTE

1. CR 470 - ROW

C. Sprint

1. CR 108 - Bore

D. Southwest Milam Water

1. CR 425 - Bore

E. SWBT

1. CR 170(Louis Henna Blvd.) - Bore & ROW

noted 8-12-97
John C. Doerfler

August 12, 1997

UNIFIED ROAD SYSTEM
OFF RIGHT-OF-WAY WORK

1. Garden Park Subdivision(off of SH 79) - Permission to dump spoils from drainage work on the property of Clark Street Properties(Pct. 4-DA).

WILLIAMSON COUNTY URS
Utility Requests - 08/12/97

Precinct I

Precinct II

- A. SWBT
 1. CR 204, D652468 - Road Cut
 2. CR 204, D650296 - Road Cut
 3. CR 273 & Cr 272, D655656 - Bore & ROW

Precinct III

- A. GTE
 1. CR 106 - Bore

Precinct IV

- A. The City of Thrall
 1. CR 424 - Bore for water line
- B. GTE
 1. CR 470 - ROW
- C. Sprint
 1. CR 108 - Bore
- D. Southwest Milam Water
 1. CR 425 - Bore
- E. SWBT
 1. CR 170(Louis Henna Blvd.) - Bore & ROW

GREG BERGERON
COUNTY ROAD ADMINISTRATOR



Williamson County
Unified Road System

1900 Georgetown Inner Loop, Suite B
Georgetown, Texas 78626
Telephone (512) 930-3330
Fax (512) 930-3335

6102
9P706GL#5

UTILITY INSTALLATION REQUEST

DATE: 7-28-97

TO: Williamson County Commissioners' Court
c/o County Engineer, County Road Administrator or County Commissioner

Formal notice is hereby given that GTE proposes to place a Buried Copper line within the right-of-way of CO RD 470 County Road as follows: Beginning at GTE STA 0+00 a buried cable to be placed inside South R.O.W. ending at GTE STA 19+37. Cable to be placed 30" Deep. END OF BURIED CONSTRUCTION.

The location and description of the proposed line and appurtenances is more fully shown on the drawing attached hereto. The line will be constructed & maintained on the County right-of-way in accordance with current Williamson County Specifications as directed by the County Engineer, County Road Administrator or County Commissioner.

Construction will begin on or after the 29th day of July 1997, and is estimated to be completed in 30 calendar days.

SUBMITTED BY FIRM: GTE AUTHORIZED SIGNATURE: _____ TITLE: _____ FIRM ADDRESS: 1700 N. Austin Ave. Georgetown PHONE # (512) 869-2234
CONTRACTOR (IF DIFFERENT FROM FIRM): _____
AUTHORIZED SIGNATURE: _____ TITLE: _____
ADDRESS: _____ PHONE # _____

Precinct #: 4

APPROVAL

This application is hereby approved subject to the following understandings and restrictions.

It is expressly understood that the said County Commissioners' Court does not imply hereby to grant any right, claim, title or easement in or upon this County Road; and it is further understood that in the future, should Williamson County, for any reason, need to work, improve, relocate, widen, increase, add to, decrease, or in any manner change the structure of this road or right-of-way, this line, if affected, will be moved at the direction of the Williamson County Engineer or County Commissioner. This installation work shall not damage any part of the roadway and adequate provisions shall be made to cause a minimum of inconvenience to traffic and adjacent property owners.

APPROVED BY WILLIAMSON COUNTY COMMISSIONERS' COURT

BY: Greg Bergeron
COUNTY ROAD ADMINISTRATOR

DATE: 8/1/97

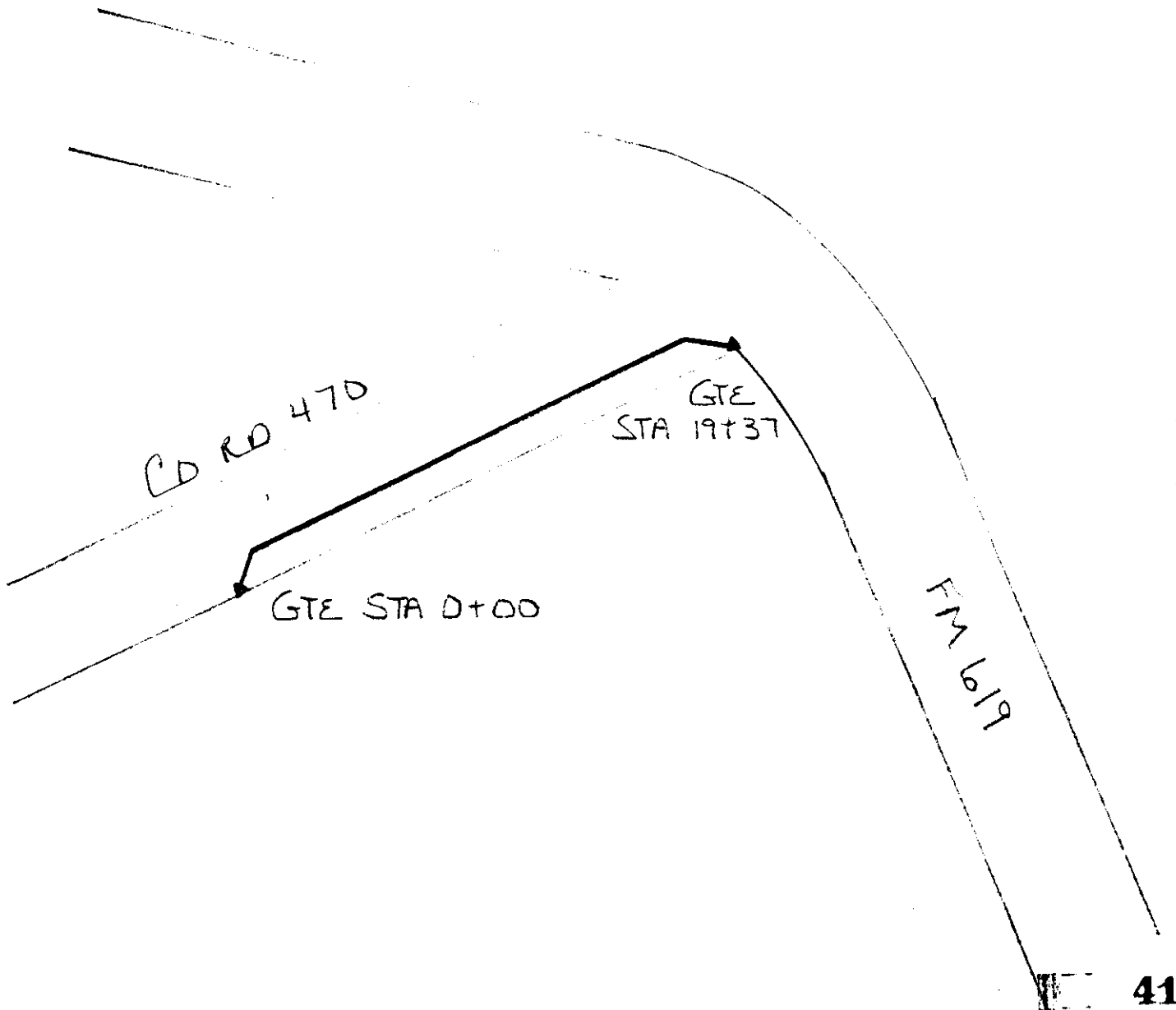

MC 600664
FORM ED-172
REV. 6-78

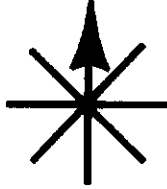
AREA <u>Texas AREA</u>		 SCALE <u>N.T.S.</u>	GENERAL TELEPHONE COMPANY OF THE SOUTHWEST	
TAX DIST. _____			LOCATION <u>16102 Coupland</u>	DESCRIPTION <u>PL CA TO SVE Dorman</u>
DESIGNED BY <u>BR</u>	DATE <u>7-28-97</u>		_____	
DRAWN BY <u>CMG</u>	DATE <u>7-28-97</u>		_____	
APPROVED BY _____	DATE _____		_____	
REVISED BY _____	DATE _____	SHEET <u>1</u> OF <u>1</u>	W.O. NO. <u>9P706GR#5</u>	

VOL 0090 G. BERGERON
County Road Administrator1900 Georgetown Loop, Ste. B
Georgetown, Texas 78626
Telephone (512) 930-3330
Fax (512) 930-3335Williamson County
Unified Road System

When specifically agreed to in writing and signed by a Williamson County Commissioner, or the County Road Administrator, Williamson County will permit the cutting of a roadbed in lieu of core drilling, provided the contractor or contractors agree to the following installation:

SPECIFICATION FOR CUTTING ROADBED IN LIEU OF CORE DRILLING

1. Compacted base material with concrete cap.
2. The utility shall be placed a minimum of 30" below the flow line.
3. Layer compacted and topped with 3" hot mix asphalt.
4. A performance bond, or other securities agreed upon by the County, must be pledged in the amount of the estimated cost of the road repairs, as agreed to by the contractor and Williamson County, prior to the commencing of a cutting of the roadbed.
5. A road cut permit fee, in the amount of \$120.00 per roadbed cut, must be submitted to the County Road Administrator's office prior to cutting the roadbed.

SPECIFICATION FOR CUTTING ROADBED IN LIEU OF CORE DRILLING
WITHIN AUSTIN ETJ

1. Roadbed cuts to be repaired in accordance with City of Austin specifications as outlined in their standard Specifications for Cuts in Public Right of Way Manual.
2. The utility shall be placed a minimum of 30" below the flow line.
3. The installation to be free from defects for a period of one (1) year from completion date. Any maintenance required during this period, caused by the cutting of a road, will be done by the contractor or contractors without cost to the County.
4. A performance bond, or other securities agreed upon by the County, must be pledged in the amount of the estimated cost of the road repairs, as agreed to by the contractor and County, prior to the commencing of a cutting of the roadbed.
5. A roadbed cut permit fee, in the amount of \$120.00 per roadbed cut, must be submitted to the County Road Administrator's office prior to cutting the roadbed.

This agreement must be entered into prior to the commencing of the cutting of a roadbed.

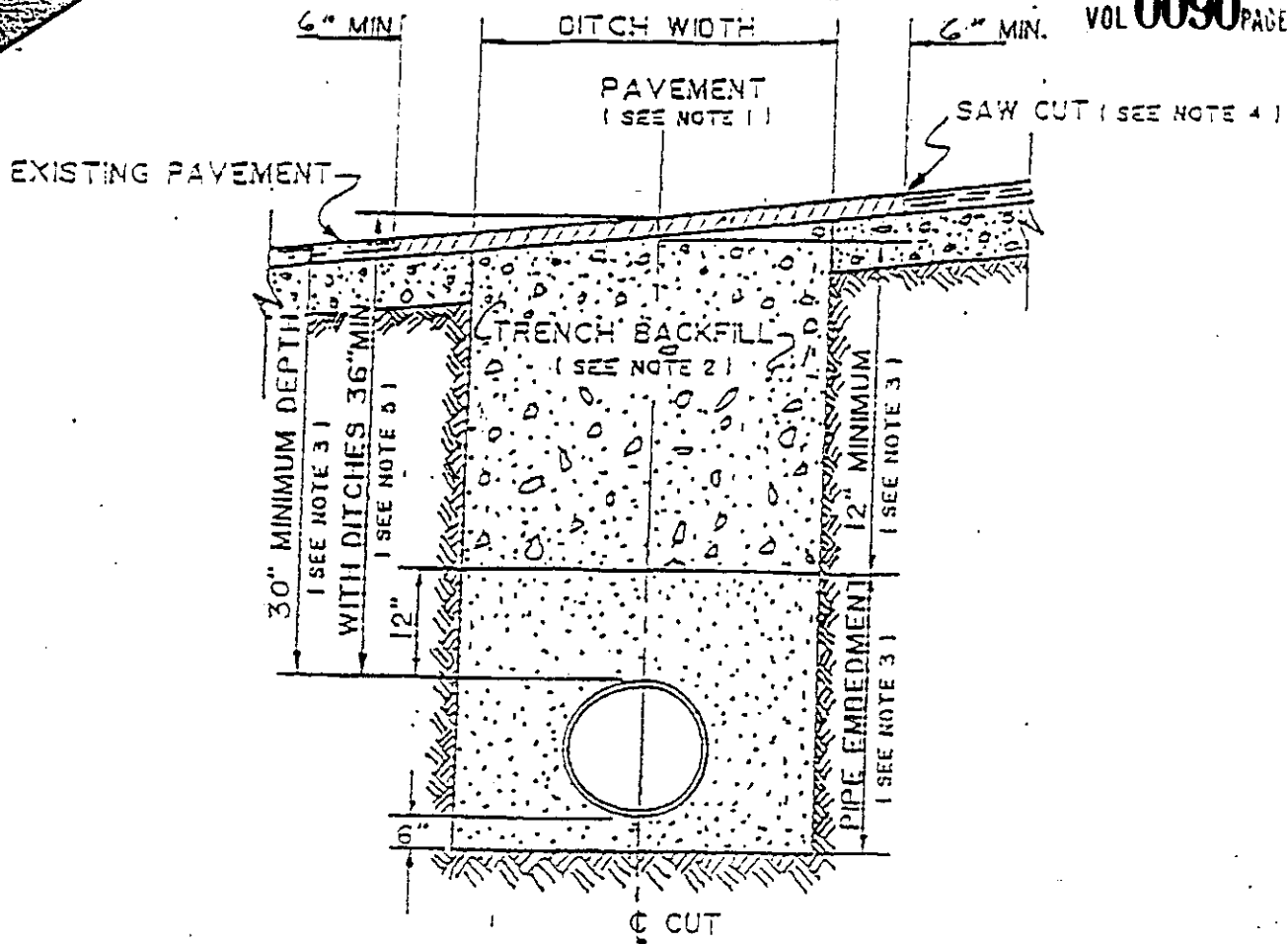

1. Hot mix asphalt 1 1/2" min. thickness. Roll in place to match existing surface. $\pm 1/8"$ tolerance.
2. Trench backfill shall be flexible base, compacted to 95% optimum in 8" layers unless otherwise approved and specified. Flexible base to match existing base thickness or 8 inches, whichever is greater (specifications: TSHD Item 248, Type A, Grade 2).
3. Pipe embedment (pipe envelope) size and materials shall be as specified elsewhere by the utility company and/or its engineers. Pipe depth shall be as specified elsewhere provided minimum depths are met.
4. Saw cut shall be made prior to ditch cut. If pavement is damaged during cut, a new saw cut shall be made beyond the damaged area and new pavement placed.
5. Where roadside ditches (bar ditches) are crossed by the utility pipe, minimum depth to the top of the pipe from centerline road elevation will be 36".

Received
8-4-97

5428
9P106 GR #72

GREG BERGERON
COUNTY ROAD ADMINISTRATOR



1900 Georgetown Inner Loop, Suite B
Georgetown, Texas 78626
Telephone (512) 930-3330
Fax (512) 930-3335

Williamson County
Unified Road System

UTILITY INSTALLATION REQUEST

DATE: 7-28-97

TO: Williamson County Commissioners' Court
c/o County Engineer, County Road Administrator or County Commissioner

Formal notice is hereby given that GTE proposes to place a Buried Communication line within the right-of-way of Co Rd 106 County Road as follows: BEGIN BURIED CONSTRUCTION ALONG THE EAST ROW AT GTE STA 0+00 AND PROCEEDING IN A SOUTH-EASTERLY DIRECTION FOR 1211 TO GTE STA 12+11, WHERE A 40" X 4" BORE WILL BE PLACED. ANOTHER BORE TO BE PLACED AT GTE STA 7+31, AT 36" DEPTH. The location and description of the proposed line and appurtenances is more fully shown on the drawing attached hereto. The line will be constructed & maintained on the County right-of-way in accordance with current Williamson County Specifications as directed by the County Engineer, County Road Administrator or County Commissioner.

Construction will begin on or after the 11 day of Aug 1997, and is estimated to be completed in 30 calendar days.

SUBMITTED BY FIRM: GTE AUTHORIZED
SIGNATURE: 1700 N Austin Ave TITLE: 1700 N Austin Ave FIRM ADDRESS: 1700 N Austin Ave
CONTRACTOR (IF DIFFERENT FROM FIRM): 1700 N Austin Ave PHONE # 512-869-2234
AUTHORIZED SIGNATURE: [Signature] TITLE: Deputy Engineer
ADDRESS: 1700 N Austin Ave PHONE # 512-869-2234

Precinct #: 3

APPROVAL

This application is hereby approved subject to the following understandings and restrictions.

It is expressly understood that the said County Commissioners' Court does not imply hereby to grant any right, claim, title or easement in or upon this County Road; and it is further understood that in the future, should Williamson County, for any reason, need to work, improve, relocate, widen, increase, add to, decrease, or in any manner change the structure of this road or right-of-way, this line, if affected, will be moved at the direction of the Williamson County Engineer or County Commissioner. This installation work shall not damage any part of the roadway and adequate provisions shall be made to cause a minimum of inconvenience to traffic and adjacent property owners.

APPROVED BY WILLIAMSON COUNTY COMMISSIONERS' COURT

BY: [Signature]
COUNTY ROAD ADMINISTRATOR

DATE: 8/6/97

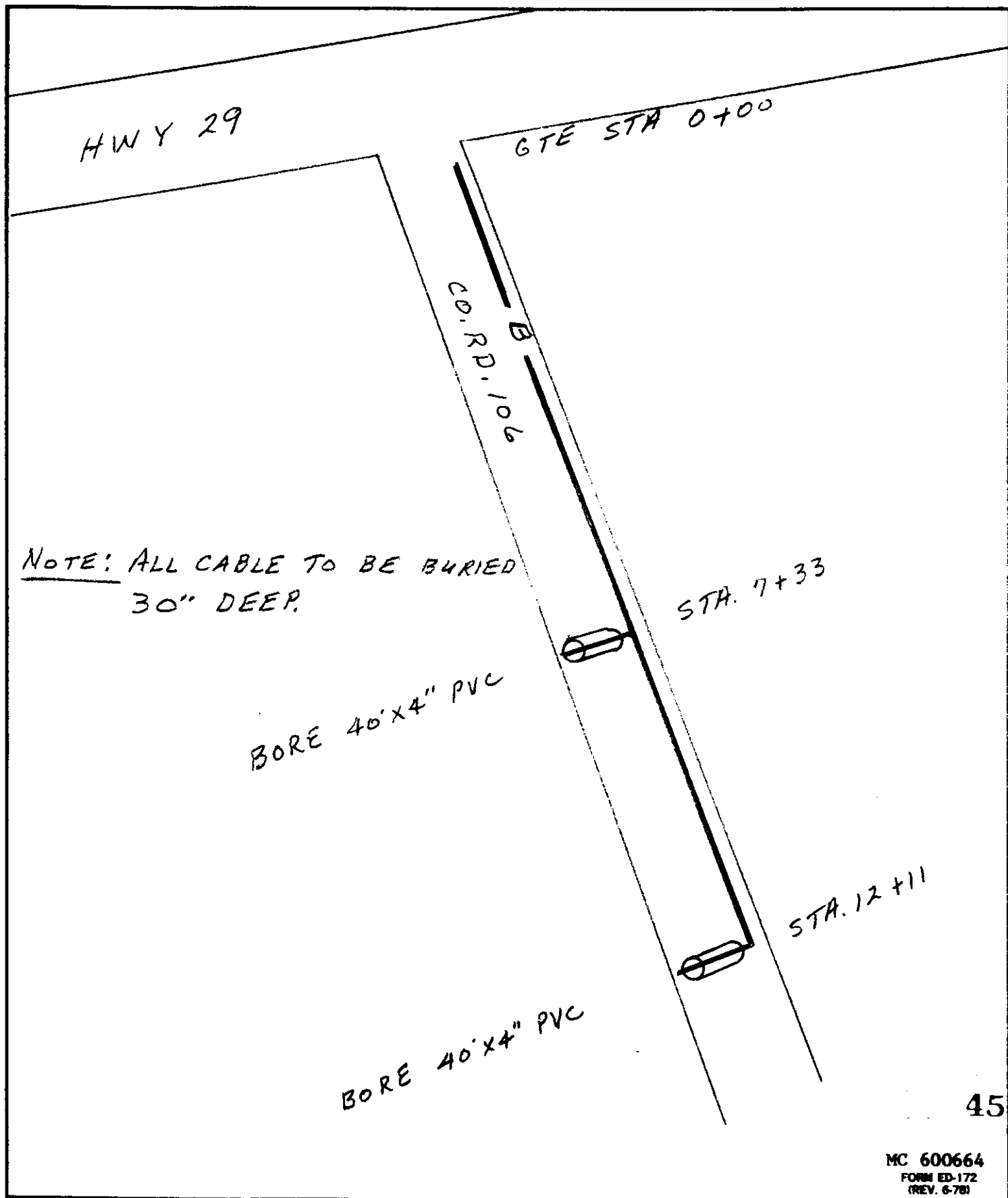

45

MC 600664
FORM ED-172
(REV. 6-78)

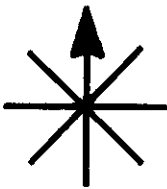
AREA <u>CENTRAL</u>			GENERAL TELEPHONE COMPANY OF THE SOUTHWEST	
TAX DIST. _____			LOCATION <u>5428 GEORGETOWN</u>	
ENGINEER BY <u>MCO</u>	DATE <u>7-28-97</u>		DESCRIPTION <u>PERMIT - CO RD 106</u>	
DRAWN BY <u>MCO</u>	DATE <u>7-28-97</u>			
APPROVED BY _____	DATE _____			
REVISOR BY _____	DATE _____	SCALE <u>N.T.S.</u>	SHEET <u>1</u> OF <u>1</u>	W.O. NO. <u>9P706 GR072</u>

GTE
SOUTHWEST
INCORPORATED

GEORGETOWN, TEXAS
Exchange Area Boundary

6th Revised
CANCELLING 5th Revised

SHEET NO. 90A
SHEET NO. 90A

WORK LOCATION
9P706 GR072

OSCAR C. GOMEZ
Vice President - Regulatory & Governmental Affairs

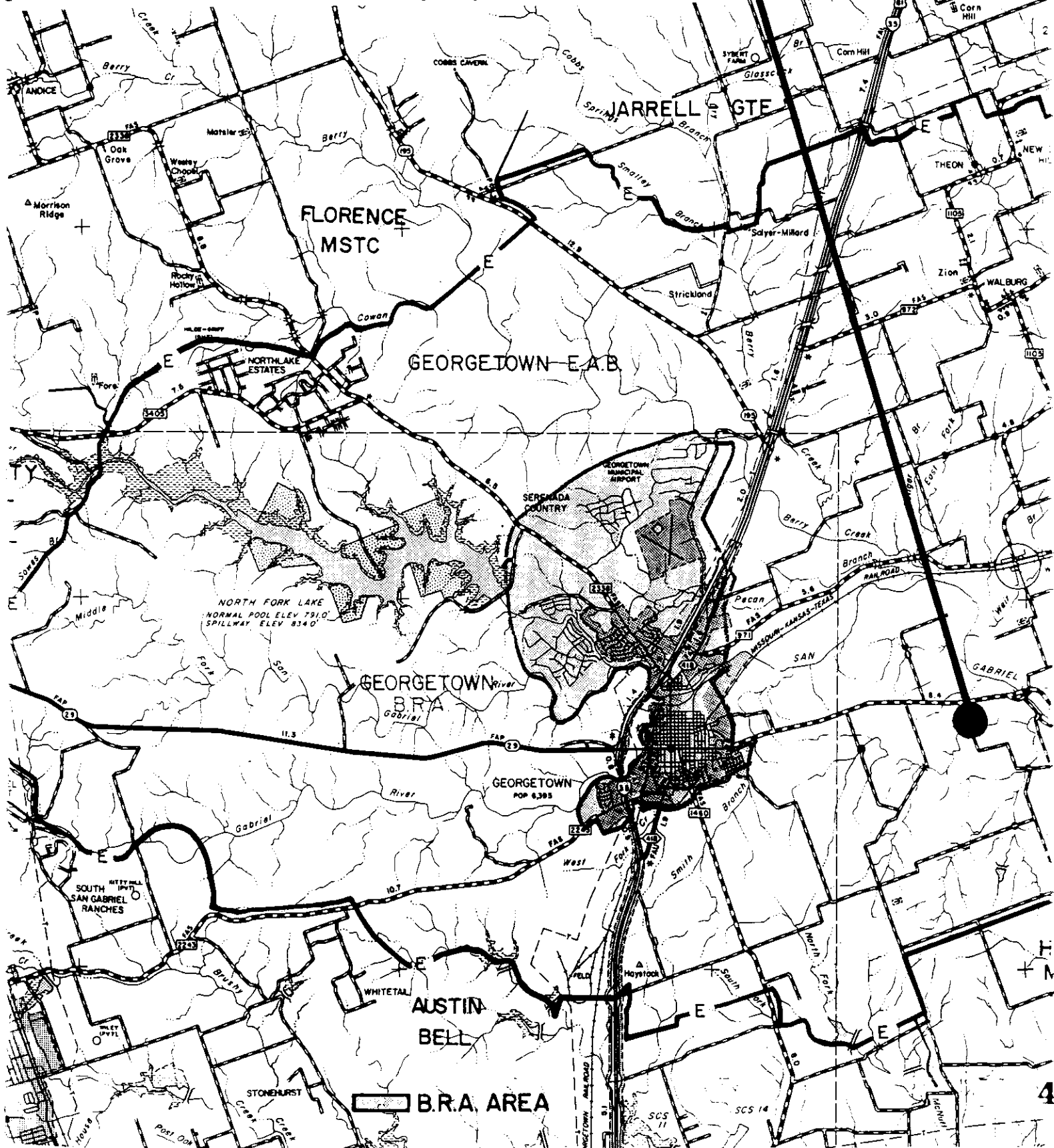

GREG BERGERON
County Road Administrator



1900 Georgetown Loop, Ste. B
Georgetown, Texas 78626
Telephone (512) 930-3330
Fax (512) 930-3335

Williamson County
Unified Road System

When specifically agreed to in writing and signed by a Williamson County Commissioner, or the County Road Administrator, Williamson County will permit the cutting of a roadbed in lieu of core drilling, provided the contractor or contractors agree to the following installation:

SPECIFICATION FOR CUTTING ROADBED IN LIEU OF CORE DRILLING

1. Compacted base material with concrete cap.
2. The utility shall be placed a minimum of 30" below the flow line.
3. Layer compacted and topped with 3" hot mix asphalt.
4. A performance bond, or other securities agreed upon by the County, must be pledged in the amount of the estimated cost of the road repairs, as agreed to by the contractor and Williamson County, prior to the commencing of a cutting of the roadbed.
5. A road cut permit fee, in the amount of \$120.00 per roadbed cut, must be submitted to the County Road Administrator's office prior to cutting the roadbed.

SPECIFICATION FOR CUTTING ROADBED IN LIEU OF CORE DRILLING
WITHIN AUSTIN ETJ

1. Roadbed cuts to be repaired in accordance with City of Austin specifications as outlined in their standard Specifications for Cuts in Public Right of Way Manual.
2. The utility shall be placed a minimum of 30" below the flow line.
3. The installation to be free from defects for a period of one (1) year from completion date. Any maintenance required during this period, caused by the cutting of a road, will be done by the contractor or contractors without cost to the County.
4. A performance bond, or other securities agreed upon by the County, must be pledged in the amount of the estimated cost of the road repairs, as agreed to by the contractor and County, prior to the commencing of a cutting of the roadbed.
5. A roadbed cut permit fee, in the amount of \$120.00 per roadbed cut, must be submitted to the County Road Administrator's office prior to cutting the roadbed.

This agreement must be entered into prior to the commencing of the cutting of a roadbed.

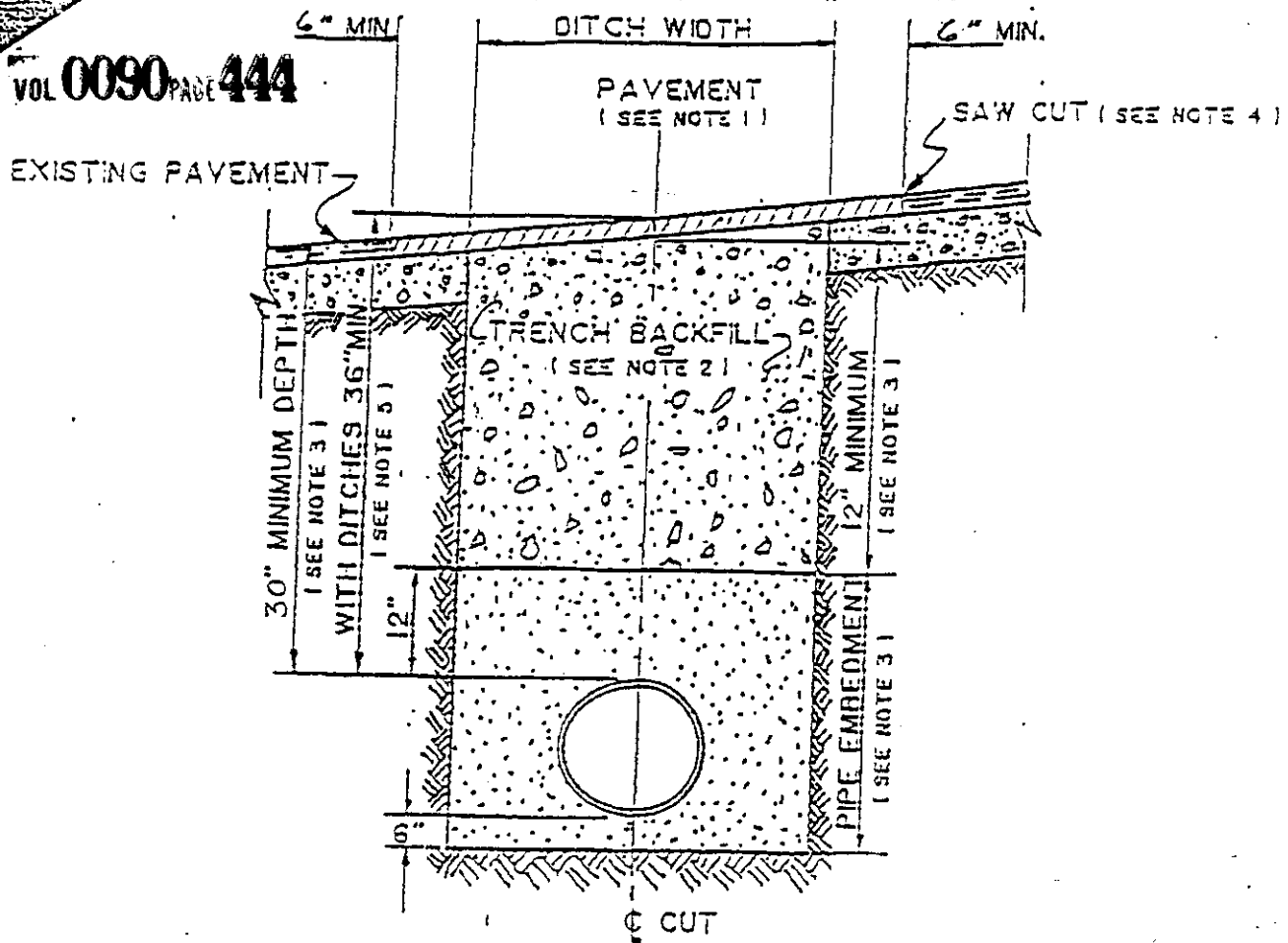

1. Hot mix asphalt 1 1/2" min. thickness. Roll in place to match existing surface. $\pm 1/8"$ tolerance.
2. Trench backfill shall be flexible base, compacted to 95% optimum in 8" layers unless otherwise approved and specified. Flexible base to match existing base thickness or 8 inches, whichever is greater (specifications: TSHD Item 248, Type A, Grade 2).
3. Pipe embedment (pipe envelope) size and materials shall be as specified elsewhere by the utility company and/or its engineers. Pipe depth shall be as specified elsewhere provided minimum depths are met.
4. Saw cut shall be made prior to ditch cut. If pavement is damaged during cut, a new saw cut shall be made beyond the damaged area and new pavement placed.
5. Where roadside ditches (bar ditches) are crossed by the utility pipe, minimum depth to the top of the pipe from centerline road elevation will be 36".

0607791

VOL 0090 PAGE 445

GREG BERGERON
COUNTY ROAD ADMINISTRATOR



1900 Georgetown Inner Loop, Suite B
Georgetown, Texas 78626
Telephone (512) 930-3330
Fax (512) 930-3335

Williamson County
Unified Road System

UTILITY INSTALLATION REQUEST

DATE: 8/1/97

TO: Williamson County Commissioners' Court
c/o County Engineer, County Road Administrator or County Commissioner

Formal notice is hereby given that SOUTHWESTERN BELL proposes to place
a CABLE line within the right-of-way of LEWIS
VENNA BLVD (CR170) County Road as follows:
"SEE ATTACHED PLAN"

The location and description of the proposed line and appurtenances is more fully shown on the drawing attached hereto. The line will be constructed & maintained on the County right-of-way in accordance with current Williamson County Specifications as directed by the County Engineer, County Road Administrator or County Commissioner.

Construction will begin on or after the 1st day of August 1997, and is estimated to be completed in 30 calendar days.

SUBMITTED BY FIRM: SOUTHWESTERN BELL TELEPHONE AUTHORIZED
SIGNATURE: [Signature] TITLE: MGR-ENG DESIGN FIRM ADDRESS: 1016
GUADALUPE, RM 406 PHONE # 870-5298
CONTRACTOR (IF DIFFERENT FROM FIRM):
AUTHORIZED SIGNATURE: TITLE:
ADDRESS: PHONE #

Precinct #: 4

APPROVAL

This application is hereby approved subject to the following understandings and restrictions.

It is expressly understood that the said County Commissioners' Court does not imply hereby to grant any right, claim, title or easement in or upon this County Road; and it is further understood that in the future, should Williamson County, for any reason, need to work, improve, relocate, widen, increase, add to, decrease, or in any manner change the structure of this road or right-of-way, this line, if affected, will be moved at the direction of the Williamson County Engineer or County Commissioner. This installation work shall not damage any part of the roadway and adequate provisions shall be made to cause a minimum of inconvenience to traffic and adjacent property owners.

APPROVED BY WILLIAMSON COUNTY COMMISSIONERS' COURT

BY: [Signature]
COUNTY ROAD ADMINISTRATOR

DATE: 8/2/97

8-6-97
Bore + Row
R.J.

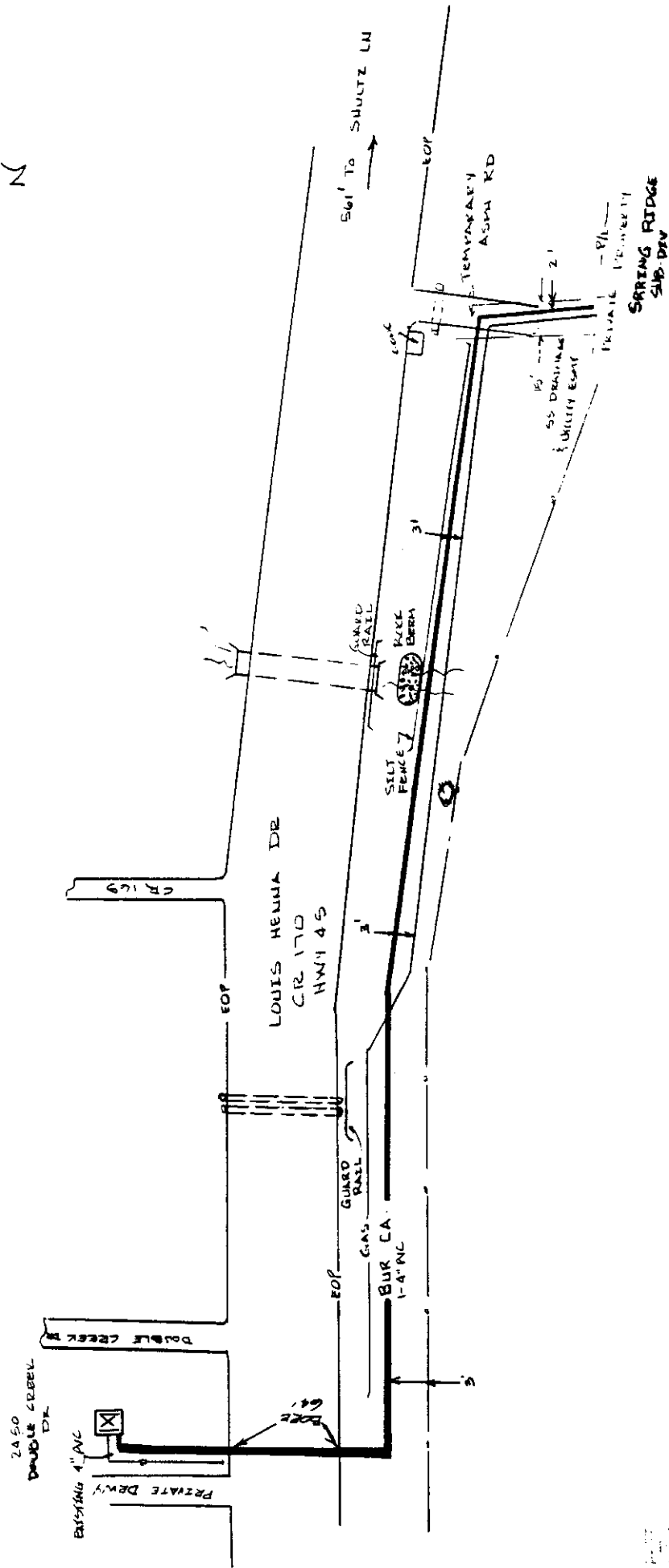
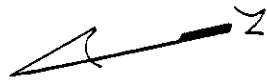

"VERIFY SKETCH"

GREG BERGERON
County Road Administrator



1900 Georgetown Loop, Ste. B
Georgetown, Texas 78626
Telephone (512) 930-3330
Fax (512) 930-3335

**Williamson County
Unified Road System**

When specifically agreed to in writing and signed by a Williamson County Commissioner, or the County Road Administrator, Williamson County will permit the cutting of a roadbed in lieu of core drilling, provided the contractor or contractors agree to the following installation:

SPECIFICATION FOR CUTTING ROADBED IN LIEU OF CORE DRILLING

1. Compacted base material with concrete cap.
2. The utility shall be placed a minimum of 30" below the flow line.
3. Layer compacted and topped with 3" hot mix asphalt.
4. A performance bond, or other securities agreed upon by the County, must be pledged in the amount of the estimated cost of the road repairs, as agreed to by the contractor and Williamson County, prior to the commencing of a cutting of the roadbed.
5. A road cut permit fee, in the amount of \$120.00 per roadbed cut, must be submitted to the County Road Administrator's office prior to cutting the roadbed.

**SPECIFICATION FOR CUTTING ROADBED IN LIEU OF CORE DRILLING
WITHIN AUSTIN ETJ**

1. Roadbed cuts to be repaired in accordance with City of Austin specifications as outlined in their standard Specifications for Cuts in Public Right of Way Manual.
2. The utility shall be placed a minimum of 30" below the flow line.
3. The installation to be free from defects for a period of one (1) year from completion date. Any maintenance required during this period, caused by the cutting of a road, will be done by the contractor or contractors without cost to the County.
4. A performance bond, or other securities agreed upon by the County, must be pledged in the amount of the estimated cost of the road repairs, as agreed to by the contractor and County, prior to the commencing of a cutting of the roadbed.
5. A roadbed cut permit fee, in the amount of \$120.00 per roadbed cut, must be submitted to the County Road Administrator's office prior to cutting the roadbed.

This agreement must be entered into prior to the commencing of the cutting of a roadbed.

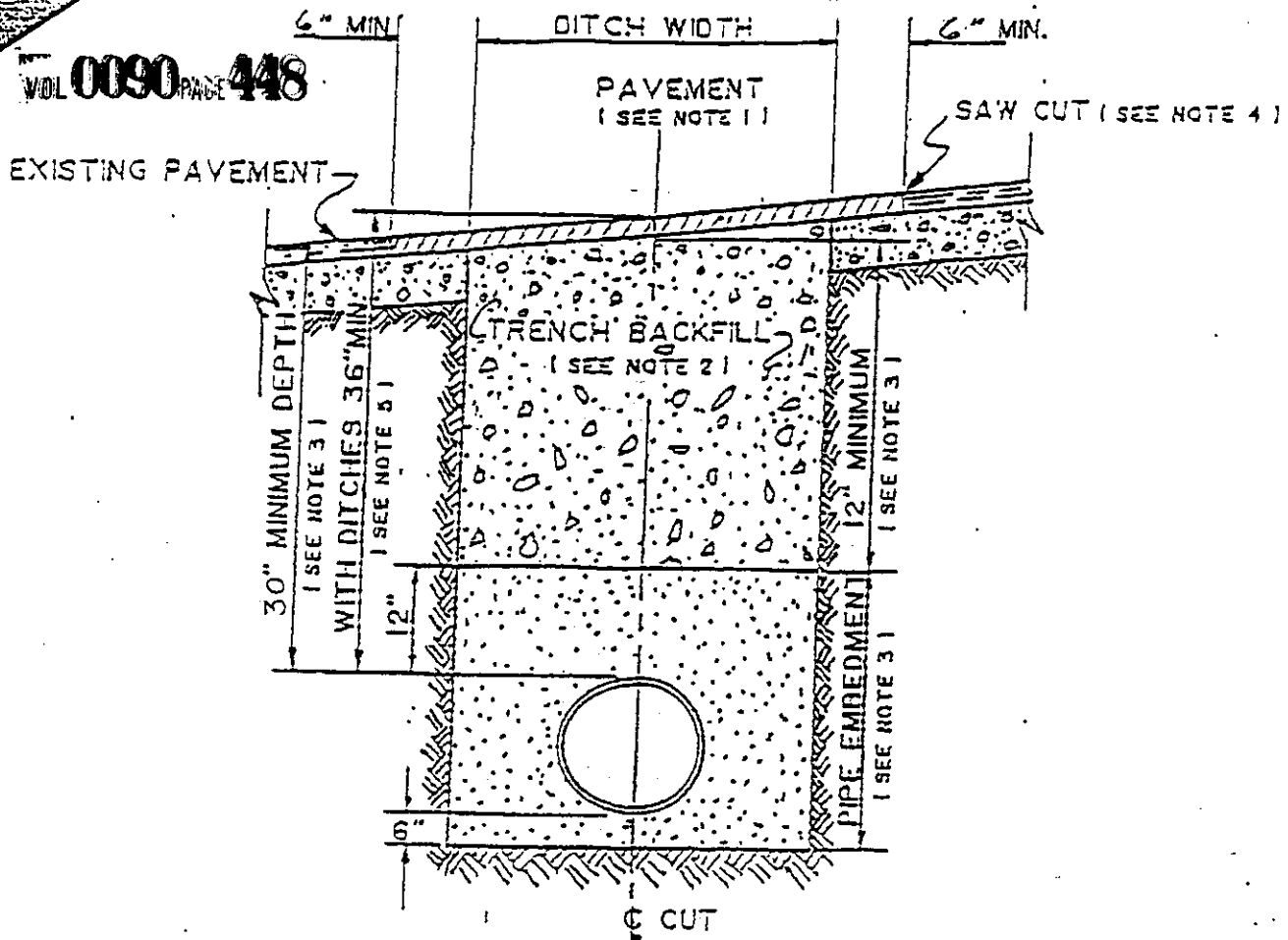

1. Hot mix asphalt 1 1/2" min. thickness. Roll in place to match existing surface. $\pm 1/8"$ tolerance.
2. Trench backfill shall be flexible base, compacted to 95% optimum in 8" layers unless otherwise approved and specified. Flexible base to match existing base thickness or 8 inches, whichever is greater (specifications: TSHD Item 248, Type A, Grade 2).
3. Pipe embedment (pipe envelope) size and materials shall be as specified elsewhere by the utility company and/or its engineers. Pipe depth shall be as specified elsewhere provided minimum depths are met.
4. Saw cut shall be made prior to ditch cut. If pavement is damaged during cut, a new saw cut shall be made beyond the damaged area and new pavement placed.
5. Where roadside ditches (bar ditches) are crossed by the utility pipe, minimum depth to the top of the pipe from centerline road elevation will be 36".

GREG BERGERON
COUNTY ROAD ADMINISTRATOR



1900 Georgetown Inner Loop, Suite B
Georgetown, Texas 78626
Telephone (512) 930-3330
Fax (512) 930-3335

Williamson County
Unified Road System

UTILITY INSTALLATION REQUEST

DATE: July 29, 1997

TO: Williamson County Commissioners' Court
c/o County Engineer, County Road Administrator or County Commissioner

Formal notice is hereby given that Southwest Milam Water proposes to place a potable line within the right-of-way of 425 Williamson County Road as follows: Bore and encase a 1 1/4" carrier water line within a 2" pipe across CR 425 approximately 75 feet south of the CR 425 & CR 426 intersection. Pipe to encase from ditch line to ditch line.

The location and description of the proposed line and appurtenances is more fully shown on the drawing attached hereto. The line will be constructed & maintained on the County right-of-way in accordance with current Williamson County Specifications as directed by the County Engineer, County Road Administrator or County Commissioner.

Construction will begin on or after the 12th day of August 1997, and is estimated to be completed in 1 calendar days.

SUBMITTED BY FIRM: Southwest Milam Water Supply Corporation AUTHORIZED SIGNATURE: _____ TITLE: Manager FIRM ADDRESS: P.O. Box 232 Rockdale, Tx. 76567 PHONE # 512-446-2604

CONTRACTOR (IF DIFFERENT FROM FIRM): _____ AUTHORIZED SIGNATURE: _____ TITLE: _____ ADDRESS: _____ PHONE # _____

Precinct #: 4

APPROVAL

This application is hereby approved subject to the following understandings and restrictions.

It is expressly understood that the said County Commissioners' Court does not imply hereby to grant any right, claim, title or easement in or upon this County Road; and it is further understood that in the future, should Williamson County, for any reason, need to work, improve, relocate, widen, increase, add to, decrease, or in any manner change the structure of this road or right-of-way, this line, if affected, will be moved at the direction of the Williamson County Engineer or County Commissioner. This installation work shall not damage any part of the roadway and adequate provisions shall be made to cause a minimum of inconvenience to traffic and adjacent property owners.

APPROVED BY WILLIAMSON COUNTY COMMISSIONERS' COURT

BY: [Signature]
COUNTY ROAD ADMINISTRATOR

DATE: 8/6/97

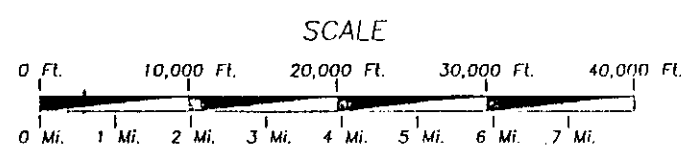
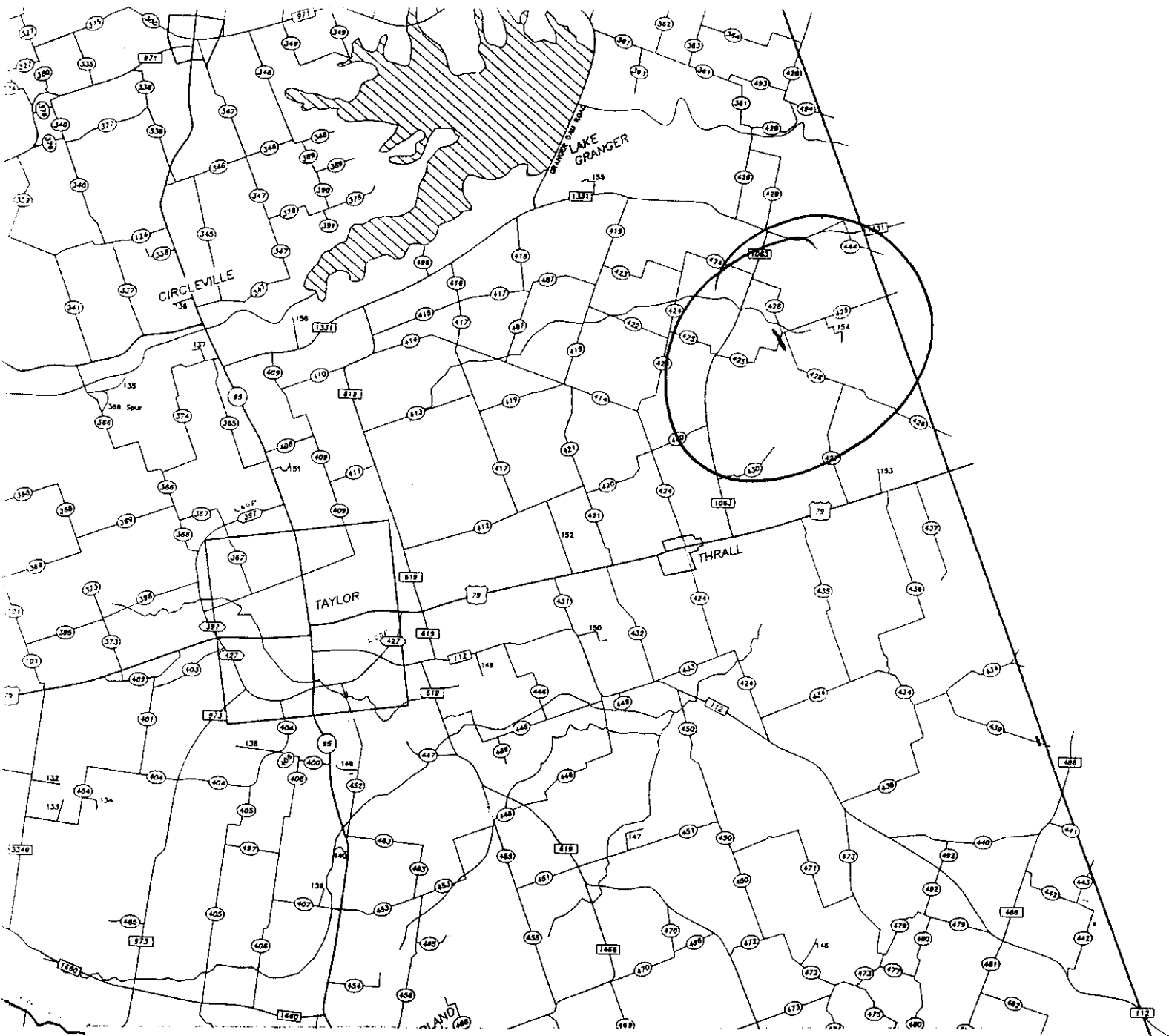

Prepared by:
 STEGER & BIZZELL ENGINEERING, INC.
 Job No. 17578
 Plot Scale 1" = 8250'

NOTICE

This map has been prepared for information within the Williamson County 9-1-1
 Addressing Office. Accuracy is limited to the validity of available data.

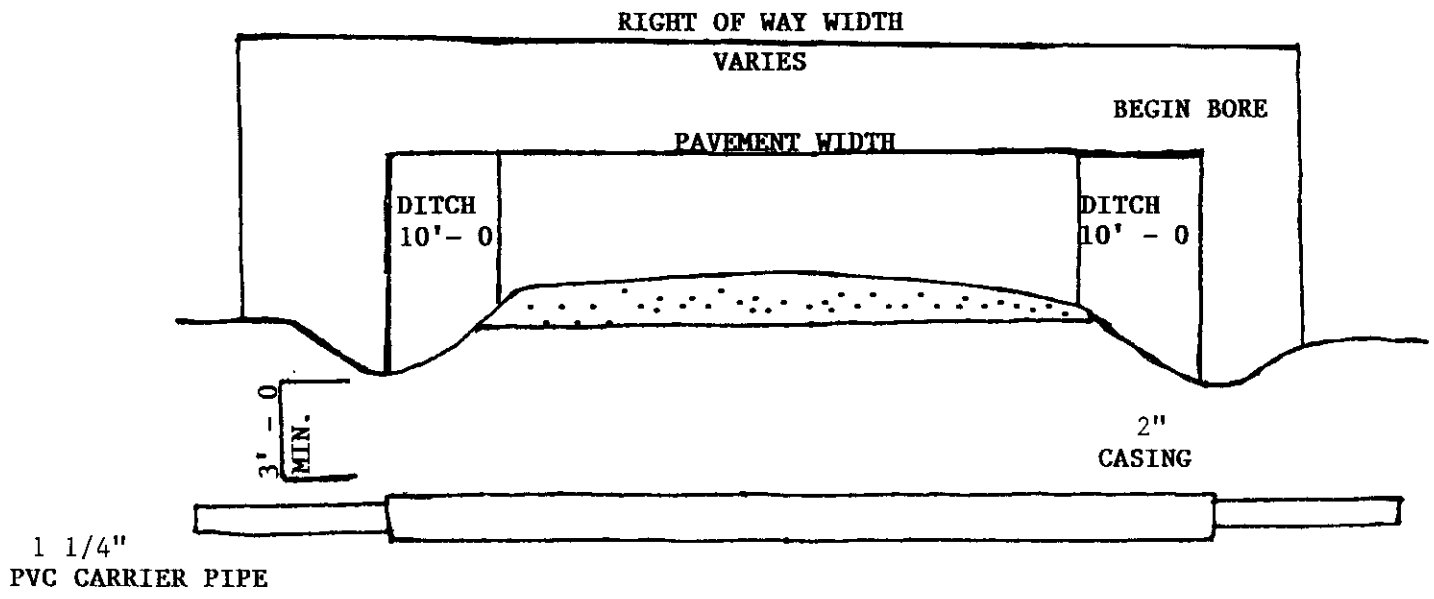

GREG BERGERON
County Road Administrator



1900 Georgetown Loop, Sta. B
Georgetown, Texas 78626
Telephone (512) 930-3330
Fax (512) 930-3335

Williamson County
Unified Road System

When specifically agreed to in writing and signed by a Williamson County Commissioner, or the County Road Administrator, Williamson County will permit the cutting of a roadbed in lieu of core drilling, provided the contractor or contractors agree to the following installation:

SPECIFICATION FOR CUTTING ROADBED IN LIEU OF CORE DRILLING

1. Compacted base material with concrete cap.
2. The utility shall be placed a minimum of 30" below the flow line.
3. Layer compacted and topped with 3" hot mix asphalt.
4. A performance bond, or other securities agreed upon by the County, must be pledged in the amount of the estimated cost of the road repairs, as agreed to by the contractor and Williamson County, prior to the commencing of a cutting of the roadbed.
5. A road cut permit fee, in the amount of \$120.00 per roadbed cut, must be submitted to the County Road Administrator's office prior to cutting the roadbed.

SPECIFICATION FOR CUTTING ROADBED IN LIEU OF CORE DRILLING
WITHIN AUSTIN ETJ

1. Roadbed cuts to be repaired in accordance with City of Austin specifications as outlined in their standard Specifications for Cuts in Public Right of Way Manual.
2. The utility shall be placed a minimum of 30" below the flow line.
3. The installation to be free from defects for a period of one (1) year from completion date. Any maintenance required during this period, caused by the cutting of a road, will be done by the contractor or contractors without cost to the County.
4. A performance bond, or other securities agreed upon by the County, must be pledged in the amount of the estimated cost of the road repairs, as agreed to by the contractor and County, prior to the commencing of a cutting of the roadbed.
5. A roadbed cut permit fee, in the amount of \$120.00 per roadbed cut, must be submitted to the County Road Administrator's office prior to cutting the roadbed.

This agreement must be entered into prior to the commencing of the cutting of a roadbed.

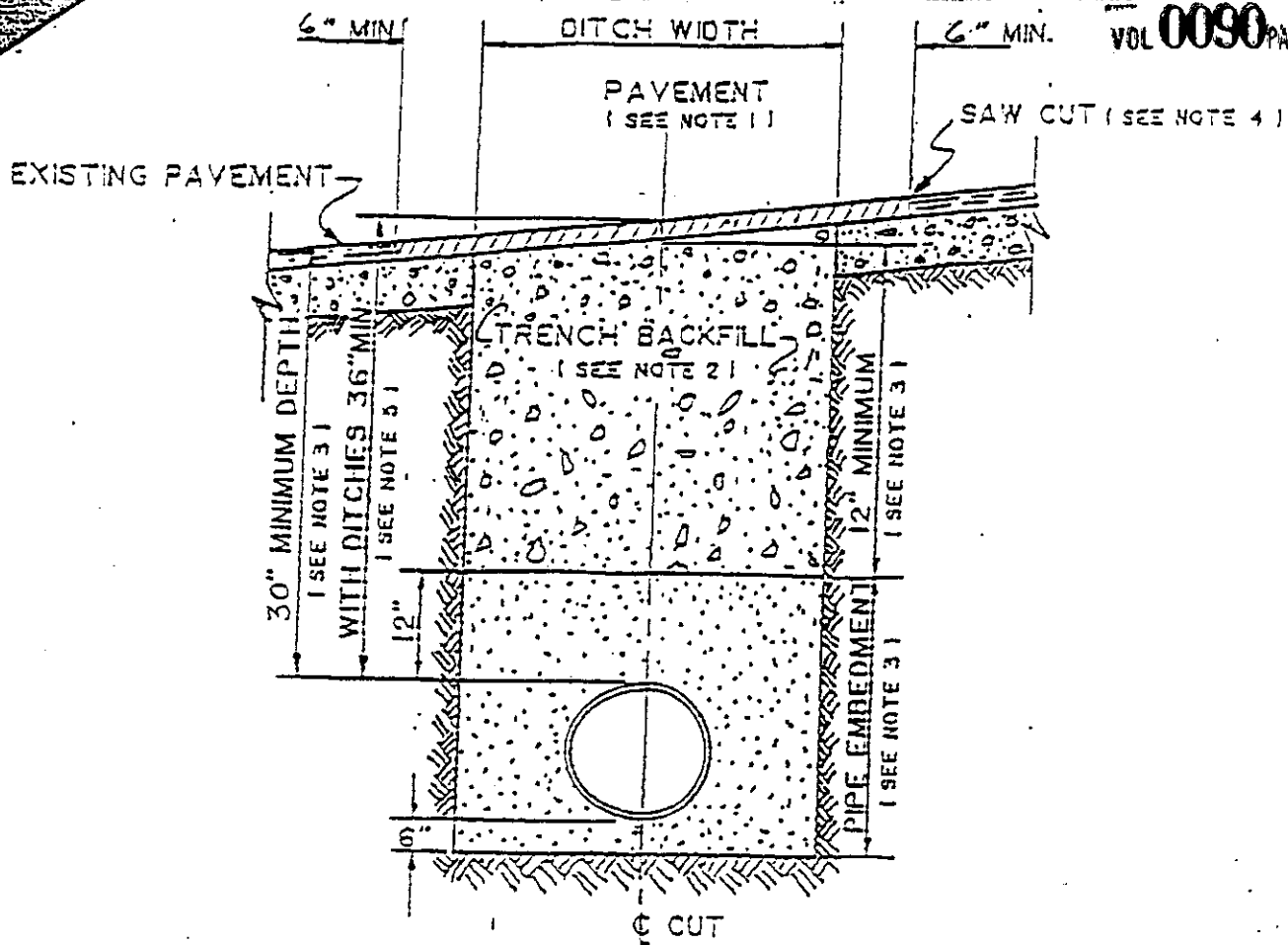

1. Hot mix asphalt 1 1/2" min. thickness. Roll in place to match existing surface. $\pm 1/8"$ tolerance.
2. Trench backfill shall be flexible base, compacted to 95% optimum in 8" layers unless otherwise approved and specified. Flexible base to match existing base thickness or 8 inches, whichever is greater (specifications: TSHD Item 248, Type A, Grade 2).
3. Pipe embedment (pipe envelope) size and materials shall be as specified elsewhere by the utility company and/or its engineers. Pipe depth shall be as specified elsewhere provided minimum depths are met.
4. Saw cut shall be made prior to ditch cut. If pavement is damaged during cut, a new saw cut shall be made beyond the damaged area and new pavement placed.
5. Where roadside ditches (bar ditches) are crossed by the utility pipe, minimum depth to the top of the pipe from centerline road elevation will be 36".

received
8-4-97

1900 Georgetown Inner Loop, Suite B
Georgetown, Texas 78626
Telephone (512) 930-3330
Fax (512) 930-3335

GREG BERGERON
County Road Administrator

Williamson County
Unified Road System

UTILITY INSTALLATION REQUEST

DATE: July 29, 1997

TO: Williamson County Commissioners' Court c/o County Engineer or County Commissioner

Formal notice is hereby given that Sprint proposes to place a buried communication cable within the right-of-way of CR 108 County Road as follows:

As requested by Williamson County; Dorothy Fisher, contact person, 512 365-2311 South of the intersection of CR 164, along the west right-of-way of CR 108 at the culvert crossing, we will replace existing cable with a new section to meet new depth requirements. Also, at the same location, it will be necessary to bore the road to provide new service to Rick Tillotson.

See attachments.

The location and description of the proposed line and appurtenances is more fully shown on the drawing attached hereto. The line will be constructed & maintained on the County right-of-way in accordance with current Williamson County Specifications as directed by the County Engineer or County Commissioner.

Construction will begin on or after the 31st day of July, 1997, and is estimated to be completed in 02 calendar days.

SUBMITTED BY FIRM: Sprint
AUTHORIZED SIGNATURE: Sherry Witcher-Irvine TITLE: OSP Engineer
FIRM ADDRESS: 1214 Dogwood, Killeen, TX 76543 (P.O. Box 1150, 76540) PHONE# 817 690-9337
CONTRACTOR (IF DIFFERENT FROM FIRM:): Isbell Construction, Inc.
AUTHORIZED SIGNATURE: _____ TITLE: Constr. Supvr
ADDRESS: P. O. Box 266, Florence, Texas 76527 PHONE # 817 690-9339

Precinct # 4

APPROVAL

The application is hereby approved subject to the following understandings and restrictions.

It is expressly understood that the said County Commissioners' Court does not imply hereby to grant any right, claim, title or easement in or upon this County Road; and it is further understood that in the future, should Williamson County, for any reason, need to work, improve, relocate, widen, increase, add to, decrease, or in any manner change the structure of this road or right-of-way, this line, if affected, will be moved at the direction of the Williamson County Engineer or County Commissioner. This installation work shall not damage any part of the roadway and adequate provisions shall be made to cause a minimum of inconvenience to traffic and adjacent property owners.

APPROVED BY WILLIAMSON COUNTY COMMISSIONERS' COURT

BY: Gary Bergeron
COUNTY ROAD ADMINISTRATOR

DATE: 8/6/97

58

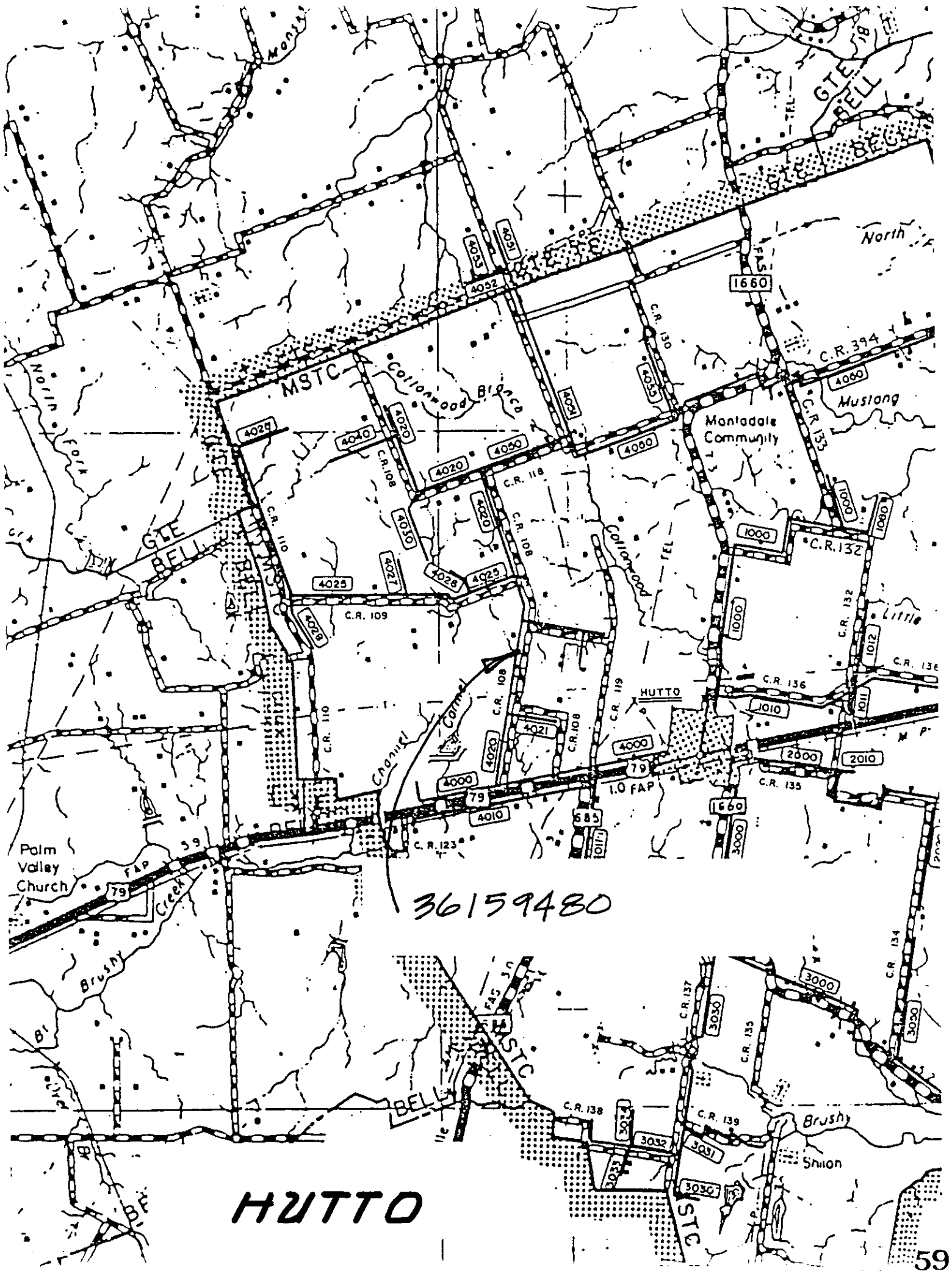

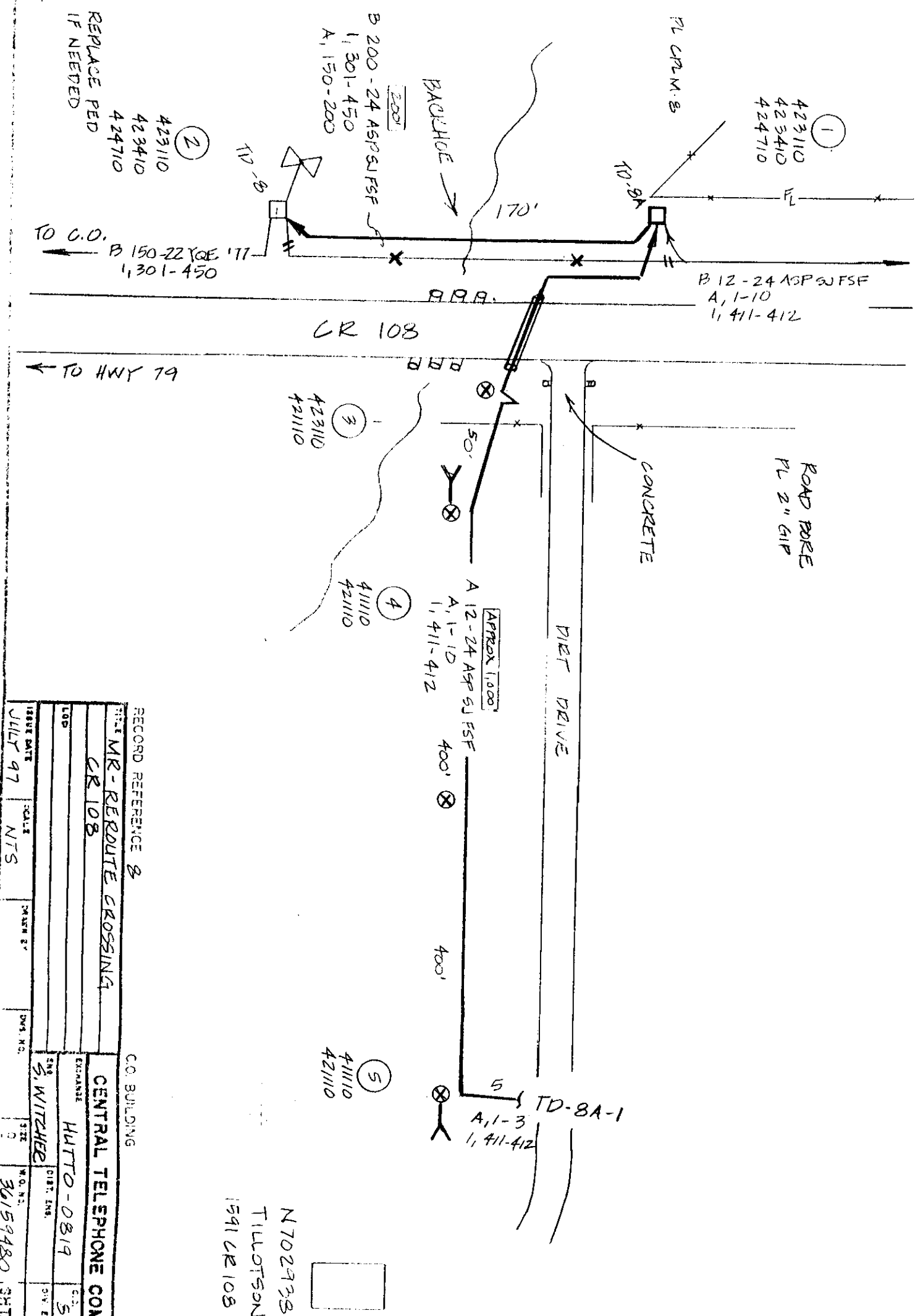

RECORD REFERENCE 8									
MR-REROUTE CROSSING									
CR 108									
CENTRAL TELEPHONE COMPANY									
EXCHANGE									
HUTTO-0819									
S. WITZLER									
36159480									
SMT. LOF 1									

N702938
TILLOTSON
1591 CR 108

GREG BERGERON
County Road Administrator



1900 Georgetown Loop, Ste. B
Georgetown, Texas 78626
Telephone (512) 930-3330
Fax (512) 930-3335

Williamson County
Unified Road System

When specifically agreed to in writing and signed by a Williamson County Commissioner, or the County Road Administrator, Williamson County will permit the cutting of a roadbed in lieu of core drilling, provided the contractor or contractors agree to the following installation:

SPECIFICATION FOR CUTTING ROADBED IN LIEU OF CORE DRILLING

1. Compacted base material with concrete cap.
2. The utility shall be placed a minimum of 30" below the flow line.
3. Layer compacted and topped with 3" hot mix asphalt.
4. A performance bond, or other securities agreed upon by the County, must be pledged in the amount of the estimated cost of the road repairs, as agreed to by the contractor and Williamson County, prior to the commencing of a cutting of the roadbed.
5. A road cut permit fee, in the amount of \$120.00 per roadbed cut, must be submitted to the County Road Administrator's office prior to cutting the roadbed.

SPECIFICATION FOR CUTTING ROADBED IN LIEU OF CORE DRILLING
WITHIN AUSTIN ETJ

1. Roadbed cuts to be repaired in accordance with City of Austin specifications as outlined in their standard Specifications for Cuts in Public Right of Way Manual.
2. The utility shall be placed a minimum of 30" below the flow line.
3. The installation to be free from defects for a period of one (1) year from completion date. Any maintenance required during this period, caused by the cutting of a road, will be done by the contractor or contractors without cost to the County.
4. A performance bond, or other securities agreed upon by the County, must be pledged in the amount of the estimated cost of the road repairs, as agreed to by the contractor and County, prior to the commencing of a cutting of the roadbed.
5. A roadbed cut permit fee, in the amount of \$120.00 per roadbed cut, must be submitted to the County Road Administrator's office prior to cutting the roadbed.

This agreement must be entered into prior to the commencing of the cutting of a roadbed.

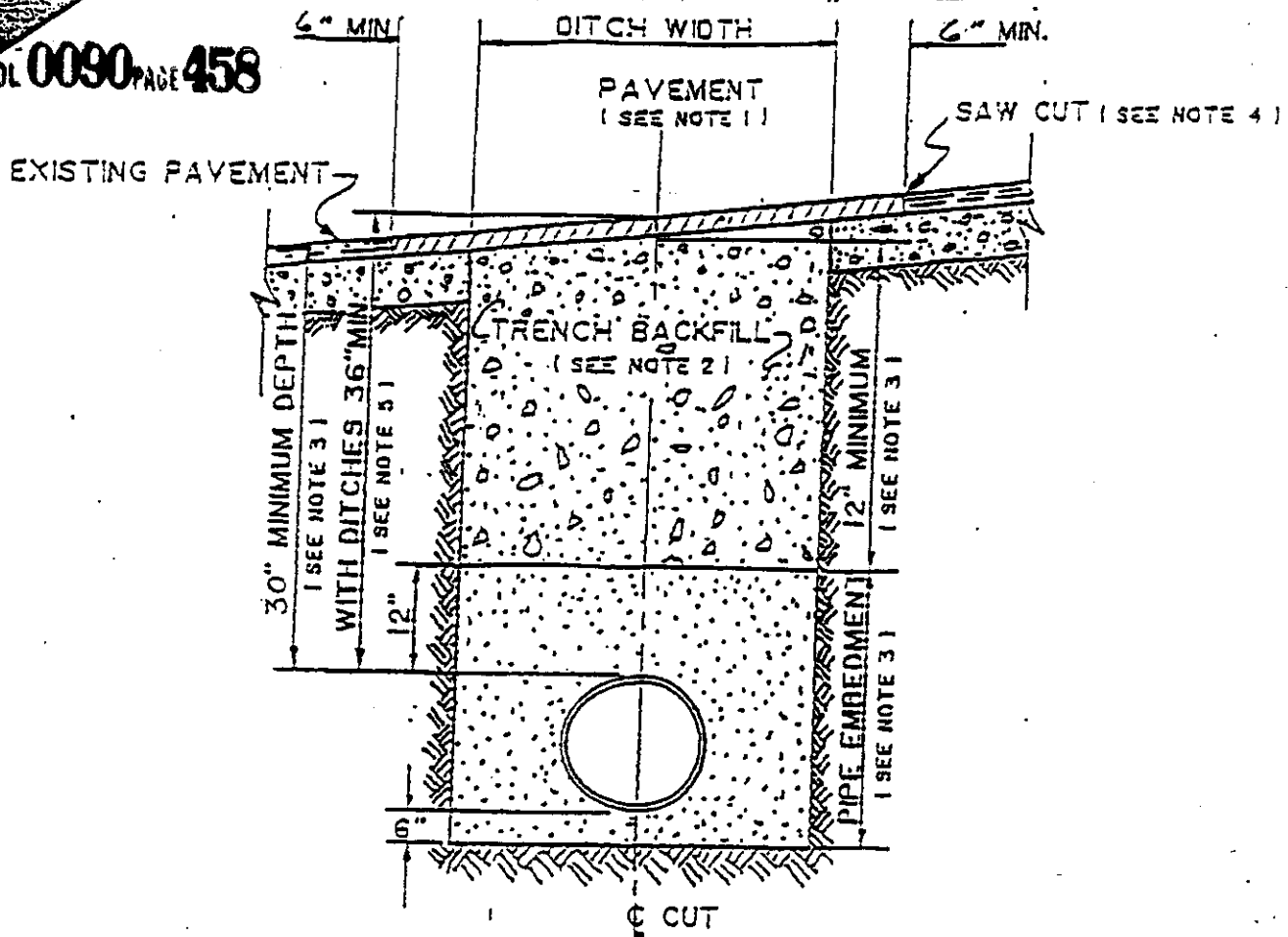

1. Hot mix asphalt 1 1/2" min. thickness. Roll in place to match existing surface. $\pm 1/8"$ tolerance.
2. Trench backfill shall be flexible base, compacted to 95% optimum in 8" layers unless otherwise approved and specified. Flexible base to match existing base thickness or 8 inches, whichever is greater (specifications: TSHD Item 248, Type A, Grade 2).
3. Pipe embedment (pipe envelope) size and materials shall be as specified elsewhere by the utility company and/or its engineers. Pipe depth shall be as specified elsewhere provided minimum depths are met.
4. Saw cut shall be made prior to ditch cut. If pavement is damaged during cut, a new saw cut shall be made beyond the damaged area and new pavement placed.
5. Where roadside ditches (bar ditches) are crossed by the utility pipe, minimum depth to the top of the pipe from centerline road elevation will be 36".

GREG BERGERON
COUNTY ROAD ADMINISTRATOR



1900 Georgetown Inner Loop, Suite B
Georgetown, Texas 78626
Telephone (512) 930-3330
Fax (512) 930-3335

Williamson County
Unified Road System

UTILITY INSTALLATION REQUEST

DATE: July 31, 1997

TO: Williamson County Commissioners' Court
c/o County Engineer, County Road Administrator or County Commissioner

Formal notice is hereby given that THE CITY OF THRALL proposes to place an 8" WATER LINE line within the right-of-way of COUNTY ROAD 424 County Road as follows: AN 8" WATER LINE WILL BE CONNECTED TO EXISTING LINE CR 424 AND EXTEND THIS LINE WILL EXTEND 160' EAST TO THE SOUTH AT WHICH TIME IT WILL TURN 90° TO THE WEST A DISTANCE OF 60'. AT THIS POINT THE 8" WATER LINE WILL BE PLACED IN THE 15' PUBLIC UTILITY EASEMENT OF THE NEWLY ANNEXED QUAIL CREEK ADDITION OF THRALL, TEXAS.

The location and description of the proposed line and appurtenances is more fully shown on the drawing attached hereto. The line will be constructed & maintained on the County right-of-way in accordance with current Williamson County Specifications as directed by the County Engineer, County Road Administrator or County Commissioner.

Construction will begin on or after the 4TH day of AUGUST 1997, and is estimated to be completed in 30 calendar days.

SUBMITTED BY FIRM: REGENCY HOMES AUTHORIZED
SIGNATURE: X J. J. Pierce PRINTED NAME: T. F. PIERCE
TITLE: OWNER FIRM ADDRESS: 604 BOUNDS, THRALL, TEXAS 76578
PHONE # 512-862-4438
CONTRACTOR (IF DIFFERENT FROM FIRM): J. W. C. CONSTRUCTION
AUTHORIZED SIGNATURE: X Rodney Barta PRINTED NAME: RODNEY BARTA
TITLE: OWNER-MANAGER ADDRESS: P.O. Box 498 GONZALES, TEXAS 78629
PHONE # 210-672-6679

Precinct #: 4

APPROVAL

This application is hereby approved subject to the following understandings and restrictions.

It is expressly understood that the said County Commissioners' Court does not imply hereby to grant any right, claim, title or easement in or upon this County Road; and it is further understood that in the future, should Williamson County, for any reason, need to work, improve, relocate, widen, increase, add to, decrease, or in any manner change the structure of this road or right-of-way, this line, if affected, will be moved at the direction of the Williamson County Engineer or County Commissioner. This installation work shall not damage any part of the roadway and adequate provisions shall be made to cause a minimum of inconvenience to traffic and adjacent property owners.

APPROVED BY WILLIAMSON COUNTY COMMISSIONERS' COURT

BY: Greg Bergeron
COUNTY ROAD ADMINISTRATOR

DATE: 8/6/97

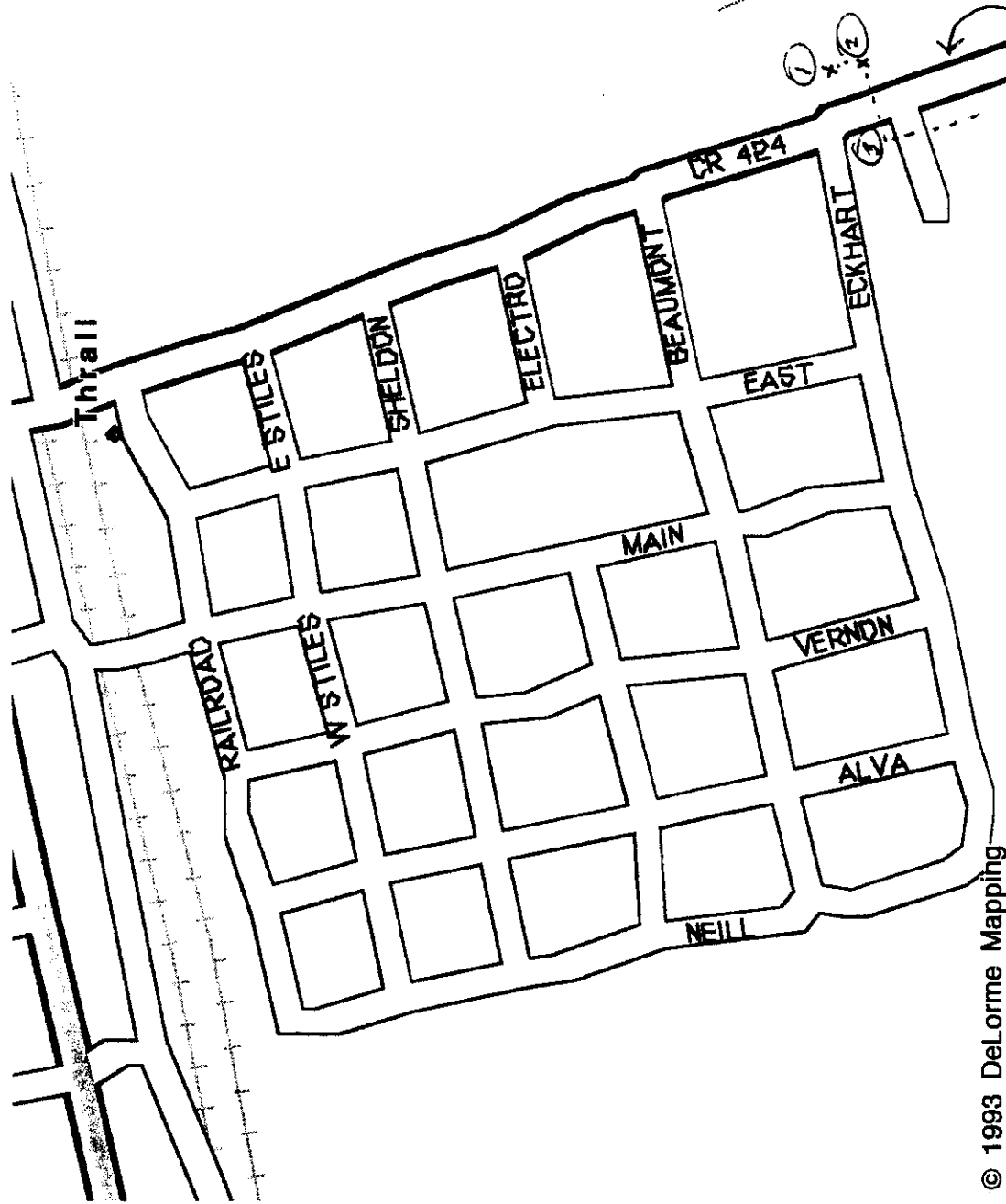

© 1993 DeLorme Mapping

1. EXISTING WATER LINE
2. 90° TURN WEST
3. LINE IS ON PUE OF QUAIL CREEK ADDITION

Contractor may want to place line 100' to 150' from street crossing.

SLB

GREG BERGERON
County Road Administrator



1900 Georgetown Loop, Ste. B
Georgetown, Texas 78626
Telephone (512) 930-3330
Fax (512) 930-3335

**Williamson County
Unified Road System**

When specifically agreed to in writing and signed by a Williamson County Commissioner, or the County Road Administrator, Williamson County will permit the cutting of a roadbed in lieu of core drilling, provided the contractor or contractors agree to the following installation:

SPECIFICATION FOR CUTTING ROADBED IN LIEU OF CORE DRILLING

1. Compacted base material with concrete cap.
2. The utility shall be placed a minimum of 30" below the flow line.
3. Layer compacted and topped with 3" hot mix asphalt.
4. A performance bond, or other securities agreed upon by the County, must be pledged in the amount of the estimated cost of the road repairs, as agreed to by the contractor and Williamson County, prior to the commencing of a cutting of the roadbed.
5. A road cut permit fee, in the amount of \$120.00 per roadbed cut, must be submitted to the County Road Administrator's office prior to cutting the roadbed.

**SPECIFICATION FOR CUTTING ROADBED IN LIEU OF CORE DRILLING
WITHIN AUSTIN ETJ**

1. Roadbed cuts to be repaired in accordance with City of Austin specifications as outlined in their standard Specifications for Cuts in Public Right of Way Manual.
2. The utility shall be placed a minimum of 30" below the flow line.
3. The installation to be free from defects for a period of one (1) year from completion date. Any maintenance required during this period, caused by the cutting of a road, will be done by the contractor or contractors without cost to the County.
4. A performance bond, or other securities agreed upon by the County, must be pledged in the amount of the estimated cost of the road repairs, as agreed to by the contractor and County, prior to the commencing of a cutting of the roadbed.
5. A roadbed cut permit fee, in the amount of \$120.00 per roadbed cut, must be submitted to the County Road Administrator's office prior to cutting the roadbed.

This agreement must be entered into prior to the commencing of the cutting of a roadbed.

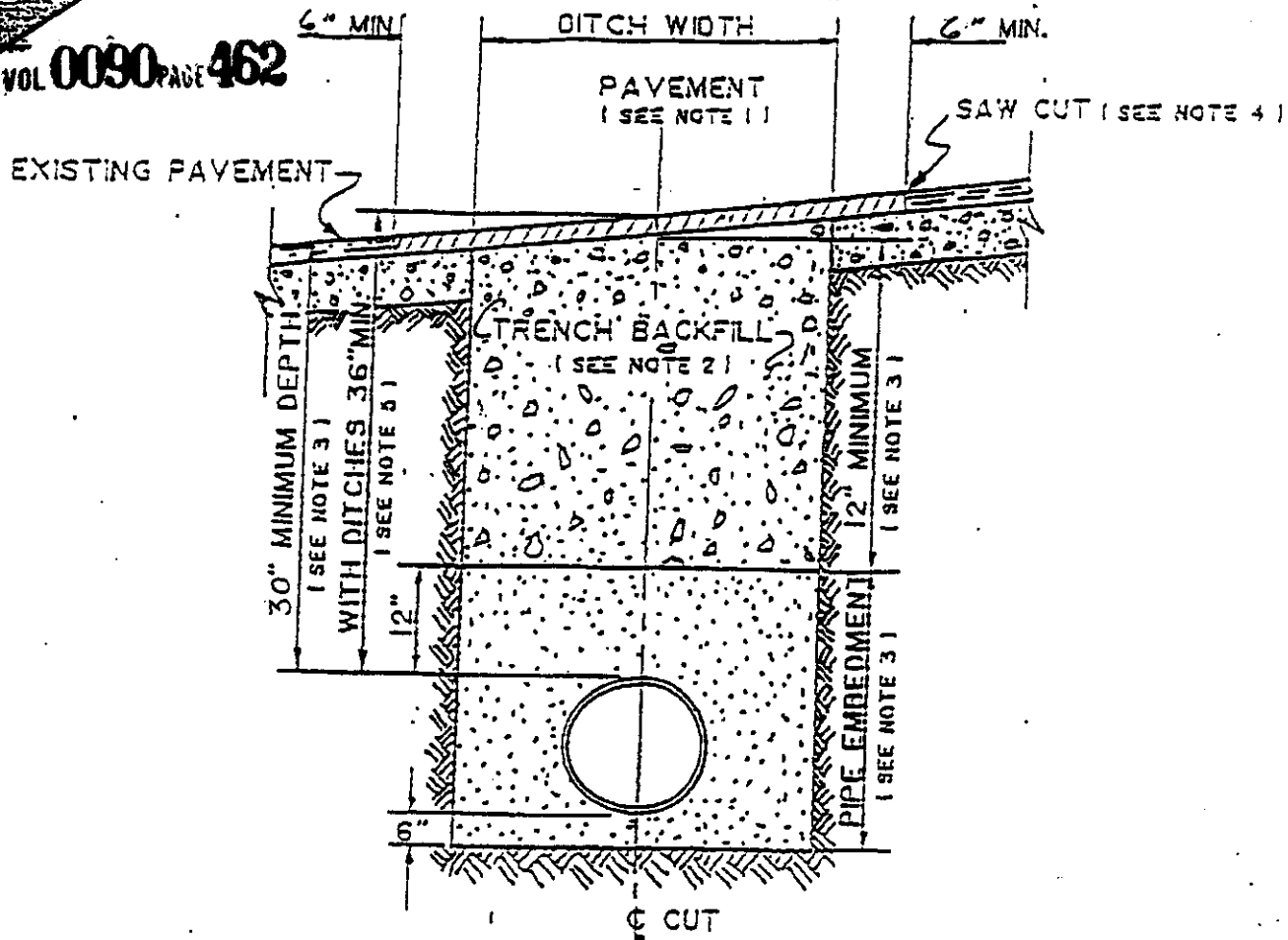

1. Hot mix asphalt 1 1/2" min. thickness. Roll in place to match existing surface. $\pm 1/8"$ tolerance.
2. Trench backfill shall be flexible base, compacted to 95% optimum in 8" layers unless otherwise approved and specified. Flexible base to match existing base thickness or 8 inches, whichever is greater (specifications: TSHD Item 248, Type A, Grade 2).
3. Pipe embedment (pipe envelope) size and materials shall be as specified elsewhere by the utility company and/or its engineers. Pipe depth shall be as specified elsewhere provided minimum depths are met.
4. Saw cut shall be made prior to ditch cut. If pavement is damaged during cut, a new saw cut shall be made beyond the damaged area and new pavement placed.
5. Where roadside ditches (bar ditches) are crossed by the utility pipe, minimum depth to the top of the pipe from centerline road elevation will be 36".

Received
8-8-97

GREG BERGERON
COUNTY ROAD ADMINISTRATOR



Williamson County
Unified Road System

1900 Georgetown Inner Loop, Suite B
Georgetown, Texas 78626
Telephone (512) 930-3330
Fax (512) 930-3335

VOL 0090 PAGE 463

UTILITY INSTALLATION REQUEST

DATE: 8-4-97

TO: Williamson County Commissioners' Court
c/o County Engineer, County Road Administrator or County Commissioner

Formal notice is hereby given that SOUTHWESTERN BELL proposes to place
a BURIED CABLE line within the right-of-way of CR 204
County Road as follows: SEE ATTACHED

SKETCH

D652468

The location and description of the proposed line and appurtenances is more fully shown on the drawing attached hereto. The line will be constructed & maintained on the County right-of-way in accordance with current Williamson County Specifications as directed by the County Engineer, County Road Administrator or County Commissioner.

Construction will begin on or after the 5th day of AUGUST 1997, and is estimated to be completed in 1 calendar days.

SUBMITTED BY FIRM: SOUTHWESTERN BELL TELEPHONE CO. AUTHORIZED
SIGNATURE: [Signature] TITLE: Area Bell Design Firm FIRM ADDRESS: 1616

GUADALUPE RD 426 AUSTIN TX PHONE # 512-870-547
CONTRACTOR (IF DIFFERENT FROM FIRM): 78701

AUTHORIZED SIGNATURE: — TITLE: —
ADDRESS: — PHONE # —

Precinct #: 2

APPROVAL

This application is hereby approved subject to the following understandings and restrictions.

It is expressly understood that the said County Commissioners' Court does not imply hereby to grant any right, claim, title or easement in or upon this County Road; and it is further understood that in the future, should Williamson County, for any reason, need to work, improve, relocate, widen, increase, add to, decrease, or in any manner change the structure of this road or right-of-way, this line, if affected, will be moved at the direction of the Williamson County Engineer or County Commissioner. This installation work shall not damage any part of the roadway and adequate provisions shall be made to cause a minimum of inconvenience to traffic and adjacent property owners.

APPROVED BY WILLIAMSON COUNTY COMMISSIONERS' COURT

BY: [Signature]
COUNTY ROAD ADMINISTRATOR

DATE: 8/12/97

67

8-11-97
cut & restore
R.E.

LOCATION MAP

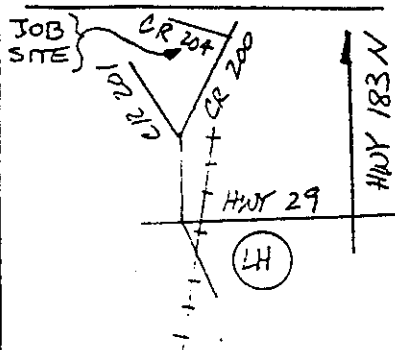

CABLE LOAD DATA P R D

0205, 151-160 881
0205, 130-135 450

INSP
45C/545C



NORTH ARROW

OPERATING RANGE OF JOB STEPS

LINE 1 TO -
SPLICE 51 TO -

MFR 45C

TRANSMISSION ZONE

RZ - C2 9
TAPER CODE 140311

CAUTION HIGH VOLTAGE

7.2 KV ☒ AERIAL
☐ BURIED

SPECIAL CIRCUITS INVOLVED

☐ YES ☒ NO
6203 FORWARDED
☐ YES ☒ NO

PERMIT REQUIRED

☐ YES ☒ NO

POLE CONTACTS

(+) - OR (-) -
PWR. CO. DEC

NOTES

ORDER NO. D652468

TOT. PLATS 1 PLAT NO. 1

CO. LIBERTY HILL

EXCH. AUSTIN NORTH

TAX DIST. WKD14

GEO. LOC. XY4778

ENGR. JP DRAWN 2

MAP REF.

REC. REF. SPUR 109

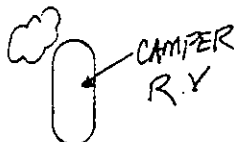
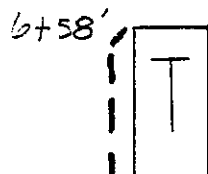

MICHELLE FITZPATRICK
CER# 339-3973
SRN 8597
S.O. N856583

4+77'

45C
PLAC 660'
BSW-SPR

GATE

CR 204

0+22'

CR 18' ASPHALT

0+4'

0205, 151-160
0205, 130-135

(440's)

BHBA16PR TO CO.

PED 3 2673

☒ 1733 PED 2

301

PIT RECD



STEN PED 2 1/2 RPL 109
0205, 151-160
0205, 130-135
A, 17-25

GREG BERGERON
County Road Administrator



1900 Georgetown Loop, Ste. B
Georgetown, Texas 78626
Telephone (512) 930-3330
Fax (512) 930-3335

**Williamson County
Unified Road System**

When specifically agreed to in writing and signed by a Williamson County Commissioner, or the County Road Administrator, Williamson County will permit the cutting of a roadbed in lieu of core drilling, provided the contractor or contractors agree to the following installation:

SPECIFICATION FOR CUTTING ROADBED IN LIEU OF CORE DRILLING

1. Compacted base material with concrete cap.
2. The utility shall be placed a minimum of 30" below the flow line.
3. Layer compacted and topped with 3" hot mix asphalt.
4. A performance bond, or other securities agreed upon by the County, must be pledged in the amount of the estimated cost of the road repairs, as agreed to by the contractor and Williamson County, prior to the commencing of a cutting of the roadbed.
5. A road cut permit fee, in the amount of \$120.00 per roadbed cut, must be submitted to the County Road Administrator's office prior to cutting the roadbed.

**SPECIFICATION FOR CUTTING ROADBED IN LIEU OF CORE DRILLING
WITHIN AUSTIN ETJ**

1. Roadbed cuts to be repaired in accordance with City of Austin specifications as outlined in their standard Specifications for Cuts in Public Right of Way Manual.
2. The utility shall be placed a minimum of 30" below the flow line.
3. The installation to be free from defects for a period of one (1) year from completion date. Any maintenance required during this period, caused by the cutting of a road, will be done by the contractor or contractors without cost to the County.
4. A performance bond, or other securities agreed upon by the County, must be pledged in the amount of the estimated cost of the road repairs, as agreed to by the contractor and County, prior to the commencing of a cutting of the roadbed.
5. A roadbed cut permit fee, in the amount of \$120.00 per roadbed cut, must be submitted to the County Road Administrator's office prior to cutting the roadbed.

This agreement must be entered into prior to the commencing of the cutting of a roadbed.

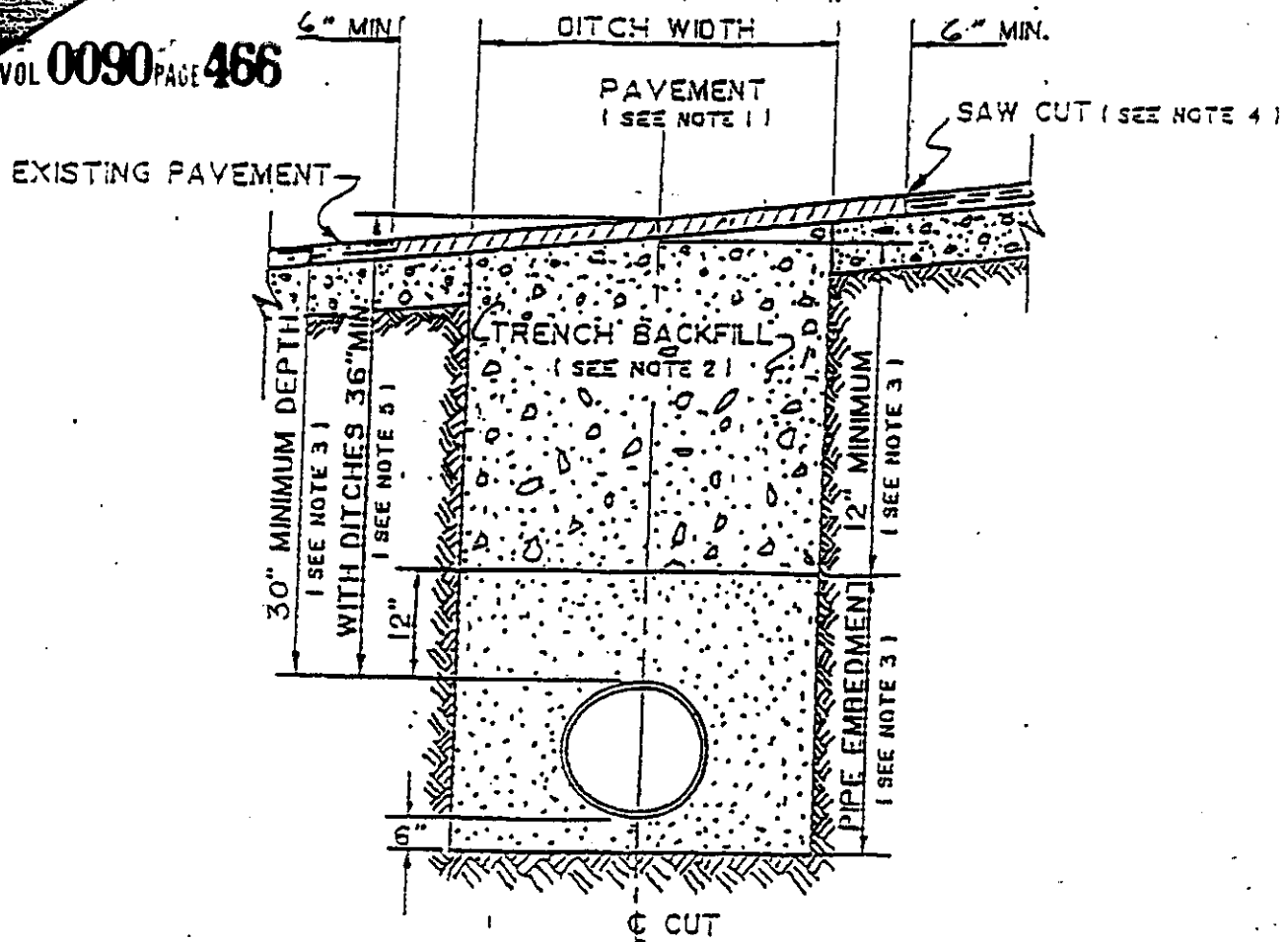

1. Hot mix asphalt 1 1/2" min. thickness. Roll in place to match existing surface. $\pm 1/8"$ tolerance.
2. Trench backfill shall be flexible base, compacted to 95% optimum in 8" layers unless otherwise approved and specified. Flexible base to match existing base thickness or 8 inches, whichever is greater (specifications: TSHD Item 248, Type A, Grade 2).
3. Pipe embedment (pipe envelope) size and materials shall be as specified elsewhere by the utility company and/or its engineers. Pipe depth shall be as specified elsewhere provided minimum depths are met.
4. Saw cut shall be made prior to ditch cut. If pavement is damaged during cut, a new saw cut shall be made beyond the damaged area and new pavement placed.
5. Where roadside ditches (bar ditches) are crossed by the utility pipe, minimum depth to the top of the pipe from centerline road elevation will be 36".

received
 8-8-97

VOL 0090 PAGE 467

D650296

GREG BERGERON
 COUNTY ROAD ADMINISTRATOR



Williamson County
 Unified Road System

1900 Georgetown Inner Loop, Suite B
 Georgetown, Texas 78626
 Telephone (512) 930-3330
 Fax (512) 930-3335

UTILITY INSTALLATION REQUEST

DATE: 8-4-97

TO: Williamson County Commissioners' Court
 c/o County Engineer, County Road Administrator or County Commissioner

Formal notice is hereby given that SOUTHWESTERN BELL proposes to place
 a BURIED CABLE line within the right-of-way of CR 204
 County Road as follows: SEE ATTACHED

SKETCHD650296

The location and description of the proposed line and appurtenances is more
 fully shown on the drawing attached hereto. The line will be constructed &
 maintained on the County right-of-way in accordance with current Williamson
 County Specifications as directed by the County Engineer, County Road
 Administrator or County Commissioner.

Construction will begin on or after the 5th day of AUGUST 1997, and
 is estimated to be completed in 1 calendar days.

SUBMITTED BY FIRM: SOUTHWESTERN BELL TELEPHONE CO AUTHORIZED
 SIGNATURE: [Signature] TITLE: MR. RNC [Signature] FIRM ADDRESS: 1616

GUADALUPE RM 406 Austin TX PHONE # 787-1

CONTRACTOR (IF DIFFERENT FROM FIRM): --- TITLE: ---
 AUTHORIZED SIGNATURE: --- PHONE # ---
 ADDRESS: ---

Precinct #: 2

APPROVAL

This application is hereby approved subject to the following understandings and restrictions.

It is expressly understood that the said County Commissioners' Court does not imply hereby
 to grant any right, claim, title or easement in or upon this County Road; and it is further
 understood that in the future, should Williamson County, for any reason, need to work,
 improve, relocate, widen, increase, add to, decrease, or in any manner change the structure
 of this road or right-of-way, this line, if affected, will be moved at the direction of the
 Williamson County Engineer or County Commissioner. This installation work shall not damage
 any part of the roadway and adequate provisions shall be made to cause a minimum of
 inconvenience to traffic and adjacent property owners.

APPROVED BY WILLIAMSON COUNTY COMMISSIONERS' COURT

BY: [Signature]
 COUNTY ROAD ADMINISTRATOR

DATE: 8/12/97

71

8-11-97
 cut + restore
 L.S.

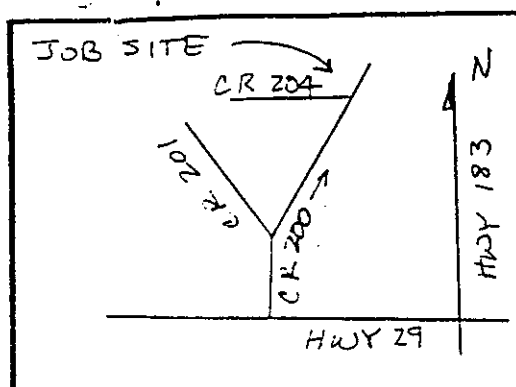

CABLE LOAD DATA P R D
0205, 151-175 12 13 2

45C/645C



NORTH ARROW

OPERATING RANGE OF JOB STEPS

LINE TO

SPLICE TO

MFR 45C

TRANSMISSION ZONE

RZ CZ 9

TAPER CODE 140311

CAUTION HIGH VOLTAGE

7.2 KV ☒ AERIAL

☐ BURIED

SPECIAL CIRCUITS INVOLVED

☐ YES ☒ NO

6203 FORWARDED

☐ YES ☒ NO

PERMIT REQUIRED

☐ YES ☒ NO

POLE CONTACTS

(+) OR (-)

PWR. CO. PEC

NOTES

ORDER NO. D650296

TOT. PLATS 1 PLAT NO. 1

C.O. LIBERTY Hill

EXCH. AUSTIN-NORTH

TAX DIST. WK014

GEO. LOC. XY4778

ENGR. JP DRAWN DL

MAP REF.

REC. REF. SPUR 109

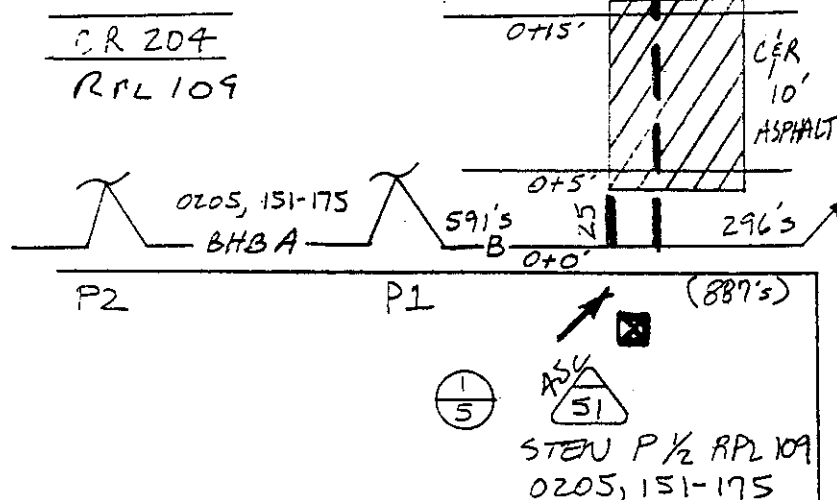
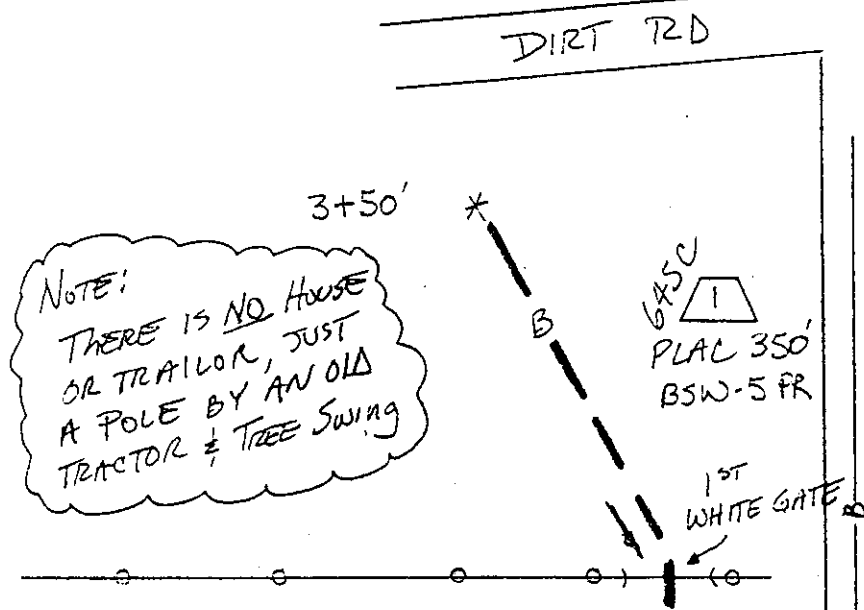

CR 200

0205, 1-25 + 126 - 160 +

MARK 24

AFBW-1

TO C.O. 4, 61-100

GREG BERGERON
County Road Administrator



1900 Georgetown Loop, Ste. B
Georgetown, Texas 78626
Telephone (512) 930-3330
Fax (512) 930-3335

**Williamson County
Unified Road System**

When specifically agreed to in writing and signed by a Williamson County Commissioner, or the County Road Administrator, Williamson County will permit the cutting of a roadbed in lieu of core drilling, provided the contractor or contractors agree to the following installation:

SPECIFICATION FOR CUTTING ROADBED IN LIEU OF CORE DRILLING

1. Compacted base material with concrete cap.
2. The utility shall be placed a minimum of 30" below the flow line.
3. Layer compacted and topped with 3" hot mix asphalt.
4. A performance bond, or other securities agreed upon by the County, must be pledged in the amount of the estimated cost of the road repairs, as agreed to by the contractor and Williamson County, prior to the commencing of a cutting of the roadbed.
5. A road cut permit fee, in the amount of \$120.00 per roadbed cut, must be submitted to the County Road Administrator's office prior to cutting the roadbed.

**SPECIFICATION FOR CUTTING ROADBED IN LIEU OF CORE DRILLING
WITHIN AUSTIN ETJ**

1. Roadbed cuts to be repaired in accordance with City of Austin specifications as outlined in their standard Specifications for Cuts in Public Right of Way Manual.
2. The utility shall be placed a minimum of 30" below the flow line.
3. The installation to be free from defects for a period of one (1) year from completion date. Any maintenance required during this period, caused by the cutting of a road, will be done by the contractor or contractors without cost to the County.
4. A performance bond, or other securities agreed upon by the County, must be pledged in the amount of the estimated cost of the road repairs, as agreed to by the contractor and County, prior to the commencing of a cutting of the roadbed.
5. A roadbed cut permit fee, in the amount of \$120.00 per roadbed cut, must be submitted to the County Road Administrator's office prior to cutting the roadbed.

This agreement must be entered into prior to the commencing of the cutting of a roadbed.

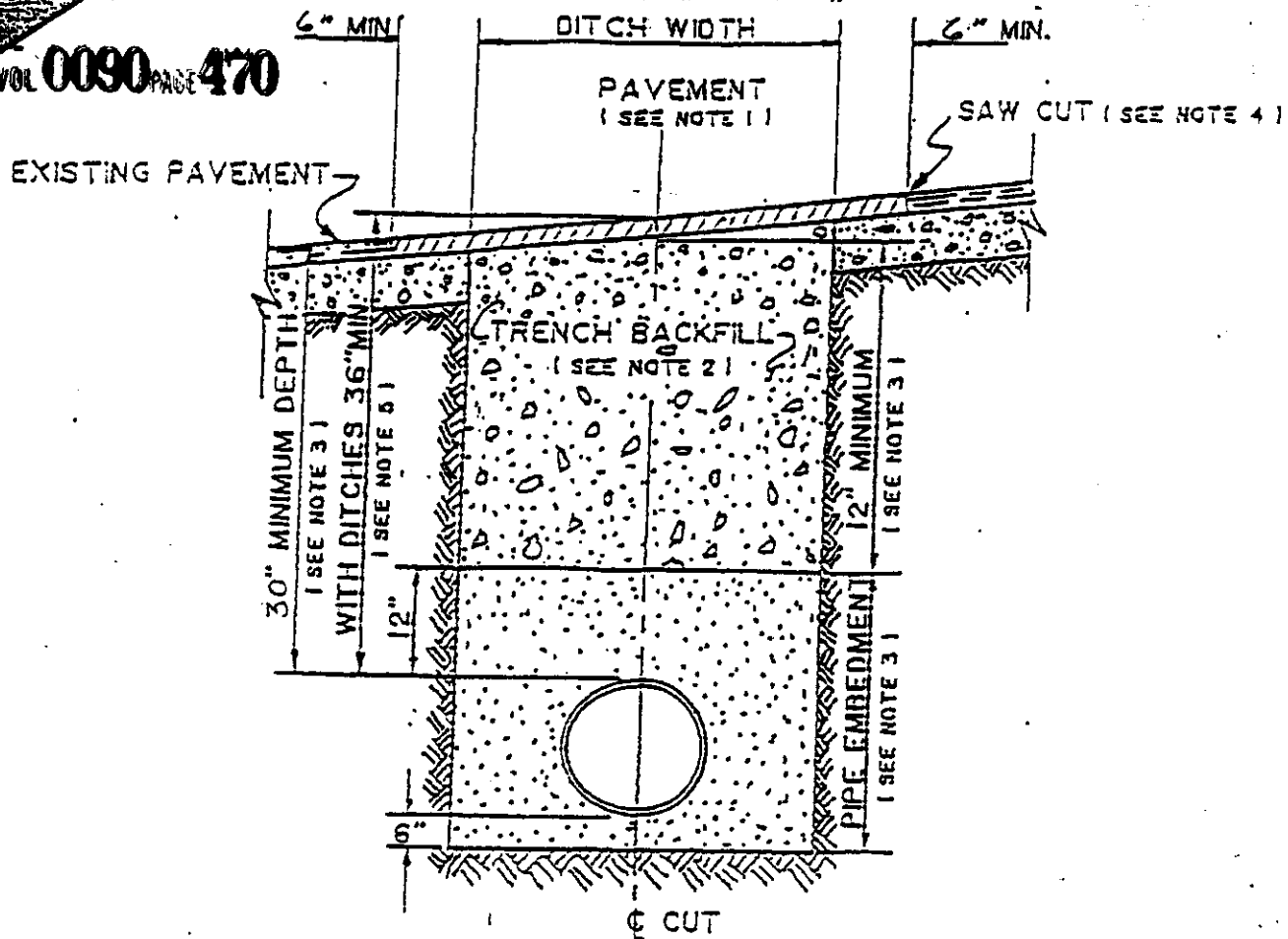

1. Hot mix asphalt 1 1/2" min. thickness. Roll in place to match existing surface. $\pm 1/8"$ tolerance.
2. Trench backfill shall be flexible base, compacted to 95% optimum in 8" layers unless otherwise approved and specified. Flexible base to match existing base thickness or 8 inches, whichever is greater (specifications: TSHD Item 248, Type A, Grade 2).
3. Pipe embedment (pipe envelope) size and materials shall be as specified elsewhere by the utility company and/or its engineers. Pipe depth shall be as specified elsewhere provided minimum depths are met.
4. Saw cut shall be made prior to ditch cut. If pavement is damaged during cut, a new saw cut shall be made beyond the damaged area and new pavement placed.
5. Where roadside ditches (bar ditches) are crossed by the utility pipe, minimum depth to the top of the pipe from centerline road elevation will be 36".

GREG BERGERON
COUNTY ROAD ADMINISTRATOR



Williamson County
Unified Road System

D655656

1900 Georgetown Inner Loop, Suite B
Georgetown, Texas 78626
Telephone (512) 930-3330
Fax (512) 930-3335

VOL 0090 PAGE 471

received
8-8-97

UTILITY INSTALLATION REQUEST

DATE: 7-16-97

TO: Williamson County Commissioners' Court
c/o County Engineer, County Road Administrator or County Commissioner

Formal notice is hereby given that Southwestern Bell Tel proposes to place
a buried line within the right-of-way of CR 273
County Road as follows: From intersection near
CR 272 ON CR 273 AND ACROSS CR 273 TO PNT ESM'T AND FROM CR 273
EAST ALONG NORTH SIDE CR 272 TO INTERFACE EAST OF Laurel Glen Blvd

The location and description of the proposed line and appurtenances is more
fully shown on the drawing attached hereto. The line will be constructed &
maintained on the County right-of-way in accordance with current Williamson
County Specifications as directed by the County Engineer, County Road
Administrator or County Commissioner.

Construction will begin on or after the 5th day of August 1997, and
is estimated to be completed in 30 calendar days.

SUBMITTED BY Southwestern Bell Telephone Co. AUTHORIZED
SIGNATURE: [Signature] TITLE: Manager FIRM ADDRESS: 1616
Guadalupe Rd 400, Austin, Tex 78701 PHONE # (512) 870-3443
CONTRACTOR (if different from submitter): Fischer Utilities
AUTHORIZED SIGNATURE: [Signature] TITLE: Mgr Engr Design
ADDRESS: 1616 Guadalupe Rd 400, Austin, Tex 78701 PHONE # (512) 870-3443

Precinct #: 2

APPROVAL

This application is hereby approved subject to the following understandings and restrictions.

It is expressly understood that the said County Commissioners' Court does not imply hereby
to grant any right, claim, title or easement in or upon this County Road; and it is further
understood that in the future, should Williamson County, for any reason, need to work,
improve, relocate, widen, increase, add to, decrease, or in any manner change the structure
of this road or right-of-way, this line, if affected, will be moved at the direction of the
Williamson County Engineer or County Commissioner. This installation work shall not damage
any part of the roadway and adequate provisions shall be made to cause a minimum of
inconvenience to traffic and adjacent property owners.

APPROVED BY WILLIAMSON COUNTY COMMISSIONERS' COURT

BY: [Signature]
COUNTY ROAD ADMINISTRATOR

8/12/97

75

8-8-97
Bone & R.A.W.
R.A.



10

GREG BERGERON
County Road Administrator



**Williamson County
Unified Road System**

VOL 0090 PAGE 477

1900 Georgetown Loop, Ste. B
Georgetown, Texas 78626
Telephone (512) 930-3330
Fax (512) 930-3335

When specifically agreed to in writing and signed by a Williamson County Commissioner, or the County Road Administrator, Williamson County will permit the cutting of a roadbed in lieu of core drilling, provided the contractor or contractors agree to the following installation:

SPECIFICATION FOR CUTTING ROADBED IN LIEU OF CORE DRILLING

1. Compacted base material with concrete cap.
2. The utility shall be placed a minimum of 30" below the flow line.
3. Layer compacted and topped with 3" hot mix asphalt.
4. A performance bond, or other securities agreed upon by the County, must be pledged in the amount of the estimated cost of the road repairs, as agreed to by the contractor and Williamson County, prior to the commencing of a cutting of the roadbed.
5. A road cut permit fee, in the amount of \$120.00 per roadbed cut, must be submitted to the County Road Administrator's office prior to cutting the roadbed.

**SPECIFICATION FOR CUTTING ROADBED IN LIEU OF CORE DRILLING
WITHIN AUSTIN ETJ**

1. Roadbed cuts to be repaired in accordance with City of Austin specifications as outlined in their standard Specifications for Cuts in Public Right of Way Manual.
2. The utility shall be placed a minimum of 30" below the flow line.
3. The installation to be free from defects for a period of one (1) year from completion date. Any maintenance required during this period, caused by the cutting of a road, will be done by the contractor or contractors without cost to the County.
4. A performance bond, or other securities agreed upon by the County, must be pledged in the amount of the estimated cost of the road repairs, as agreed to by the contractor and County, prior to the commencing of a cutting of the roadbed.
5. A roadbed cut permit fee, in the amount of \$120.00 per roadbed cut, must be submitted to the County Road Administrator's office prior to cutting the roadbed.

This agreement must be entered into prior to the commencing of the cutting of a roadbed.

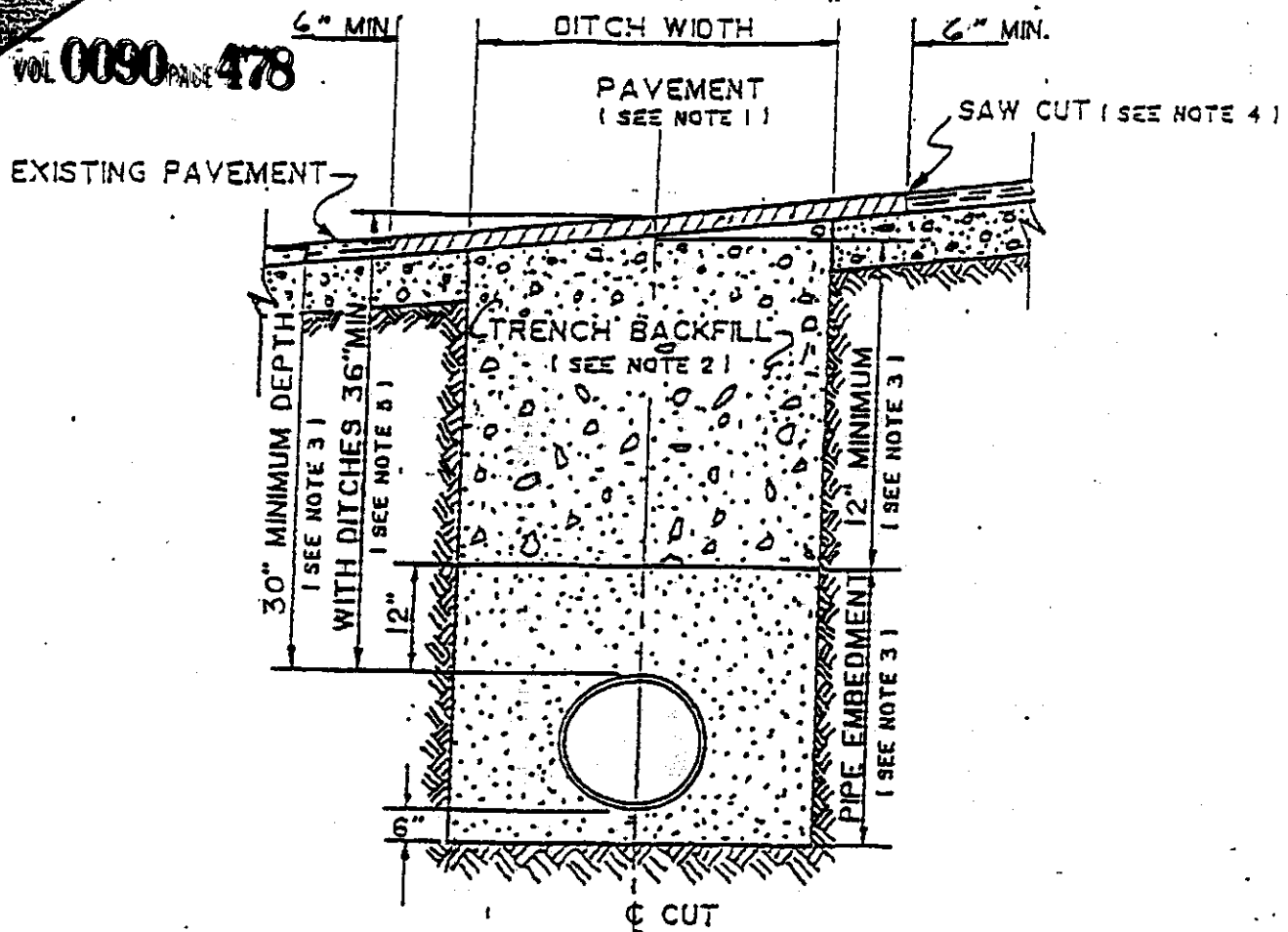

1. Hot mix asphalt 1 1/2" min. thickness. Roll in place to match existing surface. $\pm 1/8"$ tolerance.
2. Trench backfill shall be flexible base, compacted to 95% optimum in 8" layers unless otherwise approved and specified. Flexible base to match existing base thickness or 8 inches, whichever is greater (specifications: TSHD Item 248, Type A, Grade 2).
3. Pipe embedment (pipe envelope) size and materials shall be as specified elsewhere by the utility company and/or its engineers. Pipe depth shall be as specified elsewhere provided minimum depths are met.
4. Saw cut shall be made prior to ditch cut. If pavement is damaged during cut, a new saw cut shall be made beyond the damaged area and new pavement placed.
5. Where roadside ditches (bar ditches) are crossed by the utility pipe, minimum depth to the top of the pipe from centerline road elevation will be 36".

AGENDA ITEM # 5

August 12, 1997

*

Consider noting reports from TxDOT on over axle/over weight tolerance permits.

Moved: Commissioner Mehevec

Seconded: Judge Doerfler

Motion: To note in minutes reports from TxDOT over axle/over weight tolerance permits.

Vote: Motion carried 5 - 0

< Clerk copy here >

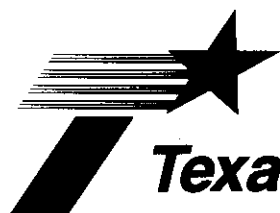

Texas Department of Transportation

DEWITT C. GREER STATE HIGHWAY BLDG. • 125 E. 11TH STREET • AUSTIN, TEXAS 78701-2483 • (512) 463-8585

July 28, 1997

Attn: County Clerks,

In accordance with HB 1547, 74th Legislature, enclosed is the notification to counties concerning the issuance of Over Axle / Over Gross Weight Tolerance Permits. HB 1547, 74th Legislature directs the Texas Department of Transportation to notify each county listed in the permit application for a permit issued under authority of TVCS 6701d-11 Sec. 5B, and the Texas Transportation Code, Chapter 623 that the person intends to operate or cause to be operated an overweight vehicle in the county.

If this report is going to the incorrect address please notify the Motor Carrier Division of any mailing address changes.

If you have any questions concerning this information, please contact Curtis Wagner at 512-465-3500.

*noted 8-12-97
John C. Doerfler*

Sincerely,

for: Larry A. Chamberlain
Lawrance R. Smith, Director
Motor Carrier Division

Enclosure