

AGENDA ITEM # 4June 10, 1997

\*

Consider noting in minutes any off right-of-way work on any county road done by Road & Bridge Unified System, or any road cuts.

Moved: Commissioner Boatright

Seconded: Judge Doerfler

Motion: To note the following utility requests for

**Central Telephone Company of Texas right-of-way on County Road 253;**

**Chisholm Trail S.U.D. bore on County Road 224;**

**Chisholm Trail S.U.D. bore on Rollings Hills Drive;**

**Chisholm Trail S.U.D. bore on County Road 214;**

**GTE right-of-way on County Road 425;**

**Southwestern Bell Telephone road cut on County Road 255;**

**Southwestern Bell Telephone road cut on Mellow Meadow (Anderson Mill);**

**Southwestern Bell Telephone bore on County Road 101;**

Vote: Motion carried 5 - 0

< Clerk copy here - Utility Proposals >

---

**WILLIAMSON COUNTY URS**

Utility Requests - 06/10/97

**Precinct I**

**Precinct II**

- A. SWBT
  - 1. Mellow Meadow(Anderson Mill) - Road cut
- B. Chisholm Trail S.U.D.
  - 1. Rollings Hills Drive - Bore
- C. Chisholm Trail S.U.D.
  - 1. CR 214 - Bore

**Precinct III**

- A. SWBT
  - 1. CR 255 - Road cut
- B. Central Telephone Company of Texas
  - 1. CR 253 - ROW
- C. Chisholm Trail S.U.D.
  - 1. CR 224 - Bore

**Precinct IV**

- A. SWBT
  - 1. CR 101 - Bore
- B. GTE
  - 1. CR 425 - ROW

*noted 6-10-97  
John C. Doerfler*

DWO D648292 PL2

GREG BERGERON  
COUNTY ROAD ADMINISTRATOR1900 Georgetown Inner Loop, Suite B  
Georgetown, Texas 78626  
Telephone (512) 930-3330  
Fax (512) 930-3335Williamson County  
Unified Road System

## UTILITY INSTALLATION REQUEST

DATE: 4-16-97TO: Williamson County Commissioners' Court  
c/o County Engineer, County Road Administrator or County Commissioner

Formal notice is hereby given that SOUTHWESTERN BELL proposes to place a Buried line within the right-of-way of Mellow County Road as follows: Bury across  
Street to Park West Apartments and in front of Drive  
way in street. Saw cut concrete ramp of 2' sag with 2" asphalt  
over T cut. Also a splice pit on Lake Creek Pkwy behind CKB.

The location and description of the proposed line and appurtenances is more fully shown on the drawing attached hereto. The line will be constructed & maintained on the County right-of-way in accordance with current Williamson County Specifications as directed by the County Engineer, County Road Administrator or County Commissioner.

Construction will begin on or after the 15th day of MAY 1997, and is estimated to be completed in 5 calendar days.

SUBMITTED BY Southwestern Bell Telephone Co. AUTHORIZED  
SIGNATURE: [Signature] TITLE: Area Eng. Dept. FIRM ADDRESS: 1616  
Guadalupe Rm 4006, Austin TX 78701 PHONE # (512) 870-3443  
CONTRACTOR (IF DIFFERENT FROM FIRM): UNKNOWN AT THIS TIME  
AUTHORIZED SIGNATURE: \_\_\_\_\_ TITLE: \_\_\_\_\_  
ADDRESS: \_\_\_\_\_ PHONE # \_\_\_\_\_

Precinct #: 2

## APPROVAL

This application is hereby approved subject to the following understandings and restrictions.

It is expressly understood that the said County Commissioners' Court does not imply hereby to grant any right, claim, title or easement in or upon this County Road; and it is further understood that in the future, should Williamson County, for any reason, need to work, improve, relocate, widen, increase, add to, decrease, or in any manner change the structure of this road or right-of-way, this line, if affected, will be moved at the direction of the Williamson County Engineer or County Commissioner. This installation work shall not damage any part of the roadway and adequate provisions shall be made to cause a minimum of inconvenience to traffic and adjacent property owners.

APPROVED BY WILLIAMSON COUNTY COMMISSIONERS' COURT

BY: [Signature]  
COUNTY ROAD ADMINISTRATORDATE: 5/29/97



[illegible]

**GREG BERGERON**  
County Road Administrator



1900 Georgetown Loop, Ste. B  
Georgetown, Texas 78626  
Telephone (512) 930-3330  
Fax (512) 930-3335

**Williamson County  
Unified Road System**

When specifically agreed to in writing and signed by a Williamson County Commissioner, or the County Road Administrator, Williamson County will permit the cutting of a roadbed in lieu of core drilling, provided the contractor or contractors agree to the following installation:

**SPECIFICATION FOR CUTTING ROADBED IN LIEU OF CORE DRILLING**

1. Compacted base material with concrete cap.
2. The utility shall be placed a minimum of 30" below the flow line.
3. Layer compacted and topped with 3" hot mix asphalt.
4. A performance bond, or other securities agreed upon by the County, must be pledged in the amount of the estimated cost of the road repairs, as agreed to by the contractor and Williamson County, prior to the commencing of a cutting of the roadbed.
5. A road cut permit fee, in the amount of \$120.00 per roadbed cut, must be submitted to the County Road Administrator's office prior to cutting the roadbed.

**SPECIFICATION FOR CUTTING ROADBED IN LIEU OF CORE DRILLING  
WITHIN AUSTIN ETJ**

1. Roadbed cuts to be repaired in accordance with City of Austin specifications as outlined in their standard Specifications for Cuts in Public Right of Way Manual.
2. The utility shall be placed a minimum of 30" below the flow line.
3. The installation to be free from defects for a period of one (1) year from completion date. Any maintenance required during this period, caused by the cutting of a road, will be done by the contractor or contractors without cost to the County.
4. A performance bond, or other securities agreed upon by the County, must be pledged in the amount of the estimated cost of the road repairs, as agreed to by the contractor and County, prior to the commencing of a cutting of the roadbed.
5. A roadbed cut permit fee, in the amount of \$120.00 per roadbed cut, must be submitted to the County Road Administrator's office prior to cutting the roadbed.

This agreement must be entered into prior to the commencing of the cutting of a roadbed.

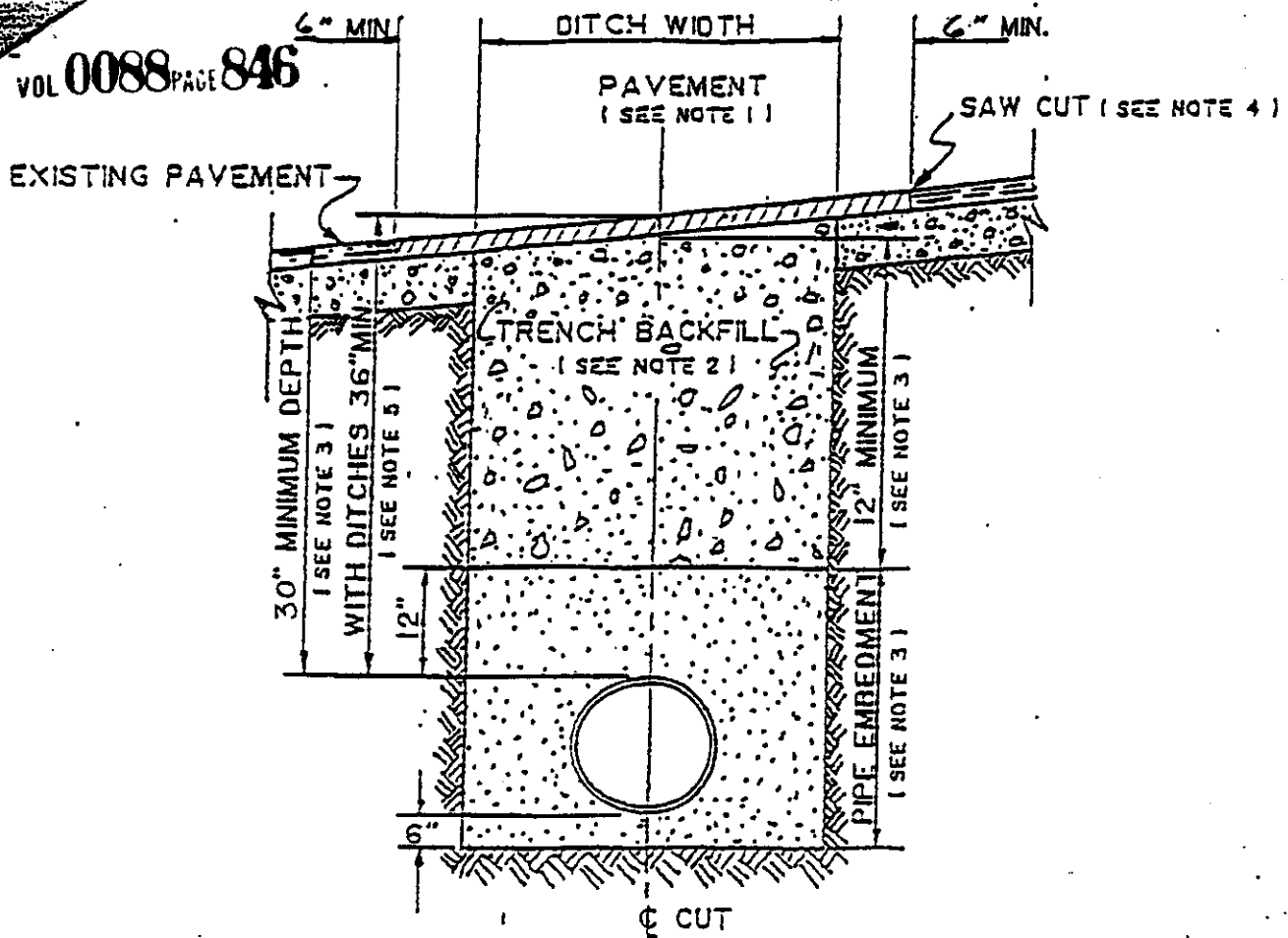

1. Hot mix asphalt 1 1/2" min. thickness. Roll in place to match existing surface.  $\pm 1/8"$  tolerance.
2. Trench backfill shall be flexible base, compacted to 95% optimum in 8" layers unless otherwise approved and specified. Flexible base to match existing base thickness or 8 inches, whichever is greater (specifications: TSHD Item 248, Type A, Grade 2).
3. Pipe embedment (pipe envelope) size and materials shall be as specified elsewhere by the utility company and/or its engineers. Pipe depth shall be as specified elsewhere provided minimum depths are met.
4. Saw cut shall be made prior to ditch cut. If pavement is damaged during cut, a new saw cut shall be made beyond the damaged area and new pavement placed.
5. Where roadside ditches (bar ditches) are crossed by the utility pipe, minimum depth to the top of the pipe from centerline road elevation will be 36".

Chisholm Trail

VOL 0088 PAGE 847

GREG BERGERON  
COUNTY ROAD ADMINISTRATOR



1900 Georgetown Inner Loop, Suite B  
Georgetown, Texas 78626  
Telephone (512) 930-3330  
Fax (512) 930-3335

Williamson County  
Unified Road System

UTILITY INSTALLATION REQUEST

DATE: 3-12-97 ROAD BORE PERMIT

TO: Williamson County Commissioners' Court  
c/o County Engineer, County Road Administrator or County Commissioner

Formal notice is hereby given that Chisholm Trail S.U.D. proposes to place  
a 8" waterline line within the right-of-way of Rollings Hills Drive  
County Road as follows:

an 8" waterline in a 10" casing

The location and description of the proposed line and appurtenances is more fully shown on the drawing attached hereto. The line will be constructed & maintained on the County right-of-way in accordance with current Williamson County Specifications as directed by the County Engineer, County Road Administrator or County Commissioner.

Construction will begin on or after the 13 day of March 19 97, and is estimated to be completed in 1 calendar days.

SUBMITTED BY FIRM: CHISHOLM TRAIL SPECIAL UTILITY DISTRICT AUTHORIZED  
SIGNATURE: [Signature] TITLE: General Manager FIRM ADDRESS: P O Box 249  
PHONE # 817/793-3103 Florence, Tx  
76527

CONTRACTOR (IF DIFFERENT FROM FIRM):  
AUTHORIZED SIGNATURE: TITLE:  
ADDRESS: PHONE #

Precinct #: 2

APPROVAL

This application is hereby approved subject to the following understandings and restrictions.

It is expressly understood that the said County Commissioners' Court does not imply hereby to grant any right, claim, title or easement in or upon this County Road; and it is further understood that in the future, should Williamson County, for any reason, need to work, improve, relocate, widen, increase, add to, decrease, or in any manner change the structure of this road or right-of-way, this line, if affected, will be moved at the direction of the Williamson County Engineer or County Commissioner. This installation work shall not damage any part of the roadway and adequate provisions shall be made to cause a minimum of inconvenience to traffic and adjacent property owners.

APPROVED BY WILLIAMSON COUNTY COMMISSIONERS' COURT

BY: [Signature]  
COUNTY ROAD ADMINISTRATOR

DATE: 3/19/97

45

3-19-97  
Bore  
RJ

RUDITH DRENNAN  
709/78  
602.59 AC.

CAROTHERS CORPORATION  
1238/59  
101.81 ACRES

CINDY CAROTHERS SHERWC  
784/516  
12.94 AC.

JAMES H. ARNOLD  
507/241  
150.00 AC.

H.C. CAROTHERS  
1238/59  
89.6 AC.

RICHARD WEST  
A-643

CEMENTERIO DE  
LAS TRES MARIAS

E. MATHER  
A-434

TRACT 1  
4.55 AC.

W. LINVILLE  
(B.A. CONNALL)  
1726/551  
2.6 AC.

R.M. PATTERSON  
670/313  
5.19 AC.

ANTHONY ESCOBAR  
(ROY E. ALLMAN)  
703/474  
TRACT 2  
5.99 AC.

TRACT 3  
5.80 AC.

ROLLING HILLS,  
BLOCK "B"

2 1/2" PVC, SDR 21, 2700 L

ROLLING HILLS ROAD  
ROBERT  
HAS. M. BRAUN TRAC  
719/825  
TRACT 5  
1.89 AC.

ROLLING HILLS

JOWERS  
S.A. GLOSSON  
736/809  
TRACT 4  
4.41 AC.

2" FLUSH VALVE  
W/ 2" FIRE HOSE ADAPTOR

2" PVC, SDR-21  
860 L.F.

46

5/8" MIN COVER @  
3-CREEK CROSSING



Chisholm Trail

GREG BERGERON  
COUNTY ROAD ADMINISTRATOR



Williamson County  
Unified Road System

VOL 0088 PAGE 849

1900 Georgetown Inner Loop, Suite B  
Georgetown, Texas 78626  
Telephone (512) 930-3330  
Fax (512) 930-3335

UTILITY INSTALLATION REQUEST

DATE: 3-12-97 ROAD BORE PERMIT

TO: Williamson County Commissioners' Court  
c/o County Engineer, County Road Administrator or County Commissioner

Formal notice is hereby given that Chisholm Trail S.U.D. proposes to place  
a 8" waterline line within the right-of-way of County Road 214  
County Road as follows: an 8" waterline in a 10" casing

The location and description of the proposed line and appurtenances is more fully shown on the drawing attached hereto. The line will be constructed & maintained on the County right-of-way in accordance with current Williamson County Specifications as directed by the County Engineer, County Road Administrator or County Commissioner.

Construction will begin on or after the 13 day of March 1997, and is estimated to be completed in 1 calendar days.

SUBMITTED BY FIRM: CHISHOLM TRAIL SPECIAL UTILITY DISTRICT AUTHORIZED  
SIGNATURE: [Signature] TITLE: General Manager FIRM ADDRESS: P O Box 249  
PHONE #817/793-3103 Florence, Tx  
CONTRACTOR (IF DIFFERENT FROM FIRM): 76527  
AUTHORIZED SIGNATURE: \_\_\_\_\_ TITLE: \_\_\_\_\_  
ADDRESS: \_\_\_\_\_ PHONE # \_\_\_\_\_

Precinct #: 2

APPROVAL

This application is hereby approved subject to the following understandings and restrictions.

It is expressly understood that the said County Commissioners' Court does not imply hereby to grant any right, claim, title or easement in or upon this County Road; and it is further understood that in the future, should Williamson County, for any reason, need to work, improve, relocate, widen, increase, add to, decrease, or in any manner change the structure of this road or right-of-way, this line, if affected, will be moved at the direction of the Williamson County Engineer or County Commissioner. This installation work shall not damage any part of the roadway and adequate provisions shall be made to cause a minimum of inconvenience to traffic and adjacent property owners.

APPROVED BY WILLIAMSON COUNTY COMMISSIONERS' COURT

BY: [Signature]  
COUNTY ROAD ADMINISTRATOR

DATE: 3/18/97

47

3-19-97  
Bore  
R.J.

RUDITH DRENNAN  
709/78  
602.59 AC.

CAROTHERS CORPORATION  
1238/59  
101.81 ACRES

JAMES H. ARNOLD  
507/241  
150.00 AC.

CINDY CAROTHERS SHERWC  
784/516  
12.94 AC.

RICHARD WEST  
A-643

CEMENTERIO DE  
LAS TRES MARIAS

H.C. CAROTHERS  
1238/59  
89.6 AC.

E. MATHER  
A-434

TRACT 1  
4.53 AC.

W.E. LINVILLE  
(B.A. CONNALL)  
1726/551  
2.6 AC.

R.H. PATTERSON  
670/313  
5.19 AC.

HAROLD L. MORRIS  
780/780  
3.48 AC.

ANTHONY ESCOBAR  
(ROY E. ALLMAN)  
703/474  
TRACT 2  
5.99 AC.

TRACT 3  
5.80 AC.

ROLLING HILLS  
JOWERS  
ES A. GLOSSON  
736/809  
TRACT 4  
4.41 AC.

ROLLING HILLS  
BLOCK "B"  
MAS. M. BRAUN  
719/825  
TRACT 5  
1.89 AC.

2" FLUSH VALVE  
W/ 2" FIRE HOSE ADAPTOR  
(70 PSI)

2" PVC, SDR-21  
860 L.F.

36" MIN COVER @  
3-CREEK CROSSING

GREG BERGERON  
COUNTY ROAD ADMINISTRATOR



311 Main St.  
Georgetown, TX 78626  
(512) 930-3330

Williamson County  
Unified Road System

UTILITY INSTALLATION REQUEST

DATE: 5-26-97

TO: Williamson County Commissioners' Court  
c/o County Engineer, County Road Administrator or County Commissioner

Formal notice is hereby given that Southwestern Bell Telephone proposes to place a BURIED line within the right-of-way of CR 255 County Road as follows: FROM A PRIVATE EASEMENT ON THE EAST SIDE OF CR 255 AT NORTH SIDE FM 3405. BURIED NORTH FOR 77' AND ACROSS CR 255 TO AN EXISTING CLEAR TO BE REMOVED.

The location and description of the proposed line and appurtenances is more fully shown on the drawing attached hereto. The line will be constructed & maintained on the County right-of-way in accordance with current Williamson County Specifications as directed by the County Engineer, County Road Administrator or County Commissioner.

Construction will begin on or after the 30th day of May 1997, and is estimated to be completed in 45 calendar days.

SUBMITTED BY SWB Southwestern Bell Telephone Co. AUTHORIZED SIGNATURE: [Signature] TITLE: Manager Design FIRM ADDRESS: 1616 Guadalupe Rm 406, Austin, Texas PHONE # (512) 870-3443 CONTRACTOR (IF DIFFERENT FROM FIRM) UNKNOWN AT THIS TIME AUTHORIZED SIGNATURE: [Signature] TITLE: Manager Design ADDRESS: 1616 Guadalupe Rm 406, Austin, Texas PHONE # (512) 870-3443 78701

APPROVAL

Date: \_\_\_\_\_

This application is hereby approved subject to the following understandings and restrictions.

It is expressly understood that the said County Commissioners' Court does not imply hereby to grant any right, claim, title or easement in or upon this County Road; and it is further understood that in the future, should Williamson County, for any reason, need to work, improve, relocate, widen, increase, add to, decrease, or in any manner change the structure of this road or right-of-way, this line, if affected, will be moved at the direction of the Williamson County Engineer or County Commissioner. This installation work shall not damage any part of the roadway and adequate provisions shall be made to cause a minimum of inconvenience to traffic and adjacent property owners.

APPROVED BY WILLIAMSON COUNTY COMMISSIONERS' COURT

BY: [Signature] PRECINCT # 3

DATE: 5/29/97

VOL 0088 PAGE 852

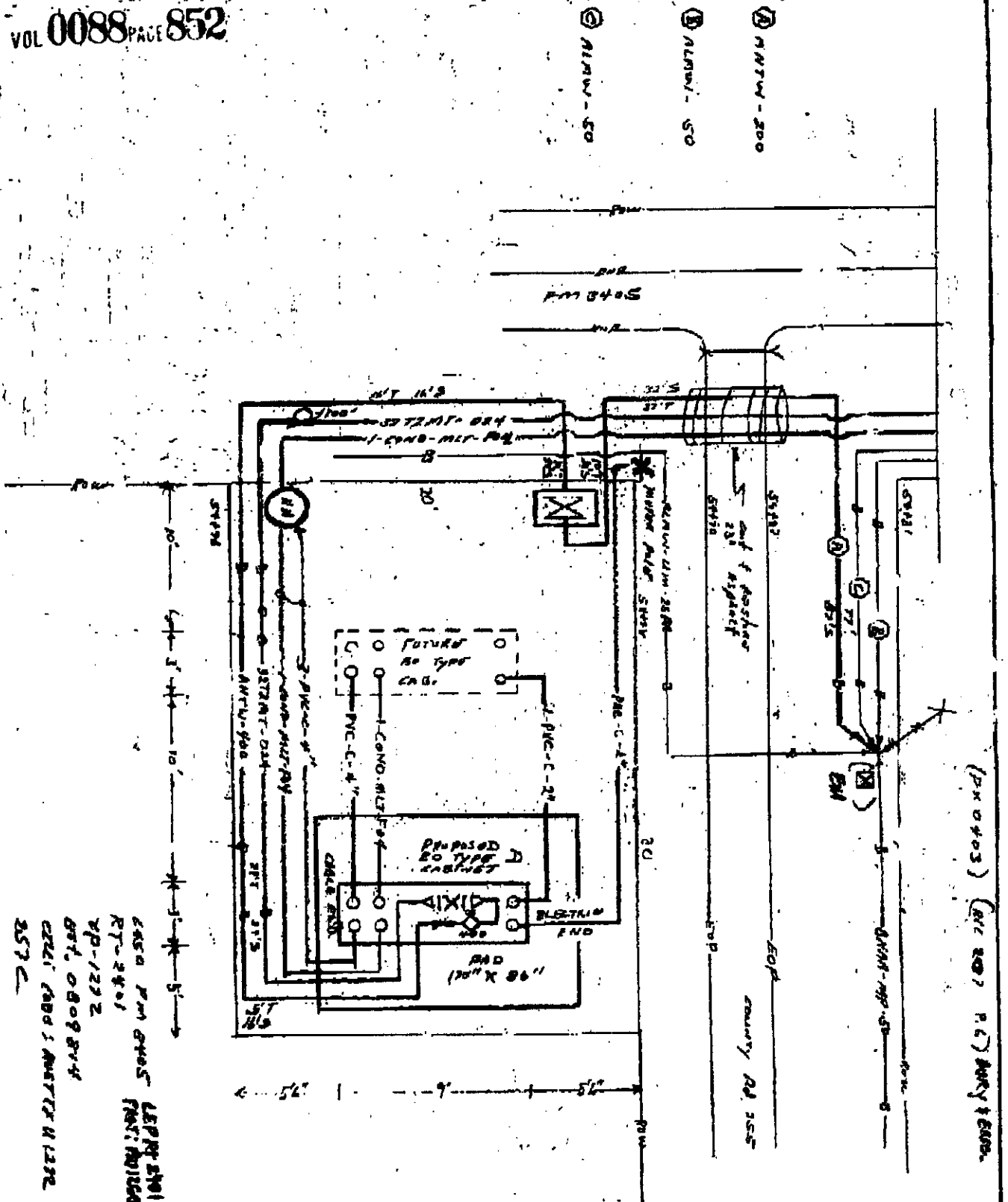

6450 PM 0405 LEPT 2701  
RT-2401 FRT: 701506  
VP-1222  
0871.0809814  
0241.0005 ANATX 11232  
257C

<b>NORTH ARROW</b> OPERATION RANGE OF JOE STEPS LINE <input type="checkbox"/> TO <input type="checkbox"/> SPUR <input type="checkbox"/> TO <input type="checkbox"/> WIRE 4C	
TRANSMISSION ZONE RT <input type="checkbox"/> ET <input type="checkbox"/> TAPER CODE <input type="checkbox"/>	
ELECTRIC HIGH VOLTAGE 7.2 KV <input type="checkbox"/> AERIAL <input type="checkbox"/> BURNED	
SPECIAL DISCRETE SYMBOLS <input type="checkbox"/> YES <input type="checkbox"/> NO 4803 FORWARDED <input type="checkbox"/> YES <input type="checkbox"/> NO	
PARENT REQUIRED <input type="checkbox"/> YES <input type="checkbox"/> NO	
POLE CONTACTS <input type="checkbox"/> YES <input type="checkbox"/> NO	
(H) <input type="checkbox"/> OR <input type="checkbox"/> P.W. CO. <input type="checkbox"/>	
<b>NOTES</b> 1) Locate all equipment and structures 2) Locate all equipment and structures 3) Locate all equipment and structures 4) Locate all equipment and structures 5) Locate all equipment and structures 6) Locate all equipment and structures 7) Locate all equipment and structures 8) Locate all equipment and structures 9) Locate all equipment and structures 10) Locate all equipment and structures	
ORDER NO. <input type="text"/>	
TOT. PLUM. & P.W. NO. <input type="text"/>	
CO. <input type="text"/>	
DOCA <input type="text"/>	
TAC. DIR. <input type="text"/>	
DIR. LOC. <input type="text"/>	
DIR. ST. <input type="text"/>	
DIR. DIR. <input type="text"/>	
DIR. DIR. <input type="text"/>	

**GREG BERGERON**  
County Road Administrator



VOL 0088 PAGE 853  
1900 Georgetown Loop, Ste. B  
Georgetown, Texas 78626  
Telephone (512) 930-3330  
Fax (512) 930-3335

**Williamson County  
Unified Road System**

When specifically agreed to in writing and signed by a Williamson County Commissioner, or the County Road Administrator, Williamson County will permit the cutting of a roadbed in lieu of core drilling, provided the contractor or contractors agree to the following installation:

**SPECIFICATION FOR CUTTING ROADBED IN LIEU OF CORE DRILLING**

1. Compacted base material with concrete cap.
2. The utility shall be placed a minimum of 30" below the flow line.
3. Layer compacted and topped with 3" hot mix asphalt.
4. A performance bond, or other securities agreed upon by the County, must be pledged in the amount of the estimated cost of the road repairs, as agreed to by the contractor and Williamson County, prior to the commencing of a cutting of the roadbed.
5. A road cut permit fee, in the amount of \$120.00 per roadbed cut, must be submitted to the County Road Administrator's office prior to cutting the roadbed.

**SPECIFICATION FOR CUTTING ROADBED IN LIEU OF CORE DRILLING  
WITHIN AUSTIN ETJ**

1. Roadbed cuts to be repaired in accordance with City of Austin specifications as outlined in their standard Specifications for Cuts in Public Right of Way Manual.
2. The utility shall be placed a minimum of 30" below the flow line.
3. The installation to be free from defects for a period of one (1) year from completion date. Any maintenance required during this period, caused by the cutting of a road, will be done by the contractor or contractors without cost to the County.
4. A performance bond, or other securities agreed upon by the County, must be pledged in the amount of the estimated cost of the road repairs, as agreed to by the contractor and County, prior to the commencing of a cutting of the roadbed.
5. A roadbed cut permit fee, in the amount of \$120.00 per roadbed cut, must be submitted to the County Road Administrator's office prior to cutting the roadbed.

This agreement must be entered into prior to the commencing of the cutting of a roadbed.

EXISTING PAVEMENT

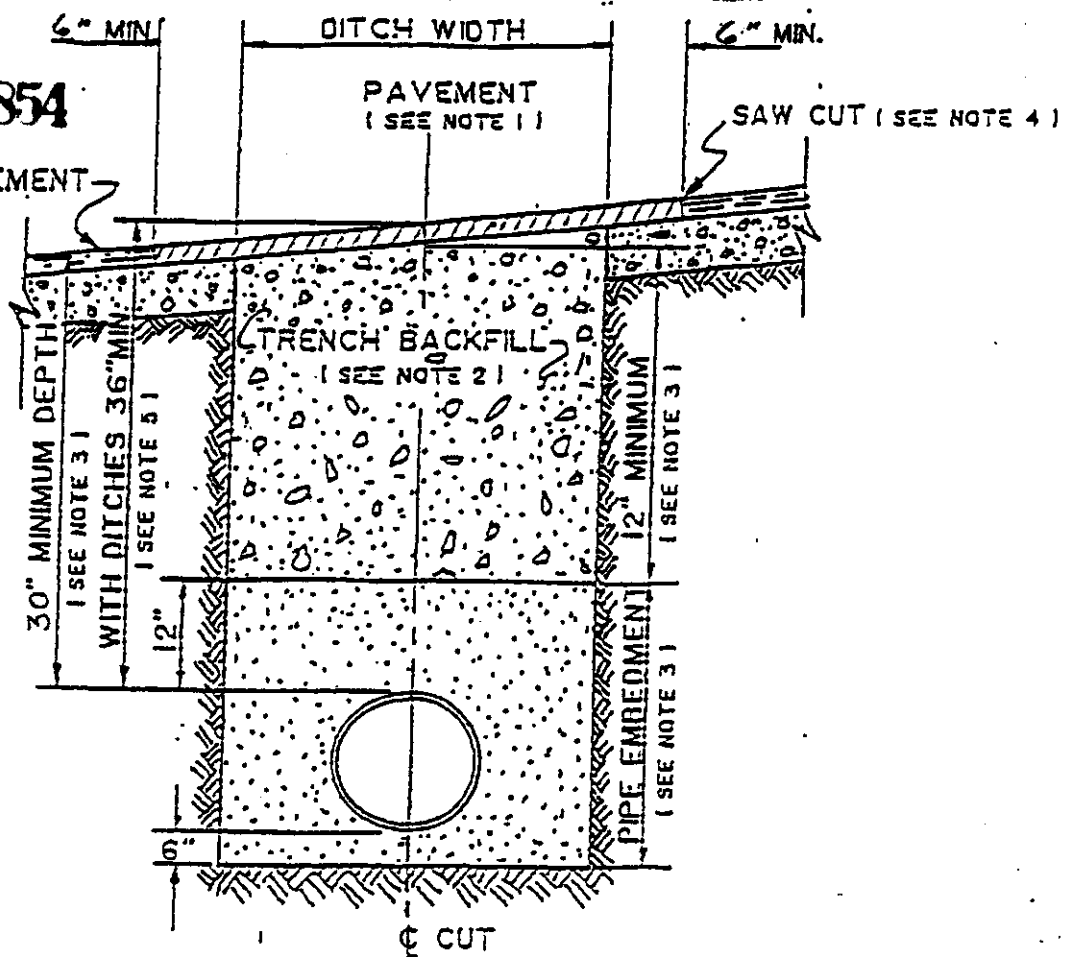

1. Hot mix asphalt 1 1/2" min. thickness. Roll in place to match existing surface.  $\pm 1/8"$  tolerance.
2. Trench backfill shall be flexible base, compacted to 95% optimum in 8" layers unless otherwise approved and specified. Flexible base to match existing base thickness or 8 inches, whichever is greater (specifications: TSHD Item 248, Type A, Grade 2).
3. Pipe embedment (pipe envelope) size and materials shall be as specified elsewhere by the utility company and/or its engineers. Pipe depth shall be as specified elsewhere provided minimum depths are met.
4. Saw cut shall be made prior to ditch cut. If pavement is damaged during cut, a new saw cut shall be made beyond the damaged area and new pavement placed.
5. Where roadside ditches (bar ditches) are crossed by the utility pipe, minimum depth to the top of the pipe from centerline road elevation will be 36".

GREG BERGERON  
County Road Administrator

1900 Georgetown Inner Loop, Suite B  
Georgetown, Texas 78626  
Telephone (512) 930-3330  
Fax (512) 930-3335

Williamson County  
Unified Road System

UTILITY INSTALLATION REQUEST

DATE: May 6, 1997  
TO: Williamson County Commissioners' Court c/o County Engineer or County Commissioner

Formal notice is hereby given that Central Telephone Company of Texas proposes to place a buried communication within the right-of-way of 253 County Road as follows:

Beginning at the intersection of CR 251 & CR 253 and continuing in the north right-of-way for 20 feet at a depth of 24 inches and at a distance of 3 feet from the rear of the right-of-way.

30 inches  
The location and description of the proposed line and appurtenances is more fully shown on the drawing attached hereto. The line will be constructed & maintained on the County right-of-way in accordance with current Williamson County Specifications as directed by the County Engineer or County Commissioner.

Construction will begin on or after the 21st day of May, 1997, and is estimated to be completed in 1 calendar day.

SUBMITTED BY FIRM: Central Telephone Company of Texas AUTHORIZED  
SIGNATURE: Ken Chester Ken Chester TITLE: Network Engineer  
FIRM ADDRESS: 1214 Dogwood, P.O. Box 1150, Killeen, TX 76543 PHONE # 817-690-9325  
CONTRACTOR (IF DIFFERENT FROM FIRM:)  
AUTHORIZED SIGNATURE: TITLE:  
ADDRESS: PHONE #

Precinct # 3

APPROVAL

The application is hereby approved subject to the following understandings and restrictions.

It is expressly understood that the said County Commissioners' Court does not imply hereby to grant any right, claim, title or easement in or upon this County Road; and it is further understood that in the future, should Williamson County, for any reason, need to work, improve, relocate, widen, increase, add to, decrease, or in any manner change the structure of this road or right-of-way, this line, if affected, will be moved at the direction of the Williamson County Engineer or County Commissioner. This installation work shall not damage any part of the roadway and adequate provisions shall be made to cause a minimum of inconvenience to traffic and adjacent property owners.

APPROVED BY WILLIAMSON COUNTY COMMISSIONERS' COURT

5-13-97  
ROW  
R-1  
BY: Greg Bergeron  
COUNTY ROAD ADMINISTRATOR

DATE: 5/14/97

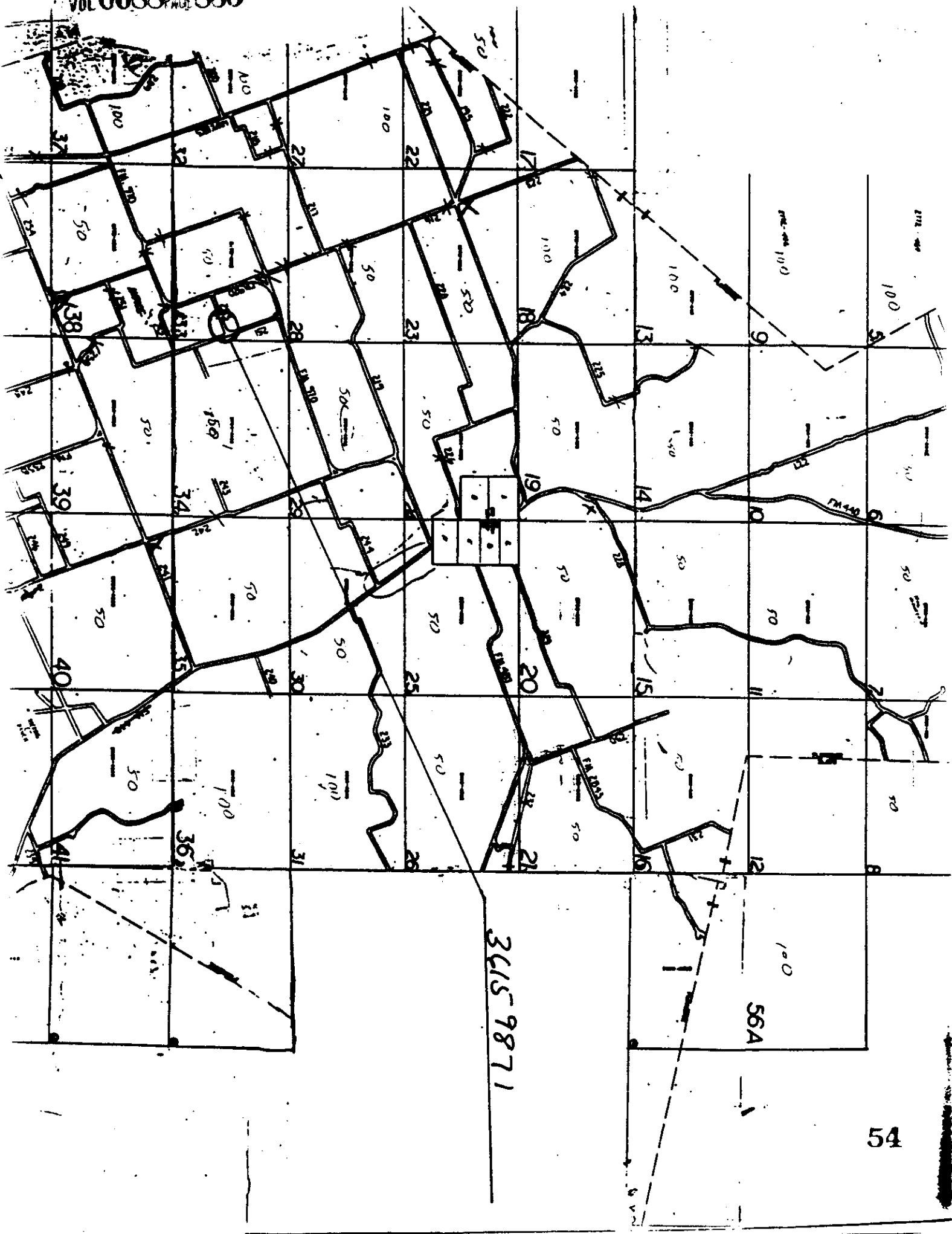







36159871

FLRN/ MAP 33

#12550  
CR-160  
'MIS

2.537-540

2588

58862  
P\*-\*

253

2

5

BDW

\_\_\_\_\_

BD

W-

\_\_\_\_\_

---

File DSO-N706507/MENNEN

Engineer	T.D.
KEC3	

[illegible]

FLRNTX

WORK ORDER 36159871

1

State TX

Scale 1"=10'

Company Code 36

SHEET : OF 1

----- CONST. NOTES: -----  
THIS WILL REQUIRE A  
COUNTY PERMIT. PLACE  
20 FT OF BURIED DROP  
IN THE RIGHT-OF-WAY  
TO AN EXISTING POWER  
POLE. PLACE NEW 35' - 5  
POLE AT THE REAR OF THE

SOUTH RIGHT-OF-WAY THEN  
PLACE 120 FT OF  
DROP TO THE LOCATION  
OF THE NEW TRAILER.

COM POLE TO TRAILER

9214

125 CR 253

33735-5  
\* 50615863  
\* 4871 (PP)

55

VOL 0088 PAGE 857

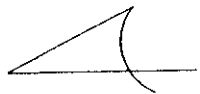

GREG BERGERON  
COUNTY ROAD ADMINISTRATOR

**received**  
5-22-97



Williamson County  
Unified Road System

1900 Georgetown Inner Loop, Suite B  
Georgetown, Texas 78626  
Telephone (512) 930-3330  
Fax (512) 930-3335

### UTILITY INSTALLATION REQUEST

DATE: MAY 15, 1997

TO: Williamson County Commissioners' Court  
c/o County Engineer, County Road Administrator or County Commissioner

Formal notice is hereby given that CHISHOLM TRAIL S.U.D. proposes to place a 2" waterline ~~XXXX~~ within the right-of-way of County Road 224 County Road as follows: It is 21' on the East side of the road to the pavement, 20' on the West side of the road to the pavement. The waterline is on the East side of the road and is 30' from the pavement. The width of the pavement is 21' and the water line is 36" deep. Cut will be 36" deep. The location and description of the proposed line and appurtenances is more fully shown on the drawing attached hereto. The line will be constructed & maintained on the County right-of-way in accordance with current Williamson County Specifications as directed by the County Engineer, County Road Administrator or County Commissioner.

Construction will begin on or after the 20 day of May 1997, and is estimated to be completed in 1 calendar days.

SUBMITTED BY FIRM: CHISHOLM TRAIL SPECIAL UTILITY DISTRICT AUTHORIZED SIGNATURE: [Signature] TITLE: General Manager FIRM ADDRESS: P O Box 249 PHONE # 817/793-3103 Florence, Tx 76527  
CONTRACTOR (IF DIFFERENT FROM FIRM): \_\_\_\_\_  
AUTHORIZED SIGNATURE: \_\_\_\_\_ TITLE: \_\_\_\_\_  
ADDRESS: \_\_\_\_\_ PHONE # \_\_\_\_\_

Precinct #: 3

### APPROVAL

This application is hereby approved subject to the following understandings and restrictions.

It is expressly understood that the said County Commissioners' Court does not imply hereby to grant any right, claim, title or easement in or upon this County Road; and it is further understood that in the future, should Williamson County, for any reason, need to work, improve, relocate, widen, increase, add to, decrease, or in any manner change the structure of this road or right-of-way, this line, if affected, will be moved at the direction of the Williamson County Engineer or County Commissioner. This installation work shall not damage any part of the roadway and adequate provisions shall be made to cause a minimum of inconvenience to traffic and adjacent property owners.

APPROVED BY WILLIAMSON COUNTY COMMISSIONERS' COURT

BY: [Signature]  
COUNTY ROAD ADMINISTRATOR

DATE: 5/29/97

56



**GREG BERGERON**  
County Road Administrator



1900 Georgetown Loop, Ste. B  
Georgetown, Texas 78626  
Telephone (512) 930-3330  
Fax (512) 930-3335

**Williamson County  
Unified Road System**

When specifically agreed to in writing and signed by a Williamson County Commissioner, or the County Road Administrator, Williamson County will permit the cutting of a roadbed in lieu of core drilling, provided the contractor or contractors agree to the following installation:

**SPECIFICATION FOR CUTTING ROADBED IN LIEU OF CORE DRILLING**

1. Compacted base material with concrete cap.
2. The utility shall be placed a minimum of 30" below the flow line.
3. Layer compacted and topped with 3" hot mix asphalt.
4. A performance bond, or other securities agreed upon by the County, must be pledged in the amount of the estimated cost of the road repairs, as agreed to by the contractor and Williamson County, prior to the commencing of a cutting of the roadbed.
5. A road cut permit fee, in the amount of \$120.00 per roadbed cut, must be submitted to the County Road Administrator's office prior to cutting the roadbed.

**SPECIFICATION FOR CUTTING ROADBED IN LIEU OF CORE DRILLING  
WITHIN AUSTIN ETJ**

1. Roadbed cuts to be repaired in accordance with City of Austin specifications as outlined in their standard Specifications for Cuts in Public Right of Way Manual.
2. The utility shall be placed a minimum of 30" below the flow line.
3. The installation to be free from defects for a period of one (1) year from completion date. Any maintenance required during this period, caused by the cutting of a road, will be done by the contractor or contractors without cost to the County.
4. A performance bond, or other securities agreed upon by the County, must be pledged in the amount of the estimated cost of the road repairs, as agreed to by the contractor and County, prior to the commencing of a cutting of the roadbed.
5. A roadbed cut permit fee, in the amount of \$120.00 per roadbed cut, must be submitted to the County Road Administrator's office prior to cutting the roadbed.

This agreement must be entered into prior to the commencing of the cutting of a roadbed.

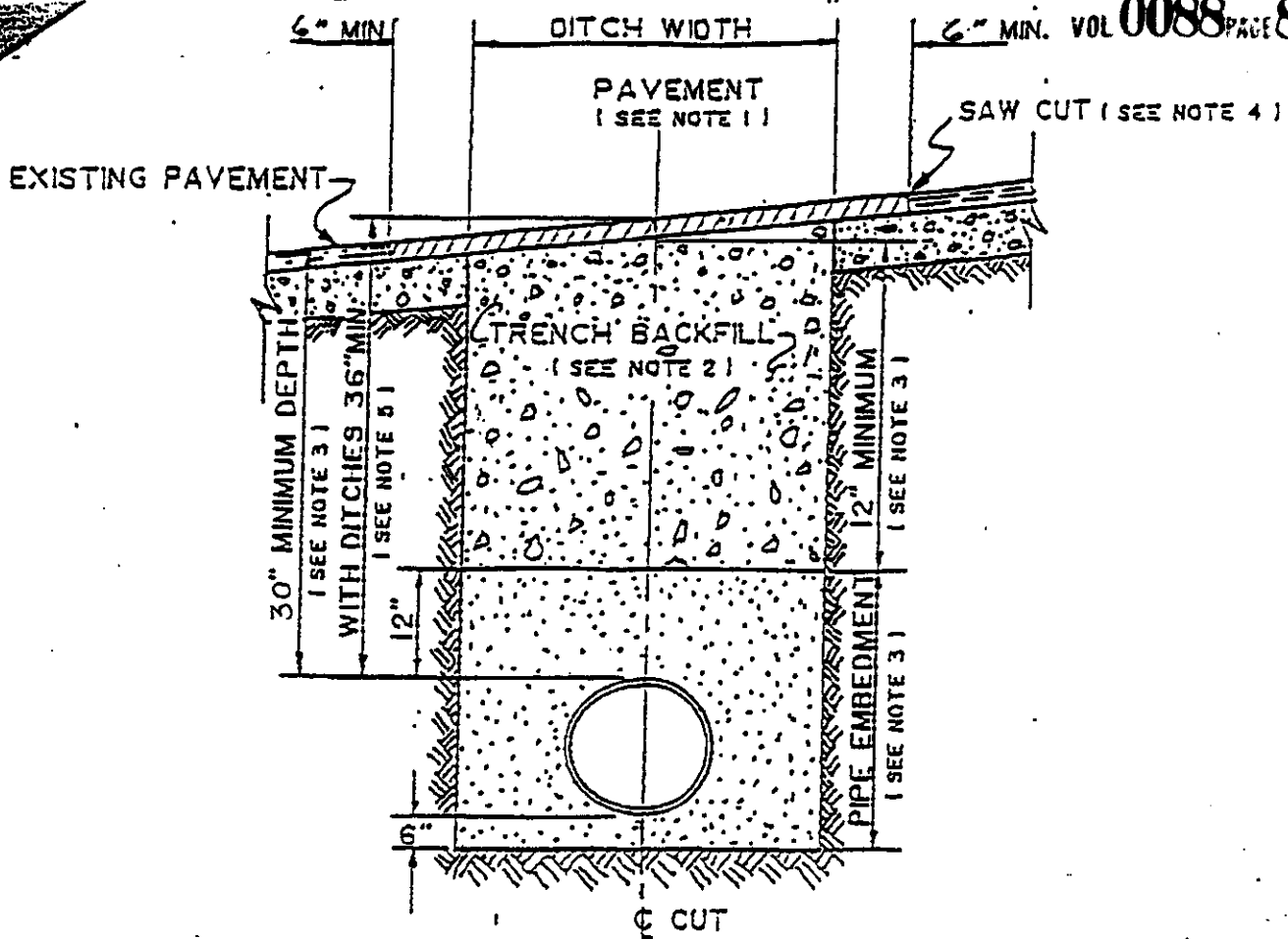

1. Hot mix asphalt 1 1/2" min. thickness. Roll in place to match existing surface.  $\pm 1/8"$  tolerance.
2. Trench backfill shall be flexible base, compacted to 95% optimum in 8" layers unless otherwise approved and specified. Flexible base to match existing base thickness or 8 inches, whichever is greater (specifications: TSHD Item 248, Type A, Grade 2).
3. Pipe embedment (pipe envelope) size and materials shall be as specified elsewhere by the utility company and/or its engineers. Pipe depth shall be as specified elsewhere provided minimum depths are met.
4. Saw cut shall be made prior to ditch cut. If pavement is damaged during cut, a new saw cut shall be made beyond the damaged area and new pavement placed.
5. Where roadside ditches (bar ditches) are crossed by the utility pipe, minimum depth to the top of the pipe from centerline road elevation will be 36".

GREG BERGERON  
COUNTY ROAD ADMINISTRATOR



1900 Georgetown Inner Loop, Suite 8  
Georgetown, Texas 78626  
Telephone (512) 930-3330  
Fax (512) 930-3335

Williamson County  
Unified Road System

UTILITY INSTALLATION REQUEST

DATE: 5-8-97

TO: Williamson County Commissioners' Court  
c/o County Engineer, County Road Administrator or County Commissioner

Formal notice is hereby given that Southwestern Bell proposes to place  
a BURIED SERVICE line within the right-of-way of CR 101  
County Road as follows: BURY FROM  
EAST STOP OF ROAD TO WEST SIDE HOME OF DOUG SCHERNIK  
WILL BORE UNDER ROAD

The location and description of the proposed line and appurtenances is more  
fully shown on the drawing attached hereto. The line will be constructed &  
maintained on the County right-of-way in accordance with current Williamson  
County Specifications as directed by the County Engineer, County Road  
Administrator or County Commissioner.

Construction will begin on or after the 14 day of MAY 19 97 and  
is estimated to be completed in 2 calendar days.

SUBMITTED BY FIRM: Southwestern Bell TELEPHONE AUTHORIZED  
SIGNATURE: [Signature] TITLE: CST. FIRM ADDRESS: 500 TAYLOR  
TAYLOR, TX PHONE # 870-3555  
CONTRACTOR (IF DIFFERENT FROM FIRM): Hausley CONST. TITLE: CST.  
AUTHORIZED SIGNATURE: [Signature] PHONE # 244-7351  
ADDRESS: 16301 BURNETT RD DUSTIN, TX 78724

Precinct #: 4

APPROVAL

This application is hereby approved subject to the following understandings and restrictions.

It is expressly understood that the said County Commissioners' Court does not imply hereby  
to grant any right, claim, title or easement in or upon this County Road; and it is further  
understood that in the future, should Williamson County, for any reason, need to work,  
improve, relocate, widen, increase, add to, decrease, or in any manner change the structure  
of this road or right-of-way, this line, if affected, will be moved at the direction of the  
Williamson County Engineer or County Commissioner. This installation work shall not damage  
any part of the roadway and adequate provisions shall be made to cause a minimum of  
inconvenience to traffic and adjacent property owners.

APPROVED BY WILLIAMSON COUNTY COMMISSIONERS' COURT

BY: [Signature]  
COUNTY ROAD ADMINISTRATOR

DATE: 5/14/97

60

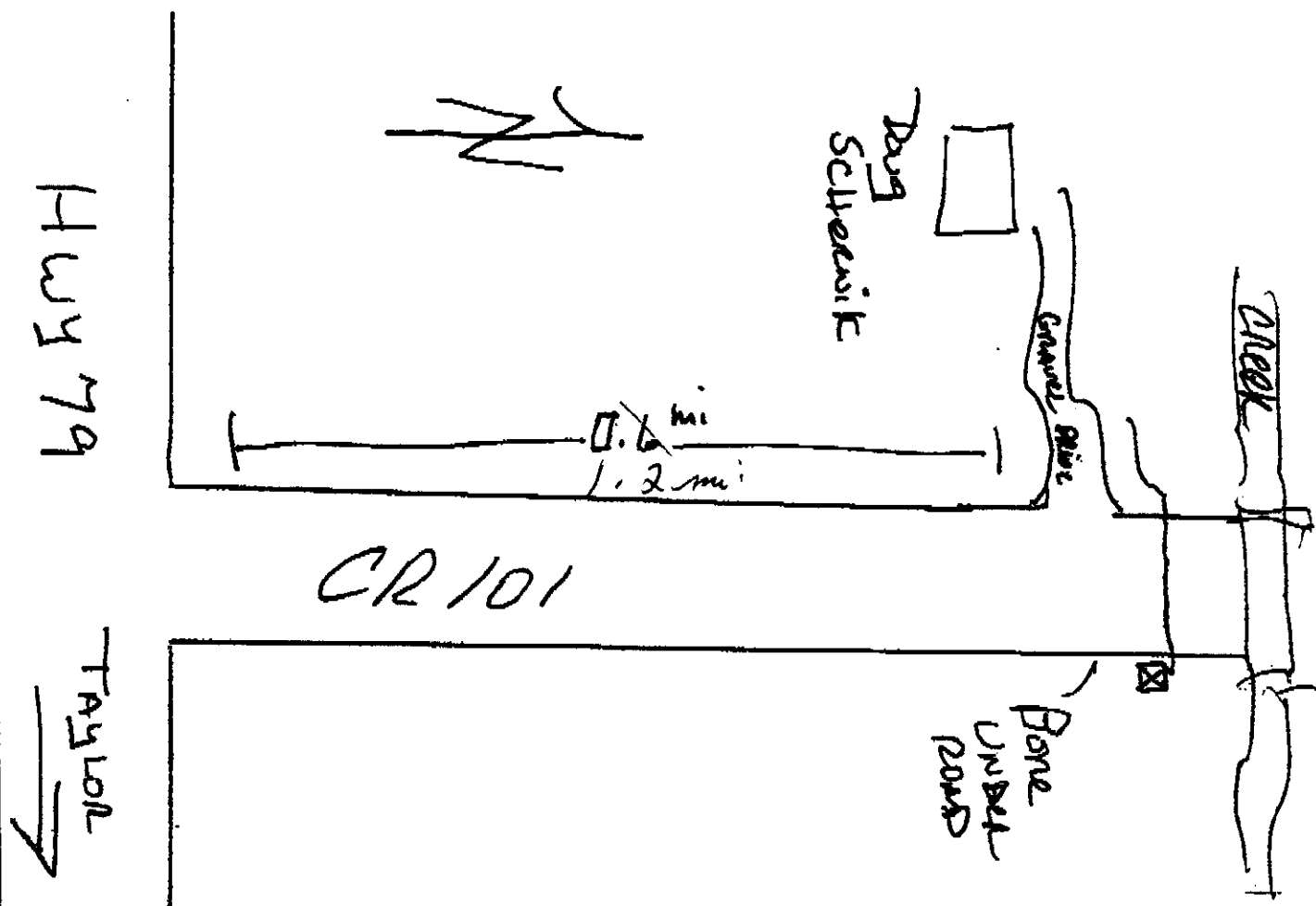

\*\* TOTAL PAGE.001 \*\*

GREG BERGERON  
COUNTY ROAD ADMINISTRATOR



311 Main St.  
Georgetown, TX 78626  
(512) 930-3330

Williamson County  
Unified Road System

UTILITY INSTALLATION REQUEST

DATE: 4-28-97

TO: Williamson County Commissioners' Court  
c/o County Engineer, County Road Administrator or County Commissioner

Formal notice is hereby given that GTE proposes to place a BURIED COPPER line within the right-of-way of CR 425 County Road as follows: Beginning at GTE STA 0+00 a Buried cable to be placed 5' inside East ROW For 10625ft To GTE STA 11+70. Cable to be placed 30" deep. End of Buried Const.

The location and description of the proposed line and appurtenances is more fully shown on the drawing attached hereto. The line will be constructed & maintained on the County right-of-way in accordance with current Williamson County Specifications as directed by the County Engineer, County Road Administrator or County Commissioner.

Construction will begin on or after the 10 day of May 1997, and is estimated to be completed in 90 calendar days.

SUBMITTED BY FIRM: GTE AUTHORIZED  
SIGNATURE: Anthony R. Rector TITLE: DSPT FIRM ADDRESS: 1700 N  
AUSTIN AVE. GEORGETOWN TX 78626 PHONE # 512-869-2290  
CONTRACTOR (IF DIFFERENT FROM FIRM):  
AUTHORIZED SIGNATURE: TITLE:  
ADDRESS: PHONE #

APPROVAL

Date: \_\_\_\_\_

This application is hereby approved subject to the following understandings and restrictions.

It is expressly understood that the said County Commissioners' Court does not imply hereby to grant any right, claim, title or easement in or upon this County Road; and it is further understood that in the future, should Williamson County, for any reason, need to work, improve, relocate, widen, increase, add to, decrease, or in any manner change the structure of this road or right-of-way, this line, if affected, will be moved at the direction of the Williamson County Engineer or County Commissioner. This installation work shall not damage any part of the roadway and adequate provisions shall be made to cause a minimum of inconvenience to traffic and adjacent property owners.

APPROVED BY WILLIAMSON COUNTY COMMISSIONERS' COURT

BY: Greg Bergeron PRECINCT # 4  
COUNTY ROAD ADMINISTRATOR

DATE: 5/14/97

62

ISSUED 8-12-77 EFFECTIVE 1-18-77 DOCKET 13-15	<b>GTE</b> GENERAL TELEPHONE COMPANY OF THE SOUTHWEST	TEXAS GENERAL EXCHANGE TARIFF MAP SUPPLEMENT SECTION 6 SAN GABRIEL, TEXAS Exchange Area Boundary
SCALE 1 inch = 2 Mi.		First Revised SHEET NO. 225A CANCELLING - Original SHEET NO. 225A

ALL BOUNDARIES ARE 600 FEET FROM  
ROADS UNLESS OTHERWISE NOTED

R. REX BAILEY  
VICE PRESIDENT--REVENUE REQUIREMENTS

WORK LOCATION CR 425



ISSUED 8-12-77  
EFFECTIVE 1-18-77  
DOCKET 13-15

**GTE**  
GENERAL  
TELEPHONE  
COMPANY  
OF THE  
SOUTHWEST

TEXAS GENERAL EXCHANGE TARIFF  
MAP SUPPLEMENT SECTION 6

SAN GABRIEL, TEXAS  
Exchange Area Boundary

SCALE 1 inch = 2 Mi.

First Revised SHEET NO. 225A  
CANCELLING - Original SHEET NO. 225A

ALL BOUNDARIES ARE 600 FEET FROM  
ROADS UNLESS OTHERWISE NOTED

R. REX BAILEY  
VICE PRESIDENT--REVENUE REQUIREMENTS

WORK LOCATION CR 425

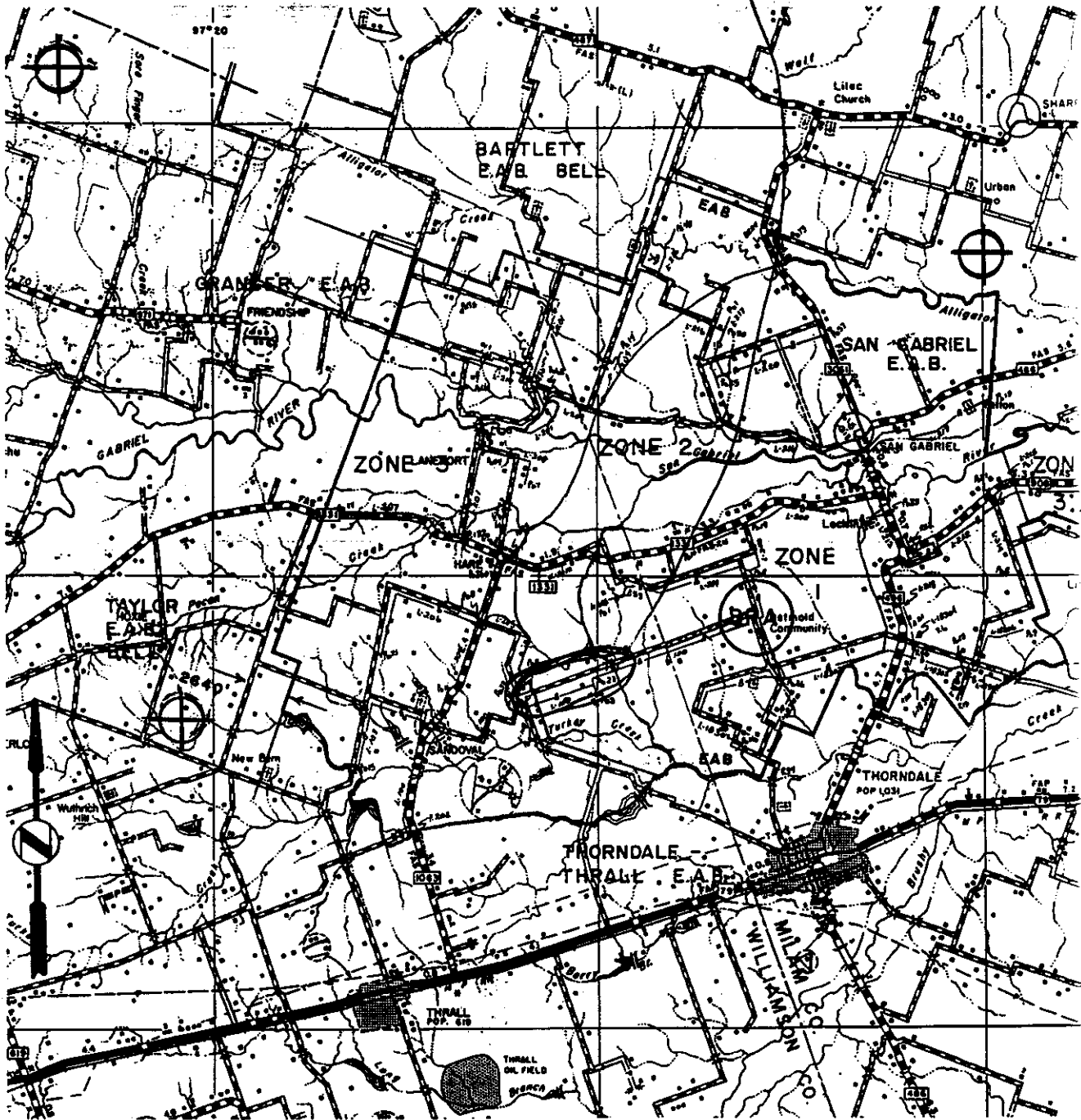

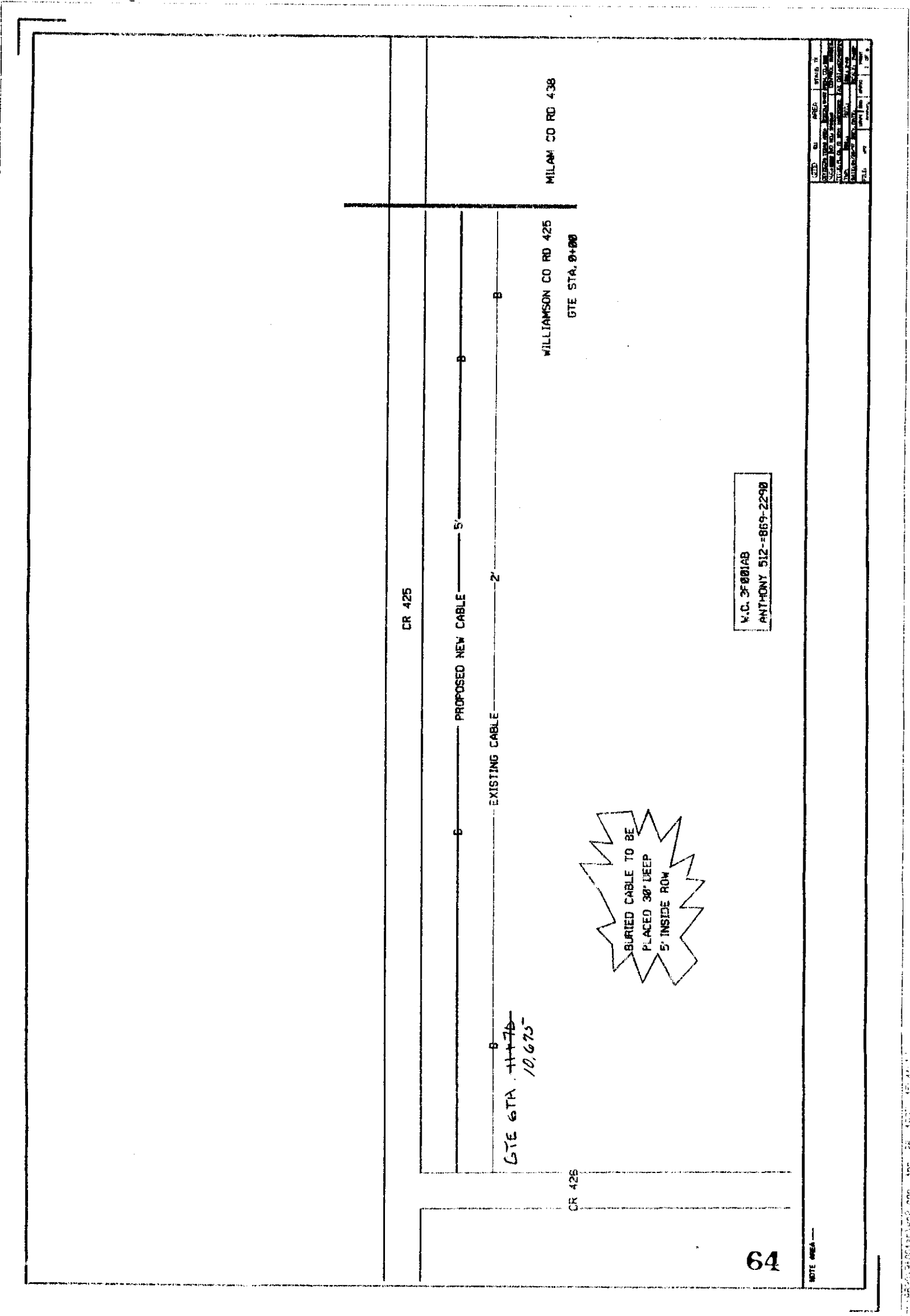

AGENDA ITEM # 5June 10, 1997\*Consider granting final approval to Amended Plat of a portion of Forest North Estates, Phase IV-C, Lot A.

Moved: Commissioner Heiligenstein

Seconded: Commissioner Boatright

Motion: To approve final to amended plat of Lot A, Forest North Estates, Phase IV-C.

Vote: Motion carried 5 - 0

AGENDA ITEM # 6June 10, 1997\*Consider granting final plat approval to Vista Oaks 6A.

Moved: Commissioner Hays

Seconded: Commissioner Heiligenstein

Motion: To grant final plat approval to Vista Oaks 6A.

Vote: Motion carried 5 - 0

AGENDA ITEM # 7June 10, 1997\*Consider setting a date for a public hearing for Resubdivision of Whitetail, Lot 45.

Moved: Commissioner Hays

Seconded: Judge Doerfler

Motion: To authorize 10:00 a.m. on July 8, 1997 as date for public hearing for Resubdivision of Whitetail, Lot 45 with property owner handling the advertising.

Vote: Motion carried 5 - 0

AGENDA ITEM # 8June 10, 1997\*Consider granting final plat approval to Tilson Subdivision.

Moved: Commissioner Hays

Seconded: Commissioner Mehevec

Motion: To grant final plat approval to Tilson Subdivision.

Vote: Motion carried 5 - 0